

**General Notes :**

A. All exposed piping ( monitor) shall be hard drain copper tubing.

(B) Monitors are to be mounted on a steel frame anchored to the floor and ceiling. Frame to be primed and painted, see COR for color.

(C) Existing meter on 8" line to be removed and a strainer installed by contractor.

**General Notes :**

1. OWQM, see schedule for required sensor.
2. Connect to domestic water piping where applicable.
3. Provide one OWQM flow cell for hot water and a separate flow cell for cold water.
4. Insulation removed to install Monitor shall be replaced with new insulation.

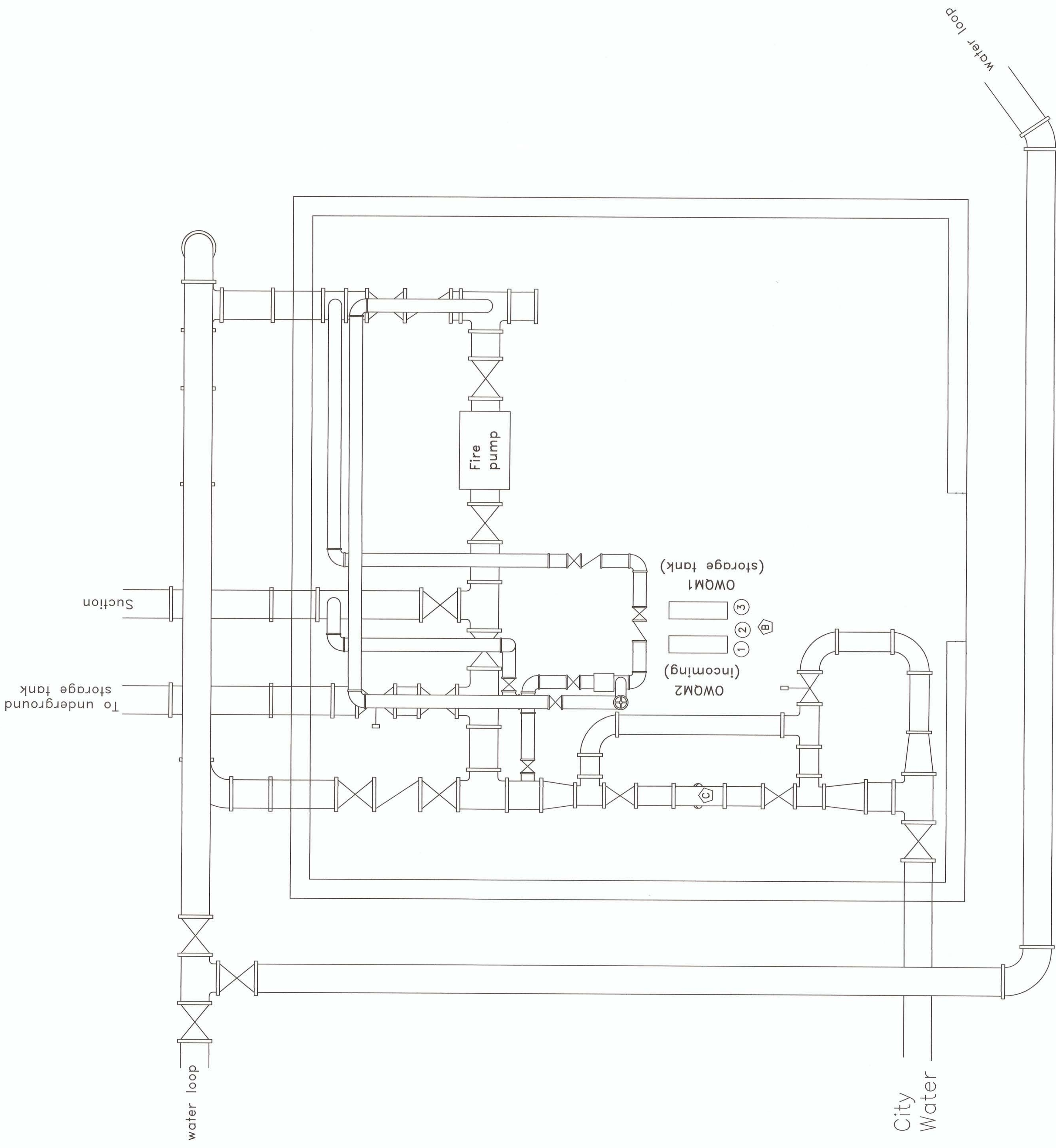

Pump house Building 10

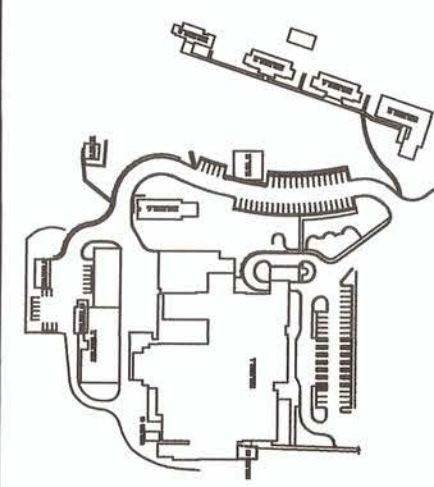

APPROVED:

APPROVED:

APPROVED:

APPROVED: SAFETY MANAGER

JUSTIN GREENE  
APPROVED: INFECTION CONTROL

APPROVED:

APPROVED: CHIEF, FACILITIES MANAGEMENT SERVICE LINE

JOHN MONTGOMERY  
APPROVED: ASSOCIATE DIRECTOR for PATIENT CARE SERVICES/EXECUTIVE NURSE

APPROVED: SERVICE LINE CHIEF

APPROVED: MEDICAL CENTER DIRECTOR

STACY J. VASQUEZ  
APPROVED: ASSOCIATE DIRECTOR

APPROVED: CHIEF OF STAFF

DRAWING TITLE:  
Building 10 - New Work Continuous Water monitoring System

PROJECT No.  
517-17-101

DATE  
8/16/2017

DRAWING No.  
M-101

DRAWN BY:  
JPP

CHECKED BY:  
KB, JH

PROJECT TITLE:  
Correct Water System for Legionella Phase 2

REV. SCALE  
NTS

NOT TO SCALE

PULLING FIRST VETERANS  
Medical Center Av  
200 Veterans Av  
Beckley, WV.  
25801