

PIPING -- GENERAL

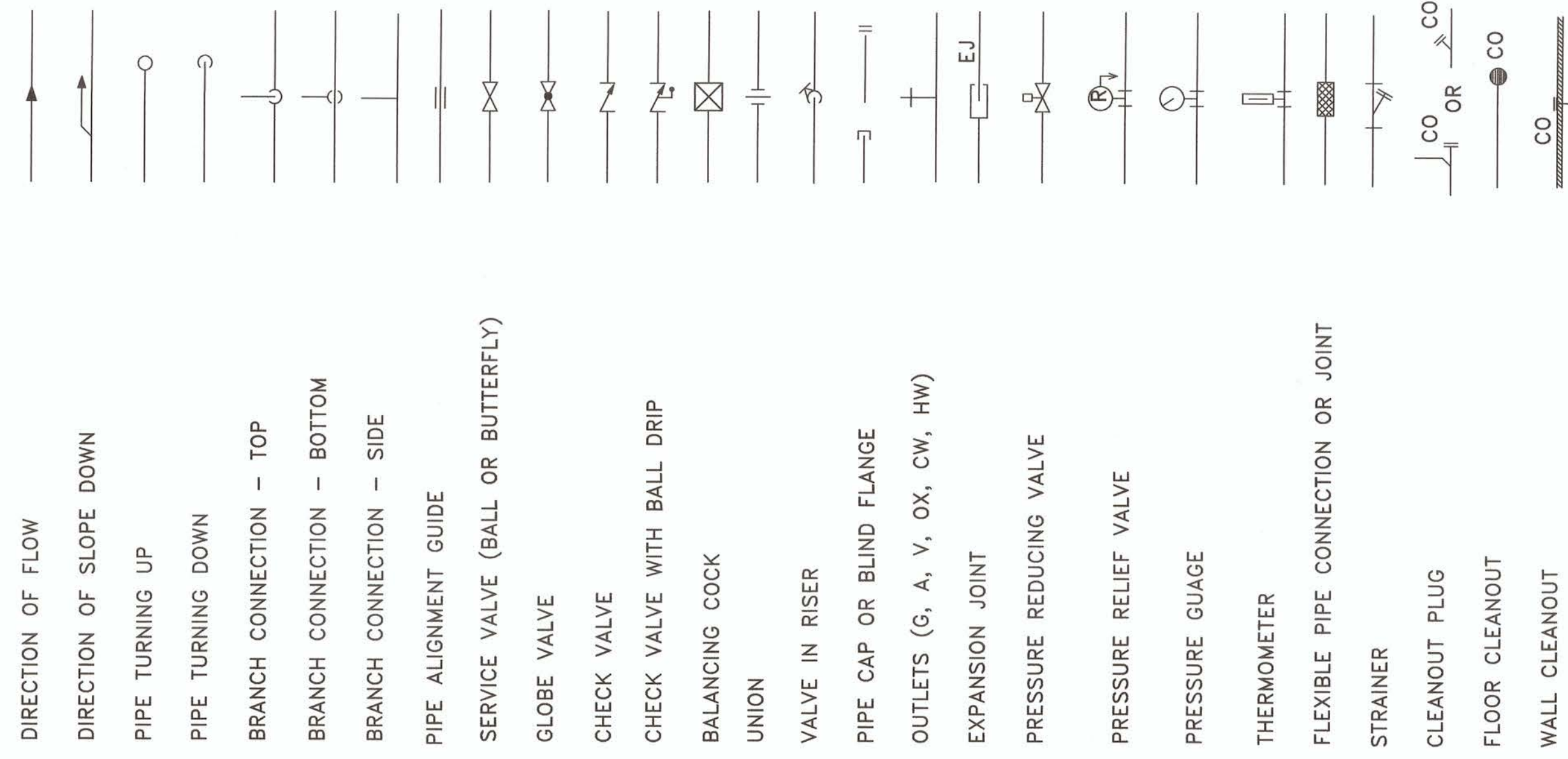

PIPING -- FIRE PROTECTION

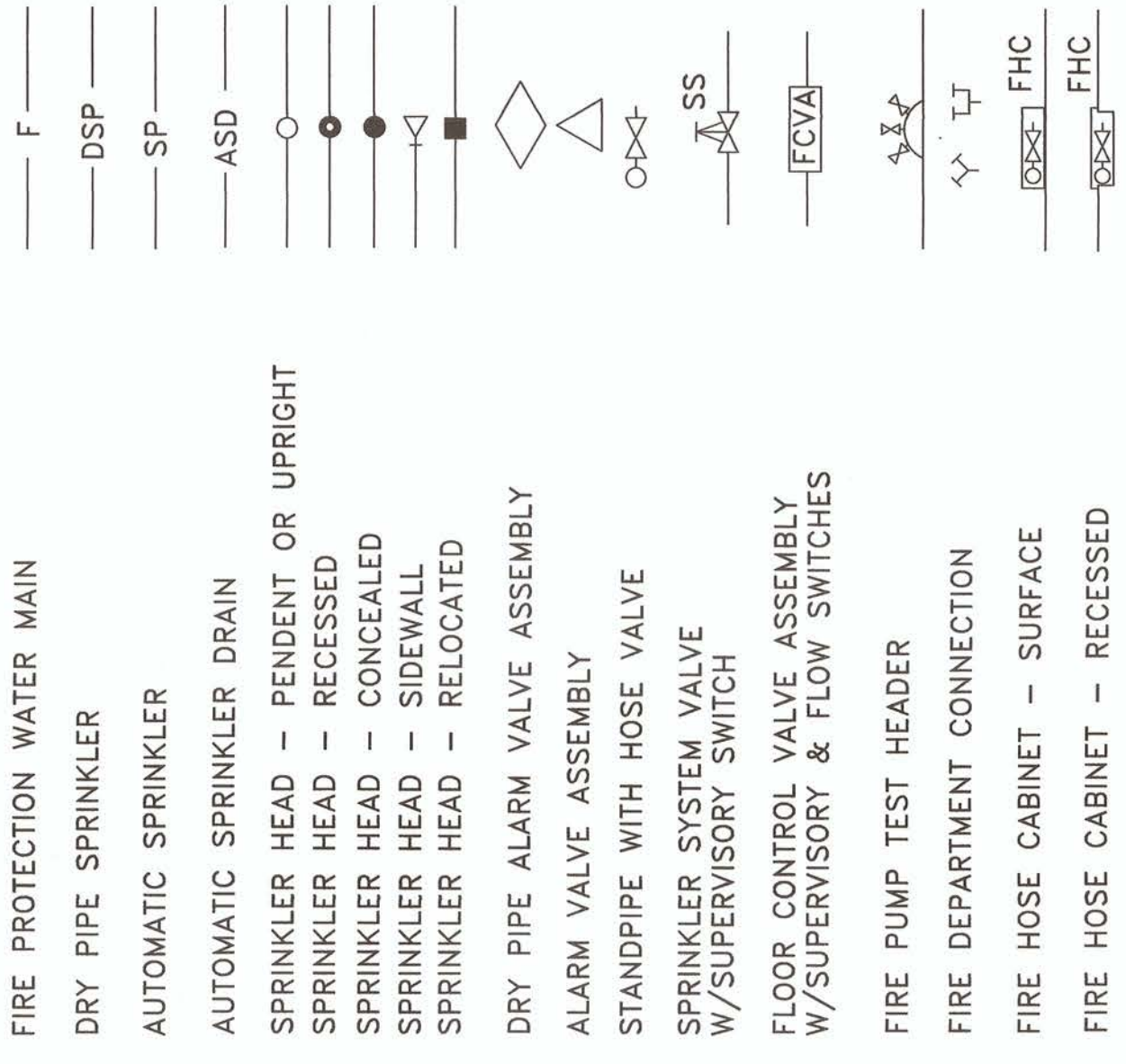

PLUMBING ABBREVIATIONS

AAV	AUTOMATIC AIR VENT
ABV	ABOVE
AD	ACCESS DOOR
ADCV	AUTOMATIC FLOW CONTROL VALVE
ADT	AIR TRANSFER DUCT
ATD	AIR TRANSFER DUCT
AV	ALARM VALVE
BEL	BELOW
BHP	BRAKE HORSEPOWER
BTH	BRITISH THERMAL UNIT
BTUH	BRITISH THERMAL UNIT/HOUR
CFM	CUBIC FEET PER MINUTE
CI	CAST IRON
CONC	CONCRETE
CO	CLEANOUT
CV	CUTOFF VALVE
CW	COLD WATER
DN	DOWN
DWV	DRAINAGE, WASTE AND VENT
ESA	EQUIPMENT SERVICE AREA
EW	ELECTRIC WATER COOLER
F	FIRE
FD	FLOOR DRAIN
FL	FLOOR
FR	FROM
FS	FLOOR SWITCH
FU	DRAINAGE FIXTURE UNIT
GAL	GALLON
GPD	GALLONS PER DAY
GPH	GALLONS PER HOUR
GPM	GALLONS PER MINUTE
HP	HORSEPOWER
HTR	HEATER
HW	HOT WATER
HWR	HOT WATER RETURN
HZ	FREQUENCY(CYCLES/SECOND)
HV	HOSE VALVE
HVC	HOSE VALVE CABINET
KW	KILOWATT
KWH	KILOWATT HOUR
LB/HR	POUNDS PER HOUR
LO	LOCKED OPEN
L	LAVATORY
MAY	MANUAL AIR VENT
MBH	BTUH IN THOUSANDS
NC	NORMALLY CLOSED
OFD	OVERFLOW DRAIN
ORC	OVERFLOW RAIN CONDUCTOR
OS&Y	OUTSIDE SCREW AND YOKE
PIV	POST INDICATOR VALVE
PRV	PRESSURE REDUCING VALVE
PSI	POUNDS PER SQUARE INCH
PVC	POLYVINYL CHLORIDE
RC	RAIN CONDUCTOR
RD	ROOF DRAIN
RPM	REVOLUTIONS PER MINUTE
RV	RELIEF VENT
SAN	SANITARY SEWER
SD	STORM DRAIN
SH	SHOWER
SP	SPRINKLER PIPE
SST	SOIL STACK
SVT	STACK VENT
SVTR	STACK VENT THRU ROOF
SS	SUPERVISORY SWITCH
S/S	STAINLESS STEEL
SV	SERVICE VALVE
SW	SWITCH
TC	TIMECLOCK
T*STAT	THERMOSTAT
V	VOLVENT
VAC	VACUUM
VS	VENT STACK
VE	VACUUM EXHAUST
VTR	VENT THRU ROOF
W	WASTE, WATTS
WM	WASHING MACHINE
WC	WATER CLOSET
WC	WATER CLOSET
WH	WALL HYDRANT (FEET OR INCHES)
WH	WALL HYDRANT
WHA	WATER HAMMER ARRESTOR
WS	WATER STOP
WST	WASTE STACK
WTR	WATER
Z	ZONE

MISCELLANEOUS



PIPING -- SPECIAL



PIPING -- PLUMBING

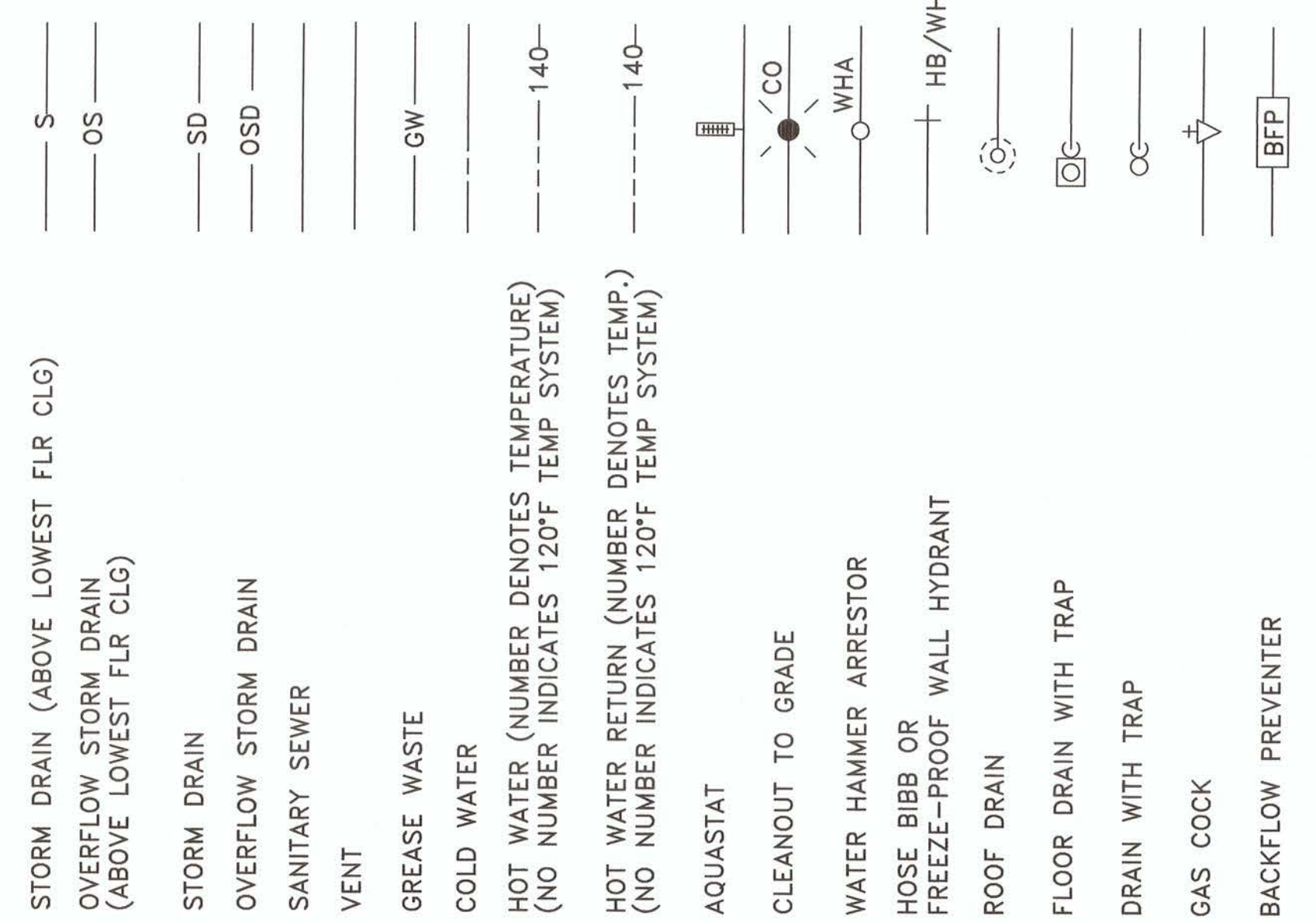

General Notes :

- All water outages must be scheduled in advance with COR.
- It is the contractor's responsibility to repair or replace any property damaged by the contractor during construction.
- Contractor shall supply VA with a schedule.
- It is the Contractor's responsibility to verify all Faucet types to determined which type of mixing valve is required.
- Contractor is to conduct water flushing after each water outage. Contractor to conduct chlorine test following each flushing and supply test results to COR.
- Contractor is to verify and supply under this contract type of adapter needed to connect stop to existing supply pipe.
- A two week notice is required for any water shut down.
- All plumbing installation is to be done by licensed certified plumbers.
- If any Asbestos is found, work is to stop and the COR is to be notified immediately.

Demolition Notes :

- Any piping, valves, etc demosed shall be recycled in a VA provided container. See COR for location of recycling container.

New Work Notes :

- Contractor to repair any damage to finishes after valves have been installed.
 - Contractor to clean room and advise COR before proceeding to next Room.
 - Contractor to install 1 mixing valve and 2 stops to all sinks indicated in mixing valve/room schedule on this sheet.
- Legend:
- Sink with new mixing valve and 2 - stops.

THESE SYMBOLS AND ABBREVIATIONS ARE PLUMBING DEPARTMENT STANDARDS AND MAY NOT NECESSARILY BE APPLICABLE TO OR APPEAR ON THESE DRAWINGS. HOWEVER WHEREVER THESE SYMBOLS DO OCCUR ON THE DRAWINGS, THE ITEM SHALL BE PROVIDED AND INSTALLED. SEE ARCHITECTURAL DRAWINGS FOR ADDITIONAL ABBREVIATIONS.

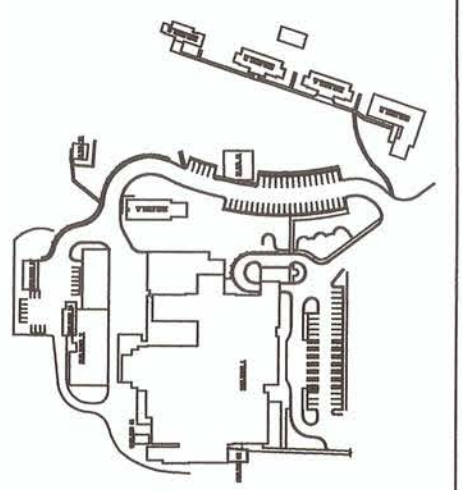

NOT TO SCALE

Medical Center
200 Veterans Av
Beckley, WV. 25801

DRAWING TITLE: LEGENDS, ABBREVIATIONS AND NOTES	DRAWING No. PL-100
PROJECT TITLE: Correct Water System for Legionella Phase 2	PROJECT No. 517-17-101
DATE 7/17/17	DRAWN BY: JPP
REV.	CHECKED BY: KB, JH
SCALE NTS	

APPROVED: MEDICAL CENTER DIRECTOR
STACY J VASQUEZ
APPROVED: ASSOCIATE DIRECTOR
JOHN D STOUT
APPROVED: CHIEF OF STAFF

APPROVED: CHIEF, FACILITIES MANAGEMENT SERVICE LINE
JOHN MONTGOMERY
APPROVED: ASSOCIATE DIRECTOR for PATIENT CARE SERVICES/EXECUTIVE NURSE
DEBRA LEGG, RN, MSN
APPROVED: SERVICE LINE CHIEF

APPROVED: SAFETY MANAGER
JUSTIN GREENE
APPROVED: INFECTION CONTROL
APPROVED:

APPROVED: