

Mixing Valve/Room Schedule		
Room No.	Sinks	Stops
2A-103A	1	2
2A-110A	1	2
2A-110B	1	2
2A-117	1	2
2A-118	1	2
2A-125	1	2
2A-141C	1	2
2A-149	1	2
2A-149	1	2
2A-151	1	2
2A-151	1	2
2A-154	1	2
2A-159	1	2
2A-161	2	4
2A-162	1	2
2A-167	1	2
2A-170	3	6
2A-171	1	2
2A-172	1	2
2A-173	1	2
2A-110	1	2
2A-112	1	2
2A-112	1	2
2B-136	1	2

\* - See Drawing PL-108 for Installation Diagram.

General Notes :

1. All water outages must be schedules in advance with COR.
2. It is the contractors responsibility to repair or replace any property damaged by the contractor during construction.
3. Contractor shall supply VA with a schedule.
4. It is the Contractors responsibility to verify all Faucet types to determined which type of mixing valve is required.
5. Contractor is to verify and supply under this contract type of adapter needed to connect stop to existing supply pipe.
- 6 A two week notice is required for any water shut down.
7. All plumbing installation is to be done by licensed certified plumbers.
8. If any Asbestos is found, the contractor is to stop work and notify the COR immediately.

Demolition Notes :

- ① Any piping, valves, etc demoesd shall be recycled in a VA provided container. See COR for location of recycling container.

New Work Notes :

- ② Contractor to repair any damage to finishes after valves have been installed. Finishes to match existing.
- ③ Contractor to clean room and advise COR before proceeding to next Room.
- ④ Contractor to install 1 mixing valve and 2 stops to all sinks indicated in mixing valve/room schedule on this sheet.

Legend:

- Ⓢ Sink with new mixing valve and 2 - stops.

SECOND FLOOR PLAN  
Building 1

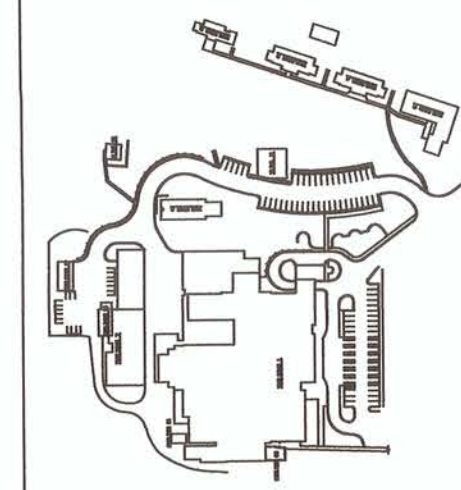

APPROVED:	APPROVED: SAFETY MANAGER	APPROVED: MEDICAL CENTER DIRECTOR	DRAWING TITLE: Second Floor - Mixing Valve Installation Locations	DRAWING No. PL-103
APPROVED:	JUSTIN GREENE APPROVED: INFECTION CONTROL	JOHN MONTGOMERY APPROVED: ASSOCIATE DIRECTOR for PATIENT CARE SERVICES/EXECUTIVE NURSE	PROJECT No. 517-17-101	PROJECT TITLE: Correct Water System for Legionella Phase 2
APPROVED:	APPROVED:	JOHN D. STOUT APPROVED: CHIEF OF STAFF	DRAWN BY: JPP	CHECKED BY: KB, JH

NOT TO SCALE

PUTTING  
WATERMANS  
FIRST  
Medical Center  
200 Veterans Av  
Beckley, WV.  
25801