

**General Notes :**

1. All water outages must be scheduled in advance with COR.
2. It is the contractor's responsibility to repair or replace any property damaged by the contractor during construction.
3. Contractor shall supply VA with a schedule.
4. A two week notice is required for any water shut down.
5. If any Asbestos is found, the contractor is to stop work and notify the COR immediately.

**New Work Notes :**

- (A) Remove existing DRV 80 is to be replaced with a new DRV 80 or equal.
- (B) A second DRV 80 or equal is to be installed in Parallel with existing DRV 80 that was replaced per One Line.
- (C) All piping, valves, couplers and associated plumbing to be installed and insulated per Specifications.
- (D) Valves and piping will need to be rearranged to accommodate new (replaced) DRV-80.

**Special note:**

All OWQM monitors are to be installed, tested and serviced by qualified manufacturer technicians.

**Special note:**

The DRV 80 Digital Re-circulation Valve or equal must be installed and serviced by their technical department.

**Characteristics of Digital recirculation valve**

- Connections - 3" NPT internal (female)
- Electronic module - PC/ABS
- Safety - Thermal shutdown upon inlet supply failure or power failure
- Pressure
  - Max inlet supply static - 150 psi
  - dynamic - 125 psi
- Temperature
  - Max hot water supply - 185 degrees F.
  - Min hot water supply - 75 degrees F. above set point
  - Max hot water supply - 125 degrees F.
  - Min set point 80 degrees F.
  - Min inlet cold water - 34 degrees F.
- Flow rate
  - Flow rate - 165 gpm @ 20 psi drop
  - Min recirc flow rate @ 10 gpm
- Power
  - Power supply - 110 VAC - 60 Hz

Thermal ratification  
 Aux. relay type - single pole changeover relay contacts  
 supply fuse - 20 amp  
 User can be able to adjust the valve using a Microsoft windows based laptop/PC computer with vendor supplied valve programming software.

**Legend:**

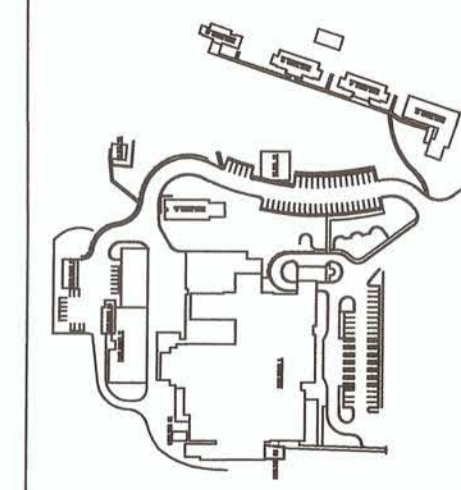
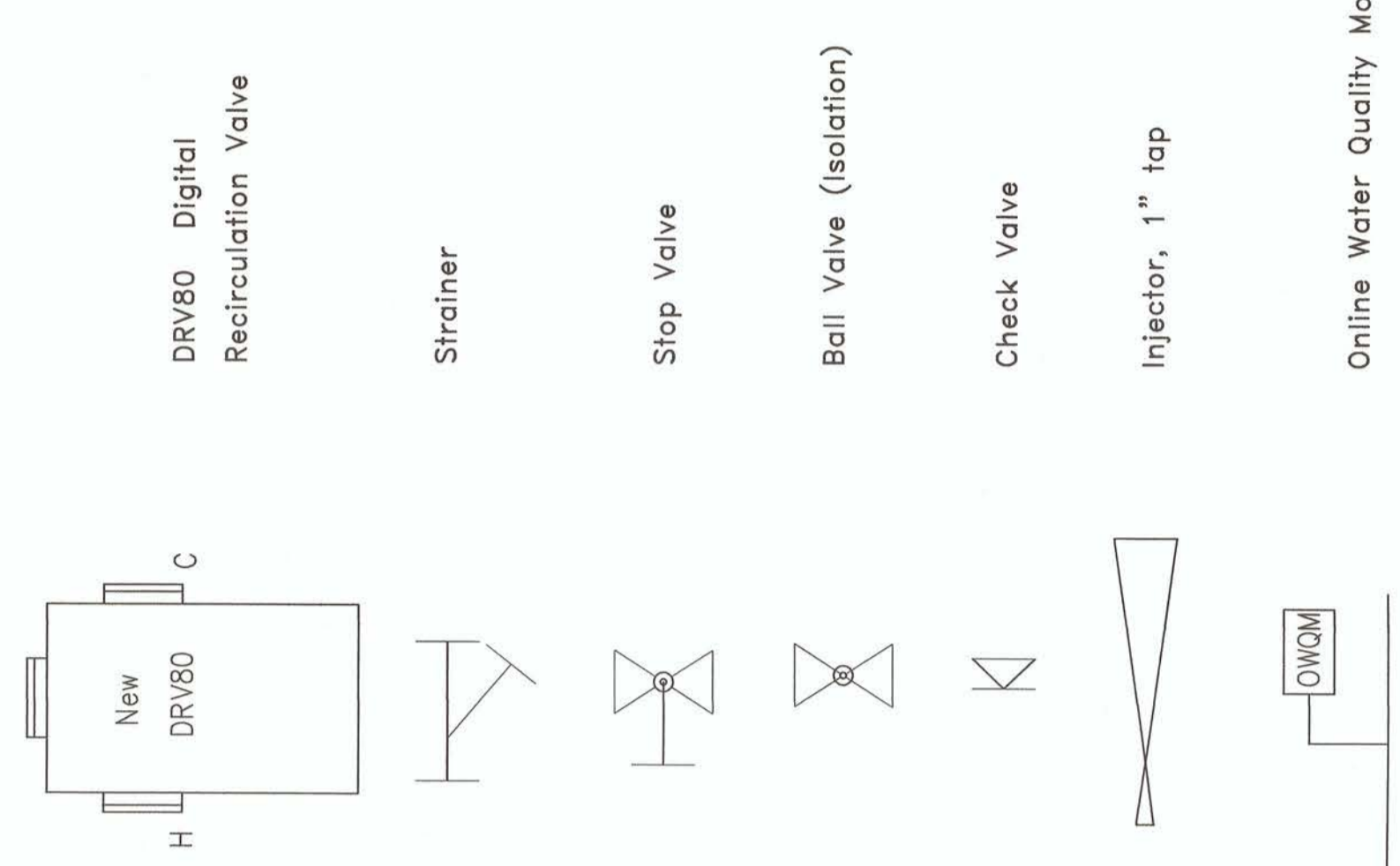

APPROVED:	APPROVED: SAFETY MANAGER	APPROVED: CHIEF, FACILITIES MANAGEMENT SERVICE LINE	APPROVED: MEDICAL CENTER DIRECTOR
APPROVED:	JUSTIN GREENE	APPROVED: ASSOCIATE DIRECTOR for PATIENT CARE SERVICES/EXECUTIVE NURSE	STACY J. VASQUES
APPROVED:	APPROVED: INFECTION CONTROL	DEBRA LEGG, RN, MSN	APPROVED: ASSOCIATE DIRECTOR
APPROVED:	APPROVED: SERVICE LINE CHIEF	APPROVED: SERVICE LINE CHIEF	JOHN D. STOUT
			APPROVED: CHIEF OF STAFF

DRAWING TITLE:	DRAWING No.
One-Line Diagram for Dual DRV, OWQM and Injector Installation	PL-109
PROJECT TITLE:	PROJECT No.
Correct Water System for Legionella Phase 2	517-17-101
DATE	DRAWN BY:
7/18/17	JPP
REV.	CHECKED BY:
SCALE	KB, JH
NTS	

NOT TO SCALE

Medical Center Av  
 200 Veterans Av  
 Beckley, WV. 25801

PUTTING  
 VETERANS  
 FIRST