

1	LABELLED / ASSUMED ACM PIPE INSULATION
2	WELDED SHEET VINYL FLOORING
3	HARD PLASTER SKIM COAT
3A	PLASTER BASE COAT
4	12" WHITE/BLUE-GREEN SPOT FLOOR
4A	FLOOR TILE MASTIC
5	SUSPENDED CEILING TILE

1	LABELLED / ASSUMED ACM PIPE INSULATION
2	WELDED SHEET VINYL FLOORING
3	HARD PLASTER SKIM COAT
3A	PLASTER BASE COAT
4	12" WHITE/BLUE-GREEN SPOT FLOOR
4A	FLOOR TILE MASTIC
5	SUSPENDED CEILING TILE

The floor plan shows a building layout with the following rooms and materials:

- Mechanical Room 4:** Contains materials 1, 2, and 3.
- Stair's:** Contains materials 3A and 3.
- Corridor 6:** Contains materials 3A and 3.
- Emergency Lighting Room 3:** Contains materials 3A and 3.
- Transformer Room 2:** Contains materials 3A and 3.
- (Old) Laundry Room 1:** Contains materials 3A, 3, and 1.
- (Old) Trunk Storage Room 5:** Contains materials 3A and 3.
- B-04:** Contains materials 4 and 5.

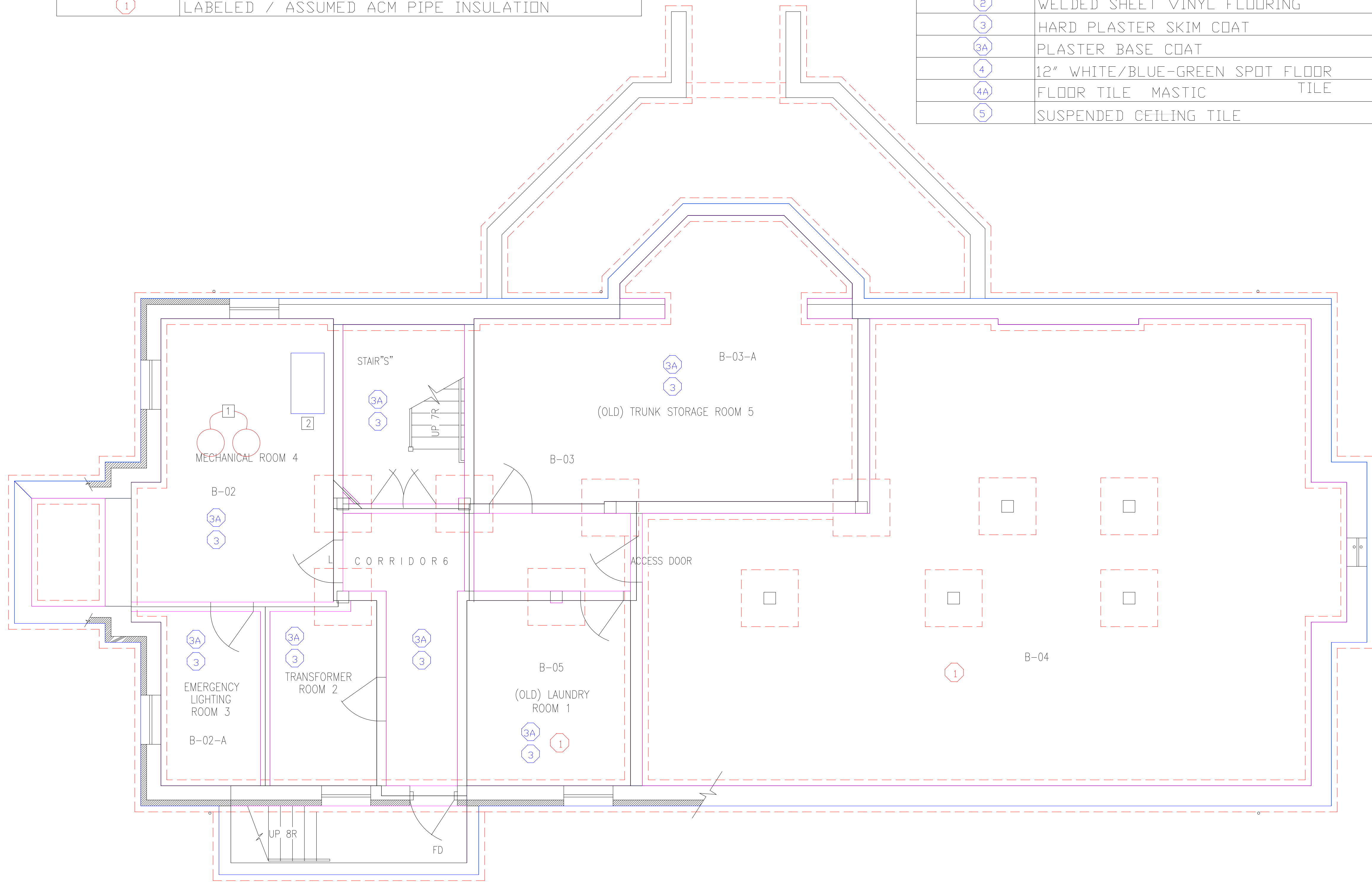

1	LABELLED / ASSUMED ACM PIPE INSULATION
2	WELDED SHEET VINYL FLOORING
3	HARD PLASTER SKIM COAT
3A	PLASTER BASE COAT
4	12" WHITE/BLUE-GREEN SPOT FLOOR
4A	FLOOR TILE MASTIC
5	SUSPENDED CEILING TILE

1	LABELLED / ASSUMED ACM PIPE INSULATION
2	WELDED SHEET VINYL FLOORING
3	HARD PLASTER SKIM COAT
3A	PLASTER BASE COAT
4	12" WHITE/BLUE-GREEN SPOT FLOOR
4A	FLOOR TILE MASTIC
5	SUSPENDED CEILING TILE

1	LABELLED / ASSUMED ACM PIPE INSULATION
2	WELDED SHEET VINYL FLOORING
3	HARD PLASTER SKIM COAT
3A	PLASTER BASE COAT
4	12" WHITE/BLUE-GREEN SPOT FLOOR
4A	FLOOR TILE MASTIC
5	SUSPENDED CEILING TILE