

VA MEDICAL CENTER CLC EXPANSION AND REMODELING

Fargo, North Dakota

Project Number 437-311

General Notes

- THE CLC PROJECT DELINEATED IN THESE DOCUMENTS GENERALLY OCCURS ON THE SECOND FLOOR WITH A THIRD FLOOR MECHANICAL PENTHOUSE. ADDITIONAL WORK IS INTERIOR COMPLETION OF EXISTING BASEMENT SHELL AND REMODELING OF FIRST FLOOR DENTAL AREA.
- SEE DRAWINGS AND SPECIFICATIONS FOR PHASING AND DESCRIPTION OF BIDS AND ALTERNATES.
- CONSTRUCTION OF THE CLC ADDITION AND REMODELING IS EXPECTED TO IMMEDIATELY AND SEAMLESSLY FOLLOW THE BASEMENT AND FIRST FLOOR OUTPATIENT ADDITION CONSTRUCTION BID UNDER SEPARATE CONTRACT AS IF THE TWO PROJECTS WERE A SINGLE PROJECT WITH ONE CONTRACTOR. EVEN THOUGH THE POSSIBILITY EXISTS WITH THE BID PROCESS THAT THERE COULD BE MULTIPLE AND DIFFERENT CONTRACTORS INVOLVED WITH EACH PROJECT.
- CONTRACTORS MUST PLAN FOR AND REFLECT THE ADDITIONAL COORDINATION AND COOPERATION IN SEQUENCING AND PHASING REQUIRED TO CONSTRUCT THE SEPARATE PROJECTS WHILE OCCUPYING THE SAME CONSTRUCTION SITE, ADDITION AND REMODELING.

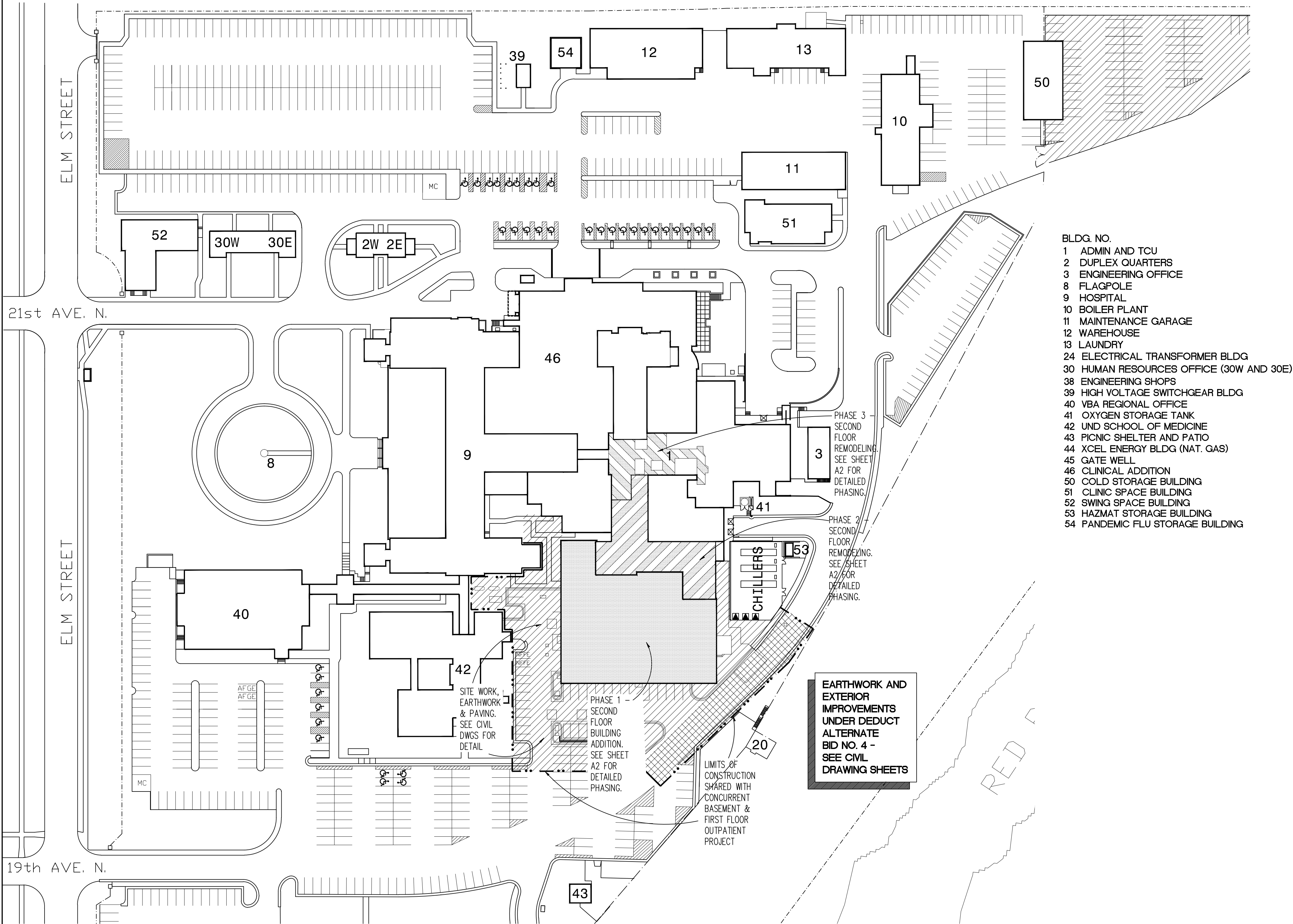

- BLDG. NO.
- 1 ADMIN AND TCU
 - 2 DUPLEX QUARTERS
 - 3 ENGINEERING OFFICE
 - 8 FLAGPOLE
 - 9 HOSPITAL
 - 10 BOILER PLANT
 - 11 MAINTENANCE GARAGE
 - 12 WAREHOUSE
 - 13 LAUNDRY
 - 24 ELECTRICAL TRANSFORMER BLDG.
 - 30 HUMAN RESOURCES OFFICE (30W AND 30E)
 - 38 ENGINEERING SHOPS
 - 39 HIGH VOLTAGE SWITCHGEAR BLDG.
 - 40 VBA REGIONAL OFFICE
 - 41 OXYGEN STORAGE TANK
 - 42 UND SCHOOL OF MEDICINE
 - 43 PICNIC SHELTER AND PATIO
 - 44 XCEL ENERGY BLDG (NAT. GAS)
 - 45 GATE WELL
 - 46 CLINICAL ADDITION
 - 50 COLD STORAGE BUILDING
 - 51 CLINIC SPACE BUILDING
 - 52 SWING SPACE BUILDING
 - 53 HAZMAT STORAGE BUILDING
 - 54 PANDEMIC FLU STORAGE BUILDING

EARTHWORK AND EXTERIOR IMPROVEMENTS UNDER DEDUCT ALTERNATE BID NO. 4 - SEE CIVIL DRAWING SHEETS

KEY TO SITE PLAN

- CONTRACTOR STAGING AREA. SHARED WITH VA AND OTHER CONTRACTORS.
- CONSTRUCTION AREA

SITE PLAN
1"=60'-0"

GENERAL

- X1 COVER SHEET
- X2 SYMBOLS, LEGEND, ABBREVIATIONS AND GENERAL NOTES

CIVIL

- C1 GRADING PLAN
- C2 PAVING PLAN
- C3 DETAILS

ARCHITECTURAL

- A1 BASEMENT AND FIRST FLOOR PHASING PLANS AND EXIST ANALYSIS
- A2 SECOND FLOOR PHASING PLANS
- A3 FIRST FLOOR DEMOLITION PLAN
- A4 SECOND FLOOR DEMOLITION PLAN - WING C
- A5 SECOND FLOOR DEMOLITION PLAN - WING D
- A6 BASEMENT PLANS
- A7 BASEMENT EQUIPMENT PLAN
- A8 BASEMENT EQUIPMENT PLAN
- A9 FIRST FLOOR PLAN
- A10 FIRST FLOOR EQUIPMENT PLAN
- A11 SECOND FLOOR PLAN - WING C
- A111 SECOND FLOOR DIMENSION PLAN - WING C
- A12 SECOND FLOOR PLAN - WING D
- A121 SECOND FLOOR DIMENSION PLAN - WING D
- A13 SECOND FLOOR EQUIPMENT PLAN
- A14 SECOND FLOOR EQUIPMENT PLAN
- A15 SECOND FLOOR EQUIPMENT PLAN
- A16 SECOND FLOOR EQUIPMENT PLAN
- A17 PENTHOUSE PLAN
- A18 ROOF PLAN
- A19 ROOM FINISH SCHEDULE
- A20 DOOR SCHEDULE
- A21 BUILDING ELEVATIONS
- A22 BUILDING ELEVATIONS
- A23 BUILDING SECTIONS
- A24 WALL SECTIONS
- A25 STAIR AND ELEVATOR PLANS AND SECTIONS
- A26 ACTIVITY INTERIOR ELEVATIONS
- A27 DINING INTERIOR ELEVATIONS
- A28 BASEMENT AND FIRST FLOOR INTERIOR ELEVATIONS
- A29 SECOND FLOOR INTERIOR ELEVATIONS
- A30 MILLWORK DETAILS
- A31 FIRST FLOOR REFLECTED CEILING DEMOLITION PLAN
- A32 SECOND FLOOR REFLECTED CEILING DEMOLITION PLAN - WING C
- A33 SECOND FLOOR REFLECTED CEILING DEMOLITION PLAN - WING D
- A34 BASEMENT REFLECTED CEILING PLAN
- A35 FIRST FLOOR REFLECTED CEILING PLAN
- A36 SECOND FLOOR REFLECTED CEILING PLAN - WING C
- A37 SECOND FLOOR REFLECTED CEILING PLAN - WING D

ASBESTOS ABATEMENT

- AB1 FIRST FLOOR ASBESTOS ABATEMENT PLAN
- AB2 SECOND FLOOR ASBESTOS ABATEMENT PLAN - WING C
- AB3 SECOND FLOOR ASBESTOS ABATEMENT PLAN - WING D

STRUCTURAL

- S1 EXISTING OUTPATIENT ROOF/SECOND FLOOR FRAMING PLAN
- S2 PENTHOUSE/SECOND FLOOR ROOF FRAMING PLAN
- S3 PENTHOUSE/CLERESTORY ROOF FRAMING PLAN
- S4 SECTIONS/DETAILS
- S5 SECTIONS/DETAILS
- S6 COLUMN SCHEDULE
- S7 COLUMN SCHEDULE
- S8 BRACING ELEVATIONS
- S9 SECTIONS/DETAILS

Code Data:

- NEPA 101 2009 EDITION
INTERNATIONAL BUILDING CODE 2009
- A. OCCUPANCY AND LOAD FACTOR:
1. BASEMENT: BUSINESS (100 SF/OCC)
 2. FIRST FLOOR: HEALTHCARE (100 SF/OCC)
 3. SECOND FLOOR: HEALTH CARE (SLEEPING DEPT.) 120SF/OCC
 4. PENTHOUSE (3RD FLOOR): MECHANICAL EQUIPMENT: 300 SF/OCC
- B. TYPE OF CONSTRUCTION: TYPE I (332)
- C. FIRE PROTECTION: FULLY SPRINKLERED
- D. ALLOWABLE AREA: UNLIMITED
- E. ALLOWABLE HEIGHT: UNLIMITED
- F. RATING REQUIREMENTS OF BUILDING ELEMENTS:
1. BEARING WALLS: NA
 2. STRUCTURAL FRAME (PRIMARY): 3 HOUR
 3. STRUCTURAL FRAME (PRIMARY): SUPPORTING ROOF ONLY: 2 HOUR
 4. FLOOR CONSTRUCTION (INCLUDING SECONDARY FRAMING): 2 HOUR
 5. ROOF CONSTRUCTION (INCLUDING SECONDARY FRAMING): 1 1/2 HOUR
 6. INTERIOR NON-BEARING WALLS: 0 HOURS
 7. EXTERIOR NON-BEARING WALLS
 8. VERTICAL OPENINGS (SHAFTS) < 3 STORES: 1 HOUR
- G. MISCELLANEOUS REQUIREMENTS:
1. SUBDIVISION OF BUILDING SPACES: MINIMUM 2 SMOKE COMPARTMENTS
 2. CORRIDOR FIRE PROTECTION: NOT REQUIRED; PREVENT SMOKE PASSAGE ONLY.

FIRE PROTECTION

- FP1 FIRST FLOOR FIRE PROTECTION DEMOLITION PLAN - WING D
- FP2 SECOND FLOOR FIRE PROTECTION DEMOLITION PLAN - WING C
- FP3 SECOND FLOOR FIRE PROTECTION DEMOLITION PLAN - WING D
- FP4 FIRST FLOOR FIRE PROTECTION PLAN - WING D
- FP5 SECOND FLOOR FIRE PROTECTION PLAN - WING C
- FP6 SECOND FLOOR FIRE PROTECTION PLAN - WING D
- FP7 PENTHOUSE FIRE PROTECTION PLAN - WING D

PLUMBING

- P1 BASEMENT PLUMBING DEMOLITION PLAN - WING C
- P2 FIRST FLOOR PLUMBING DEMOLITION PLAN - WING C
- P3 FIRST FLOOR PLUMBING DEMOLITION PLAN - WING D
- P4 SECOND FLOOR PLUMBING DEMOLITION PLAN - WING C
- P5 SECOND FLOOR PLUMBING DEMOLITION PLAN - WING D
- P6 THIRD FLOOR PLUMBING DEMOLITION PLAN - WING C
- P7 BASEMENT MEDICAL GAS DEMOLITION PLAN - WING D
- P8 FIRST FLOOR MEDICAL GAS DEMOLITION PLAN - WING D
- P9 SECOND FLOOR MEDICAL GAS DEMOLITION PLAN - WING C
- P10 SECOND FLOOR MEDICAL GAS DEMOLITION PLAN - WING D
- P11 BASEMENT PLUMBING PLAN - WING D
- P12 FIRST FLOOR PLUMBING PLAN - WING C
- P13 FIRST FLOOR PLUMBING PLAN - WING D
- P14 SECOND FLOOR PLUMBING PLAN - WING C
- P15 SECOND FLOOR PLUMBING PLAN - WING D
- P16 THIRD FLOOR PLUMBING PLAN - WING D
- P17 PENTHOUSE PLUMBING PLAN - WING D
- P18 BASEMENT MEDICAL GAS PLAN - WING D
- P19 FIRST FLOOR MEDICAL GAS PLAN - WING D
- P20 SECOND FLOOR MEDICAL GAS PLAN - WING C
- P21 SECOND FLOOR MEDICAL GAS PLAN - WING D

HVAC

- H1 BASEMENT HVAC PIPING DEMOLITION PLAN - WING D
- H2 FIRST FLOOR HVAC PIPING DEMOLITION PLAN - WING D
- H3 SECOND FLOOR HVAC PIPING DEMOLITION PLAN - WING C
- H4 SECOND FLOOR HVAC PIPING DEMOLITION PLAN - WING D
- H5 FIRST FLOOR VENTILATION DEMOLITION PLAN - WING D
- H6 SECOND FLOOR VENTILATION DEMOLITION PLAN - WING C
- H7 SECOND FLOOR VENTILATION DEMOLITION PLAN - WING D
- H8 BASEMENT HVAC PIPING PLAN - WING D
- H9 FIRST FLOOR HVAC PIPING PLAN - WING D
- H10 SECOND FLOOR HVAC PIPING PLAN - WING C
- H11 SECOND FLOOR HVAC PIPING PLAN - WING D
- H12 PENTHOUSE HVAC PIPING PLAN - WING D
- H13 BASEMENT VENTILATION PLAN - WING D
- H14 FIRST FLOOR VENTILATION PLAN - WING D
- H15 SECOND FLOOR VENTILATION PLAN - WING C
- H16 SECOND FLOOR VENTILATION PLAN - WING D
- H17 PENTHOUSE VENTILATION PLAN AND SECTION - WING D
- H18 MECHANICAL ROOF PLAN - WING C
- H19 MECHANICAL ROOF PLAN - WING D
- H20 HVAC PIPING SCHEMATIC - BASEMENT AND FIRST FLOOR WING D
- H21 HVAC PIPING SCHEMATIC - SECOND FLOOR WING C AND D
- H22 MECHANICAL SYMBOLS AND ABBREVIATIONS, PLUMBING RISERS, AND BASEMENT MECHANICAL ROOM SECTION
- H23 MECHANICAL DETAILS
- H24 MECHANICAL DETAILS
- H25 MECHANICAL SCHEDULES
- H26 MECHANICAL SCHEDULES
- H27 MECHANICAL CONTROL DIAGRAMS

ELECTRICAL

- E1 ELECTRICAL SYMBOLS LEGEND AND LUMINAIRE SCHEDULE
- E2 BASEMENT DEMOLITION PLAN - ELECTRICAL
- E3 FIRST FLOOR DEMOLITION PLAN - ELECTRICAL
- E4 SECOND FLOOR DEMOLITION PLAN - WING C - ELECTRICAL
- E5 SECOND FLOOR DEMOLITION PLAN - WING D - ELECTRICAL
- E6 BASEMENT REMODELING PLAN - LIGHTING
- E7 FIRST FLOOR REMODELING PLAN - LIGHTING
- E8 SECOND FLOOR REMODELING PLAN - WING C - LIGHTING
- E9 SECOND FLOOR REMODELING PLAN - WING D - LIGHTING
- E10 BASEMENT REMODELING PLAN - POWER
- E11 FIRST FLOOR REMODELING PLAN - POWER
- E12 SECOND FLOOR REMODELING PLAN - WING C - POWER
- E13 SECOND FLOOR REMODELING PLAN - WING D - POWER
- E14 BASEMENT REMODELING PLAN - SYSTEMS
- E15 FIRST FLOOR REMODELING PLAN - SYSTEMS
- E16 SECOND FLOOR REMODELING PLAN - WING C - SYSTEMS
- E17 SECOND FLOOR REMODELING PLAN - WING D - SYSTEMS
- E18 PENTHOUSE PLAN - LIGHTING, POWER AND SYSTEMS, ROOF PLAN - ELECTRICAL
- E19 EXISTING ELECTRICAL ONE-LINE DIAGRAM - BUILDING 1
- E20 REVISED ELECTRICAL ONE-LINE DIAGRAM - BUILDING 1
- E21 ELECTRICAL SCHEDULES
- E22 ELECTRICAL SCHEDULES
- E23 ELECTRICAL SCHEDULES
- E24 ELECTRICAL SCHEDULES
- E25 ELECTRICAL SCHEDULES



Dept. of Veterans Affairs
Medical Center
2101 Elm Street North
Fargo, ND 58102



IMAGE GROUP INC.
403 CENTER AVENUE, SUITE 300
MOOREHEAD, MN 56560

IMAGE GROUP INC., Architecture & Interiors
SOLIN & LARSON ENGINEERING, Structural Engineers
OBERMILLER NELSON ENGINEERING, Mechanical Engineers
MEN ENGINEERS, Electrical Engineers
TRIO ENVIRONMENTAL, Environmental Consultants

I hereby certify that this plan specification, or report was prepared by me or under my direct supervision, and that I am duly Registered Architect under the laws of the State of North Dakota.

Date 11/1/2011 Reg. No. 378

Drawing Title
COVER SHEET

VA Project No.
437-311

Building No.
1

Contract No.
VA263-P-0968
VA263-C-

AutoCAD File Name
X1_COVER

Project Title
VA MEDICAL CENTER
CLC EXPANSION AND REMODELING

Designed By
RM

Checked By
RM

Drawn By
KS

Location
VA MEDICAL CENTER
FARGO, ND

Date
NOVEMBER 1, 2011

AS SHOWN

Drawing No.
X1

Dwg 1 of 136



DRAFTING SYMBOLS

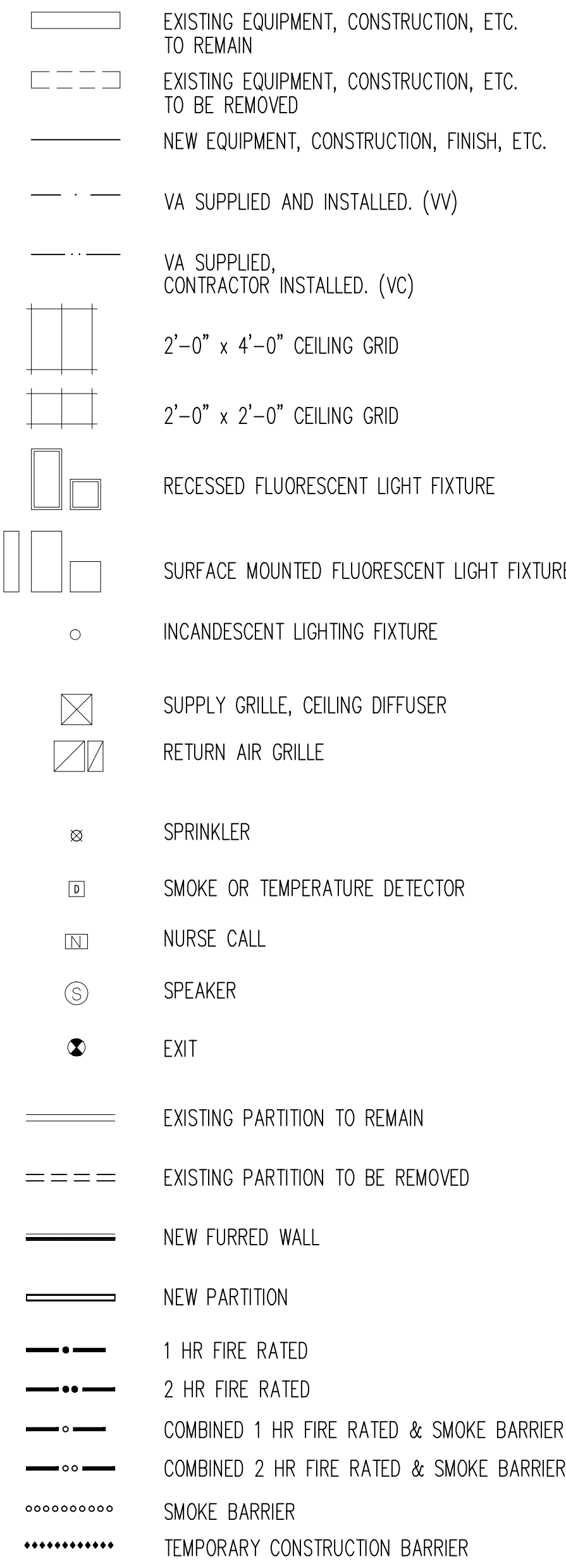
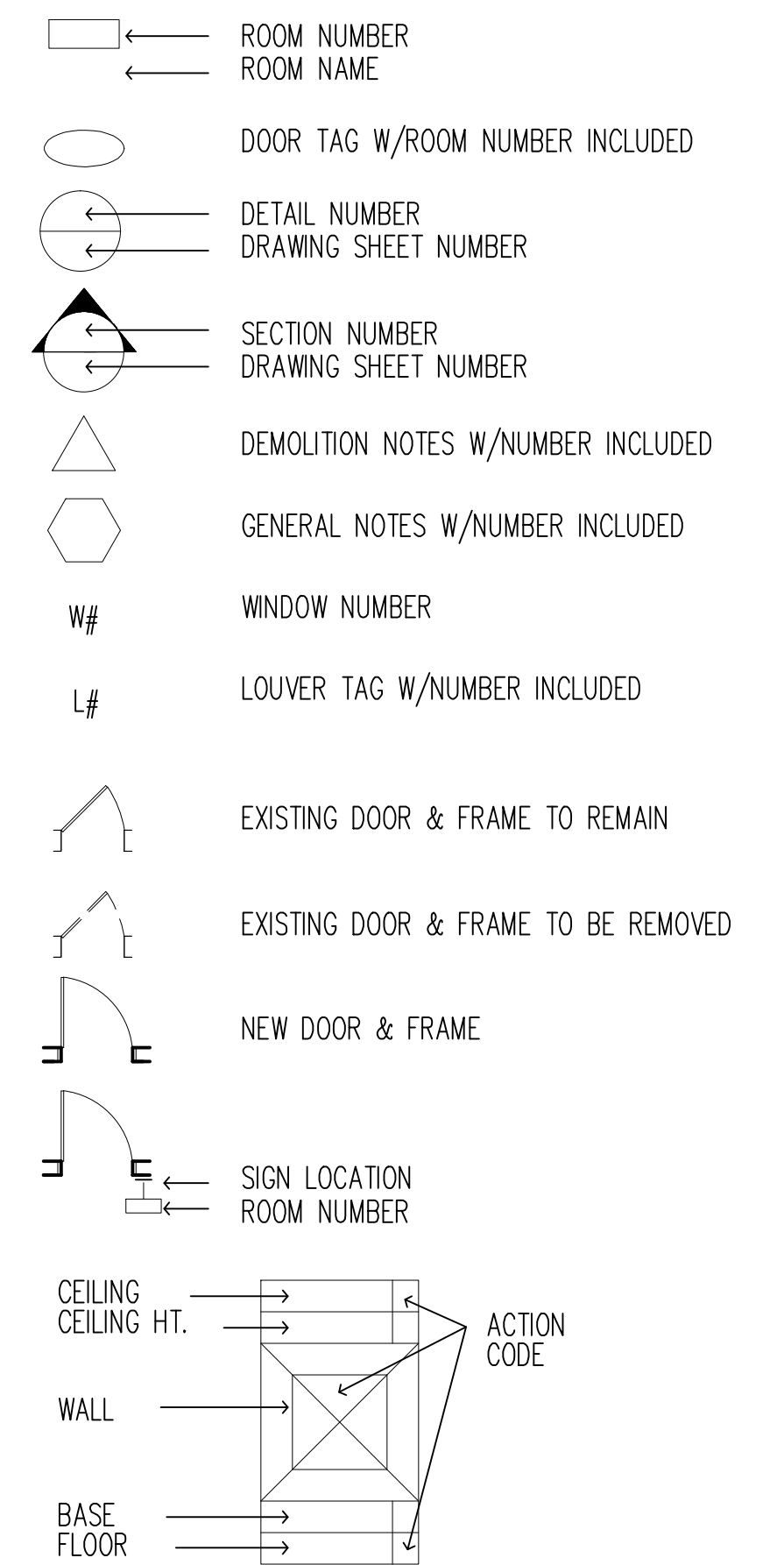

GENERAL MATERIALS

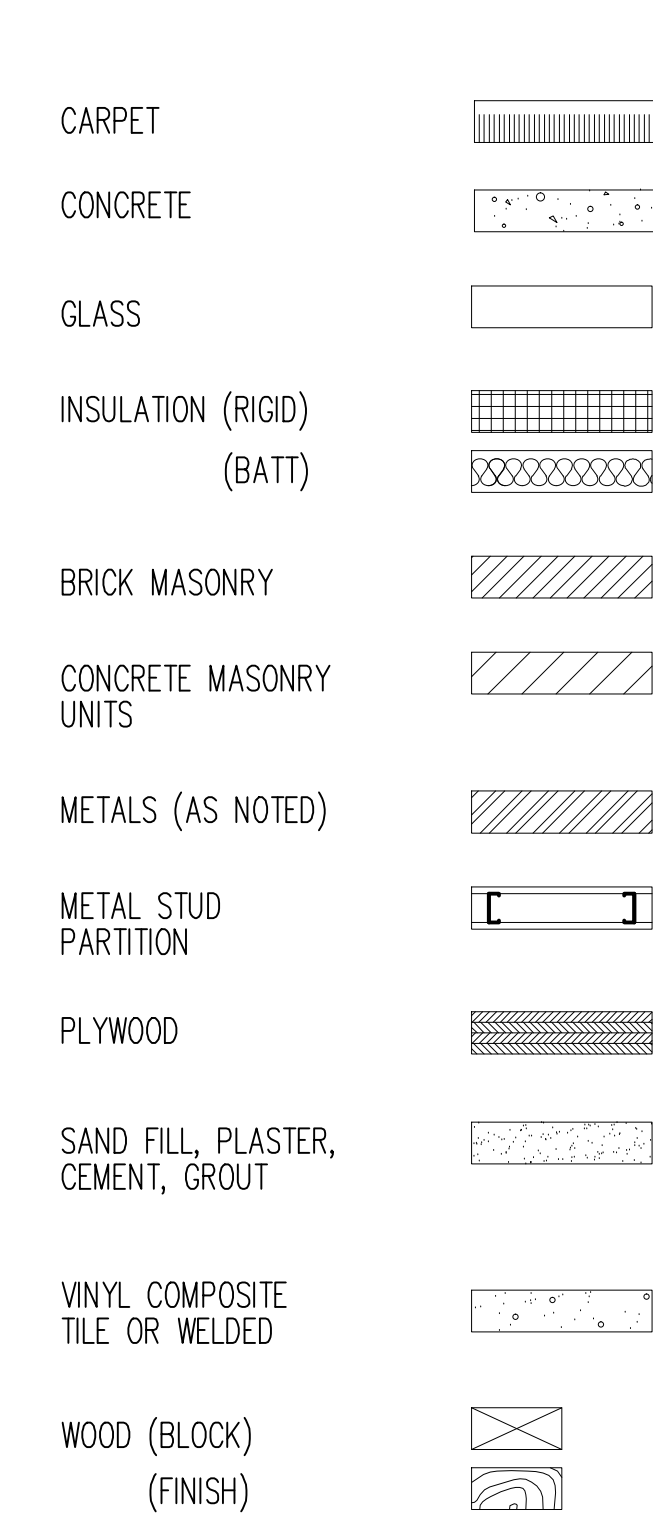

STANDARD ABBREVIATIONS

AB	ANCHOR BOLT	(N)	NEW
A/C	AIR CONDITIONED	NIC	NOT IN CONTRACT
ACT	ACOUSTICAL CEILING TILE	NL	NEOPRENE LATEX
AD	AIR CONDITIONING UNIT	NOM	NOMINAL
ADJ	ACCESS DOOR		
ADO	ADJUSTABLE	OC	ON CENTER
AFF	AUTOMATIC DOOR OPERATOR	OD	OUTSIDE DIMENSION
ALUM	ABOVE FINISHED FLOOR	OPG	OPENING
AP	ALUMINUM		
ARCH	ACCESS PANEL	P	PAINT
AT	ARCHITECTURAL	PART	PARTITION PARTIAL
	ACOUSTICAL TILE	PBPJ	PATIENT BEDSIDE POWER UNIT
		PH	PHARMACY FURNITURE
		PL	PLASTER
		PTD	PAPER TOWEL DISPENSER
		PMP	PREFINISHED METAL PARTITION
BB	BULLETIN BOARD	QT	QUARRY TILE
BD	BOARD		
BLDG	BUILDING		
CONC	CONCRETE		
CAB	CABINET		
CB	CHALK BOARD		
CC	MATERIAL & INSTALLATION BY CONTRACTOR	(R)	REMOVE
CCT	CUBICLE CURTAIN TRACK	RCP	RADIANT CEILING PANEL
CCU	CORONARY CARE UNIT	(REL)	RELOCATE(D)
CEM	CEMENT	REQ'D	REQUIRED
CI	CAST IRON	REV	REVERSE
CG	CORNER GUARD	RM	ROOM
CJ	CONTROL JOINT	RO	ROUGH OPENING
CLG	CEILING		
CLGL	CLEAR GLASS		
CLO	CLOSET	SBP	SMOKE BARRIER PARTITION
CMU	CONCRETE MASONRY UNIT	SCHED	SCHEDULE
COL	COLUMN	SFTU	STRUCTURAL FACING TILE UNIT
CONST	CONSTRUCTION	SIM	SIMILAR
CPT	CARPET	SSPSS	SPECIFIC ONE
CT	CERAMIC TILE	SS	STAINLESS STEEL
CTR	COUNTER	SV	SHEET VINYL
DET	DETAIL	TEL	TELEPHONE
DF	DRINKING FOUNTAIN	TER	TERAZZO
DIA	DIAMETER	TOIL	TOILET
DIAC	DIAGONAL		
DIW	DIMENSION	VIN	VINYL
DISP	DISPENSER	VC	MATERIAL BY V.A., INSTALLED BY CONTRACTOR
DL	DENTAL LABORATORY	VCT	VINYL COMPOSITION TILE
DS	DOWN SPOUT	VL	LAB FURNITURE
DSB	DOUBLE STRENGTH "B"	VP	VINYL PLANK
	QUALITY GLASS	VS	STERILIZATION EQUIPMENT
DW	DUMBWAITER	VV	MATERIAL AND INSTALLATION BY V.A.
DWG	DRAWING		
		W	WALL FABRIC
EEG	ELECTRO ENOPHALOGRAPHIC	WC	WATER CLOSET
EJ	EXPANSION JOINT	W/C	WHEEL CHAIR
EKG	ELECTRO CARDIOGRAPH	WD	WOOD
ELEV	ELEVATION, ELEVATOR	W	WROUGHT IRON
ELEC	ELECTRICAL	WVF	WELDED VINYL FLOORING
ENT	EAR, NOSE, & THROAT		
EP	ELECTRICAL PANEL		
EPY	EPOXY		
EQUIP	EQUIPMENT		
EXIST	EXISTING		
EXP	EXPOSED EXPANSION		
EXPS	EXPOSED STRUCTURE		
EXT	EXTERIOR		
EW	ELECTRICAL WATER COOLER		
EIFS	EXTERIOR INSULATION & FINISHING SYSTEM		
FAC	FIRE APPARATUS CLOSET		
FCU	FAN COIL UNIT		
FD	FLOOR DRAIN		
FI	FILM ILLUMINATOR		
FIN	FINISH		
FL	PHOTOGRAPHIC DARK ROOM EQUIPMENT		
FLASH	FLASHING		
FS	FULL SIZE		
FEC	FIRE EXTINGUISHER CABINET		
GA	GAUGE		
GALV	GALVANIZED		
GB	GRAB BAR		
GC	GENERAL CONTRACTOR		
GWB	GYPSUM WALL BOARD		
H	LABORATORY FUME HOOD		
HAC	HOUSEKEEPING AIDS CLOSET		
HM	HOLLOW METAL		
HT	HEIGHT		
HDW	HARDWARE		
HSP	HIGH STRENGTH PLASTER		
HW	LAB WASHING EQUIPMENT		
HR	HANDRAIL		
ICU	INTENSIVE CARE UNIT		
ID	INSIDE DIAMETER		
INSUL	INSULATION		
INT	INTERIOR		
IPU	ISOLATED POWER UNIT		
IV	INTRA-VENOUS		
JT	JOINT		
K	KITCHEN EQUIPMENT		
KC	KEEN'S CEMENT		
KIT	KITCHEN		
LAM	LAMINATE		
LAV	LAVATORY		
LIN	LINOLEUM		
MAX	MAXIMUM		
MECH	MECHANICAL		
MET	METAL		
MFR	MANUFACTURER		
MIN	MINIMUM		
MISC	MISCELLANEOUS		
MO	MASONRY OPENING		
MTD	MOUNTED		

GENERAL NOTES

THE FOLLOWING WILL APPLY, UNLESS OTHERWISE NOTED.

- CONTRACTORS STAGING AREA AND PARKING
 - LOCATION NEAR BUILDING NO. 50 EAST SIDE OF CHAINLINK FENCE TO BE USED FOR ALL EQUIPMENT, TRAILER AND VEHICLE PARKING. TO BE SHARED WITH VA AND OTHER CONTRACTORS.
 - OTHER STAGING AREAS TO BE COORDINATED WITH VA ON PER NEED BASIS.
 - RESTORE SITE TO ORIGINAL AND/OR BETTER CONDITION UPON CONSTRUCTION COMPLETION.
- WHERE EXISTING EQUIPMENT, PIPING, CONDUIT, DUCTS, ETC. ARE TO BE REMOVED, SUCH REMOVAL SHALL INCLUDE ALL ANCHORS, HANGERS, OR HARDWARE, ETC.
- WHERE EXISTING CEILINGS ARE TO BE REMOVED, SUCH REMOVAL SHALL INCLUDE ALL PLASTER, GYPSUM WALLBOARD, ACOUSTICAL TILE, ALL METAL LATH, SUPPORT CHANNELS, CEILING TEES, AND HANGER WIRE, UNLESS OTHERWISE NOTED.
- NEW WORK SHALL LINE WITH AND MATCH EXISTING WORK EXCEPT WHERE OTHERWISE DIMENSIONED OR DETAILED.
- WHERE THE FLOOR SURFACE IS NOT EVEN BETWEEN EXISTING ROOMS WHICH ARE BEING CONSOLIDATED INTO ONE NEW ROOM, THE FLOOR SURFACES SHALL BE MADE EVEN IN PREPARATION FOR THE NEW CONTINUOUS FLOOR FINISH AT NO ADDITIONAL COST TO THE GOV'T.
- ALL EXISTING HOLES IN EXISTING FLOOR OR ATTIC SLABS WHICH ARE NOT BEING USED FOR NEW VERTICAL PIPING, DUCTS, CONDUIT, ETC., SHALL BE CLOSED WITH CONCRETE TO THE FULL DEPTH OF THE EXISTING SLAB.
- ALL NEW HORIZONTAL AND VERTICAL PIPING, DUCTS AND CONDUIT REQUIRED BY THIS CONTRACT, SHALL BE RUN CONCEALED FROM VIEW (EXCEPT IN MECHANICAL EQUIPMENT ROOMS, TELEPHONE CLOSETS, SIGNAL CLOSETS, ELECTRICAL CLOSETS, AND ELECTRICAL EQUIPMENT ROOMS). PROVIDE FURRING AS NECESSARY. SUCH FURRING WHETHER AT WALLS OR CEILINGS, SHALL BE FINISHED TO MATCH NEW AND/OR EXISTING ADJACENT SURFACES. THE CONTRACTOR SHALL REFER TO ALL HVAC, ELECTRICAL AND PLUMBING DRAWINGS TO DETERMINE WHERE ANY SUCH PIPES, DUCTS OR CONDUIT OCCUR.
- NEW FINISHES APPLIED PATCH TO MATCH TO EXISTING FLOORS, WALLS AND PARTITIONS. IF FINISH CANNOT BE MATCHED, ALL NEW FINISH SHALL BE PROVIDED AT NO ADDITIONAL COST TO THE GOV'T.
- WHERE EXISTING CT FINISH IS BEING REMOVED, A CONCRETE TOPPING SHALL BE APPLIED TO THE REMAINING FLOOR SURFACE TO MAKE IT SMOOTH AND EVEN IN PREPARATION FOR THE APPLICATION OF A NEW CONTINUOUS FLOOR FINISH.
- ALL PARTITIONS, UNLESS OTHERWISE SHOWN OR DETAILED, SHALL BE METAL STUDS AND OF THICKNESS TO ADEQUATELY COVER PIPING, CONDUITS, ETC.
- ALL DIMENSIONS ARE TO THE CENTER LINE OF NEW STUD WALLS AND NEW COLUMNS. EXISTING WALLS, EXISTING COLUMNS AND NEW MASONRY WALLS ARE DIMENSIONED TO THE FACE OF FINISH.
- ALL EXISTING PARTITIONS WITHIN THE REMODELING AREAS WHICH ARE DESIGNATED FIRE RATED PARTITIONS SHALL BE IMPROVED TO CONFORM TO THE STANDARDS FOR NEW FIRE RATED PARTITIONS AS FOLLOWS:

FIRE RATED EXISTING PARTITIONS TO REMAIN SHALL BE CONTINUOUS FROM THE FLOOR SLAB TO THE UNDERSIDE OF THE FLOOR OR ROOF SLAB ABOVE, INCLUDING CONTINUITY THROUGH THE CONCEALED SPACE ABOVE THE SUSPENDED CEILING. ALL EDGES SHALL BE CAULKED CONTINUOUSLY AND SEALED TIGHTLY. PARTITIONS SHALL BE TIGHTLY FITTED AND SEALED AROUND ALL PENETRATIONS SUCH AS DUCTS, PIPES, CONDUIT AND AROUND ALL FRAMING MEMBERS SUCH AS BEAMS, JOISTS AND CONCRETE RIBS.
- PROVIDE A VINYL STRIP UNDER ALL DOORS WHERE NEW OR EXISTING FINISHES AND ADJACENT FLOORS ARE AT DIFFERENT LEVELS AND WHERE ADJACENT FLOOR FINISHES ARE OF DIFFERENT MATERIALS. UNLESS OTHERWISE DETAILED.
- UNLESS OTHERWISE SHOWN ON THE REFLECTED CEILING PLANS, ALL ACOUSTICAL CEILING TILE GRIDS SHALL BE CENTERED IN EACH ROOM WITH EITHER A TILE OR GRID AT THE CENTER.
- UNLESS OTHERWISE DETAILED, WHERE EXISTING WALLS OR PARTITIONS ARE REMOVED AND A DIFFERENCE IN CEILING HEIGHTS OCCURS IN ONE ROOM OR AREA, THE SPACE BETWEEN THE CEILING SHALL BE SQUARED OFF HORIZONTALLY AND VERTICALLY WITH FURRING CHANNELS AND FINISHED WITH THE MATERIALS AS CALLED FOR BY THE INDICATED ROOM FINISH.
- EXISTING DOORS, WHICH SWING INTO ROOMS WHERE NEW FLOOR FINISH IS ABOVE ADJACENT FLOORS, SHALL BE CUT OFF NO MORE THAN 3/4" GAP AT BOTTOM TO CLEAR NEW FINISHED FLOOR.
- WORK AT THE DISCRETION OF THE VA MAY BE SHUT DOWN AND RESCHEDULED BY DUE TO CRITICAL AREAS OR SPECIAL NEEDS OF PATIENTS AND STAFF.
- CONTRACTOR TO VERIFY ALL EXISTING SITE CONDITIONS.
- CONTRACTOR TO PROVIDE PROTECTION AGAINST DAMAGE, INCLUDING WATER PENETRATION, TO EXISTING STRUCTURE AND FINISHES WHERE DEMOLITION AND NEW CONSTRUCTION OCCURS.
- ALL EXISTING EQUIPMENT, SIGNAGE AND ART SALVAGED FOR REUSE TO BE REINSTALLED BY CONTRACTOR AT SAME LOCATIONS IF POSSIBLE. UTILIZE ALTERNATE LOCATIONS AT OWNER'S DISCRETION.



Dept. of Veterans Affairs
Medical Center
2101 Elm Street North
Fargo, ND 58102



IMAGE GROUP INC., Architecture & Interiors
SOLEN & LARSON ENGINEERING, Structural Engineers
OBERMILLER NELSON ENGINEERING, Mechanical Engineers
MEN ENGINEERS, Electrical Engineers
TRIO ENVIRONMENTAL, Environmental Consultants

I hereby certify that this plan specification, or report was prepared by me or under my direct supervision, and that I am duly Registered Architect under the laws of the State of North Dakota.
Rebecca Mearns
Date 11/1/2011 Reg. No. 378

Drawing Title SYMBOLS, LEGEND, ABBREVIATIONS AND GENERAL NOTES		Project Title VA MEDICAL CENTER CLC EXPANSION AND REMODELING		Date NOVEMBER 1, 2011
VA Project No. 437-311	Contract No. VA263-P-0968 VA263-C-	Designed By RM	Checked By RM	Drawing No. X2
Building No. 1	AutoCAD File Name X2_LEGEND	Location VA MEDICAL CENTER FARGO, ND		Dwg 2 of 136

Department of Veterans Affairs