

1
three inches = one foot
6"

1
one and one half inches = one foot
6"

2
one inch = one foot
6"

2
three quarters inch = one foot
6"

4
one half inch = one foot
6"

4
three eighths inch = one foot
6"

8
one quarter inch = one foot
6"

16
one eighth inch = one foot
6"

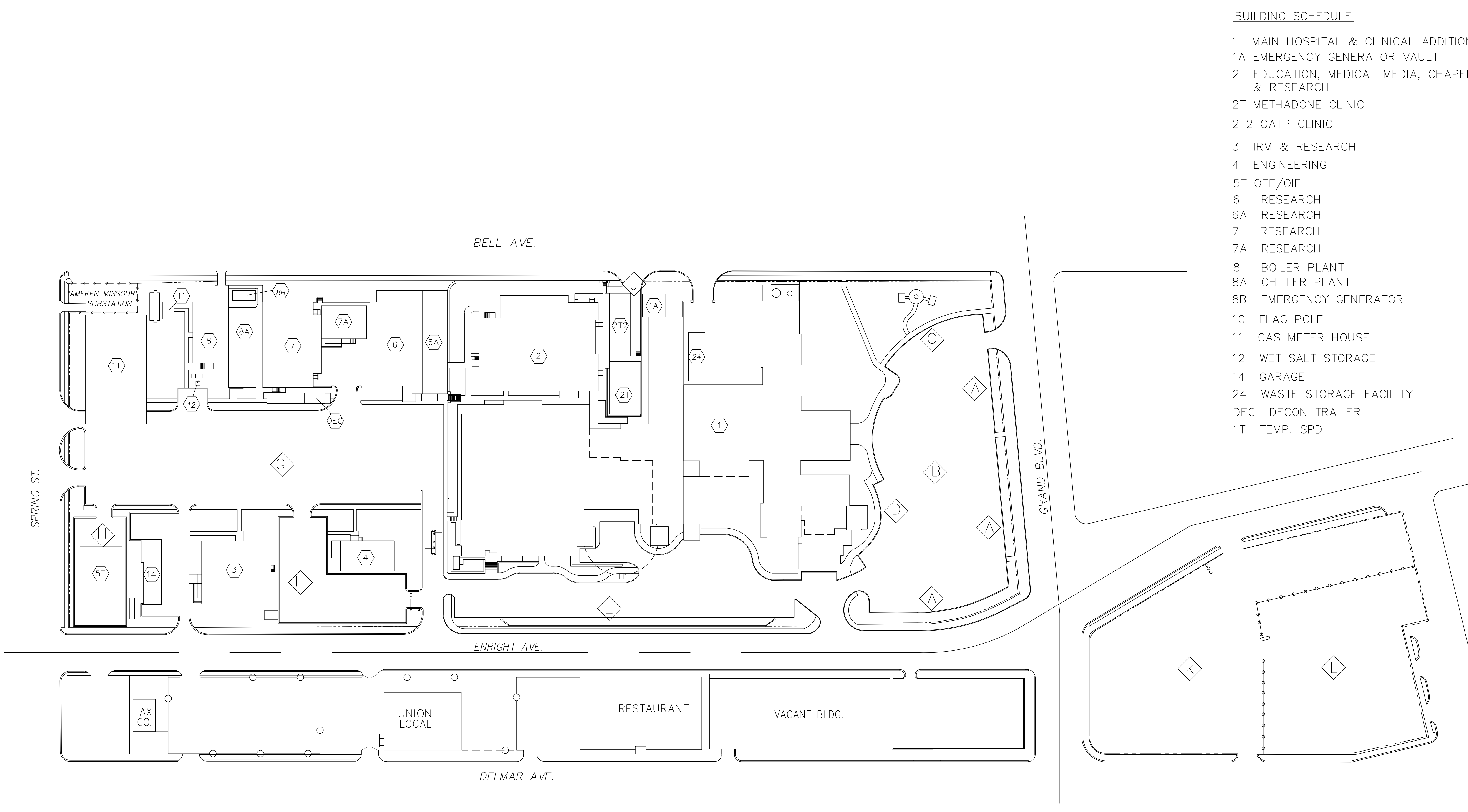

BUILDING SCHEDULE

- 1 MAIN HOSPITAL & CLINICAL ADDITION
- 1A EMERGENCY GENERATOR VAULT
- 2 EDUCATION, MEDICAL MEDIA, CHAPEL & RESEARCH
- 2T METHADONE CLINIC
- 2T2 OATP CLINIC
- 3 IRM & RESEARCH
- 4 ENGINEERING
- 5T OEF/OIF
- 6 RESEARCH
- 6A RESEARCH
- 7 RESEARCH
- 7A RESEARCH
- 8 BOILER PLANT
- 8A CHILLER PLANT
- 8B EMERGENCY GENERATOR
- 10 FLAG POLE
- 11 GAS METER HOUSE
- 12 WET SALT STORAGE
- 14 GARAGE
- 24 WASTE STORAGE FACILITY
- DEC DECON TRAILER
- 1T TEMP. SPD

PLOT PLAN

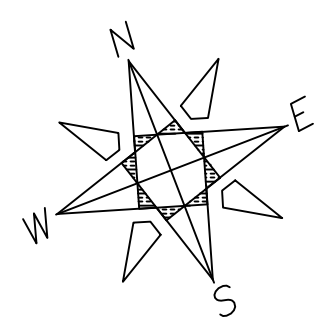

SCALE: 1" = 50'-0"

AS-BUILT

		CONSULTANTS:		ARCHITECT/ENGINEERS:		Drawing Title Site Plan		Project Title As-Built Plans		Project Number 000		Office of Construction and Facilities Management		
								Building Number 00						
						Approved: Project Director		Location John Cochran VAHCS		Drawing Number				
								Date June 2012		Checked MH	Drawn KRC		G1101 Dwg. # of --	
Revisions:	Date													