

three inches = one foot  
one and one half inches = one foot  
one inch = one foot  
three quarters inch = one foot  
one half inch = one foot  
three eighths inch = one foot  
one quarter inch = one foot  
one eighth inch = one foot

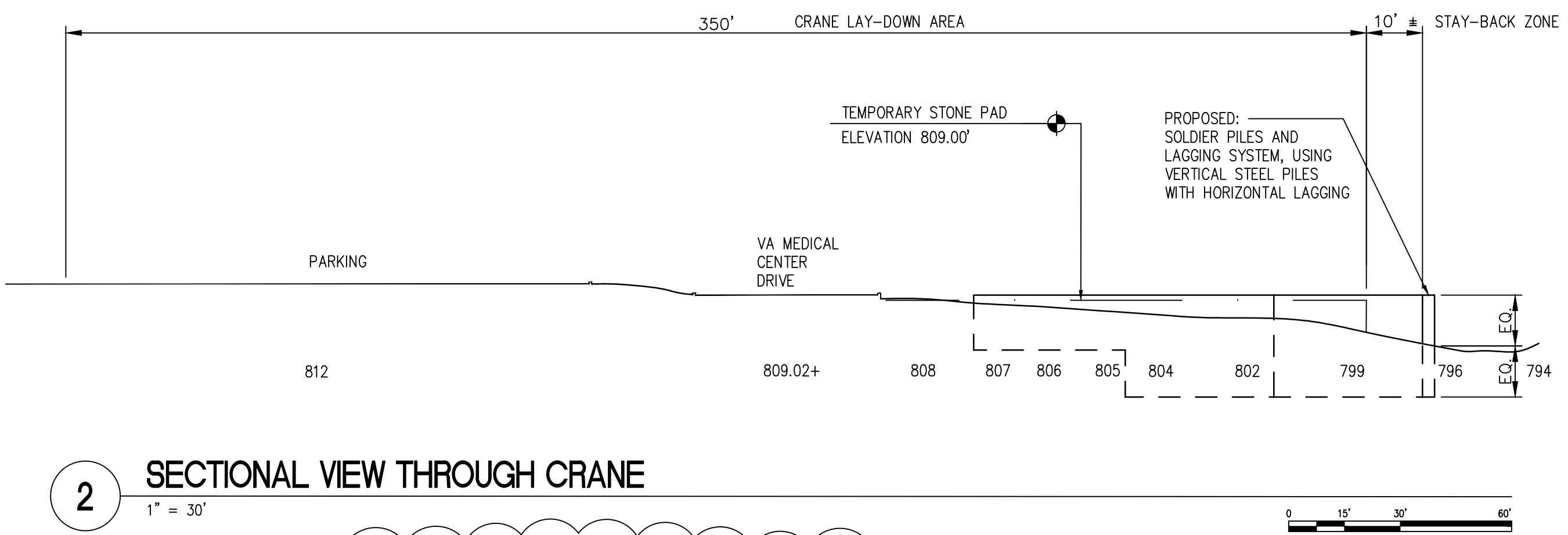
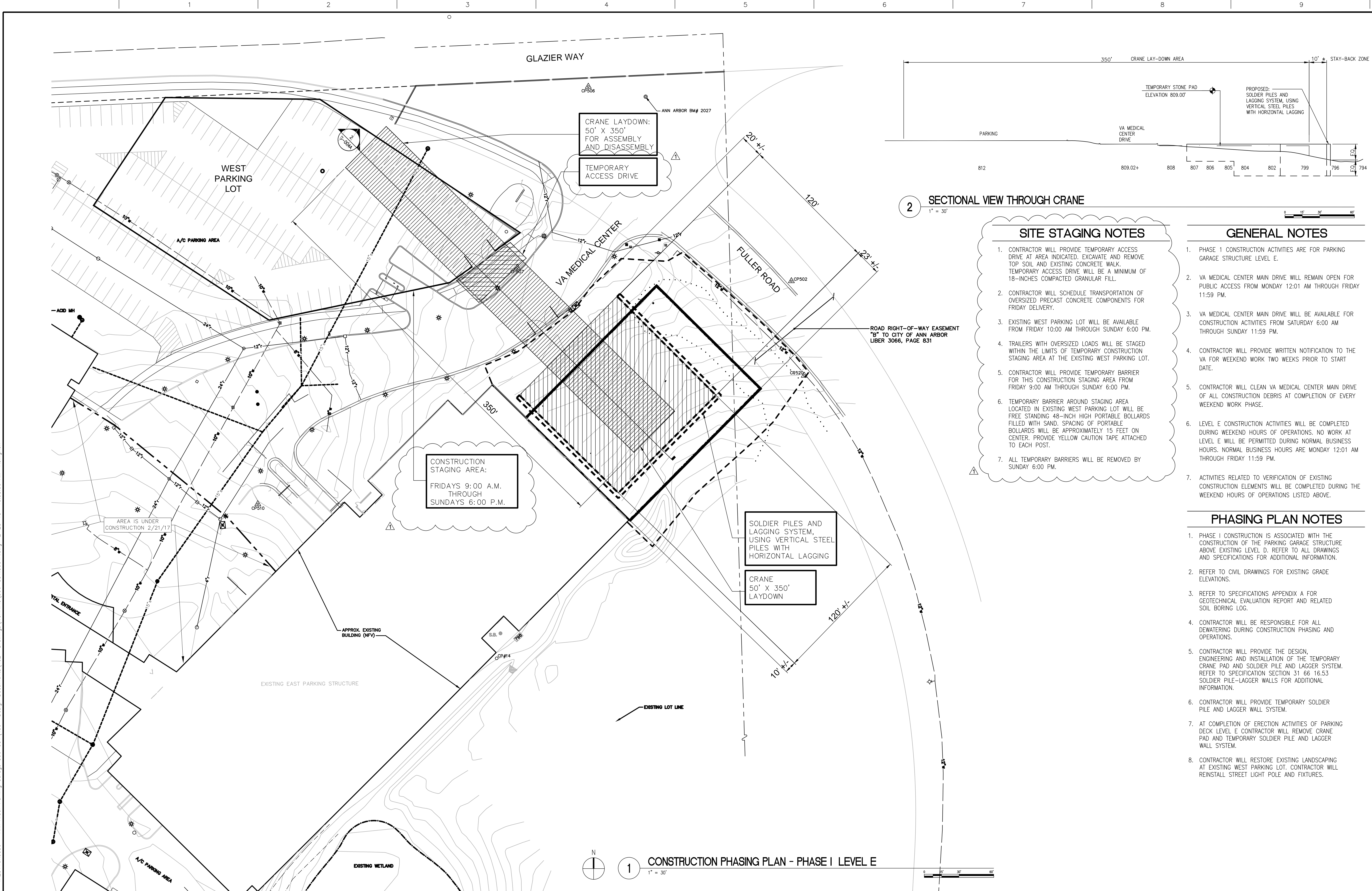

- ### SITE STAGING NOTES
- CONTRACTOR WILL PROVIDE TEMPORARY ACCESS DRIVE AT AREA INDICATED. EXCAVATE AND REMOVE TOP SOIL AND EXISTING CONCRETE WALK. TEMPORARY ACCESS DRIVE WILL BE A MINIMUM OF 18-INCHES COMPACTED GRANULAR FILL.
  - CONTRACTOR WILL SCHEDULE TRANSPORTATION OF OVERSIZED PRECAST CONCRETE COMPONENTS FOR FRIDAY DELIVERY.
  - EXISTING WEST PARKING LOT WILL BE AVAILABLE FROM FRIDAY 10:00 AM THROUGH SUNDAY 6:00 PM.
  - TRAILERS WITH OVERSIZED LOADS WILL BE STAGED WITHIN THE LIMITS OF TEMPORARY CONSTRUCTION STAGING AREA AT THE EXISTING WEST PARKING LOT.
  - CONTRACTOR WILL PROVIDE TEMPORARY BARRIER FOR THIS CONSTRUCTION STAGING AREA FROM FRIDAY 9:00 AM THROUGH SUNDAY 6:00 PM.
  - TEMPORARY BARRIER AROUND STAGING AREA LOCATED IN EXISTING WEST PARKING LOT WILL BE FREE STANDING 48-INCH HIGH PORTABLE BOLLARDS FILLED WITH SAND. SPACING OF PORTABLE BOLLARDS WILL BE APPROXIMATELY 15 FEET ON CENTER. PROVIDE YELLOW CAUTION TAPE ATTACHED TO EACH POST.
  - ALL TEMPORARY BARRIERS WILL BE REMOVED BY SUNDAY 6:00 PM.

- ### GENERAL NOTES
- PHASE 1 CONSTRUCTION ACTIVITIES ARE FOR PARKING GARAGE STRUCTURE LEVEL E.
  - VA MEDICAL CENTER MAIN DRIVE WILL REMAIN OPEN FOR PUBLIC ACCESS FROM MONDAY 12:01 AM THROUGH FRIDAY 11:59 PM.
  - VA MEDICAL CENTER MAIN DRIVE WILL BE AVAILABLE FOR CONSTRUCTION ACTIVITIES FROM SATURDAY 6:00 AM THROUGH SUNDAY 11:59 PM.
  - CONTRACTOR WILL PROVIDE WRITTEN NOTIFICATION TO THE VA FOR WEEKEND WORK TWO WEEKS PRIOR TO START DATE.
  - CONTRACTOR WILL CLEAN VA MEDICAL CENTER MAIN DRIVE OF ALL CONSTRUCTION DEBRIS AT COMPLETION OF EVERY WEEKEND WORK PHASE.
  - LEVEL E CONSTRUCTION ACTIVITIES WILL BE COMPLETED DURING WEEKEND HOURS OF OPERATIONS. NO WORK AT LEVEL E WILL BE PERMITTED DURING NORMAL BUSINESS HOURS. NORMAL BUSINESS HOURS ARE MONDAY 12:01 AM THROUGH FRIDAY 11:59 PM.
  - ACTIVITIES RELATED TO VERIFICATION OF EXISTING CONSTRUCTION ELEMENTS WILL BE COMPLETED DURING THE WEEKEND HOURS OF OPERATIONS LISTED ABOVE.

- ### PHASING PLAN NOTES
- PHASE I CONSTRUCTION IS ASSOCIATED WITH THE CONSTRUCTION OF THE PARKING GARAGE STRUCTURE ABOVE EXISTING LEVEL D. REFER TO ALL DRAWINGS AND SPECIFICATIONS FOR ADDITIONAL INFORMATION.
  - REFER TO CIVIL DRAWINGS FOR EXISTING GRADE ELEVATIONS.
  - REFER TO SPECIFICATIONS APPENDIX A FOR GEOTECHNICAL EVALUATION REPORT AND RELATED SOIL BORING LOG.
  - CONTRACTOR WILL BE RESPONSIBLE FOR ALL DEWATERING DURING CONSTRUCTION PHASING AND OPERATIONS.
  - CONTRACTOR WILL PROVIDE THE DESIGN, ENGINEERING AND INSTALLATION OF THE TEMPORARY CRANE PAD AND SOLDIER PILE AND LAGGER SYSTEM. REFER TO SPECIFICATION SECTION 31.66.16.53 SOLDIER PILE-LAGGER WALLS FOR ADDITIONAL INFORMATION.
  - CONTRACTOR WILL PROVIDE TEMPORARY SOLDIER PILE AND LAGGER WALL SYSTEM.
  - AT COMPLETION OF ERECTION ACTIVITIES OF PARKING DECK LEVEL E CONTRACTOR WILL REMOVE CRANE PAD AND TEMPORARY SOLDIER PILE AND LAGGER WALL SYSTEM.
  - CONTRACTOR WILL RESTORE EXISTING LANDSCAPING AT EXISTING WEST PARKING LOT. CONTRACTOR WILL REINSTALL STREET LIGHT POLE AND FIXTURES.

<b>REVISION</b> 100% FINAL BID DOCUMENTS 02-27-2018 100% BID DOCUMENTS-NOT FOR CONSTRUCTION 08-18-2017 95% CONSTRUCTION DOCUMENTS SUBMISSION 07-24-2017 65% DESIGN DEVELOPMENT SUBMISSION 06-15-2017 35% SCHEMATIC DESIGN SUBMISSION 04-19-2017 Revisions 03-06-2017 Date		<b>CONSULTANTS:</b> <b>WALKER</b> PARKING CONSULTANTS 3815 Plaza Drive Ann Arbor, Michigan 48108 (734) 995-0200 • www.midwesternconsulting.com Land Development • Land Survey • Institutional • Municipal Wireless Communications • Transportation • Landfill Services		<b>KEYPLAN</b> 1		<b>ARCHITECT + ENGINEERS:</b> <b>Bancroft</b> BANCROFT ARCHITECTS + ENGINEERS 700 Nicholas Blvd., Suite 300 Elk Grove Village, IL 60007 Telephone : 847.922.9362 www.bancroft-ae.com Bancroft-AE Project No. 16-121 VA CONTRACT NO. VA250-17-C-0008		<b>Drawing Title</b> CONSTRUCTION PHASING PLAN - PHASE I LEVEL E <b>Approved Project Director</b>		<b>Project Title</b> CONSTRUCT NORTH PARKING STRUCTURE <b>Location</b> ANN ARBOR, MICHIGAN <b>Date</b> 08-18-2017 <b>Checked</b> EM <b>Drawn</b> AG		<b>Project Number</b> 506-331 <b>Building Number</b> 29 <b>Drawing Number</b> G-004A		<b>Office of Construction and Facilities Management</b> Department of Veterans Affairs	
--	--	--	--	---------------------	--	---	--	--	--	---	--	---	--	---	--