

- NOTES:**
- SHEET NOTES:**
- SEE SHEET G-011 FOR GENERAL ABBREVIATIONS AND ARCHITECTURAL SYMBOLS.
  - REFER TO SHEETS H-LS SERIES FOR LIFE SAFETY PLANS
  - ALL INTERIOR PARTITIONS ARE TYPE 27 U.O.N. SEE SHEET H-AE5.600 SERIES FOR PARTITION TYPES
  - REFER TO EQUIPMENT PLAN SHEETS H-QH4.000 SERIES FOR ADDITIONAL DIMENSIONS AND INFORMATION.
  - REFER TO SHEET H-QH6.101 FOR NON-MEDICAL EQUIPMENT LIST. REFER TO H-QH6.102 FOR TYPICAL MOUNTING HEIGHTS AND TOILET INFORMATION.
  - REFER TO SHEET H-AE6.000 SERIES FOR DOOR, FRAME AND BORROWED LITE SCHEDULES AND DETAILS
  - DIMENSIONS ARE TO COLUMN GRID, FACE OF MASONRY OR CONCRETE OR FACE OF METAL STUD U.O.N. DIMENSIONS NOTED AS "CLEAR" ARE FINISH FACE TO FINISH FACE INCLUDING ALL FINISHES SUCH AS TILE, WALL PANELS, ETC.
  - SEE H-AE6.4 SERIES FOR WINDOW AND LOUVER TYPES.
  - REFER TO PLUMBING PANS, H-MP1 SERIES, FOR FLOOR DRAIN LOCATIONS
  - REFER TO SHEET H-AE5.210 FOR TYPICAL EXPANSION JOINT DETAILS.
  - REFER TO SHEET H-AE5.201 THRU H-AE5.302 FOR TYPICAL PLAN DETAILS.
  - SEE SHEETS H-AE4.301 FOR ENLARGED PLANS - TYPICAL ROOMS.
  - REFER TO 1/16" AREA PLANS FOR INTERSTITIAL SPACE PLANS AND LEVEL 6 OVERALL ROOF PLANS.

- KEY NOTE LEGEND**
- LOW AIR RETURN. SEE MECH.
  - MODULAR CASEWORK SHOWN FOR REFERENCE ONLY. REFER TO H-QH4 SERIES FOR MANUFACTURER INFORMATION.
  - CONCRETE PAD. SEE H-EP1.2FD3. PROVIDE BOND BREAKER BETWEEN PAD AND PARTITION AND SEAL VOID AFTER PAD IS COMPLETE

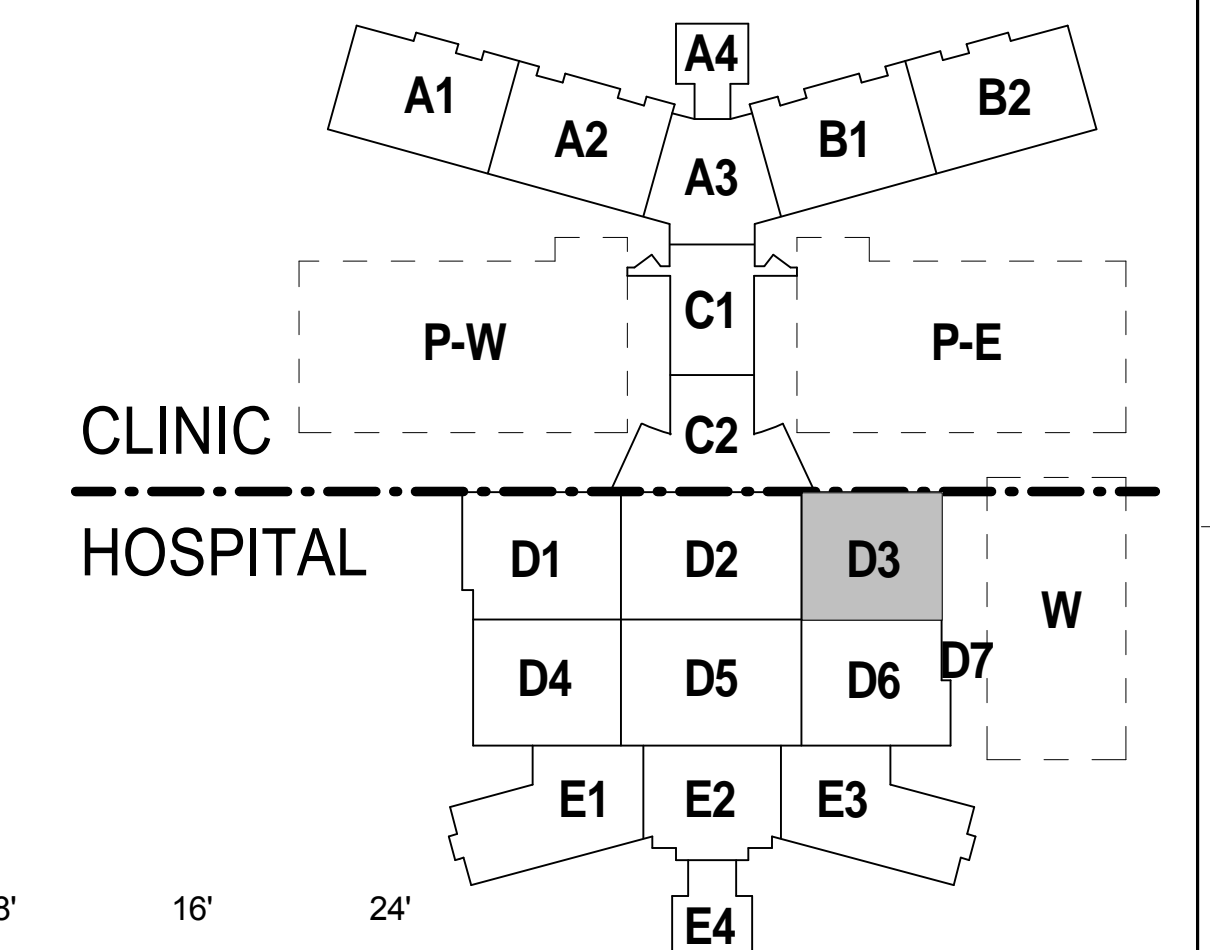

0 4' 8' 16' 24'

1/8" = 1'-0" GRAPHIC SCALE

**KEY PLAN**  
AREA D, ZONE 3

**BUILDING IS FULLY SPRINKLERED**

No.	Description	Date
3	CPR 066	04/28/2011
4	CPR 068	07/08/2011
5	CPR 130	08/25/2011
6	CPR 139	09/08/2011
7	CPR 180	11/17/2011
8	CPR 182	11/21/2011
9	CPR 231	03/01/2012
10	CPR 327	08/23/2012

**CONSULTANTS:**

**Professional Seals:**

**ARCHITECT/ENGINEERS:**

**RLF** ELLERBE BECKET  
A JOINT VENTURE

145 Lincoln Avenue Winter Park, Florida 32789 407 647 1039

1001 G Street, NW, Suite 1000 Washington, D.C. 20001 202 654 9300

Drawing Title  
**HOSPITAL / CLINIC  
LEVEL 2, AREA D, ZONE 3  
CONSTRUCTION PLAN**

Approved: Project Director  
*Melan Arski*

Project Title  
**A NEW HOSPITAL FOR  
VAMC ORLANDO, FLORIDA**

Location  
Orlando, Florida

Date  
04 JUNE, 2010

Checked  
Checker

Drawn  
EB / RLF

Project Number  
673-950

Building Number  
01 AND 02

Drawing Number  
**H-AE1.2FD3**

Dwg. 0689 of 4322

**OFFICE OF  
FACILITIES  
MANAGEMENT**

Department of  
Veterans Affairs