

\\dms01\geopass\saarchitects\Projects\VA Martinsburg - EDC2 Pool House 11-8101-050 Drawings\AC101.dwg, Wed May 26 13:36:13 2012

0 4 8 16
one eighth inch = one foot
0 4 8 16
one quarter inch = one foot
0 4 8 16
three eighths inch = one foot
0 4 8 16
one half inch = one foot
0 4 8 16
three quarters inch = one foot
0 2 4 6
one inch = one foot
0 2 4 6
one and one half inches = one foot
0 1 2 3 4 5 6
three inches = one foot

(F) SITE PLAN
3/8" = 1'-0"

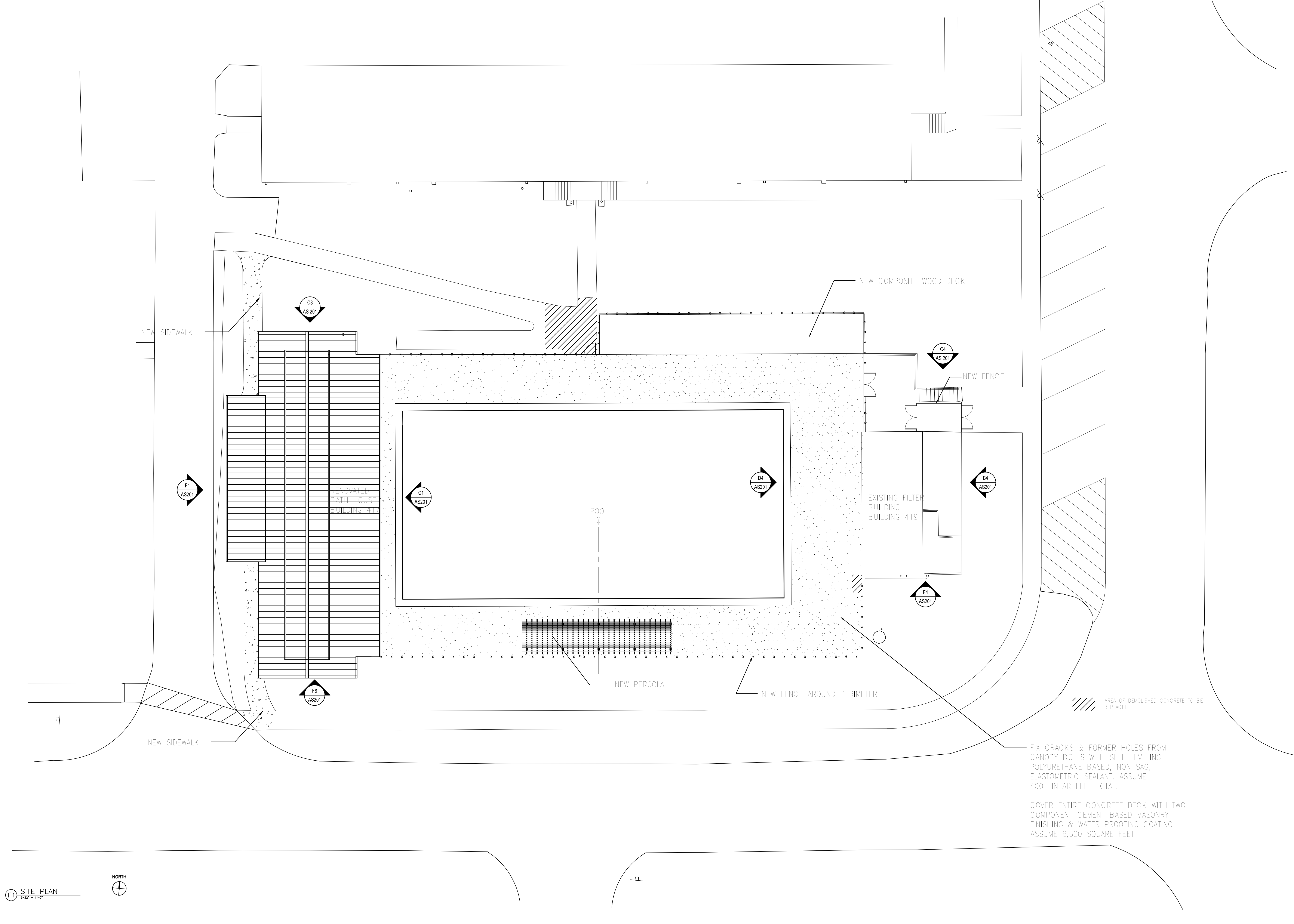
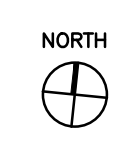

NOTE:
1. PATCH/REPAIR ALL CORE DRILLS FROM REMOVAL OF EXISTING CHAIN LINK FENCE WITH SELF LEVELING POLYURETHANE BASED, NON SAG, ELASTOMETRIC SEALANT. ASSUME 34 LBS.

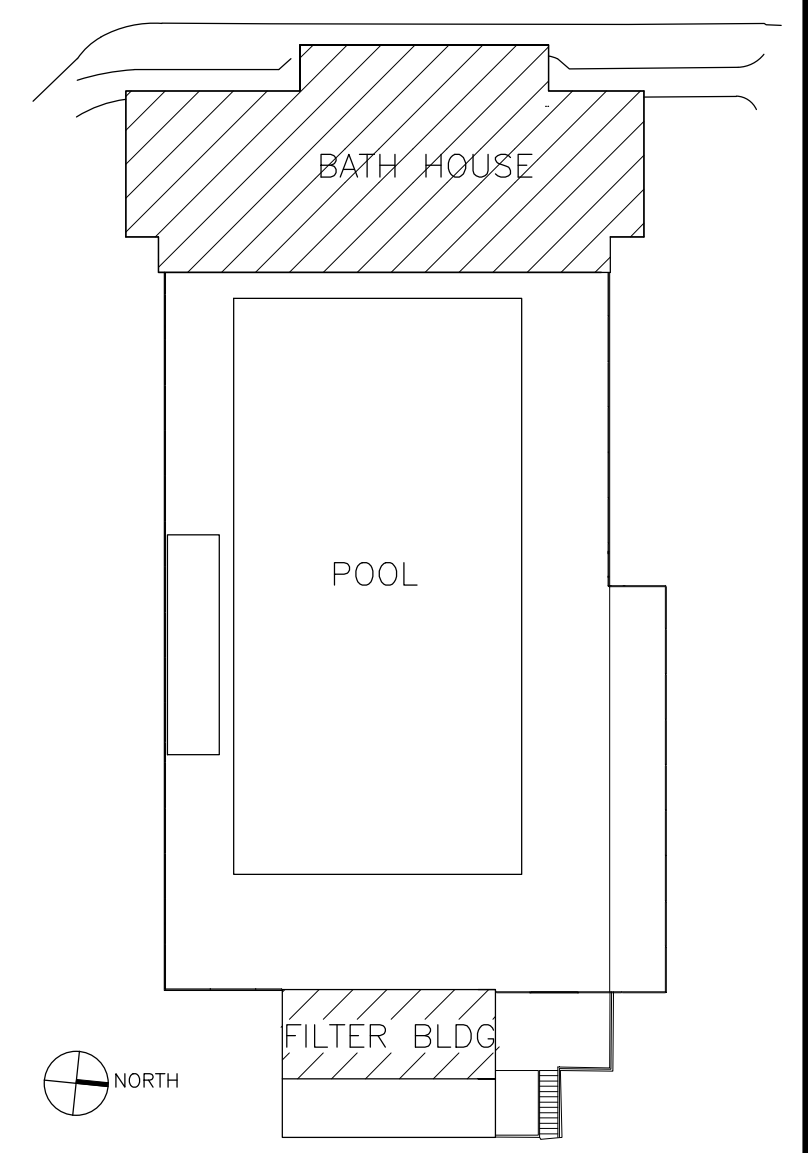

100% CONSTRUCTION DOCUMENTS

		CONSULTANTS:				ARCHITECT/ENGINEERS:		Drawing Title		Project Title		Project Number		Office of Construction and Facilities Management	
						SAAarchitects		CIVIL SITE		RECREATIONAL POOL FACILITY RENOVATIONS BATH HOUSE & FILTER BLDG		613-11-140			
								Approved: Project Director		Location VAMC, MARTINSBURG, WV		Drawing Number AC101		Department of Veterans Affairs	
						T 717.843.3200 F 717.699.0205 www.saaarchitects.com				Date 05-14-12		Checked DRSD			
Revisions:		Date										Dwg. 2 of 24			