

- NOTES:**
- SHEET NOTES:**
- A. SEE SHEET G-011 FOR GENERAL ABBREVIATIONS AND ARCHITECTURAL SYMBOLS.
 - B. REFER TO SHEETS H-LS SERIES FOR LIFE SAFETY PLANS
 - C. ALL INTERIOR PARTITIONS ARE TYPE 27 U.O.N. SEE SHEET H-AE5.600 SERIES FOR PARTITION TYPES
 - D. REFER TO EQUIPMENT PLAN SHEETS H-QH4.000 SERIES FOR ADDITIONAL DIMENSIONS AND INFORMATION.
 - E. REFER TO SHEET H-QH6.101 FOR NON-MEDICAL EQUIPMENT LIST. REFER TO H-QH6.102 FOR TYPICAL MOUNTING HEIGHTS AND TOILET INFORMATION.
 - F. REFER TO SHEET H-AE6.000 SERIES FOR DOOR, FRAME AND BORROWED LITE SCHEDULES AND DETAILS
 - G. DIMENSIONS ARE TO COLUMN GRID, FACE OF MASONRY OR CONCRETE OR FACE OF METAL STUD U.O.N. DIMENSIONS NOTED AS "CLEAR" ARE FINISH FACE TO FINISH FACE INCLUDING ALL FINISHES SUCH AS TILE, WALL PANELS, ETC.
 - H. SEE H-AE6.4 SERIES FOR WINDOW AND LOUVER TYPES.
 - I. REFER TO PLUMBING PANS, H-MP1 SERIES, FOR FLOOR DRAIN LOCATIONS
 - J. REFER TO SHEET H-AE5.210 FOR TYPICAL EXPANSION JOINT DETAILS.
 - K. REFER TO SHEET H-AE5.201 THRU H-AE5.302 FOR TYPICAL PLAN DETAILS.
 - L. SEE SHEETS H-AE4.301 FOR ENLARGED PLANS - TYPICAL ROOMS.
 - M. REFER TO 1/16" AREA PLANS FOR INTERSTITIAL SPACE PLANS AND LEVEL 6 OVERALL ROOF PLANS.

- KEY NOTE LEGEND**
- 1 PNEUMATIC TUBE STATION, SEE VERTICAL CIRCULATION SERIES DRAWINGS
 - 2 DUMBBWATER, SEE VERTICAL CIRCULATION SERIES DRAWINGS
 - 3 EXPANSION JOINT FLOOR COVER ASSEMBLY. TYP. SIM. DETAIL 2H-AE5.210
 - 4 EXPANSION JOINT WALL TO WALL COVER ASSEMBLY. TYP. AT RATED PARTITIONS, SIM. DETAIL 7H-AE5.210
 - 5 LINE OF FLOOR ABOVE
 - 6 INTERIOR FLOOR DRAIN, TYPICAL. SEE PLUMBING DRAWINGS.
 - 7 ACCESS PANEL 2 HOUR RATED 30" X 30" 4" A.F.F
 - 8 COORDINATE LOCATION OF DUCT ACCESS POINTS WITH LOCATION OF ARCHITECTURAL ACCESS DOORS SHOWN HERE.

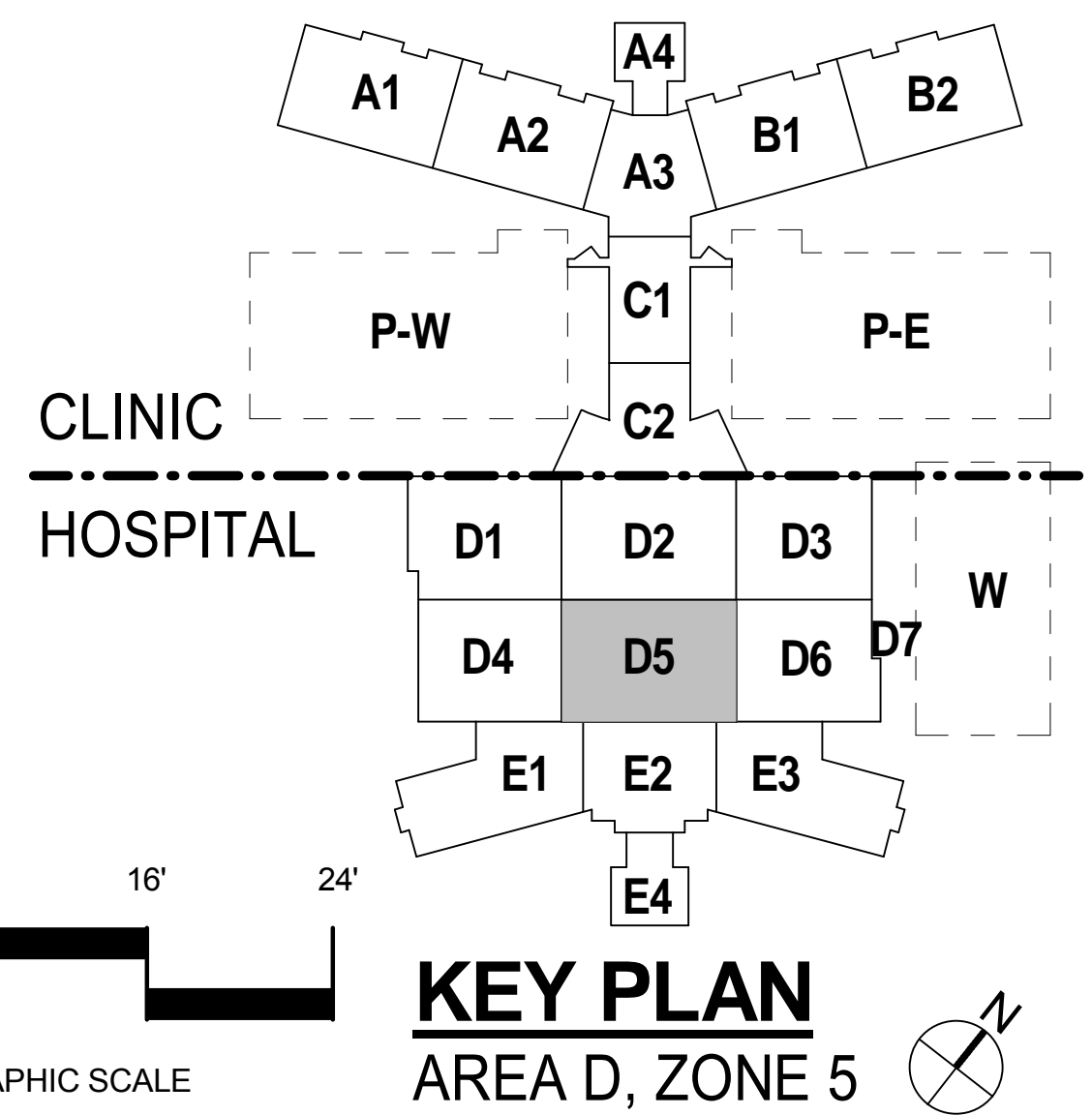

<div><div></div><div>No.</div><div>Description</div><div>Date</div></div> <table><tr><td>5</td><td>CPR 204</td><td>12/23/2011</td></tr><tr><td>6</td><td>CPR 210</td><td>01/06/2012</td></tr><tr><td>7</td><td>CPR 236</td><td>03/09/2012</td></tr><tr><td>8</td><td>CPR 242</td><td>03/14/2012</td></tr><tr><td>9</td><td>CPR 285</td><td>05/21/2012</td></tr><tr><td>10</td><td>CPR 316</td><td>07/20/2012</td></tr><tr><td>11</td><td>CPR 366</td><td>12/20/2012</td></tr><tr><td>12</td><td>CPR 374</td><td>01/31/2013</td></tr></table>			5	CPR 204	12/23/2011	6	CPR 210	01/06/2012	7	CPR 236	03/09/2012	8	CPR 242	03/14/2012	9	CPR 285	05/21/2012	10	CPR 316	07/20/2012	11	CPR 366	12/20/2012	12	CPR 374	01/31/2013	CONSULTANTS:			Professional Seals:			ARCHITECT/ENGINEERS:			Drawing Title			Project Title			Project Number			OFFICE OF FACILITIES MANAGEMENT		
5	CPR 204	12/23/2011																																													
6	CPR 210	01/06/2012																																													
7	CPR 236	03/09/2012																																													
8	CPR 242	03/14/2012																																													
9	CPR 285	05/21/2012																																													
10	CPR 316	07/20/2012																																													
11	CPR 366	12/20/2012																																													
12	CPR 374	01/31/2013																																													
						<div><div><div>STATE OF FLORIDA</div><div>PAUL CARL ZUBER</div><div>6-10</div><div>REGISTERED PROFESSIONAL</div></div><div><div></div><div></div></div></div>			<div><div><div>RLF</div><div>ELLERBE BECKET</div><div>A JOINT VENTURE</div></div><div><div>145 Lincoln Avenue Winter Park, Florida 32789 407.647.1039</div><div>1001 G Street,NW, Suite 1000 Washington, D.C. 20001 202.654.9300</div></div></div>			HOSPITAL / CLINIC LEVEL 3, AREA D, ZONE 5 CONSTRUCTION PLAN			A NEW HOSPITAL FOR VAMC ORLANDO, FLORIDA			673-950																													
									Approved: Project Director			Location Orlando, Florida			Building Number 01 AND 02																																
												Date 04 JUNE, 2010			Checked Checker			Drawing Number H-AE1.3FD5			Dwg. 0711 of 4322																										
												<div><div></div><div>Melan Arskic</div></div>			Drawn EB / RLF						<div><div></div><div>Department of Veterans Affairs</div></div>																										