

three inches = one foot
one and one half inches = one foot
one inch = one foot
three quarters inch = one foot
one half inch = one foot
three eighths inch = one foot
one quarter inch = one foot
one eighth inch = one foot



DEMOLITION PLAN GENERAL NOTES

- COORDINATE SCHEDULE OF ALL DEMOLITION WITH GOVERNMENT.
- ALL ITEMS SHOWN DASHED BOLD TO BE REMOVED COMPLETE UNLESS OTHERWISE NOTED (UON).
- TEMPORARY CONSTRUCTION WALLS ARE SHOWN WITH WALL TYPE 5A OR 5B. WALLS SHALL BE INSTALLED PRIOR TO ANY DEMOLITION COMMENCING.
- SALVAGE PORTION OF REMOVED FACE BRICK VENEER FOR WINDOW INFILLS.
- REMOVE INTERIOR SIGNS ON WALLS TO BE REMOVED OR AS NOTED PER MANUFACTURER'S INSTRUCTIONS. TURN OVER TO THE GOVERNMENT FOR REINSTALLATION.

DEMOLITION PLAN KEYNOTES

- SAWCUT OPENINGS IN PRE-CAST CONCRETE SANDWICH PANELS
- SEE CIVIL SHEET CDI FOR ADDITIONAL DEMOLITION.
- REMOVE DOOR AND FRAME AND STORE DOOR FOR RE-INSTALLATION.
- REMOVE 1-STORY VESTIBULE AND ENTRY IN ITS ENTIRETY.
- REMOVE RAISED FLOORING SYSTEM
- REMOVE ALL CEILINGS THROUGHOUT MRI SUITE
- REMOVE 6" CONCRETE FLOOR SLAB WITH THICKENED EDGE
- REMOVE PACT 1-STORY WAITING/ENTRY IN ITS ENTIRETY.
- REMOVE CEILING
- REMOVE CEILING AND STORE GRID FOR REINSTALLATION
- REMOVE FLOORING
- REMOVE 12" CONCRETE FLOOR SLAB IN VESTIBULE AND ENTRY SHOWN CROSS-HATCHED
- REMOVE STORM SEWER AND MANHOLE - SEE CIVIL
- REMOVE BEAM AND COLUMN
- REMOVE RF COPPER SHIELDING AND FURRING FROM ALL WALLS, FLOOR AND CEILING.
- REMOVE RAMP
- REMOVE WALL FURRING ON EXTERIOR WALLS. THROUGHOUT MRI SUITE EXCEPT AT ELECTRICAL PANELS IN EQUIPMENT ROOM 1W75.
- REMOVE CUBICLE CURTAIN AND TRACK AND HAND GEL DISPENSER AND STORE FOR RE-INSTALLATION.
- REMOVE ALL TOILET ACCESSORIES ON THIS WALL AND STORE FOR RE-INSTALLATION.
- REMOVE CEILING AND SOFFIT.
- UNDERGROUND ELECTRICAL CONDUIT TO BE REMOVED. SEE ELECTRICAL FOR ADDITIONAL NOTES.
- UNDERGROUND COMMUNICATION DUCT BANK TO REMAIN. PROTECT DURING CONSTRUCTION.
- CLEANOUT - SEE CIVIL
- MRI IS LOCATED IN THIS BUILDING AND WILL REMAIN OPERATIONAL DURING AT LEAST THE BEGINNING OF CONSTRUCTION. COORDINATE WITH GOVERNMENT TO AVOID INTERFERENCE WITH OPERATION.
- GOVERNMENT TO REMOVE AND STORE WALL MOUNTED T.V.
- REMOVE EXISTING SIGNAGE PER MANUFACTURES INSTRUCTION AND TURN OVER TO GOVERNMENT FOR REINSTALLATION.
- SALVAGE AUTOMATIC DOOR OPERATORS AND PUSH PLATES, ALUMINUM DOORS, AND ALUMINUM FRAMES AND TURN OVER TO THE GOVERNMENT
- SALVAGE CARD ACCESS READER AND DOOR CYLINDER AND CORE AND TURN OVER TO THE GOVERNMENT.

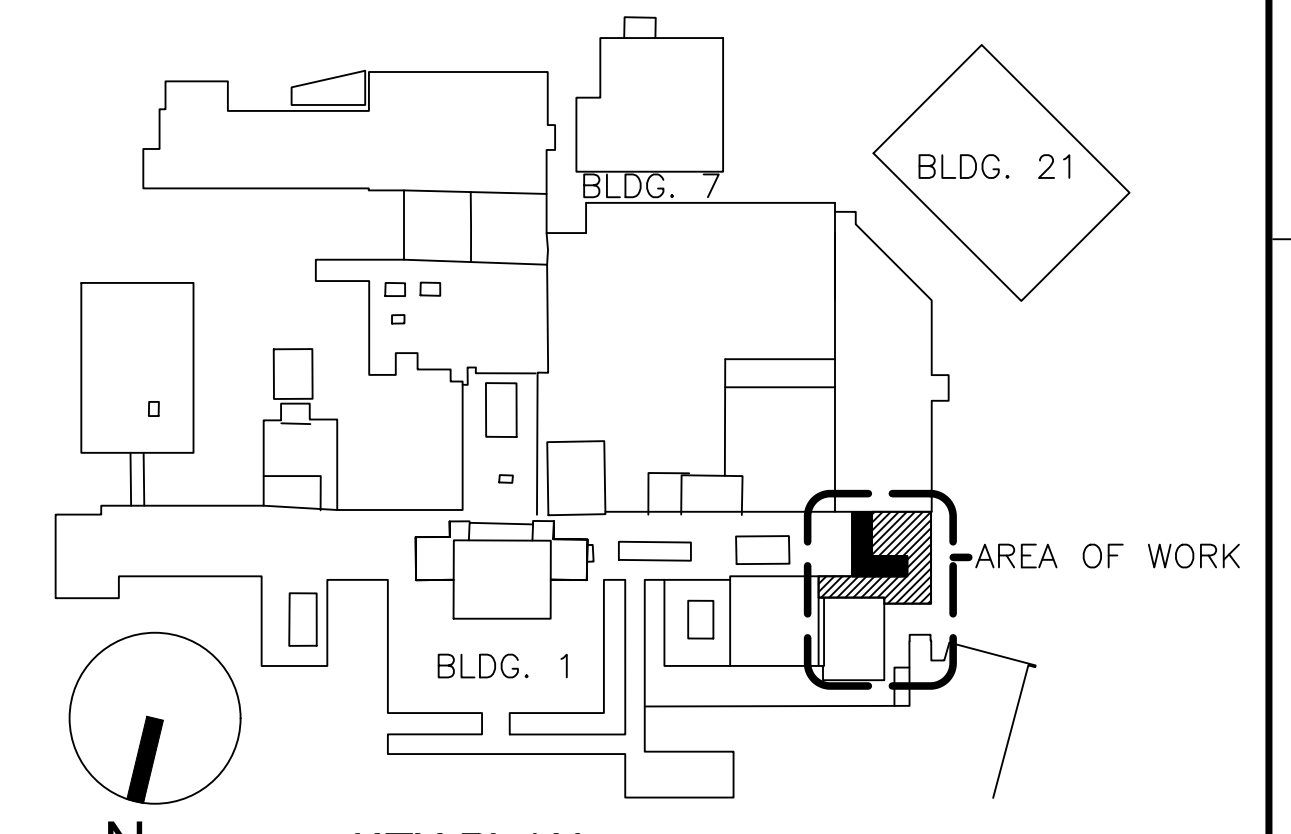

100% BID DOCUMENTS - FULLY SPRINKLERED

CONSULTANTS:		ARCHITECT/ENGINEERS:		Drawing Title FIRST FLOOR DEMOLITION PLAN		Project Title CORRECT LIFE SAFETY DEFICIENCIES		Project Number 636A8-16-006		Office of Construction and Facilities Management VA U.S. Department of Veterans Affairs
				Approved Project Director -		Location IOWA CITY VA HEALTH CARE SYSTEM		Building Number 01		
				-		Date 19 SEPTEMBER 2017		Drawing Number AD2-01W		
				-		Checked KJH		Volume 1 of 2 Dwg. 30 of 103		
				-		Drawn NAS				
1 - ADDENDUM 00002		Kenneth Hahn Architects		AE Project # 171-005						
Revisions		1343 South 75th Street Omaha, NE 68124-1610 402.391.2111 www.kharch.com								
6 APR 2018										
Date										