

REPLACE DETERIORATED SIDEWALKS

St. Cloud VA Health Care System Main Campus, St. Cloud, Minnesota

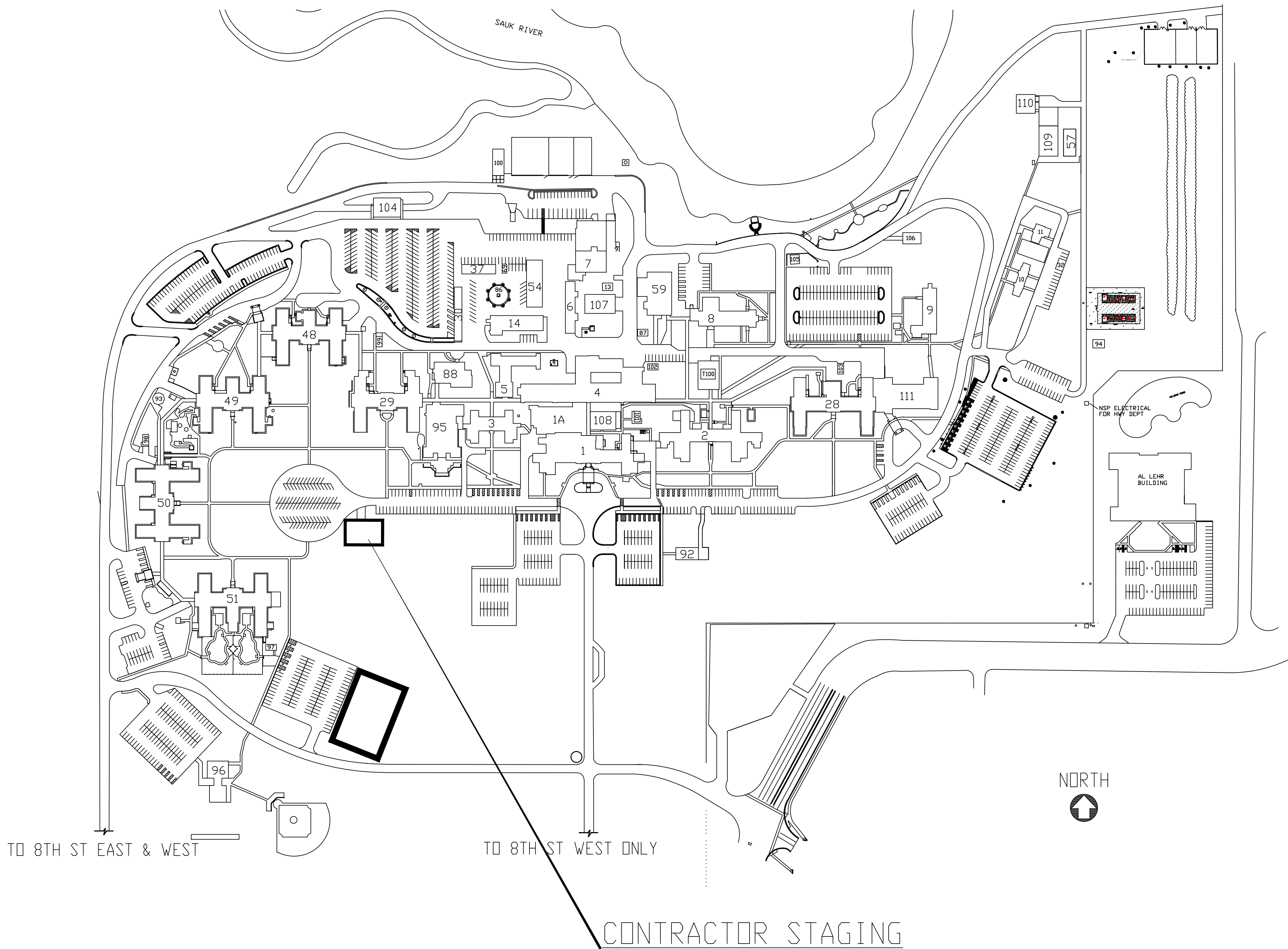

GENERAL CONDITIONS

All dimensions on drawings are approximate; Drawings are not to be scaled. It is the responsibility of the contractor to verify all field conditions and physical dimensions that influence the construction area.

It is recommended that contractors visit the proposed construction site prior to submitting their bids and they are encouraged to do so.

Contractor shall adhere strictly to State and Federal Occupational Safety and Health Administration (OSHA) Standards.

Contractor shall park only in the designated parking areas and are not to park on the lawn areas; the only exception is to load or unload supplies or equipment.

Contractor is responsible for the safeguarding of their tools and equipment. All tools and equipment are not to be left unattended and are to be secured at all times when the contractor is not present, or the construction site is not supervised by the contractor.

All VA property is to be safeguarded from damage. Any damaged VA property is to be restored to original condition prior to damage or replaced completely. This includes installation, labor, and procurement expenses.

All demolished material becomes the property and the responsibility of the contractor with the exception of specified items designated either in the plans or verbally requested by the CDR to be retained by the VA. Offsite disposal of the demolished items is the responsibility of the contractor.

Contractor must control demolition and construction dust from facility. When transporting debris, wet down sufficiently to prevent dust spreading.

If scaffolding is used, it must be used in accordance with (OSHA) regulations and is to be enclosed for the first eight feet above ground at end of each working day, until dismantled. Ladders must be removed and locked up at the end of each working day to prevent unauthorized persons from having access.

Clean all debris from construction site to the satisfaction of the CDR.

Contractor is responsible for erecting a barrier around work site to prevent patients, staff and visitors from entering construction site. This fence may be a plastic snow fence. Coordinate construction materials and location of fence with CDR.

Contractor is responsible for repairing and replacing any damaged lawn. The restoration will be performed by a landscape contractor that regularly does sodding as part of their business. All damaged lawn will be overcut by 6' or more to accomodate full width rolls of sod. Top soil to be tilled and graded to a smooth matching grade of undamaged lawn. Sod to be thoroughly saturated with water upon placement. The contractor is responsible for watering new sod until project acceptance by the CDR.

Landscaping to be completed within 5 days of sidewalk phase completion.

Access to all buildings and parking areas must be maintained throughout the project. No more than 1 building can be out of service at a time for no more than 4 days.

Any sidewalk location that is against landscape rock is required to be exposed aggregate.

Contractors are to coordinate all work with the Contracting Officers Representative.

Contractor will do utility locates prior to the start of each phase.

DRAWING INDEX	
DRAWING TITLE	SHT #
COVER SHEET	1039-1
EXISTING AFFECTED AREAS	1039-2
PERMANANT REMOVAL LOCATIONS	1039-3
NEW ADDITION LOCATIONS	1039-4
PROJECT PHASING	1039-5
PHASE 1	1039-6
PHASE 2	1039-7
PHASE 3	1039-8
PHASE 4	1039-9
PHASE 5	1039-10
PHASE 6	1039-11
B95 PATIO	1039-12
RAMP DETAILS	1039-13
SIDEWALK / CURB DETAILS	1039-14
MISC. DETAILS	1039-15

REPLACE DETERIORATED SIDEWALKS

APPROVED: SERVICE LINE DIRECTOR	DATE:	APPROVED: INFECTION CONTROL NURSE	DATE:
APPROVED: GENR COORDINATOR	DATE:	APPROVED: PATIENT SAFETY	DATE:
APPROVED: PROJECTS SECTION MANAGER	DATE:	APPROVED: CHIEF OF POLICE	DATE:
APPROVED: DIRECTOR FMS	DATE:	APPROVED: SAFETY MANAGER	DATE:

DRAWING TITLE	PROJECT TITLE	PROJECT NO.	PROJECT DATE
Cover	Replace Deteriorated Sidewalks	656-12-2245C1B	656-12-2245C1B
XXX	XXX	XXX	XXX
APPROVED: CHIEF OF STAFF	DATE:	BUILDING NO.	CHECKED BY
APPROVED: MEDICAL CENTER DIRECTOR	DATE:	XX	RLC
LOCATION:	DATE:	VA MEDICAL CENTER	DRAWING NO. 1039
ST. CLOUD, MN 56303			1 of 15

