

three eighths inch = one foot
one eighth inch = one foot
one quarter inch = one foot
one half inch = one foot
three quarters inch = one foot
one inch = one foot
two inches = one foot
three inches = one foot
four inches = one foot
five inches = one foot
six inches = one foot
seven inches = one foot
eight inches = one foot
nine inches = one foot
ten inches = one foot
eleven inches = one foot
twelve inches = one foot
thirteen inches = one foot
fourteen inches = one foot
fifteen inches = one foot
sixteen inches = one foot
seventeen inches = one foot
eighteen inches = one foot
nineteen inches = one foot
twenty inches = one foot
twenty one inches = one foot
twenty two inches = one foot
twenty three inches = one foot
twenty four inches = one foot
twenty five inches = one foot
twenty six inches = one foot
twenty seven inches = one foot
twenty eight inches = one foot
twenty nine inches = one foot
thirty inches = one foot
thirty one inches = one foot
thirty two inches = one foot
thirty three inches = one foot
thirty four inches = one foot
thirty five inches = one foot
thirty six inches = one foot
thirty seven inches = one foot
thirty eight inches = one foot
thirty nine inches = one foot
forty inches = one foot
forty one inches = one foot
forty two inches = one foot
forty three inches = one foot
forty four inches = one foot
forty five inches = one foot
forty six inches = one foot
forty seven inches = one foot
forty eight inches = one foot
forty nine inches = one foot
fifty inches = one foot
fifty one inches = one foot
fifty two inches = one foot
fifty three inches = one foot
fifty four inches = one foot
fifty five inches = one foot
fifty six inches = one foot
fifty seven inches = one foot
fifty eight inches = one foot
fifty nine inches = one foot
sixty inches = one foot
sixty one inches = one foot
sixty two inches = one foot
sixty three inches = one foot
sixty four inches = one foot
sixty five inches = one foot
sixty six inches = one foot
sixty seven inches = one foot
sixty eight inches = one foot
sixty nine inches = one foot
seventy inches = one foot
seventy one inches = one foot
seventy two inches = one foot
seventy three inches = one foot
seventy four inches = one foot
seventy five inches = one foot
seventy six inches = one foot
seventy seven inches = one foot
seventy eight inches = one foot
seventy nine inches = one foot
eighty inches = one foot
eighty one inches = one foot
eighty two inches = one foot
eighty three inches = one foot
eighty four inches = one foot
eighty five inches = one foot
eighty six inches = one foot
eighty seven inches = one foot
eighty eight inches = one foot
eighty nine inches = one foot
ninety inches = one foot
ninety one inches = one foot
ninety two inches = one foot
ninety three inches = one foot
ninety four inches = one foot
ninety five inches = one foot
ninety six inches = one foot
ninety seven inches = one foot
ninety eight inches = one foot
ninety nine inches = one foot
one hundred inches = one foot

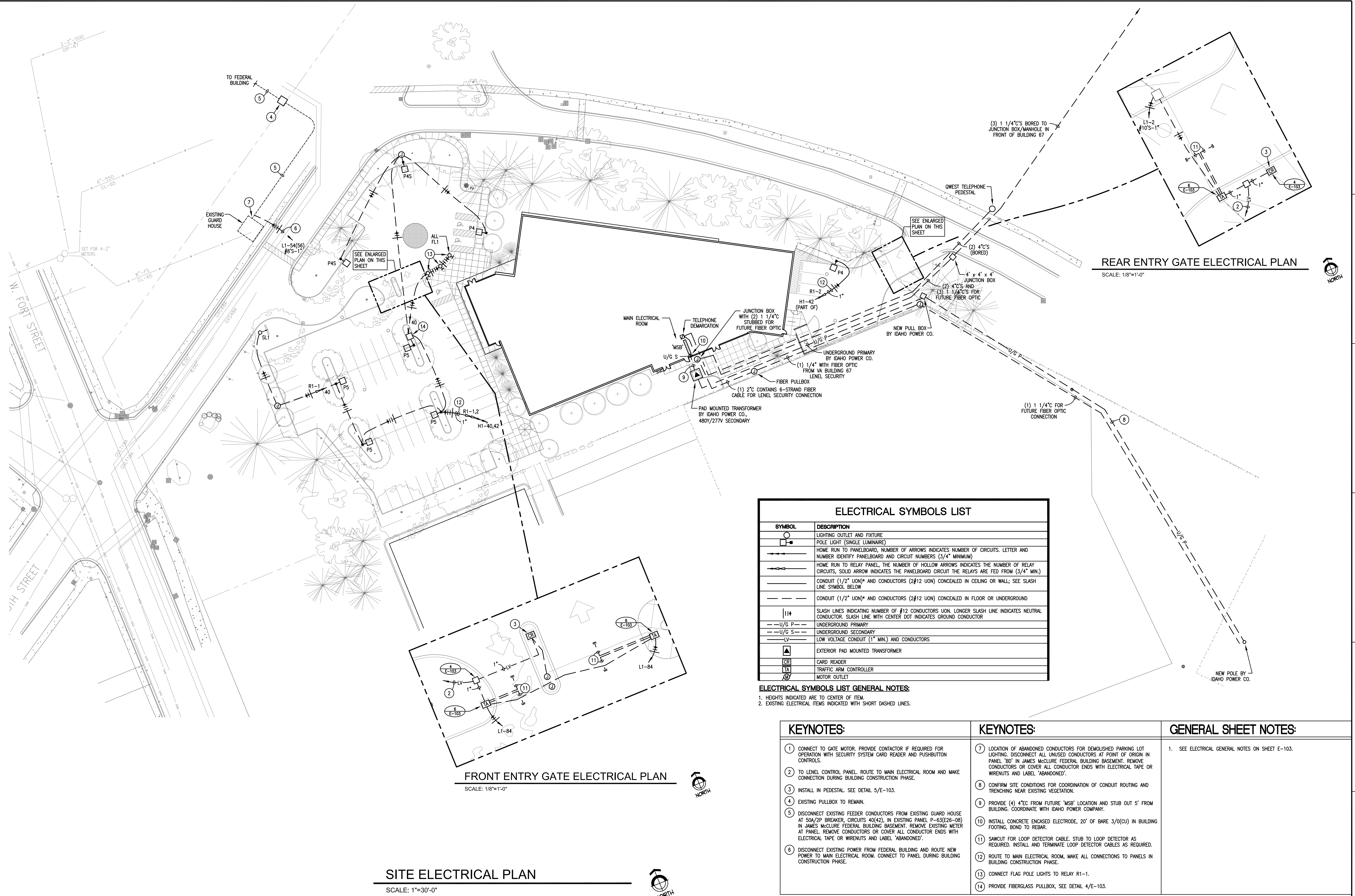

CONSULTANTS: EIDAM AND ASSOCIATES CONSULTING ENGINEERS 720 E PARK BOULEVARD, SUITE 250 BOISE, IDAHO 83702-7157 Phone (208)345-7157; FAX (208)345-7173 email: cades@eidam-asso.com EIDAM & ASSOCIATES PROJECT NUMBER 08-034RD		RECORD DOCUMENTS THESE DOCUMENTS HAVE BEEN PREPARED BASED ON INFORMATION PROVIDED BY THE CONTRACTOR. EIDAM & ASSOCIATES HAVE NOT VERIFIED THE ACCURACY OF THIS INFORMATION AND SHALL NOT BE RESPONSIBLE FOR ANY ERRORS OR OMISSIONS WHICH MAY BE INCORPORATED HEREIN AS A RESULT. Date: JULY 2009 By: GJL Eidam And Associates 720 E. Park Boulevard, Suite 250 Boise, Idaho 83712 208-345-7173 Copyright 2009 - Eidam and Associates		ARCHITECT: ZGA Architects and Planners, Chartered 565 W. Myrtle Street, Suite 225 Boise, Idaho 83702-7606 SIGNED ON 1-22-2009 ORIGINAL WITH SIGNATURE ON FILE AT ZGA ARCHITECTS AND PLANNERS, CHARTERED		Drawing Title SITE ELECTRICAL PLAN Approved Project Director		Project Title Veterans Benefits Administration Boise Regional Office Building Location Boise, Idaho Date January 22, 2009 Checked GLJ/JMH Drawn KGL		Project Number 347 - VB3018 Building Number RO Drawing Number E-101 Dwg. 2 of --		Office of Facilities Management Department of Veterans Affairs	
--	--	--	--	--	--	---	--	--	--	---	--	---	--