

three inches = one foot
one and one half inches = one foot
one inch = one foot
three quarters inch = one foot
one half inch = one foot
three eighths inch = one foot
one quarter inch = one foot
one eighth inch = one foot

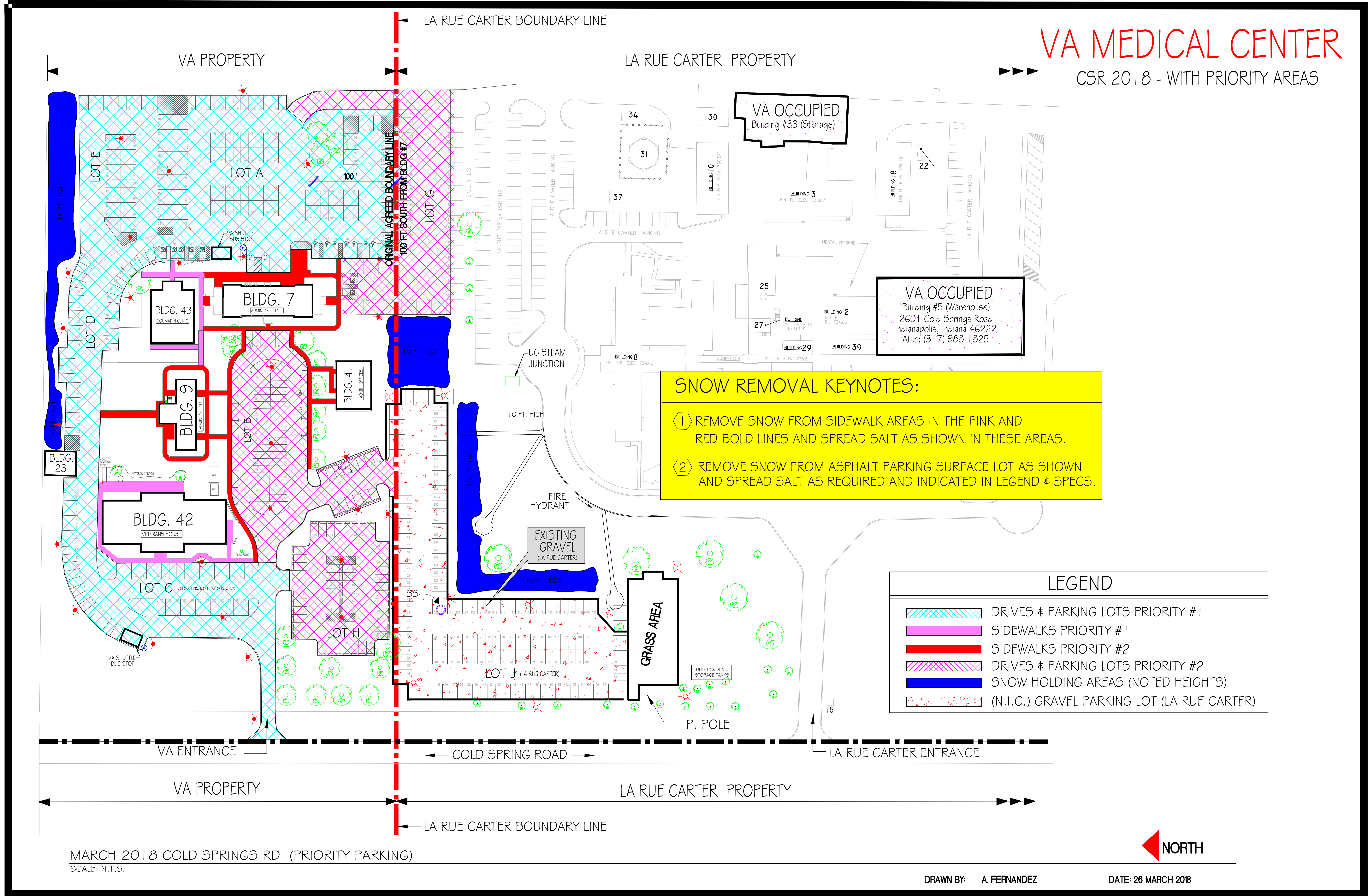

Revisions:	Date:	CONSULTANTS:	ADDRESS:	NORTH REFERENCE	PROJECT ENGINEERS:	DRAWN BY:	Drawing Title	Project Title	Project Number	Engineering and Facilities Management Services
			Richard L. Roudebush VA Medical Center 1481 W. 10th St. Indianapolis, Indiana 46202		SCOTT L. MORITZ: CHIEF ANDREW L. HAWK: ASSIT. CHIEF DWAYNE ARTHUR: SHOP SUPERVISOR	A. FERNANDEZ	COLD SPRING ROAD SNOW AND PARKING WITH PRIORITY AREAS	PRIORITY SNOW REMOVAL	Building Number	
							Approved Project Director	Location COLD SPRINGS ROAD	Drawing Number	
								Date 26 MARCH 2018	Checked AF	FY018 1 OF 1