

three inches = one foot  
one and one half inches = one foot  
one inch = one foot  
three quarters inch = one foot  
one half inch = one foot  
three eighths inch = one foot  
one quarter inch = one foot  
one eighth inch = one foot



NOTES:  
1. REFER TO SHEET AE100 FOR CONSTRUCTION NOTES  
2. REFER TO SHEET AE510 FOR PARTITION NOTES

FLOOR PLAN LEGEND  
CR CARD READER  
PP PUSH PLATE  
EFEC EXIST FIRE EXTINGUISHER CABINET  
EFEC-HC EXIST FIRE EXTINGUISHER AND HOSE CABINET  
TEMP PTN SEE AD101  
INDICATES EXISTING CONSTRUCTION TO REMAIN, UNO

ISSUE 005 - RECORD	02-23-18
ISSUE 003 - BID	08-12-15
ISSUE 002 - CD OWNER REVIEW	05-29-15
Revisions:	Date

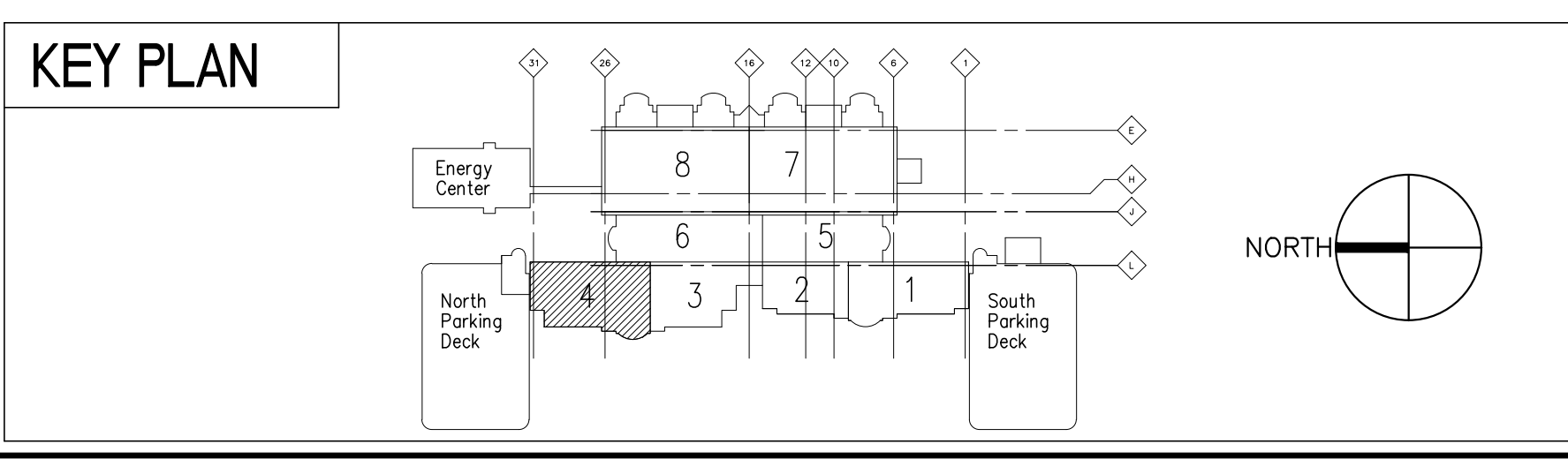

ARCHITECT/ENGINEERS:

**Kahn**

Albert Kahn Associates, Inc.  
Albert Kahn Building  
7430 Second Ave.  
Detroit, Michigan 48202-2798  
Albert Kahn Associates, Inc. is a member of the Albert Kahn Family of Companies.  
ALBERT KAHN JOB # 0398-C0-000 © 2007

FULLY SPRINKLERED - CONSTRUCTION DOCUMENTS

Drawing Title FIRST FLOOR PLAN - ZONE 4	Project Title JOHN D. DINGELL VA MEDICAL CENTER DETROIT RENOVATE 1ST FLOOR CLINICS	Project Number 553-13-122	Office of Construction and Facilities Management Department of Veterans Affairs
Approved J. HROVAT	Location DETROIT, MICHIGAN	Building Number B-100	
Date 08-12-15	Checked KDJ	Drawn ZAT	

AE101  
Dwg. 8 of 76