

Limited Asbestos Inventory Summary

To:	Michael A. Ciofani AIA NCARB
From:	Jeff Senn and Robert Peschel – Sigma
Project Number:	13180
Date:	May 22, 2012
RE:	VA Medical Center – Milwaukee, WI VA Project 695-12-118 Replace Electrical Substation Building 115 Demolition

Background

Chequamegon Bay Engineering, LLC (Chequamegon Bay) retained Sigma to conduct a limited pre-demolition asbestos survey at the VA Medical Center (VA) facility located in Milwaukee, Wisconsin. The VA intends to replace Building 115 with a new facility. Building 115 will be demolished once the new switch gear is installed and operational. Pre-demolition asbestos inspections are required by the United States Environmental Protection Agency's (USEPA) National Emission Standards for Hazardous Air Pollutants (NESHAP) regulations provided in 40 CFR 61 and the Wisconsin Department of Natural Resources (WDNR) Control of Asbestos Emissions (WAC Chapter NR 447). The VAMC is required to perform a thorough asbestos inspection of the affected facility or part of the facility where the demolition operations will occur prior to the commencement of the demolition.

State of Wisconsin certified asbestos inspectors, Mr. Dale Armbruster (All-156285) and Mr. Tom McCoy (All-117261), performed the limited pre-demolition asbestos inspection on March 29, 2012. Attachment 1 provides a copy of Mr. Armbruster's and Mr. McCoy's asbestos inspection certification cards. This limited pre-demolition asbestos inspection was performed in substantial compliance with the USEPA NESHAP and WDNR WAC Chapter NR 447 inspection and sampling requirements. The asbestos inspection included visual observation, material sampling, and laboratory analysis of suspect asbestos-containing building materials (ACBM).

Material Assessment Results

Sigma inspected Building 115 for suspect ACBMs. The following materials were evaluated by Sigma for the presence of asbestos.

- Caulk – light grey, interior (negative)
- Caulk – white/light grey, exterior (negative)
- Caulk – cream, exterior (negative)
- Flashing – black on wall (negative)
- Built-up roof – black (negative)

Polarized light microscopy (PLM) analysis did not reveal asbestos in any of the materials evaluated. Sigma did not evaluate energized building systems for the presence of asbestos. The analytical report and chain of custody are provided in Attachment 2.

Recommendation

The sample analysis results indicate that none of the materials contain asbestos and are therefore not subject to the WDNR Chapter NR 447 and the Wisconsin Department of Health Services Chapter 159 removal and disposal requirements.

Sigma recommends that there is one individual on-site during abatement and demolition that is designated as a "Competent Person". At a minimum, this individual shall be a State of Wisconsin certified asbestos supervisor familiar with applicable asbestos and hazardous material related regulations; have the experience to recognize potential work crew and environmental exposures; institute proper personal protective equipment and personnel monitoring as necessary; have the authority to stop work; and meet training requirements established by the State of Wisconsin. Discovery of suspect asbestos and/or other hazardous materials should be reported immediately to the Owner so that appropriate measures can be implemented. Further sampling of newly discovered materials may be required to confirm the presence of ACM within walls and other areas that were not visible or reasonably accessible during the asbestos inspection. Any additional or ACM discovered after this inspection is the responsibility of the building owner.

Attachment

1. Asbestos Inspector Certifications
2. Micro Analytical, Inc. Bulk Asbestos Analytical Report & Chain of Custody Documentation

ATTACHMENT 1

Asbestos Inspector Certifications

**ASBESTOS SUPERVISOR**

Issued By

STATE OF WISCONSIN

Dept. of Health Services

Dale Cameron Armbruster
823 Blaine Ave
Racine WI 53405-2407

		220 lbs	5' 10"
ACS-156285	Exp: 06/17/2012	03/23/1960	Male

Training due by: 06/17/2012

**ASBESTOS INSPECTOR**

Issued By

STATE OF WISCONSIN

Dept. of Health Services

Dale Cameron Armbruster
823 Blaine Ave
Racine WI 53405-2407

		220 lbs	5' 10"
AIL-156285	Exp: 08/11/2012	03/23/1960	Male

Training due by: 08/11/2012

**ASBESTOS SUPERVISOR**

Issued By

STATE OF WISCONSIN

Dept. of Health Services

Thomas J McCoy Jr
809 Buena Vista Ave
Waukesha WI 53188-3849

		195 lbs	5' 10"
ACS-117261	Exp: 03/03/2013	02/01/1960	Male

Training due by: 03/03/2013

**ASBESTOS INSPECTOR**

Issued By

STATE OF WISCONSIN

Dept. of Health Services

Thomas J McCoy Jr
809 Buena Vista Ave
Waukesha WI 53188-3849

		195 lbs	5' 10"
AII-117261	Exp: 04/07/2013	02/01/1960	Male

Training due by: 04/07/2013

ATTACHMENT 2

**Micro Analytical, Inc. Bulk Asbestos Analytical Report
&
Chain of Custody Documentation
March 29, 2012**

CERTIFICATE OF ANALYSIS

Client:	Sigma Environmental Services	Report Date:	4/6/2012
	1300 West Canal Street	Report No:	268832
	Milwaukee WI 53233	Project:	Building 115; 3/29/12
		Project No.:	13180

BULK SAMPLE ANALYSIS SUMMARY

Lab No.:	4611703	Description / Location:	Grey Caulk
Client No.:	01		Room 1 NW
<u>% Asbestos</u>	<u>Type</u>	<u>% Non-Asbestos Fibrous Material</u>	<u>Type</u>
None Detected	None Detected	None Detected	None Detected
			100

Lab No.:	4611704	Description / Location:	Grey Caulk
Client No.:	02		Room 3 SW
<u>% Asbestos</u>	<u>Type</u>	<u>% Non-Asbestos Fibrous Material</u>	<u>Type</u>
None Detected	None Detected	None Detected	None Detected
			100

Lab No.:	4611705	Description / Location:	Grey Caulk
Client No.:	03		Room Ext West N
<u>% Asbestos</u>	<u>Type</u>	<u>% Non-Asbestos Fibrous Material</u>	<u>Type</u>
None Detected	None Detected	None Detected	None Detected
			100

Lab No.:	4611706	Description / Location:	Tan Caulk
Client No.:	04		Room Ext West S
<u>% Asbestos</u>	<u>Type</u>	<u>% Non-Asbestos Fibrous Material</u>	<u>Type</u>
None Detected	None Detected	None Detected	None Detected
			100

Accreditation **NIST-NVLAP No. 101165-0** **NY-DOH No. 11021** **AIHA-LAP, LLC No. 100188**

*This confidential report relates only to those item(s) tested and does not represent an endorsement by NIST-NVLAP, AIHA or any agency of the U.S. government
This report shall not be reproduced except in full, without written approval of the laboratory.*

Analytical Method: EPA 600/R-93/116, by Polarized Light Microscopy

Comments: Quantification at <0.25% by volume is possible with this method. (PC) Indicates Stratified Point Count Method performed. (PC-Trace) means that asbestos was detected but is not quantifiable under the Point Counting regimen. Analysis includes all distinct separable layers in accordance with EPA 600 Method. If not reported or otherwise noted, layer is either not present or the client has specifically requested that it not be analyzed (ex. analyze until positive instructions). Small asbestos fibers may be missed by PLM due to resolution limitations of the optical microscope. Therefore, PLM is not consistently reliable in detecting asbestos in non-friable organically bound (NOB) materials. Quantitative transmission electron microscopy (TEM) is currently the only method that can pronounce materials as non-asbestos containing.

Analysis Performed By: B. Fauseit

Approved By:

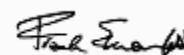

Date: 4/6/2012

Frank E. Ehrenfeld, III
Laboratory Director

CERTIFICATE OF ANALYSIS

Client:	Sigma Environmental Services	Report Date:	4/6/2012
	1300 West Canal Street	Report No:	268832
	Milwaukee WI 53233	Project:	Building 115; 3/29/12
		Project No.:	13180

BULK SAMPLE ANALYSIS SUMMARY

Lab No.:	4611707	Description / Location:	Tan Caulk	
Client No.:	05		Room Ext South C	
<u>% Asbestos</u>	<u>Type</u>	<u>% Non-Asbestos Fibrous Material</u>	<u>Type</u>	<u>% Non-Fibrous Material</u>
None Detected	None Detected	None Detected	None Detected	100

Lab No.:	4611708	Description / Location:	Black Tar; Wall Flashing	
Client No.:	06		Room Ext West S	
<u>% Asbestos</u>	<u>Type</u>	<u>% Non-Asbestos Fibrous Material</u>	<u>Type</u>	<u>% Non-Fibrous Material</u>
None Detected	None Detected	None Detected	None Detected	100

Lab No.:	4611709	Description / Location:	Black Tar; Wall Flashing	
Client No.:	07		Room Ext West N	
<u>% Asbestos</u>	<u>Type</u>	<u>% Non-Asbestos Fibrous Material</u>	<u>Type</u>	<u>% Non-Fibrous Material</u>
None Detected	None Detected	None Detected	None Detected	100

Lab No.:	4611710	Description / Location:	Black Tar; Wall Flashing	
Client No.:	08		Room Ext East N	
<u>% Asbestos</u>	<u>Type</u>	<u>% Non-Asbestos Fibrous Material</u>	<u>Type</u>	<u>% Non-Fibrous Material</u>
None Detected	None Detected	None Detected	None Detected	100

Accreditation	NIST-NVLAP No. 101165-0	NY-DOH No. 11021	AIHA-LAP, LLC No. 100188
----------------------	--------------------------------	-------------------------	---------------------------------

*This confidential report relates only to those item(s) tested and does not represent an endorsement by NIST-NVLAP, AIHA or any agency of the U.S. government
This report shall not be reproduced except in full, without written approval of the laboratory.*

Analytical Method: EPA 600/R-93/116, by Polarized Light Microscopy

Comments: Quantification at <0.25% by volume is possible with this method. (PC) Indicates Stratified Point Count Method performed. (PC-Trace) means that asbestos was detected but is not quantifiable under the Point Counting regimen. Analysis includes all distinct separable layers in accordance with EPA 600 Method. If not reported or otherwise noted, layer is either not present or the client has specifically requested that it not be analyzed (ex. analyze until positive instructions). Small asbestos fibers may be missed by PLM due to resolution limitations of the optical microscope. Therefore, PLM is not consistently reliable in detecting asbestos in non-friable organically bound (NOB) materials. Quantitative transmission electron microscopy (TEM) is currently the only method that can pronounce materials as non-asbestos containing.

Analysis Performed By: B. Fauseit

Date: 4/6/2012

CERTIFICATE OF ANALYSIS

Client:	Sigma Environmental Services	Report Date:	4/6/2012
	1300 West Canal Street	Report No:	268832
	Milwaukee WI 53233	Project:	Building 115; 3/29/12
		Project No.:	13180

BULK SAMPLE ANALYSIS SUMMARY

Lab No.:	4611711	Description / Location:	White NonFibrous	
Client No.:	09		Built Up Roof NW	
<u>% Asbestos</u>	<u>Type</u>	<u>% Non-Asbestos Fibrous Material</u>	<u>Type</u>	<u>% Non-Fibrous Material</u>
None Detected	None Detected	None Detected	None Detected	100

Lab No.:	4611711	Description / Location:	Tan Fibrous	Layer No.:	2
Client No.:	09		Built Up Roof NW		
<u>% Asbestos</u>	<u>Type</u>	<u>% Non-Asbestos Fibrous Material</u>	<u>Type</u>	<u>% Non-Fibrous Material</u>	
None Detected	None Detected	50	Cellulose	50	

Lab No.:	4611711	Description / Location:	Black Roof Material	Layer No.:	3
Client No.:	09		Built Up Roof NW		
<u>% Asbestos</u>	<u>Type</u>	<u>% Non-Asbestos Fibrous Material</u>	<u>Type</u>	<u>% Non-Fibrous Material</u>	
None Detected	None Detected	None Detected	None Detected	100	

Accreditation NIST-NVLAP No. 101165-0 NY-DOH No. 11021 AIHA-LAP, LLC No. 100188

*This confidential report relates only to those item(s) tested and does not represent an endorsement by NIST-NVLAP, AIHA or any agency of the U.S. government
This report shall not be reproduced except in full, without written approval of the laboratory.*

Analytical Method: EPA 600/R-93/116, by Polarized Light Microscopy

Comments: Quantification at <0.25% by volume is possible with this method. (PC) Indicates Stratified Point Count Method performed. (PC-Trace) means that asbestos was detected but is not quantifiable under the Point Counting regimen. Analysis includes all distinct separable layers in accordance with EPA 600 Method. If not reported or otherwise noted, layer is either not present or the client has specifically requested that it not be analyzed (ex. analyze until positive instructions). Small asbestos fibers may be missed by PLM due to resolution limitations of the optical microscope. Therefore, PLM is not consistently reliable in detecting asbestos in non-friable organically bound (NOB) materials. Quantitative transmission electron microscopy (TEM) is currently the only method that can pronounce materials as non-asbestos containing.

Analysis Performed By: B. Fauseit

Date: 4/6/2012

CERTIFICATE OF ANALYSIS

Client:	Sigma Environmental Services	Report Date:	4/6/2012
	1300 West Canal Street	Report No:	268832
	Milwaukee WI 53233	Project:	Building 115; 3/29/12
		Project No.:	13180

BULK SAMPLE ANALYSIS SUMMARY

Lab No.:	4611712	Description / Location:	White NonFibrous
Client No.:	10		Built Up Roof SW
<u>% Asbestos</u>	<u>Type</u>	<u>% Non-Asbestos Fibrous Material</u>	<u>Type</u>
None Detected	None Detected	None Detected	None Detected
			100

Lab No.:	4611712	Description / Location:	Tan Fibrous	Layer No.:	2
Client No.:	10		Built Up Roof SW		
<u>% Asbestos</u>	<u>Type</u>	<u>% Non-Asbestos Fibrous Material</u>	<u>Type</u>	<u>% Non-Fibrous Material</u>	
None Detected	None Detected	50	Cellulose	50	

Lab No.:	4611712	Description / Location:	Black Roof Material	Layer No.:	3
Client No.:	10		Built Up Roof SW		
<u>% Asbestos</u>	<u>Type</u>	<u>% Non-Asbestos Fibrous Material</u>	<u>Type</u>	<u>% Non-Fibrous Material</u>	
None Detected	None Detected	None Detected	None Detected	100	

Accreditation	NIST-NVLAP No. 101165-0	NY-DOH No. 11021	AIHA-LAP, LLC No. 100188
----------------------	--------------------------------	-------------------------	---------------------------------

*This confidential report relates only to those item(s) tested and does not represent an endorsement by NIST-NVLAP, AIHA or any agency of the U.S. government
This report shall not be reproduced except in full, without written approval of the laboratory.*

Analytical Method: EPA 600/R-93/116, by Polarized Light Microscopy

Comments: Quantification at <0.25% by volume is possible with this method. (PC) Indicates Stratified Point Count Method performed. (PC-Trace) means that asbestos was detected but is not quantifiable under the Point Counting regimen. Analysis includes all distinct separable layers in accordance with EPA 600 Method. If not reported or otherwise noted, layer is either not present or the client has specifically requested that it not be analyzed (ex. analyze until positive instructions). Small asbestos fibers may be missed by PLM due to resolution limitations of the optical microscope. Therefore, PLM is not consistently reliable in detecting asbestos in non-friable organically bound (NOB) materials. Quantitative transmission electron microscopy (TEM) is currently the only method that can pronounce materials as non-asbestos containing.

Analysis Performed By: B. Fauseit

Date: 4/6/2012

CERTIFICATE OF ANALYSIS

Client:	Sigma Environmental Services	Report Date:	4/6/2012
	1300 West Canal Street	Report No:	268832
	Milwaukee WI 53233	Project:	Building 115; 3/29/12
		Project No.:	13180

BULK SAMPLE ANALYSIS SUMMARY

Lab No.:	4611713	Description / Location:	White NonFibrous	
Client No.:	11		Built Up Roof SE	
<u>% Asbestos</u>	<u>Type</u>	<u>% Non-Asbestos Fibrous Material</u>	<u>Type</u>	<u>% Non-Fibrous Material</u>
None Detected	None Detected	None Detected	None Detected	100

Lab No.:	4611713	Description / Location:	Tan Fibrous	Layer No.:	2
Client No.:	11		Built Up Roof SE		
<u>% Asbestos</u>	<u>Type</u>	<u>% Non-Asbestos Fibrous Material</u>	<u>Type</u>	<u>% Non-Fibrous Material</u>	
None Detected	None Detected	50	Cellulose	50	

Lab No.:	4611713	Description / Location:	Black Roof Material	Layer No.:	3
Client No.:	11		Built Up Roof SE		
<u>% Asbestos</u>	<u>Type</u>	<u>% Non-Asbestos Fibrous Material</u>	<u>Type</u>	<u>% Non-Fibrous Material</u>	
None Detected	None Detected	None Detected	None Detected	100	

Accreditation **NIST-NVLAP No. 101165-0** **NY-DOH No. 11021** **AIHA-LAP, LLC No. 100188**

*This confidential report relates only to those item(s) tested and does not represent an endorsement by NIST-NVLAP, AIHA or any agency of the U.S. government
This report shall not be reproduced except in full, without written approval of the laboratory.*

Analytical Method: EPA 600/R-93/116, by Polarized Light Microscopy

Comments: Quantification at <0.25% by volume is possible with this method. (PC) Indicates Stratified Point Count Method performed. (PC-Trace) means that asbestos was detected but is not quantifiable under the Point Counting regimen. Analysis includes all distinct separable layers in accordance with EPA 600 Method. If not reported or otherwise noted, layer is either not present or the client has specifically requested that it not be analyzed (ex. analyze until positive instructions). Small asbestos fibers may be missed by PLM due to resolution limitations of the optical microscope. Therefore, PLM is not consistently reliable in detecting asbestos in non-friable organically bound (NOB) materials. Quantitative transmission electron microscopy (TEM) is currently the only method that can pronounce materials as non-asbestos containing.

Analysis Performed By: B. Fauseit

Date: 4/6/2012

CDavis

From: Ray Sankey [RaySankey@iatl.com]
Sent: Wednesday, April 11, 2012 11:45 AM
To: 'CDavis'
Subject: FW: Project Numbers

Do you want instant access to your client reports and invoices? [Click here](#) to learn more about our client portal.



Raymond Sankey
Business Development Coordinator
International Asbestos Testing Laboratories
9000 Commerce Parkway, Suite B
Mt. Laurel, NJ 08054
Ph 856 231-9449
Fx 856-231-9818

Confidentiality Notice: This e-mail transmission contains confidential or legally privileged information that is intended for the individual or entity named in the e-mail address. If you are not the intended recipient, you are hereby notified that any disclosure, copying, distribution or reliance upon the contents of this e-mail is strictly prohibited. If you have received this e-mail transmission in error, please reply to the sender and delete the message from your system. Thank you.

From: Jeff Senn [mailto:jsenn@thesigmagroup.com]
Sent: Monday, April 09, 2012 4:30 PM
To: Ray Sankey
Cc: Dale Armbruster; Tom McCoy; Robert Peschel
Subject: Project Numbers

Hello Ray,

Please modify the following reports to reflect our internal project numbers.

IATL Report 268832
Change Project Number from 13205 to 13180

IATL Report 268835
Change Project Number from 13180 to 13205

Include this email with the Chain of Custody for each project.

4/11/2012

Please call or email with questions.

Thanks much,
Jeff

--

Jeffrey M. Senn, CHMM
Senior Engineer
Sigma Environmental Services, Inc.
414.643.4151 (direct)
414.588.4952 (cell)
1300 W Canal Street, Milwaukee, WI 53233
jsenn@thesigmagroup.com | www.thesigmagroup.com



*This electronic transmission is strictly confidential
and intended solely for the addressee. If you are not
the intended addressee, you must not disclose,
copy or take any action in reliance of this transmission.*

International Asbestos Testing Laboratories
9000 Commerce Parkway, Suite B
Mt. Laurel, New Jersey 08054

Tel. 856 231-9449
Fax 856 231-9818

- Chain of Custody -

Client: Sigma Environmental Services, Inc.
1300 West Canal Street
Milwaukee, Wisconsin
Phone: (414) 643-4200
FAX: (414) 643-4210

Project Name: _____
Project No.: #13205
Contact: Jeff Senn
Pager: 414-643-4151

Special: _____
Instructions: _____

Type:

Asbestos		Lead		Other	
<input type="checkbox"/> Air	<input type="checkbox"/> Soil	<input type="checkbox"/> Air	<input type="checkbox"/> Soil		
<input checked="" type="checkbox"/> Bulk	<input type="checkbox"/> Dust	<input type="checkbox"/> Bulk	<input type="checkbox"/> Dust		
<input checked="" type="checkbox"/> Water	<input type="checkbox"/> Other	<input type="checkbox"/> Water	<input type="checkbox"/> Other		

Analysis Method:

<input type="checkbox"/> PCM: NIOSH 7400	<input checked="" type="checkbox"/> PLM: Bulk Asbestos EPA 600	<input type="checkbox"/> TEM: AHERA
<input type="checkbox"/> PCM: OSHA	<input checked="" type="checkbox"/> PLM: Point Counting 198.1	<input type="checkbox"/> TEM: NIOSH 7402
<input type="checkbox"/> PCM: Other _____	<input type="checkbox"/> PLM: NOB via 198.1 (PLM only)	<input type="checkbox"/> TEM: EPA Level II
	<input type="checkbox"/> If <1% by PLM, to TEM via 198.4 to meet NYSDOH requirements** (** call to confirm TAT!)	<input type="checkbox"/> TEM: Microvac/Wipe
<input type="checkbox"/> AAS: NIOSH 7082 (Air)		<input type="checkbox"/> TEM: Asbestos in Water
<input type="checkbox"/> AAS: Lead in Drinking Water		<input type="checkbox"/> TEM: Bulk Analysis
<input type="checkbox"/> AAS: Lead in Paint ASTM D3335-85a		<input type="checkbox"/> TEM: NOB 198.4
<input type="checkbox"/> AAS: Lead Dust/Wipe		<input type="checkbox"/> TEM: Other _____
<input type="checkbox"/> AAS: Other Metals/Soil _____		<input type="checkbox"/> Total Dust: NIOSH 0500

Turnaround

FAX: _____ date / time Verbals: _____ date / time

Time:

<input type="checkbox"/> 10 Day	<input type="checkbox"/> 3 Day	<input type="checkbox"/> 1 Day	<input type="checkbox"/> RUSH
<input checked="" type="checkbox"/> 5 Day	<input type="checkbox"/> 2 Day	<input type="checkbox"/> 6 Hour	
Preliminary FAX / Verbal Results Requested by:			

Sample Numbers:

Client #(s): 01 - 11
(start) (end)
IATL #(s): _____ - _____
(start) (end)

Total: 11 ^B 4/6/12

Chain of Custody:

Relinquished: <u>[Signature]</u>	Date: <u>3/30/12</u>	Time: <u>14:15</u>
Received: _____	Date: _____	Time: _____
Sample Log-in: <u>2241572</u>	Date: <u>APR - 2 2012</u>	Time: _____
Sample Prep: _____	Date: _____	Time: _____
Analyzed: _____	Date: _____	Time: _____
QA/QC Review: <u>[Signature]</u>	Date: <u>4/10/12</u>	Time: _____

Archived/Released: _____
Date: _____

QA/QC InterLAB Use: _____
Time: _____

SIGMA ENVIRONMENTAL SERVICES, INC.
1300 West Canal Street
Milwaukee, Wisconsin 53233

Supplemental Asbestos Chain of Custody

Project Number: #13205
Number of Samples: 11

In addition to the information provided on the laboratory chain of custody, Sigma requires the following (checked items only):

- ☒ When the laboratory observes an apparent discrepancy between Sigma's material description and the sample received by the laboratory, the laboratory shall flag the material description on the laboratory report and define on the laboratory report the specific discrepancy(s) noted.
- ☒ With the exception of drywall and joint compound samples, analyze and report each distinct and separable material layer unless otherwise instructed on the attached "Sigma Sample Material List" sheet(s). Laboratory to determine distinct and separable layers and provide layer descriptions for each individual layer.
- ☐ Analyze and report each distinct and separable material layer unless otherwise instructed on the attached "Sigma Sample Material List" sheet(s). Laboratory to determine distinct and separable layers and provide layer descriptions for each individual layer.
- ☒ Discontinue analysis of homogenous material upon determining that the material contains greater than one percent asbestos content. If the homogeneous material contains multiple layers, continue analysis of each layer until all samples have been analyzed or until it has been determined that the layer contains greater than one percent asbestos content. See item #4 for flooring system Positive Stop instructions.

For example, if Sigma submitted three roofing system samples and the top layer sample analysis revealed asbestos is present at greater than one percent, the top layer analysis would be discontinued but the underlying layer(s) analysis would continue until greater than one percent asbestos is detected or until all three underlying sample layers have been analyzed. This assumes, however, that the materials are in fact homogenous. Through microscopic examination, it may be determined by the analyst that there are additional layers not present in each sample. In that case, the individual sample layer should also be analyzed.

- ☐ **Flooring Systems (including floor tile systems, vinyl flooring systems, vinyl laminate systems, and stair tread systems):** Conduct analysis of the mastic layer(s) first. If analysis reveals greater than one percent asbestos content, discontinue analysis of the mastic layers and do not analyze the flooring material (tile, vinyl, laminate, etc.) Call Jeff Senn at (414) 643-4151 with specific questions.

Sigma Sample Material List

Page 1 of 1

Project: # 13205

Date: 3-29-12

Building: 115

Inspectors: DCA, TM

Sample Number	Homogenous Material Code	Homogeneous Material Description	Functional Area/ Room Number	Location within Room	
01	MC-1	Lt. Grey Caulk	1	NW	4611703
02	MC-1		3	SW	4611704
03	MC-2	White/Lt. Grey Caulk	Ext. West	N	4611705
04	MC-3	Cream Caulk	Ext. West	S	4611706
05	MC-3		Ext. South	C	4611707
06	MWF-1	Black Wall Flashing	Ext. West	S	4611708
07	MWF-1		Ext. West	N	4611709
08	MWF-1		Ext. East	N	4611710
09	MBR-1	Black Built Up Roof	Roof	NW	4611711
10	MBR-1		Roof	SW	4611712
11	MBR-1		Roof	SE	4611713
12					
13					
14					
15					
16					
17					
18					
19					
20					
21					
22					
23					
24					
25					
26					
27					
28					
29					
30					
31					
32					
33					
34					
35					
36					
37					
38					
39					
40					
41					
42					
43					
44					
45					
46					
47					
48					
49					
50					

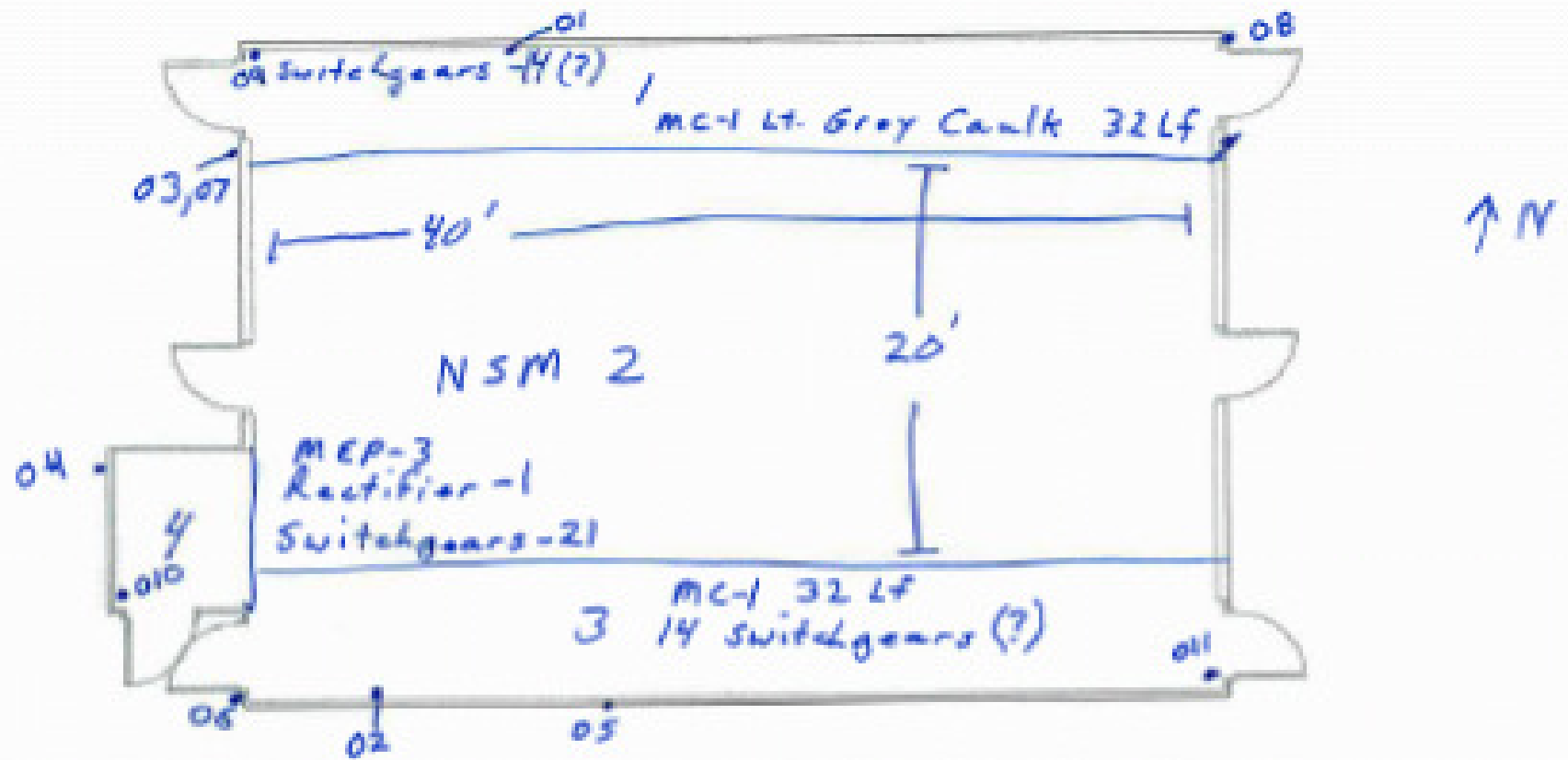

Figure 1 – Building 115