

A  
three inches = one foot  
B  
one and one-half inches = one foot  
C  
one inch = one foot  
D  
three-quarters inch = one foot  
E  
one-half inch = one foot  
F  
three-eighths inch = one foot



DEPARTMENTAL GROSS (sq. ft.)		
DEPARTMENT	LEVEL	AREA
Ambulatory Care - Pediatrics	LEVEL 03	5,682 SF
		5,682 SF
Ambulatory Care - Primary	LEVEL 02	27,664 SF
		27,664 SF
Ambulatory Care - Specialty	LEVEL 03	15,627 SF
		15,627 SF
Audiology and Speech Pathology	LEVEL 02	3,470 SF
		3,470 SF
Business Office	LEVEL 01	2,132 SF
		2,132 SF
Canteen	LEVEL 01	4,650 SF
		4,650 SF
Cardiovascular Labs	LEVEL 03	1,855 SF
		1,855 SF
Clinic Management	LEVEL 02	1,870 SF
		1,870 SF
EMS	LEVEL 01	1,501 SF
	LEVEL 02	233 SF
	LEVEL 03	213 SF
		1,947 SF
Engineering	LEVEL 01	509 SF
		509 SF
Eye Clinic	LEVEL 01	447 SF
	LEVEL 03	5,079 SF
		5,526 SF
Fine Arts	LEVEL 01	224 SF
		224 SF
Lobby (Included in NUSF)	LEVEL 01	628 SF
	LEVEL 02	840 SF
	LEVEL 03	2,039 SF
		3,507 SF
Lobby (Not Included in NUSF)	LEVEL 01	5,573 SF
	LEVEL 02	816 SF
	LEVEL 03	724 SF
		7,112 SF
Lockers	LEVEL 01	1,377 SF
		1,377 SF
Logistics	LEVEL 01	2,888 SF
		2,888 SF
Mechanical	LEVEL 02	93 SF
		93 SF
Mental Health	LEVEL 02	2,150 SF
		2,150 SF
Pathology and Laboratory Medicine (PLM)	LEVEL 01	3,440 SF
		3,440 SF
Pharmacy	LEVEL 01	2,991 SF
		2,991 SF
Physical Medicine and Rehab (PMR)	LEVEL 01	4,590 SF
		4,590 SF
Prosthetics	LEVEL 01	1,310 SF
		1,310 SF
Radiology	LEVEL 01	3,678 SF
		3,678 SF
Service Organizations	LEVEL 01	427 SF
		427 SF
Volunteer Service	LEVEL 01	633 SF
		633 SF
Women's Health	LEVEL 01	167 SF
	LEVEL 02	251 SF
	LEVEL 03	5,154 SF
		5,573 SF

DEPARTMENT LEGEND	
	WOMEN'S HEALTH

BUILDING GROSS (sq. ft.)	
LEVEL	AREA
LEVEL 01	49,474 SF
LEVEL 02	49,483 SF
LEVEL 03	49,478 SF
	148,435 SF

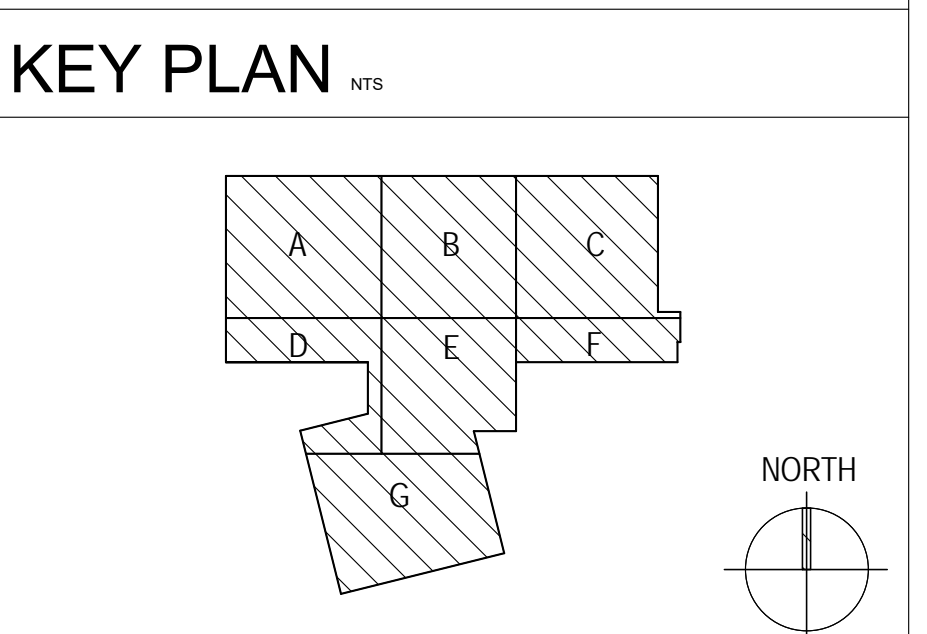

1 OVERALL FLOOR PLAN - LEVEL 01  
1/16" = 1'-0"

Plot Date: 2/15/2017 4:24:43 PM  
File Name: C:\Users\Alysa E\Documents\12-4392 VADA - MCC\_Inner\_Ayza E.rvt  
one-quarter inch = one foot  
one-eighth inch = one foot

No.	Description	Date
AB #008 - 100% VA COMMENTS		11/7/2014

CONSULTANTS:

OWNER:



ARCHITECT/ENGINEERS:  
  
NICHOLS • MELBURG • ROSSETTO  
ARCHITECTS + ENGINEERS  
300 KNOLLCREST DRIVE  
REDDING, CA. 96002  
(530) 222-3300 (530) 222-3538 FAX  
http://www.nmrdesign.com  
NMR Project Number: 12-4392

Drawing Title  
OVERALL DEPARTMENT PLAN - LEVEL 01  
Approved: Project Manager  
  
MAX EVANS  
VAPAHCS OFFICE OF FACILITY PLANNING & DEVELOPMENT

Project Title: Major General William H. Gourley  
VA - DOD  
OUTPATIENT CLINIC  
Location  
201 9TH STREET, MARINA, CA 93933  
Date  
DECEMBER 18, 2014  
Checked  
Checker  
Drawn  
NMR

BUILDING DEPARTMENT  
APPROVED SET  
VA Project Number:  
VA-101-134-0004  
FULLY  
SPRINKLERED  
Drawing No.  
AE108  
 Department of Veterans Affairs