

GENERAL NOTES:

1. THE CONTRACTOR WILL PROVIDE ALL LABOR, MATERIALS, EQUIPMENT AND SUPERVISION NECESSARY FOR THE COMPLETION OF PROJECT #610-18-501 INSTALL PERIMETER SIDEWALK AT THE VA-NIHCS MARION, IN CAMPUS.
2. THE CONTRACTOR WILL BE RESPONSIBLE TO VISIT THE SITE TO PERFORM ANY AND ALL REQUIRED MEASUREMENTS AND ELEVATIONS USED IN PREPARATION OF BIDDING DOCUMENTS. ALL DIMENSIONS ARE APPROXIMATE. ALL SITE VISITS MUST BE MADE BY APPOINTMENT WITH THE PROJECT ENGINEER/CONTRACTING OFFICER REPRESENTATIVE (COR).
3. WORK AREAS WILL BE ROPED OFF AROUND WORK SITES. ALL ENTRANCES SHALL REMAIN OPERATIONAL AT ALL TIMES UNLESS PRIOR PERMISSION HAS BEEN OBTAINED BY THE PROJECT ENGINEER/COR. CONTRACTORS WILL BE RESPONSIBLE FOR BLOCKING OFF AREAS AS REQUIRED, FURNISHING THE NECESSARY BARRICADES, SIGNS, FENCING, ETC...
4. TOOLS AND EQUIPMENT WILL BE SECURED ANY TIME WORKERS ARE NOT IN THE IMMEDIATE AREA. THE WORK SITE WILL BE CLEANED UP AT THE CONCLUSION OF EACH DAYS WORK.
5. THE CONTRACTOR WILL FOLLOW ALL APPLICABLE VAMC REGULATIONS, OSHA STANDARDS AND INTERIM LIFE SAFETY MEASURES.
6. IT WILL BE THE CONTRACTORS RESPONSIBILITY TO LOCATE ALL SITE UTILITIES BEFORE DIGGING. IF ANY DAMAGE OCCURS, IT WILL BE REPAIRED AT THE CONTRACTORS OWN EXPENSE PER THE APPROVAL OF THE PROJECT ENGINEER/COR.
7. THE CONTRACTOR WILL TAKE EVERY PRECAUTION TO PREVENT DAMAGING ADJACENT PAVING, SIDEWALKS, SOD, FENCING, ETC... IF DAMAGE OCCURS IT WILL BE FIXED AT THE CONTRACTORS OWN EXPENSE PER THE APPROVAL OF THE PROJECT ENGINEER/COR.
8. ALL DEBRIS WILL BECOME THE PROPERTY OF THE CONTRACTOR AND WILL BE DISPOSED OF OFF STATION IN A PROPER FASHION.
9. THE WORK PERFORMED IN THIS CONTRACT WILL BE CAREFULLY COORDINATED WITH THE PROJECT ENGINEER/COR AND A WORK SCHEDULE WILL BE SUBMITTED BY THE CONTRACTOR FOR APPROVAL PRIOR TO THE START OF ANY WORK. DEMOLISHED AREAS WILL BE REPAIRED WITHIN SEVEN (7) WORKING DAYS OF THEIR REMOVAL. THE CONTRACTOR WILL BE RESPONSIBLE FOR A SCHEDULE ALLOWING A MINIMUM OF TEN (10) DAYS ADVANCE NOTICE OF THE PLANNED START OF WORK/CONSTRUCTION ACTIVITIES.
10. THE CONTRACTOR WILL BE ALLOWED TO WORK AFTER THE CLOSE OF REGULAR BUSINESS HOURS BY APPROVAL ONLY. THIS WILL BE SCHEDULED WITH THE PROJECT ENGINEER/COR AND THE CONTRACTOR WILL REPORT IN AND OUT WITH THE VA POLICE WHEN WORKING AFTER HOURS. HOWEVER, NO CONCRETE WILL BE POURED OTHER THAN REGULAR BUSINESS HOURS. APPROVAL TO POUR CONCRETE WILL BE SUBMITTED BY THE CONTRACTOR FOR APPROVAL BY THE PROJECT ENGINEER/COR WITH A MINIMUM OF 24 HOURS ADVANCED NOTICE.
11. THE CONTRACTOR WILL HAVE ON THE JOB AT ALL TIMES DURING THE PROGRESS A FOREMAN, SUPERINTENDENT OR OTHER COMPETENT REPRESENTATIVE TO WHOM ORDERS AND INSTRUCTIONS MAY BE GIVEN. HIS NAME IS TO BE CERTIFIED TO THE VA AND ANY ORDERS GIVEN TO SUCH REPRESENTATIVE WILL HAVE THE SAME FORCE AND EFFECT AS IF GIVEN DIRECTLY TO THE CONTRACTOR. A PHONE NUMBER WHERE A RESPONSIBLE PERSON CAN BE REACHED AFTER HOURS IN CASE OF PROBLEMS ETC... WILL BE PROVIDED ALSO.
12. CATCH BASIN'S WILL BE TOPPED WITH A HEAVY DUTY INLET FRAME "GRATE" (TYPE A, B OR C). THE FRAME WILL BE EQUAL TO NEENAH R-1772 OR EAST JORDAN 1022.
13. AREAS AROUND THE CATCH BASIN'S GRATE WILL BE REPLACED WITH 5½" THICK 4000 P.S.I. FIBERMESH CONCRETE W/ 4" SLUMP AND #5 REBAR 12" O.C. BOTH WAYS AND BE SLIGHTLY SLOPED INWARD WITH A MEDIUM BROOM FINISH. THE CONCRETE AREA WILL BE A MIN. OF 8'X8'.
14. NEW LINE STRIPPING WILL BE INSTALLED APPROXIMATELY AS SHOWN ON THE DRAWING. NEW POST AND SIGNS WILL ALSO BE INSTALLED TO MATCH EXISTING AND ADDITIONAL POST AND SIGNS WILL BE INSTALL TO MATCH EXISTING WHERE SPECIFIED ON DRAWING.
15. IT WILL BE THE CONTRACTORS RESPONSIBILITY TO PROVIDE EXACT MEASUREMENTS FOR THE LINE STRIPPING DETAIL. ALL STRIPES WILL BE STRAIGHT, CLEAN AND COLORED WHITE. ALL LINE STRIPPING WILL BE PAINTED WITH A REFLECTIVE PAINT.
16. THE CONTRACTOR WILL PROVIDE NEW SIGNS. SIGNAGE WILL BE INSTALLED PLUMB AND LEVEL. POST WILL BE MOUNTED NO LESS THAN 24" BELOW GRADE AND SIGNAGE WILL BE MOUNTED NO LESS THAN 6' ABOVE GRADE. POST WILL BE 3" U CHANNEL POST MOUNTED IN CONCRETE. THE CONTRACTOR WILL REMOVE ANY EXISTING SIGNS AND REPLACE WITH NEW. EXISTING SIGNS WILL REMAIN PROPERTY OF THE VAMC. NEW SIGNS ARE SHOWN ON DRAWING AS S-1, S-2, S-3 AND S-4. SEE SIGN DETAIL. SIZES AND COLOR OF SIGNS WILL MATCH EXISTING.
17. SIDEWALKS WILL BE 5-1/2" THICK FIBERMESH CONCRETE WITH 6" OF COMPACTED #53 AGGREGATE SUB-BASE. THE CONCRETE WILL BE REINFORCED WITH # 4 REBAR 12" O.C. BOTH WAYS. NEWLY REPLACED SECTIONS WILL BE PINNED TO EXISTING SECTIONS WITH # 4 REBAR A MIN. OF 6" DEPTH BOTH WAYS AND ADHERED WITH EPOXY. EXPANSION JOINTS WILL ALSO BE INSTALLED BETWEEN NEW AND EXISTING SECTIONS AND EVERY 50 FEET. THE SURFACE WILL BE FINISHED WITH A MEDIUM BROOM FINISH AND APPROVED CONCRETE SEALER.
18. IT WILL BE THE CONTRACTORS RESPONSIBILITY TO SURVEY ALL ELEVATIONS SO THAT THE PROPER DRAIN SLOPE AND CATCH BASIN DEBTS ARE OBTAINED.

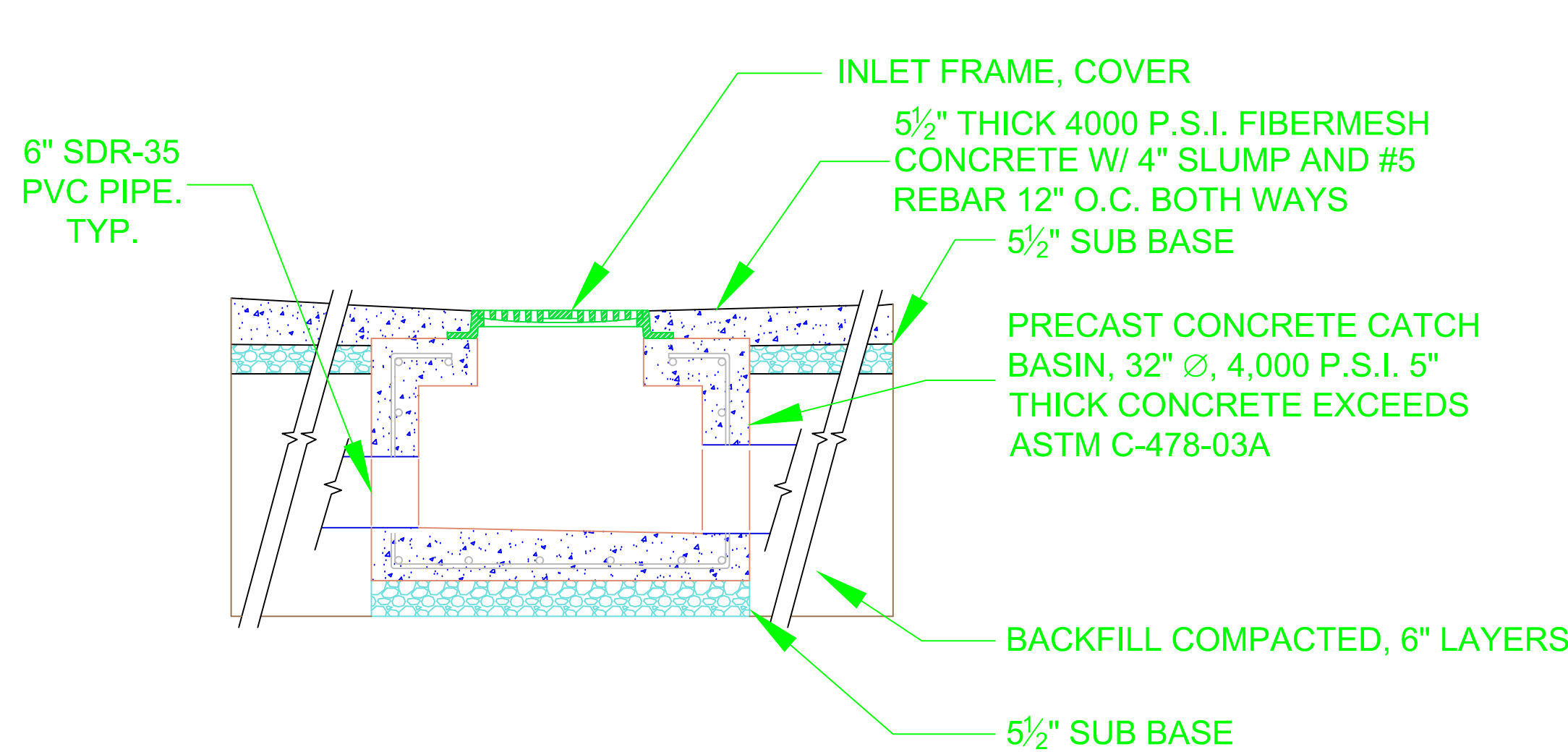

TYPICAL CONCRETE CATCH BASIN DETAIL

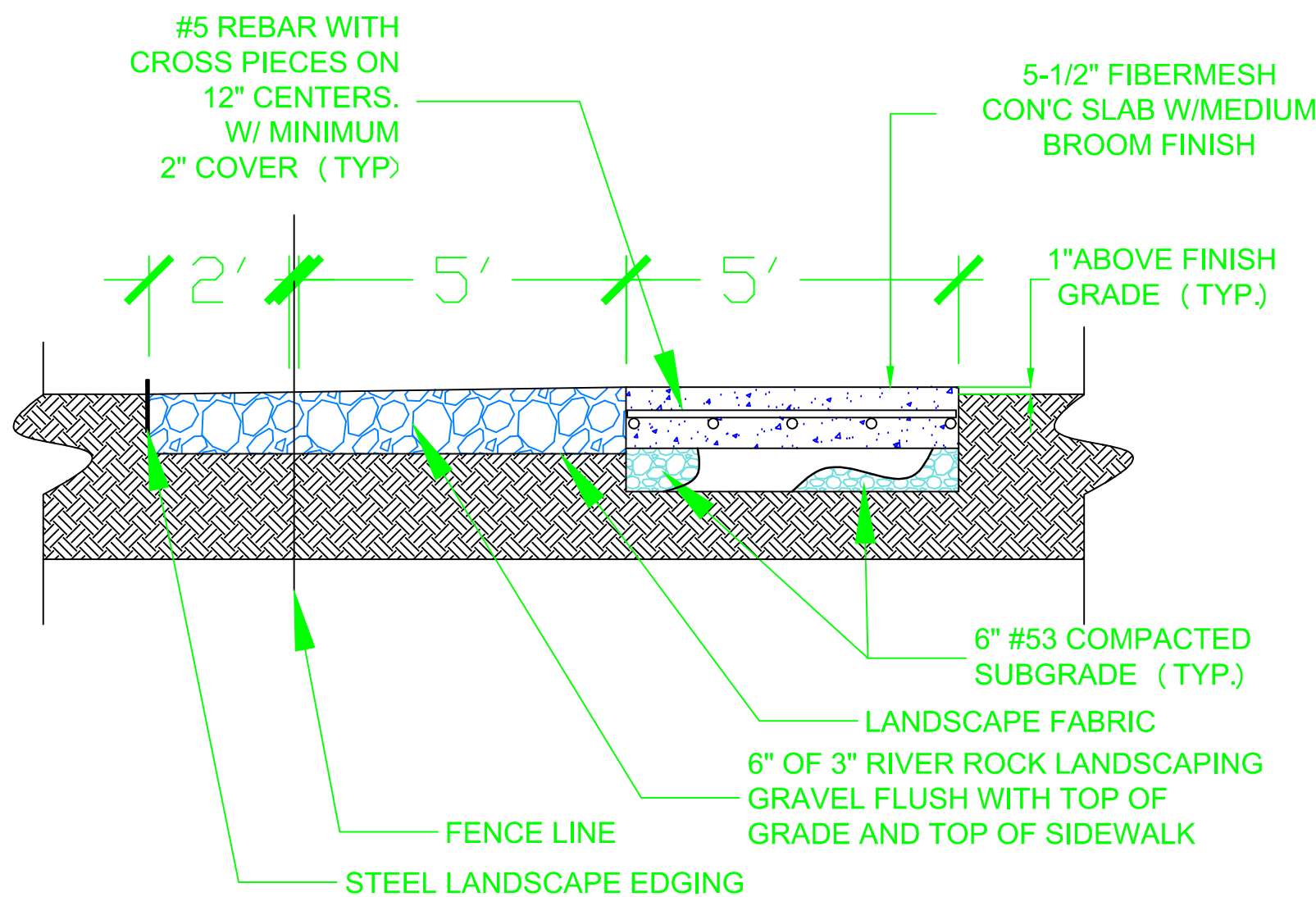

TYPICAL CONCRETE CONSTRUCTION DETAIL

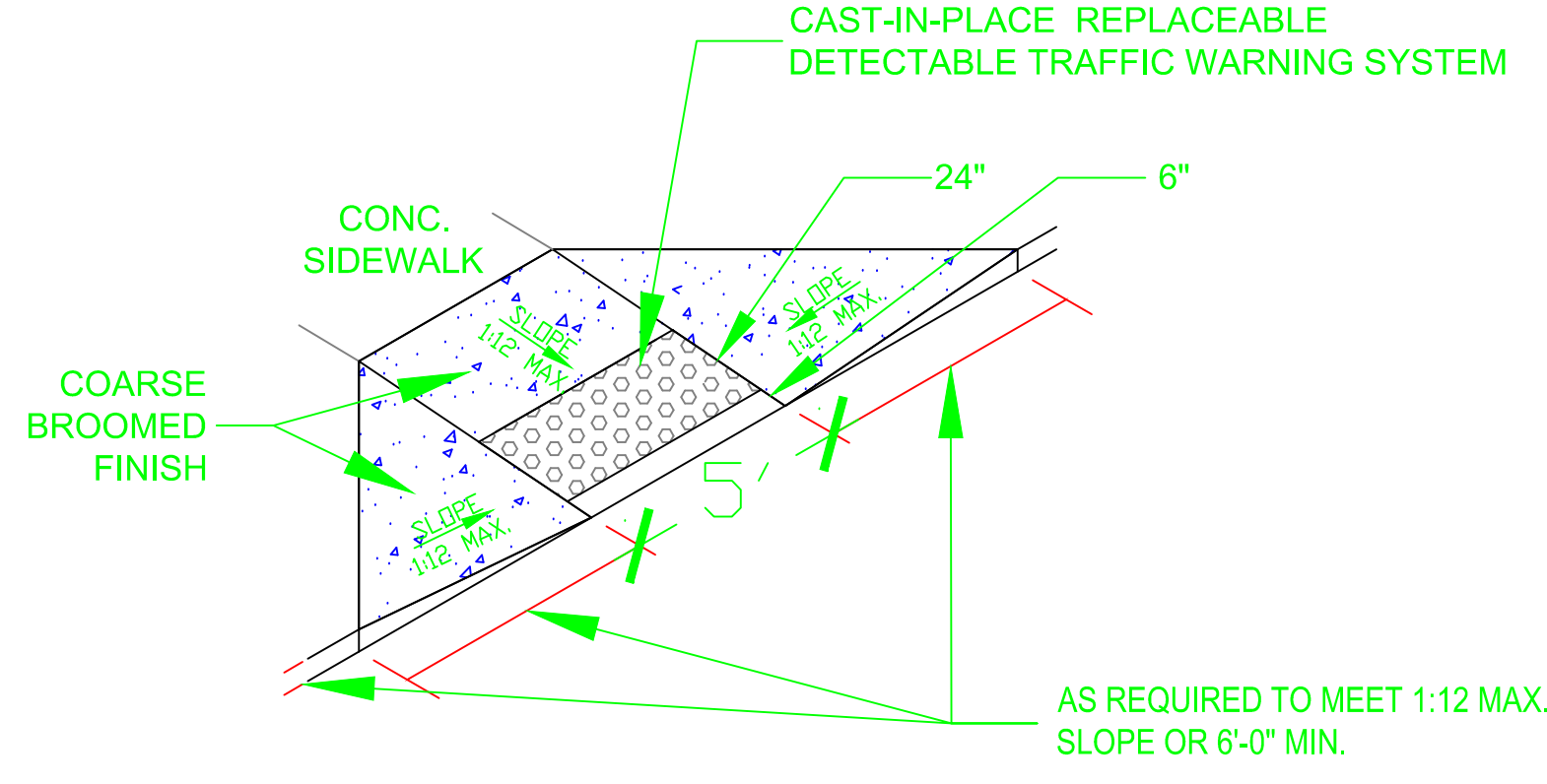

TYPICAL CURB RAMP CONSTRUCTION DETAIL

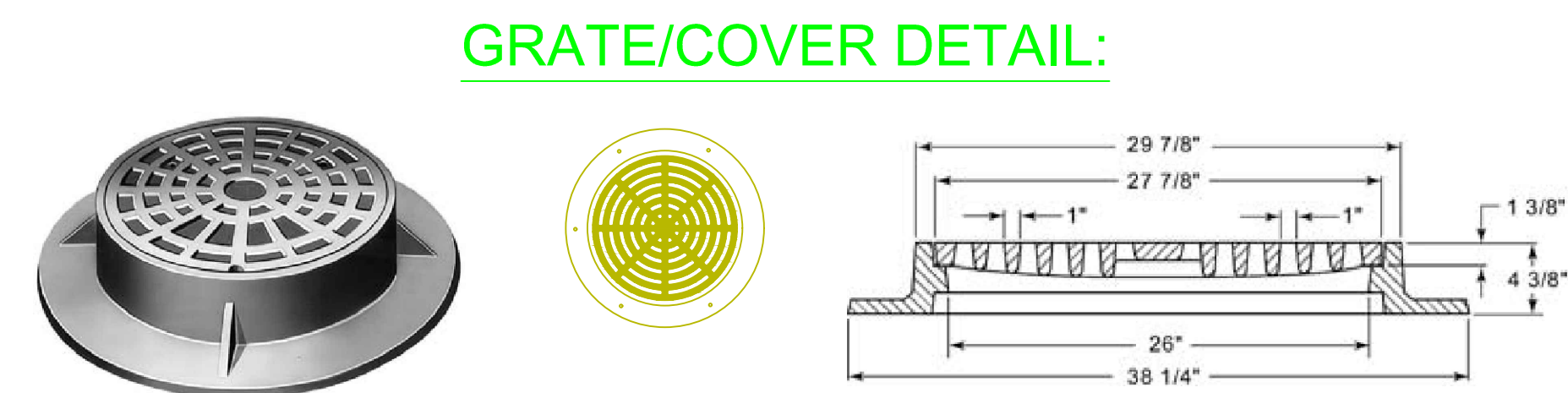

GRATE/COVER DETAIL:



Approved: Medical Center Director
Michael E. Hershman

Approved: Medical Center Assoc. Director
Jay Miller

Approved: Engineering Department
Daniel A. Martin

Drawing Title
GENERAL NOTES AND DETAILS

Approved: Project Director

Project Title
INSTALL PERIMETER SIDEWALK

Location
MARION, IN

Date
11/05/2017

Checked
J. MORRICAL

Drawn
Z. MCDANIEL

Project Number
610-18-501

Building Number
GROUNDS

Drawing Number
18-100M

Dwg. 2 of 2

