

REPLACE DOMESTIC WATER PIPING-NORTH LOOP

HEFNER VAMC,CAMPUS

SALISBURY, NC



Department of
Veterans Affairs

GENERAL NOTES

1. ALL CONSTRUCTION SHALL BE IN ACCORDANCE WITH CONTRACT DOCUMENTS & REQUIREMENTS
2. THE CONTRACTOR SHALL CHECK ALL CONTRACT DOCUMENTS, FIELD CONDITIONS, AND DIMENSIONS FOR ACCURACY AS SHOWN BEFORE PROCEEDING WITH THE CONSTRUCTION. IF THERE ARE ANY QUESTIONS, THE CONTRACTOR SHALL OBTAIN A CLARIFICATION FROM THE GOVERNMENT BEFORE PROCEEDING WITH THE WORK IN QUESTION OR RELATED WORK.
3. DRAWINGS SHALL NOT BE SCALED. WRITTEN DIMENSIONS SHALL ALWAYS GOVERN. CONTRACTOR REQUIRING DIMENSIONS NOT NOTED, SHALL CONTACT THE GOVERNMENT FOR SUCH INFORMATION PRIOR TO PROCEEDING WITH WORK RELATED TO THOSE DIMENSIONS.
4. CONTRACTOR SHALL NOTIFY GOVERNMENT OF CONFLICTS BETWEEN DRAWINGS DETAILS AND SPECIFICATION IN WRITING, PRIOR TO PROCEEDING WITH THE WORK IN QUESTION.
5. "TYPICAL" OR "TYP." MEANS THAT THE CONDITION IS REPRESENTATIVE FOR ALL SIMILAR CONDITIONS, UNLESS OTHERWISE NOTED. "SIMILAR" OR "SIM" MEANS COMPARABLE CHARACTERISTICS FOR THE CONDITIONS NOTED. VERIFY DIMENSIONS AND ORIENTATION ON PLANS AND ELEVATIONS. "ALIGN" AS USED IN THESE DOCUMENTS MEANS TO ACCURATELY LOCATE FINISHES IN THE SAME PLACE.
6. "AS REQUIRED" MEANS AS REQUIRED BY REGULATORY REQUIREMENTS, BY REFERENCED STANDARDS, BY EXISTING CONDITIONS, BY GENERALLY ACCEPTED CONSTRUCTION PRACTICE OR BY THE CONTRACT DOCUMENTS.
7. CONTRACTOR SHALL PROVIDE ALL NECESSARY BLOCKING, BACKING, FRAMING HANGERS OR OTHER SUPPORTS OF ALL FIXTURES, EQUIPMENT, FURNISHINGS, AND ALL OTHER ITEMS REQUIRING SAME.
8. THE CONTRACTOR SHALL BE RESPONSIBLE FOR ALL CUTTING AND PATCHING FOR PROPER INSTALLATION OF MATERIAL AND EQUIPMENT.
9. ALL PENETRATIONS THROUGH MASONRY AND CONCRETE STRUCTURES SHALL BE SEALED TO PROTECT AGAINST FIRE WITH ENVIRONMENTAL CONDITIONS THAT EXIST.
10. CONTRACTOR TO SUBMIT MOBILIZATION PLAN TO GOVERNMENT FOR APPROVAL BEFORE MOBILIZATION OF THE JOB CAN TAKE PLACE.
11. CONTRACTOR NOT TO PARK IN PATIENT PARKING LOTS OR EMPLOYEE PARKING ONLY ON DESIGNATED BY COTR. CONTRACTOR TO COORDINATE WITH COTR FOR PARKING AREAS AND PROPER ACCESS TO CONSTRUCTION AREA.
12. BEFORE STARTING WORK IN A NEW AREA OR MOVEMENT OF EQUIPMENT ONE AREA TO ANOTHER, COORDINATION WITH THE FACILITY AND GOVERNMENT IS REQUIRED TO ENSURE PATIENT SAFETY.
13. IT IS THE CONTRACTOR'S RESPONSIBILITY TO MAKE THE PROPER COORDINATION IN ADVANCE FOR MAJOR INTERRUPTIONS (15 CALENDAR DAYS) AND ANY DELAY OF WORK DUE TO IMPROPER NOTICE WILL BE RESPONSIBILITY OF THE CONTRACTOR NOT THE GOVERNMENT.
14. AT ANY TIME IMPROPER PROCEDURES ARE OBSERVED THAT PUT PATIENT SAFETY, STAFF, OR CONTRACTOR WORKERS SAFETY AT RISK, THE WORK WILL BE STOPPED UNTIL CORRECTIONS ARE MADE AND APPROVED BY THE GOVERNMENT AND THE CONTRACTOR WILL BE HELD RESPONSIBLE FOR ANY DELAY DUE TO IMPROPER ADHERENCE TO THE CONTRACT/DOCUMENTS AND/OR SAFETY REGULATIONS.
15. BEFORE ANY NEW ELECTRICAL, MECHANICAL, AND/OR SITE MODIFICATIONS THE CONTRACTOR MUST NOTIFY THE GOVERNMENT 72 HOURS IN ADVANCE FOR PROPER COORDINATION TO ENSURE PATIENT, STAFF, AND CONTRACTOR WORKERS SAFETY.
16. CONTRACTOR TO REMOVE ALL DEBRIS FROM CONSTRUCTION AREA THAT MIGHT EFFECT GOVERNMENT OPERATIONS AND EACH DAY PERFORM HOUSE KEEPING OPERATIONS TO ENSURE CLEAN WORK AREA.

SPECIAL CONCERNS

1. DUE TO WORK BEING DONE IN AN ACTIVE HOSPITAL SPECIAL PRECAUTIONS AND COORDINATION MUST BE TAKEN BEFORE ANY WORK CAN BE DONE.
2. MOBILIZATION PLAN MUST BE SUBMITTED TO THE GOVERNMENT AND APPROVED. MOBILIZATION PLAN MUST ADDRESS DUST CONTROL MEASURE, MOVEMENT OF MATERIALS, CONTROL METHODS DURING CONSTRUCTION, TRAFFIC CONTROL, AND DEMOBILIZATION OUTLINE.
3. ALL WORK SHALL BE DONE IN A PROFESSIONAL MANNER AND AT ALL TIMES WORKERS WILL CONDUCT THEMSELVES IN A WAY AS NOT TO DISTURB NORMAL HOSPITAL OPERATIONS.
4. THE GOVERNMENT RESERVED THE RIGHT TO REMOVE ANY PERSONNEL FROM THE JOB SITE FOR ANY FAILURE TO ADHERE TO THE CONTRACT/DOCUMENTS AND/OR SAFETY REGULATIONS AND WILL BE AT THE COST OF THE CONTRACTOR DUE TO FAILURE TO ADHERE TO CONTRACT/DOCUMENTS AND/OR SAFETY REGULATIONS.
5. AT ALL TIMES CONTRACTORS SHALL WEAR ID BADGES AND PROPER PPE.
6. CONTRACTOR WORKERS MUST COMPLETE 2 DVD INFECTION CONTROL INFORMATION SESSION BEFORE ANY WORK CAN BEGIN.

DRAWING INDEX

GENERAL

- G-101
- G-102
- G-103
- COVER SHEET
- UTILITIES & STEAM LINES
- OPTIONS (DEDUCTS)

CIVIL

- C-101
- C-102
- C-103

- STANDARD DETAILS
- ASPHALT PAVING & REPAIR
- BACK-FLOW PREVENTER HOUSES

MECHANICAL

- U-001
- U-101

- NOTES AND DETAILS
- EXISTING, REPLACING, AND NEW DOMESTIC WATER LINES

LOCATION MAP

KEY PLAN

PROJECT DESCRIPTION

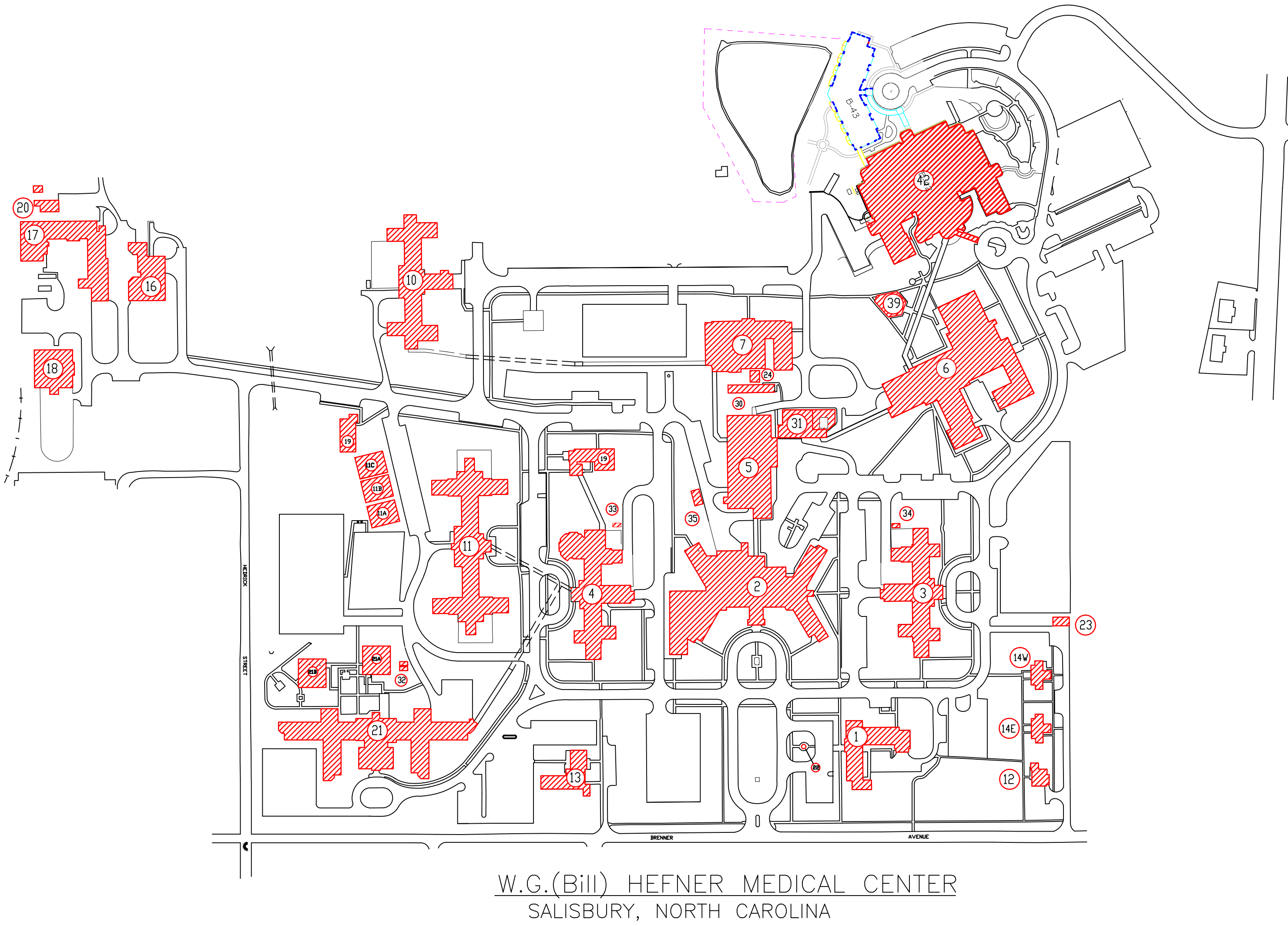

STATEMENT OF WORK:

THE WORK INCLUDES, BUT NOT LIMITED REPLACEMENT OF EXISTING UNDERGROUND DOMESTIC WATER LINES. REPLACEMENT WILL OCCUR THROUGHOUT VAMC SALISBURY CAMPUS. NOTE THAT THE EXISTING SYSTEM CAN NOT BE TAKEN OFF-LINE FOR ANY LENGTH OF TIME SO, PHASING AND/OR TEMPORARY UTILITIES NEED TO BE COORDINATED WITH COR PRIOR TO BEGINNING OF ANY WORK AS PER SPECIFICATIONS. CONTRACTOR TO DETERMINE BEST METHOD AND LOCATION OF EXCAVATION AND REPLACEMENT BASED ON EXISTING SITE CONDITIONS, DRAWINGS, AND SPECIFICATIONS. CONTRACTOR TO DETERMINE FINAL QUANTITY OF SIDEWALK, CURB, PAVEMENT, AND GRASS REPAIR AND OR REPLACEMENT BASED ON ACTUAL ROUTE THROUGH FACILITY.

PROJECT DATA

PROJECT ADDRESS

W.G. (BILL) HEFNER VA MEDICAL CENTER
1601 BRENNER AVE.
SALISBURY, NC 28144

RECOMMEND APPROVAL

REQUESTER	Date	CHIEF OF STAFF	Date
CHIEF OF SERVICE	Date	CHIEF OF STAFF	Date
ASSOC. DIR. PATIENT CARE SVC.	Date	ASSOC. DIR. for OPERATIONS	Date
APPROVAL BY:	Date		
MEDICAL CENTER DIRECTOR			

Drawing Title

COVER SHEET

Approved: Safety Manager/M&O Supervisor

Approved:Chief of Facilities Management Svr.

Project Title

REPLACE DOMESTIC WATER
PIPING-NORTH LOOP

Building Number

Checked

Drawn

BLF

Location

W.G.(Bill) Hefner Medical Center
1601 Brenner Ave.
Salisbury NC 28144

Date

29 JUNE 2012

Project No.

659-12-253

DRAWING NO.

G-101

DWG. 1 OF 8



Department of
Veterans Affairs