

one-eighth inch = one foot

0 4 8 16

An aerial photograph of the University of Illinois at Chicago campus. The central feature is a large, complex academic building with multiple interconnected wings and a central courtyard. Surrounding the building are extensive parking lots filled with cars. To the right of the main building complex is a large, open field, likely a sports field or stadium. The campus is bordered by roads, including a multi-lane highway on the left side of the image. The overall layout shows a well-organized urban campus environment.

An aerial photograph of the University of North Carolina at Chapel Hill campus. The image shows the main building complex, including the Old East Building and the Old South Building, which are connected by a walkway. Surrounding the buildings are several large parking lots, some of which are filled with cars. There are also green spaces, including a large lawn in the foreground and a wooded area to the right. The image is oriented vertically, with the top of the page showing the top of the campus.

## Ft Snelling

Office of  
Facilities  
Management

Department of  
Veterans Affairs









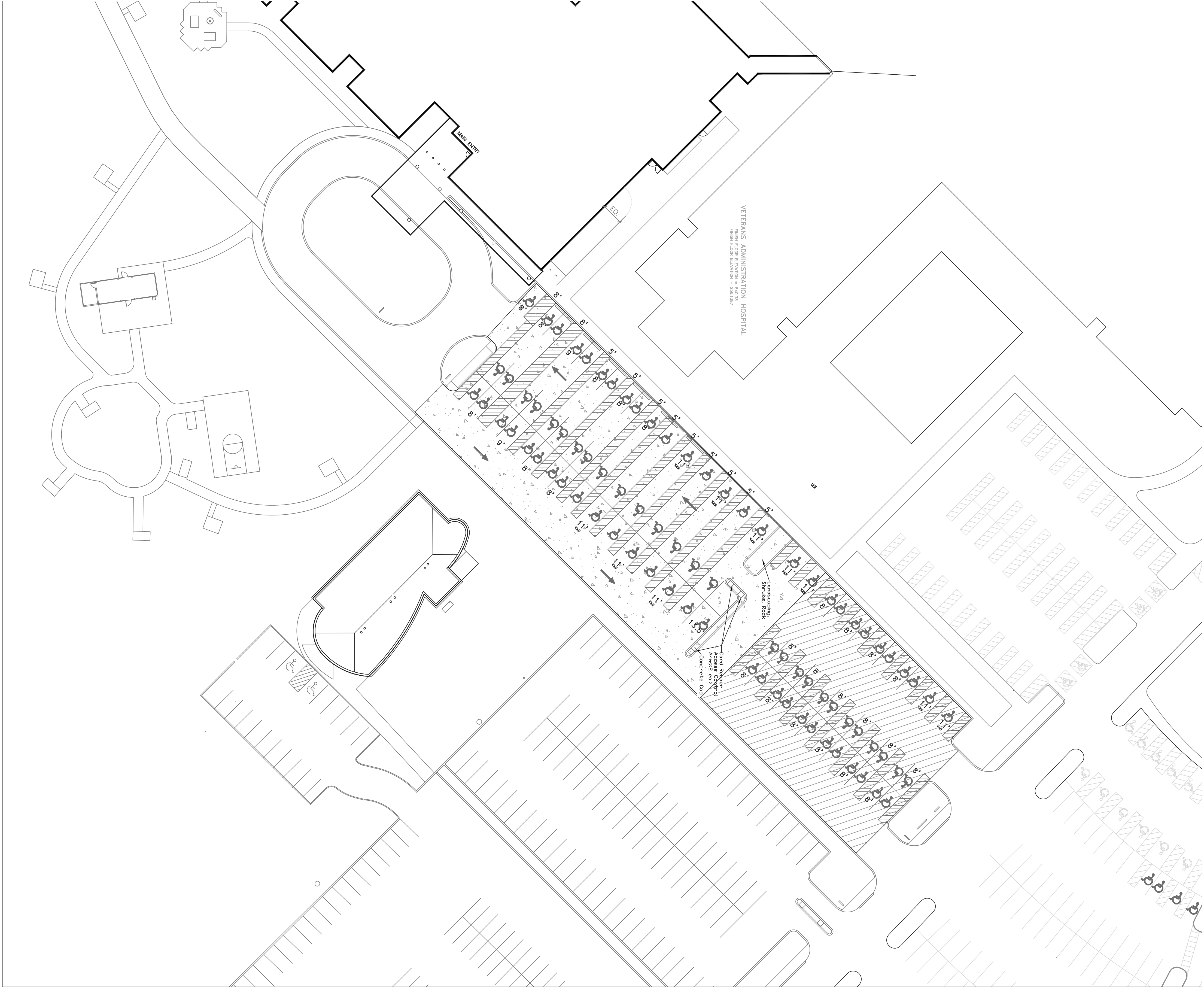
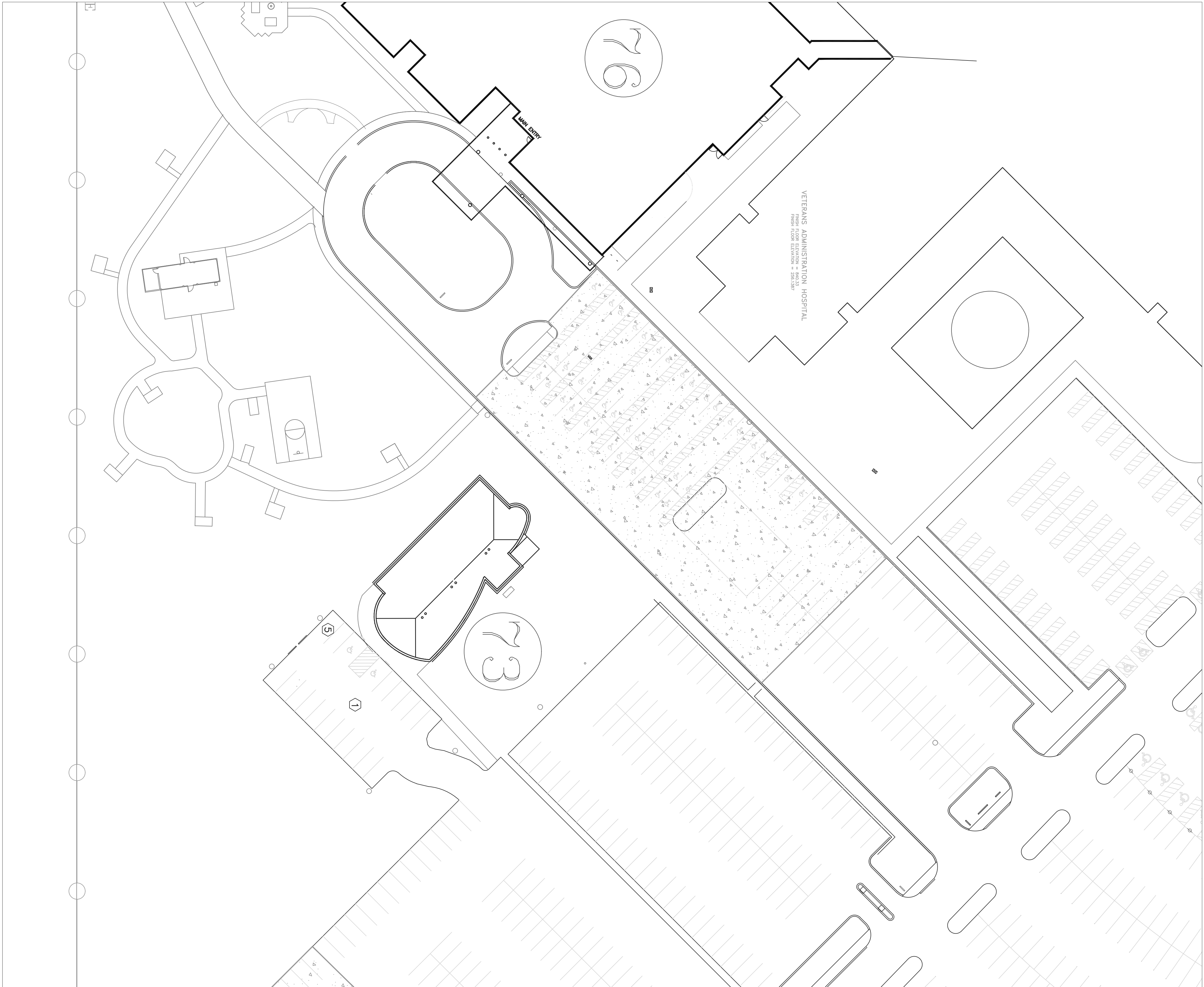
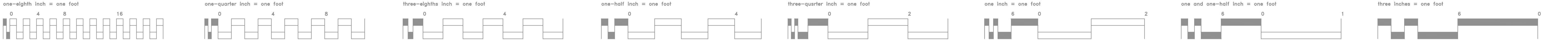

# EXISTING CONFIGURATION

## Notes:

1. Removal and Demolition of Island curbing and fill, Remove of Asphalt 'bumpers', Any other Demo required to complete project As Stated in the SOW
2. Installation of new Electrical, Commn, Curbing, Fill, Landscaping, Concrete Cap, Control arms, and card reader as required per concept and SOW
3. Apply an emulsion layer within indicated area and, paint new Handicap parking striping per concept.
4. Install new vehicle barriers, and hydro seed as necessary.

# PLANNED MODIFICATIONS

Handicap parking within hatched area covered under Base Bid Item 6, Handicap Remarking

Approximate limits of Asphalt Emulsion Resurfacing

REVISIONS	DATE

**GENERAL NOTES:**

GENERAL CONTRACTOR AND/OR ALL SUBCONTRACTORS SHALL FIELD VERIFY ALL DIMENSIONS SHOWN ON THESE PLANS AND SHALL BE RESPONSIBLE FOR VARIATIONS BETWEEN PLANNED DIMENSIONS AND ACTUAL FIELD DIMENSIONS. WHERE VARIATIONS ARE FOUND TO OCCUR, THE WORK WILL BE MADE WITHOUT THE PRIOR APPROVAL OF THE PROJECT ENGINEER.

GENERAL CONTRACTOR SHALL BE RESPONSIBLE FOR GENERAL DEMOLITION INCLUDING REMOVAL OF WALLS, PARTITIONS, DOORS, & CEILING & FLOORS. ANY AND ALL CUTTING OF CONCRETE FLOORS, WALLS OR STRUCTURE SHALL BE THE GENERAL CONTRACTOR'S RESPONSIBILITY. THE SUBCONTRACTOR SHALL BE RESPONSIBLE FOR THE REMOVAL OF ALL DEMOLITION DEBRIS. THE SUBCONTRACTOR SHALL BE RESPONSIBLE FOR THE REMOVAL OF ALL DEMOLITION DEBRIS RESULTING FROM DEMOLITION CUTTING, AND/OR DRILLING IS THE RESPONSIBILITY OF THE GENERAL CONTRACTOR. THIS WILL BE ACCOMPLISHED UPON COMPLETION OF THE INSTALLATION OF ANY AND ALL UTILITIES INSTALLED BY THE VARIOUS SUBCONTRACTORS.

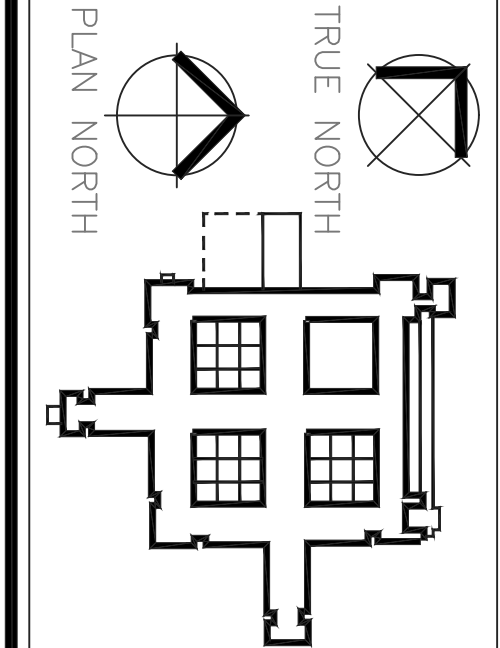

PROJECT COPY THIS PLAN, REVISIONS OR DELETIONS, DIRECT REVISIONS AND THAT IT IS A TRUE REPRESENTATION OF THE WORK AND THE LINES OF THE STATE OF MINNESOTA

Drawing Scale: 1/32" = 1'-0"

Plot Scale: 1/2" = 1'-0"

Drawing Title: SC/D Parking Lot Alteration

Project Title: Upgrade Roads and Parking Lots Phase III

Location: VA MEDICAL CENTER ONE VETERANS DRIVE MINNEAPOLIS, MN 55417

Date: 6/06/2012

Checked: JBD

Drawn: M/H

Project No.: 12-123

Building Number: 1256-A2

Site: 1256-A2

Office of Facilities Management

Department of Veterans Affairs

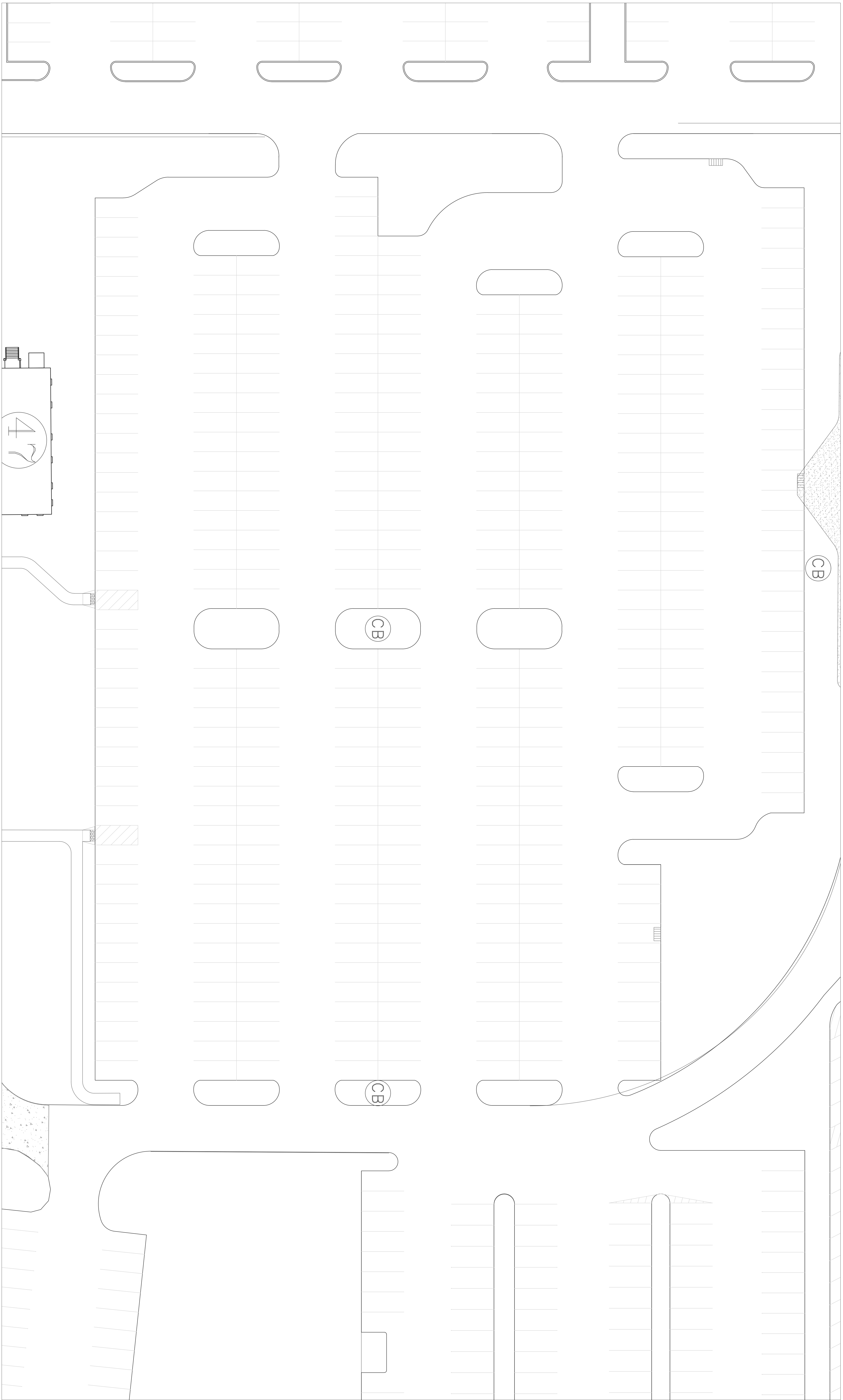
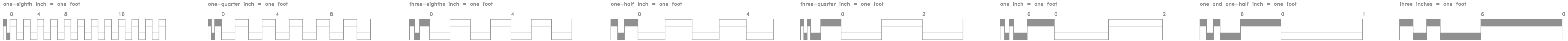

- Notes:
1. Purchase 3 Lexan M200 CDMA Emergency Call boxes and all associated equipment, (P/N 4421-0176) or approved equal.
  2. Install new equipment on existing post foundations per manufacturer instructions and provided owners manual (Attachment 2)
  3. Program with corresponding ESN and Verizon cell phone numbers per attachment.

1/16" = 1'-0"  
Emergency Call Box **CB**

REVISIONS		DATE
GENERAL NOTES:		
GENERAL CONTRACTOR AND/OR ALL SUBCONTRACTORS SHALL FIELD VERIFY ALL DIMENSIONS SHOWN ON THESE PLANS AND SHALL BE RESPONSIBLE FOR VARIATIONS BETWEEN PLANNED DIMENSIONS AND ACTUAL FIELD DIMENSIONS. WHERE VARIATIONS ARE FOUND TO OCCUR, THE WORK WILL BE MADE WITHOUT THE PRIOR APPROVAL OF THE PROJECT ENGINEER.		
GENERAL CONTRACTOR SHALL BE RESPONSIBLE FOR GENERAL DEMOLITION INCLUDING REMOVAL OF WALLS, PARTITIONS, DOORS, & CEILING & FLOORS. ANY AND ALL CUTTING OF CONCRETE FLOORS, WALLS OR STRUCTURE SHALL BE THE GENERAL CONTRACTOR'S RESPONSIBILITY. THE SUBCONTRACTOR SHALL BE RESPONSIBLE FOR THE REMOVAL OF DEBRIS RESULTING FROM DEMOLITION, CUTTING, AND/OR DRILLING IS THE RESPONSIBILITY OF THE GENERAL CONTRACTOR. THIS WILL BE ACCOMPLISHED UPON COMPLETION OF THE INSTALLATION OF ANY AND ALL UTILITIES INSTALLED BY THE VARIOUS SUBCONTRACTORS.		

TRUE NORTH  
PLAN NORTH

HEREBY CERTIFY THAT THIS PLAN, SPECIFICATION OR DRAWING WAS PREPARED BY ME OR UNDER MY DIRECT SUPERVISION AND THAT I AM A LICENSED PROFESSIONAL ENGINEER IN THE STATE OF MINNESOTA. Registration Number:		Drawing Title	Project Title		Project No.	
Drawing Scale 1/16"=1'-0"	Approved: Service Director	Lot 11 Emergency Call Box	Date 6/1/2012	Location VA MEDICAL CENTER ONE VETERANS DRIVE MINNEAPOLIS, MN 55417	Building Number 125-123	Site
Plot Scale 1/2" = 1'-0"	Checked JED	Drawn M/H			DRAWING NO. 1256-A3	

Office of Facilities Management

Department of Veterans Affairs

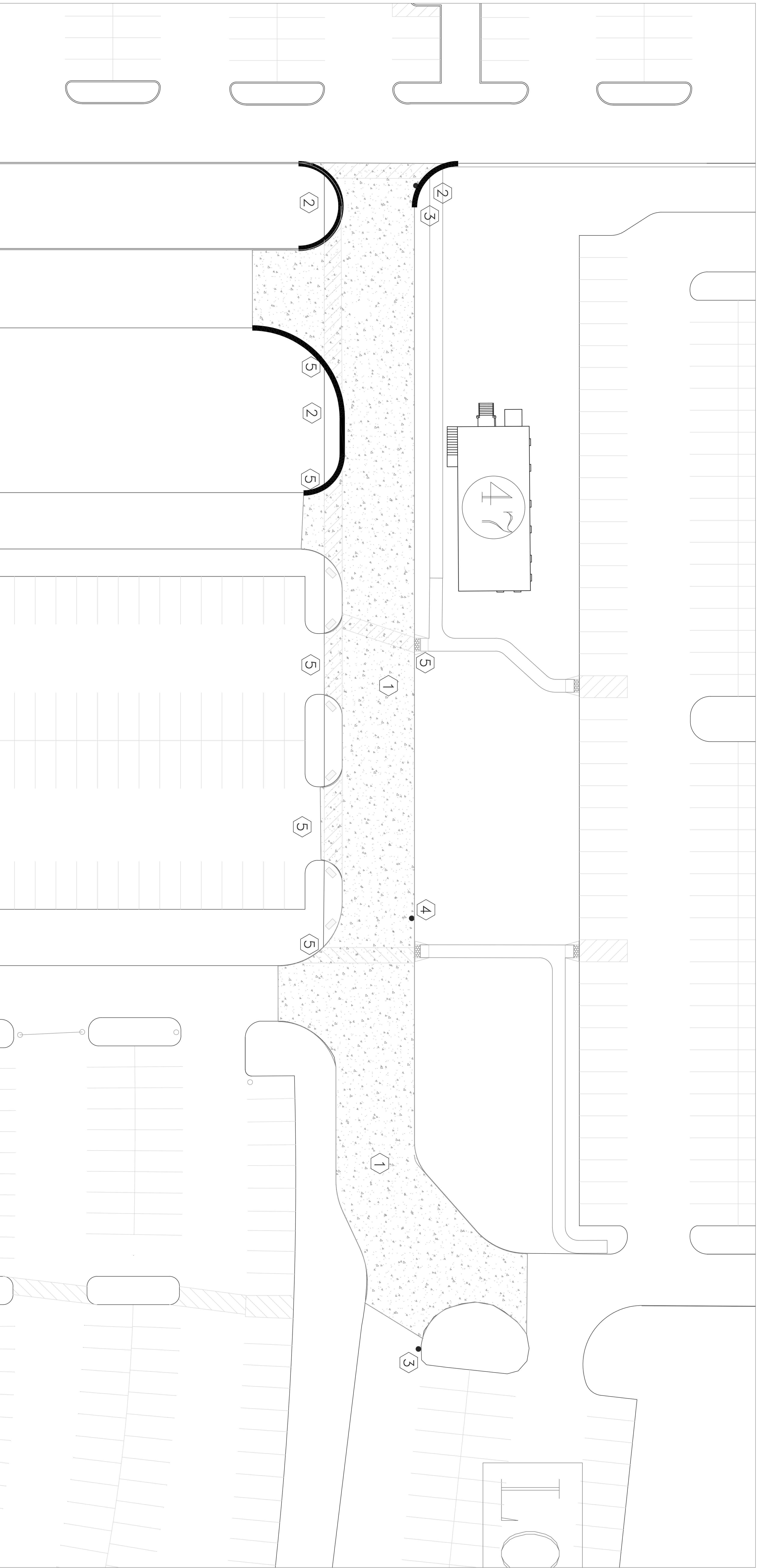
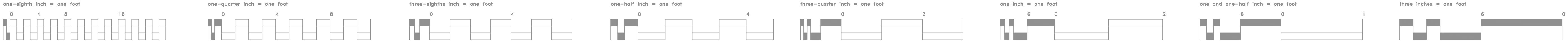

1. Full Depth Pavement Rehabilitation of approximately 1930 SY Bituminous paving. To include compaction of sub base and installation of 5" Asphalt system (3" base, 2" wear)
2. Removal of Existing Sidewalk and Curbing. Installation of 2 ADA compliant Ramps. Installation of new curbing and Sidewalk.
  - 2.1. Ramps to include 1:12 slope ratio and installation of Truncated dome plates per VA Standards.
  - 2.2. Curbing to be of a design similar to Mn/DOT type D412. Connection to existing curbing Mn/DOT Type V612 shall be by expansion joint. Transition slope to match existing curbing shall occur in no less than 36".
3. Replace existing Storm drain inlet with "Mountable Curb Inlet"
- 3.1. See Pacific Marine R-3506-A2 thru R-3517 series for design example
4. Replace existing Elena Foundry Storm Drain Inlet "Curb Box" with new Full depth "Curb Box"
- 4.1. See Neenah Foundry R-3229-A for design example.
- 4.2. The intent of the government is to improve only the curb box.
5. Repaint pedestrian crosswalk per specifications

REVISIONS

NO.	DESCRIPTION	DATE

GENERAL NOTES

GENERAL CONTRACTOR AND/OR ALL SUBCONTRACTORS SHALL FIELD VERIFY ALL DIMENSIONS SHOWN ON THESE PLANS AND SHALL BE RESPONSIBLE FOR VARIATIONS BETWEEN PLANNED DIMENSIONS AND ACTUAL FIELD DIMENSIONS. WHEN VARIATIONS ARE FOUND TO OCCUR, THE WORK WILL BE MADE WITHOUT THE PRIOR APPROVAL OF THE PROJECT ENGINEER.

THE GENERAL CONTRACTOR SHALL BE RESPONSIBLE FOR GENERAL DEMOLITION INCLUDING REMOVAL OF WALLS, PARTITIONS, DOORS, & CEILING & FLOORS. ANY AND ALL CUTTING OF CONCRETE FLOORS, WALLS OR STRUCTURE SHALL BE THE GENERAL CONTRACTOR'S RESPONSIBILITY. THE SUBCONTRACTOR SHALL BE RESPONSIBLE FOR THE REMOVAL OF EXISTING CURBING AND THE INSTALLATION OF NEW CURBING. THE REMOVAL OF EXISTING CURBING AND THE INSTALLATION OF NEW CURBING SHALL BE THE RESPONSIBILITY OF THE GENERAL CONTRACTOR. THIS WILL BE ACCOMPLISHED UPON COMPLETION OF THE INSTALLATION OF ANY AND ALL UTILITIES INSTALLED BY THE VARIOUS SUBCONTRACTORS.

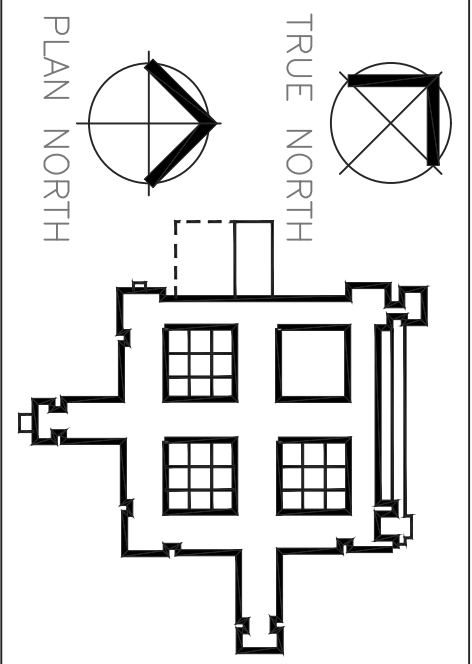

HEREBY CERTIFY THAT THIS PLAN, SPECIFICATION OR DRAWING WAS PREPARED BY ME OR UNDER MY DIRECT SUPERVISION AND THAT I AM A LICENSED PROFESSIONAL ENGINEER IN THE STATE OF MINNESOTA. Registration Number:	Drawing Title		Project Title	
	Building 47 Street Repair		Upgrade Roads and Parking Lots Phase III	
Drawing Scale 1/16"=1'-0"	Approved: Service Director	Location VA MEDICAL CENTER ONE VETERANS DRIVE MINNEAPOLIS, MN 55417	Date 6/06/2012	Building Number 1256-A4
Plot Scale 1/2" = 1'-0"	Checked JED	Drawn M/H		



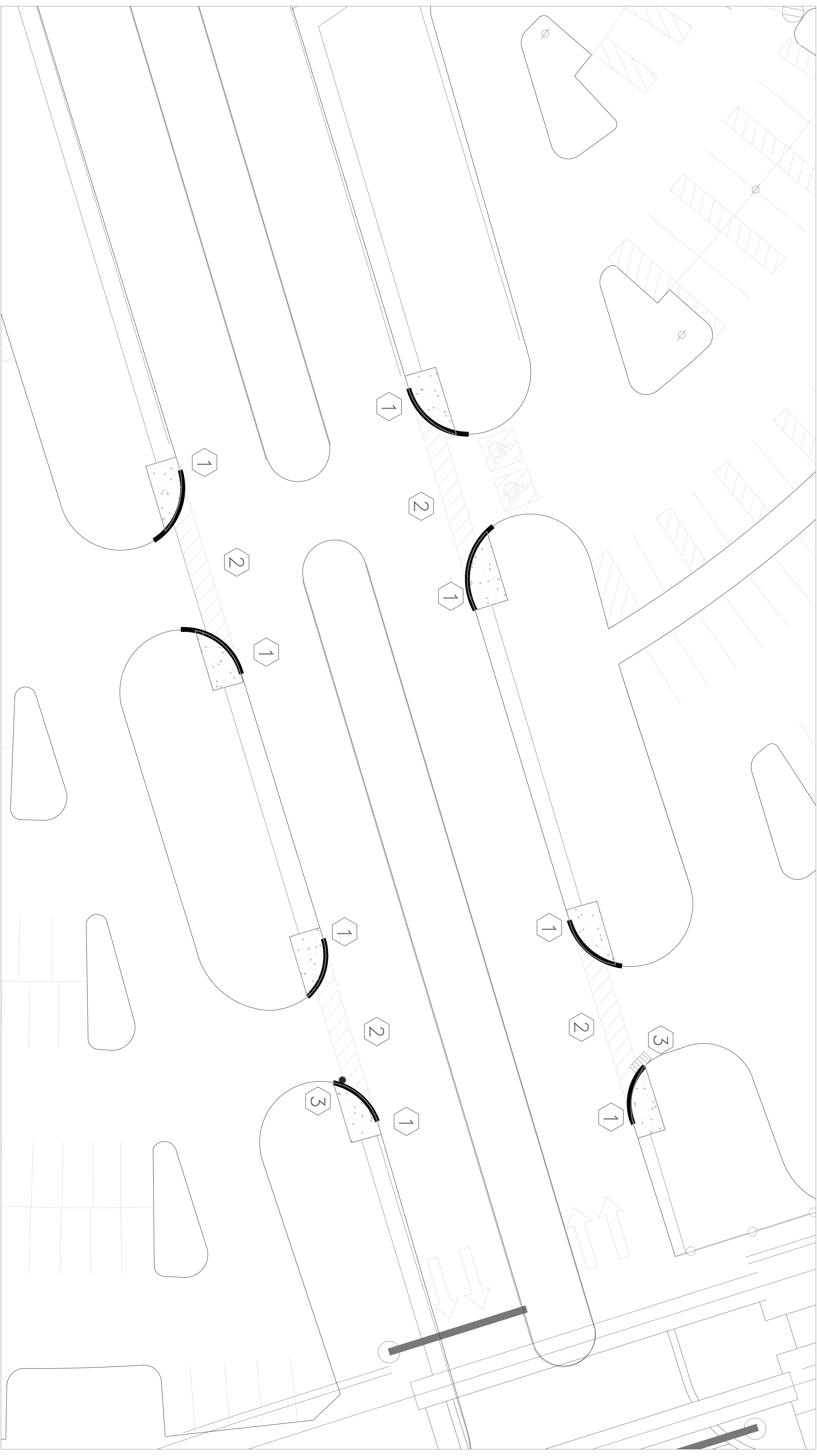
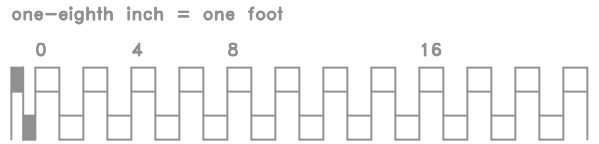
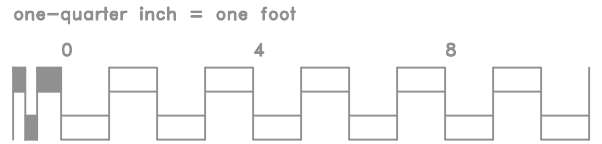
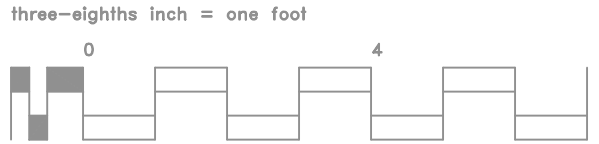
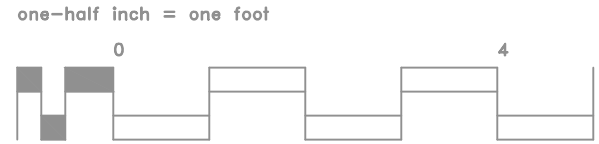
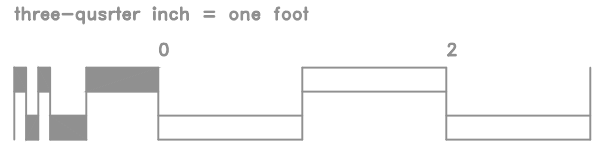
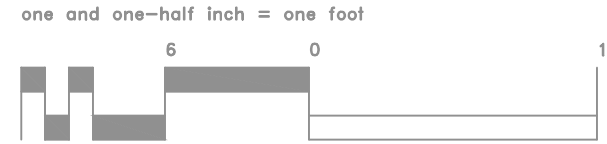
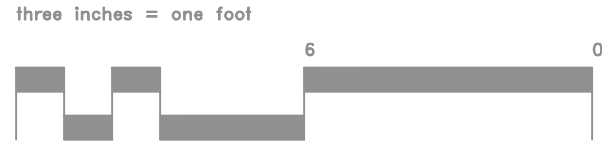

- Notes:
1. Removal of Existing affected Sidewalk and Curbing. Installation of "VA Barrier Free Design Guide" compliant Ramps. Installation of new curbing and Sidewalk.
    - 1.1. Ramps to include 1:12 slope ratio and maintain full sidewalk width. Installation of Truncated dome plates per VA Standards.
    - 1.2. Curbing to be of a design similar to Mn/DOT type D412. Connection to existing curbing Mn/DOT Type V612 shall be by expansion joint. Transition slope to match existing curbing shall occur in no less than 36".
  2. Repaint pedestrian crosswalk per specifications
  3. Replace existing Storm drain Inlet with "Mountable Curb Inlet"
    - 3.1. See Pacific Marine R-3506-A2 thru R-3517 series for design example

## Approximate limits of Asphalt construction

Approximate location of curbing repair

[illegible]

## GENERAL NOTES:

I HEREBY CERTIFY THAT THE PLAN, SPECIFICATION OR REPORT WAS PREPARED BY ME OR UNDER MY DIRECT SUPERVISION AND THAT I AM A DULY LICENSED PROFESSIONAL ENGINEER UNDER THE LAWS OF THE STATE OF MINNESOTA.

REGISTRATION NUMBER: \_\_\_\_\_

Drawing Scale

$1/16" = 1'0"$

Plot Scale

$12" = 1'-0"$

Drawing Title	Veterans Drive Pedestrian Ramp Repair
Approved: Division Chief	
Approved: Service Director	

Project Title	Upgrade Roads and Parking Lots		
Location	V.A. MEDICAL CENTER ONE VETERANS DRIVE MINNEAPOLIS, MN 55417		
Date	6/08/2012	Checked	TBD
		Drawn	MAH

Project No.	12-123
Building Number	Site
DRAWING NO.	1256-A5
Dwg. 6 of 14	

Office of  
Facilities  
Management

Department of  
Veterans Affairs

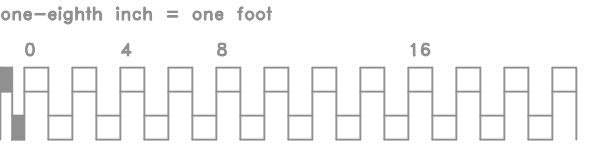
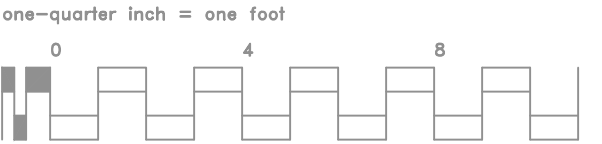
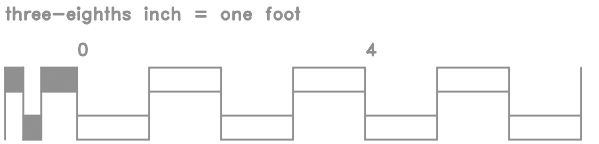
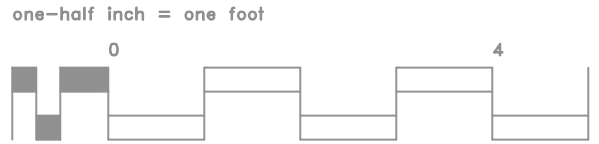
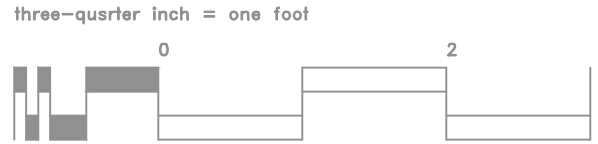
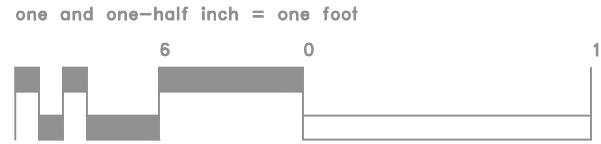
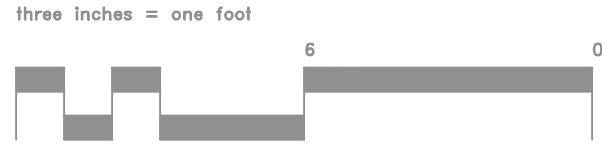

- Notes:
1. Full Depth Pavement Rehabilitation of approximately 3700 SY Bituminous paving. To include compaction of sub base and installation of 4" Asphalt system (2" base, 2" wear)
  2. Removal and Installation of Indicated Curbing. Curbing to be of a design similar to Mn/DOT type D412. Connection to existing curbing Mn/DOT type V612 shall be by expansion joint. Transition slope to match existing curbing shall occur in no less than 36'.
  3. Replace existing Neenah Foundry Storm Drain inlet "Curb Box" with new Full depth "Curb Box"
  - 3.1. See Neenah Foundry R-3229-A for design example.
  - 3.2. The intent of the government is to improve only the curb box.
  - 3.3. Repaint lot markings per specifications

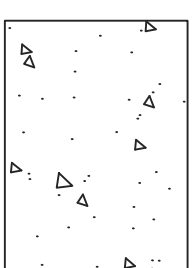

## Approximate limits of Asphalt construction

Approximate location of curbing repair

$$1/8'' = 1'-0''$$

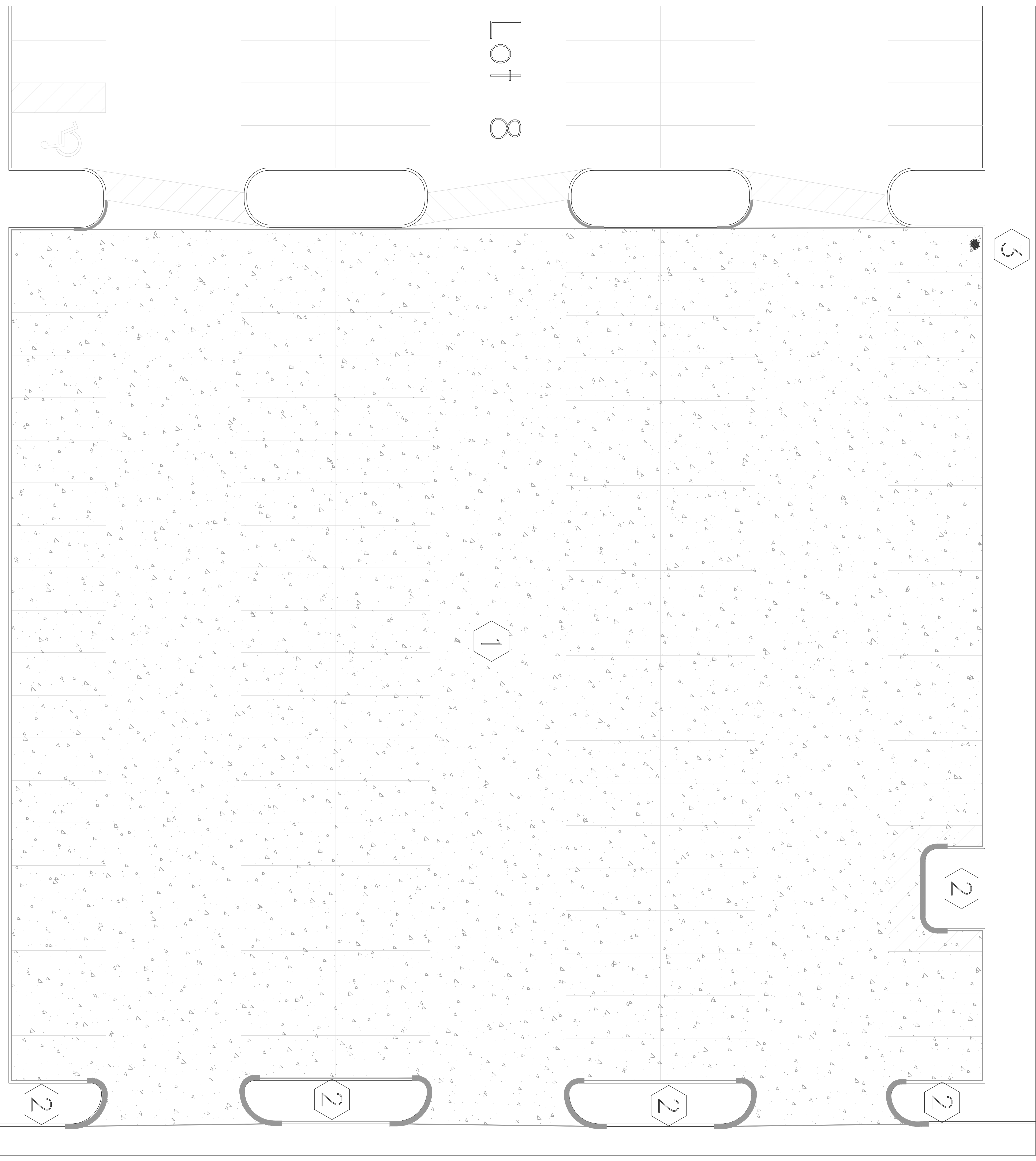
[illegible]

GENERAL  
NOTES:

GENERAL CONTRACTOR SHALL FIELD VERIFY ALL DIMENSIONS SHOWN ON THESE PLANS AND SHALL BE RESPONSIBLE FOR CORRECTING ANY DISCREPANCIES. THE GENERAL CONTRACTOR SHALL OBTAIN THE CONTRACTOR SHALL OBTAIN THE PROJECT ENGINEER IN WRITING PRIOR TO PROCEEDING WITH CONSTRUCTION; NO ADJUSTMENT TO THE WORK WILL BE MADE WITHOUT THE PRIOR APPROVAL OF THE PROJECT ENGINEER.

GENERAL CONTRACTOR SHALL BE RESPONSIBLE FOR GENERAL DEMOLITION INCLUDING REMOVAL OF WALLS, PARTITIONS, DOORS & PARTITIONS, CEILING, FLOORS, ROOFING, MECHANICAL, ELECTRICAL, PLUMBING, AND ALL OTHERS. THE GENERAL CONTRACTOR SHALL BE RESPONSIBLE FOR THE REMOVAL OF ALL MATERIALS AND DEBRIS RESULTING FROM DEMOLITION, CUTTING, AND/OR DRILLING TO THE EXTENT OF THE PROJECT. THE GENERAL CONTRACTOR SHALL BE RESPONSIBLE FOR THE REMOVAL OF ALL MATERIALS AND DEBRIS RESULTING FROM DEMOLITION, CUTTING, AND/OR DRILLING TO THE EXTENT OF THE PROJECT. THE GENERAL CONTRACTOR SHALL BE RESPONSIBLE FOR THE REMOVAL OF ALL MATERIALS AND DEBRIS RESULTING FROM DEMOLITION, CUTTING, AND/OR DRILLING TO THE EXTENT OF THE PROJECT.

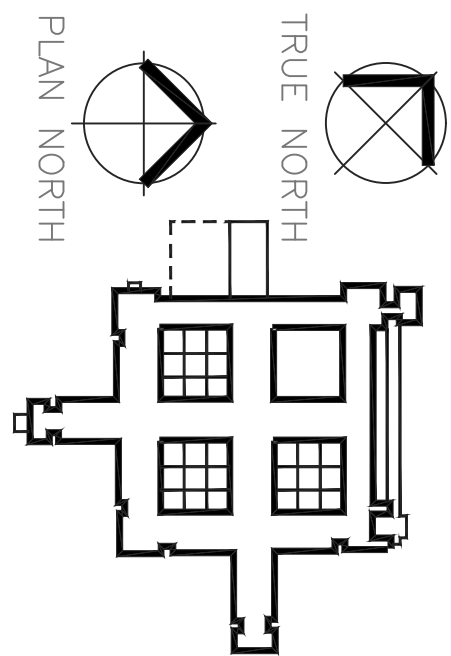

I HEREBY CERTIFY THAT THIS PLAN,  
SPECIFICATION OR REPORT WAS  
PREPARED BY ME OR UNDER MY DIRECT  
SUPERVISION AND THAT I AM A DULY  
LICENSED PROFESSIONAL ENGINEER  
REGISTERED UNDER  
THE LAWS OF THE STATE OF MINNESOTA.

REGISTRATION NUMBER: \_\_\_\_\_

Drawing Scale  
 $3/32"=1'0"$

Plot Scale  
 $12"=1'-0"$

Uworing little

Lot 8 Repair

Approved: Division Chief

Approved: Service Director

Project title	Upgrade Roads and Parking Lots		
Location	V.A. MEDICAL CENTER ONE VETERANS DRIVE MINNEAPOLIS, MN 55411		
Date	6/08/2012	Checked	TBD
		Dr	

Project No.	12-123
Building Number	Site
DRAWING NO.	1256-A6
Dwg. 7 of 14	

Office of  
Facilities  
Management

 Department of  
Veterans Affairs







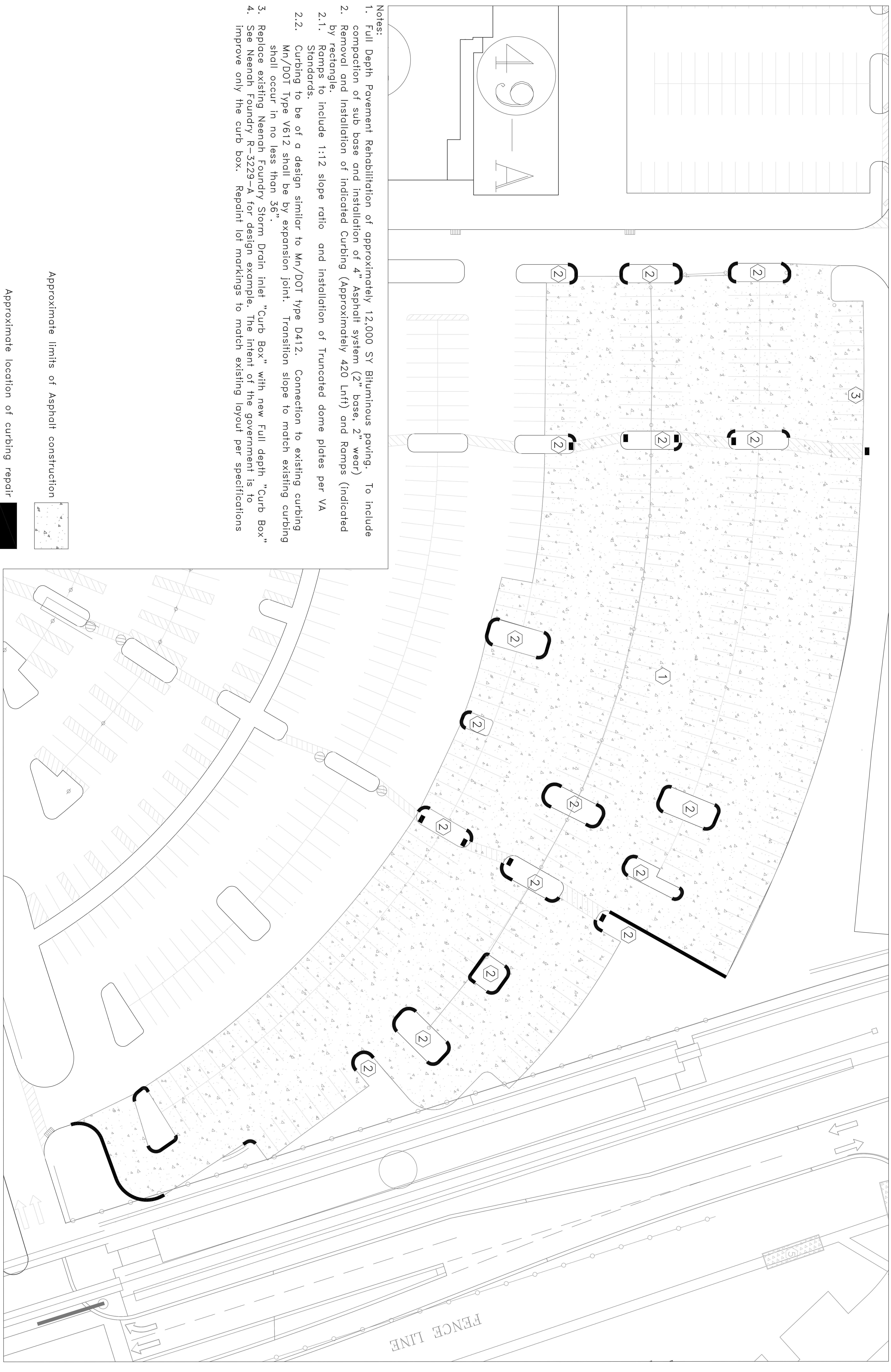
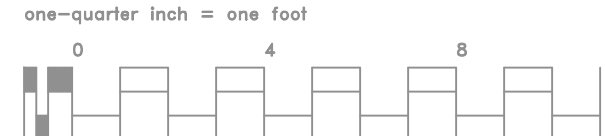
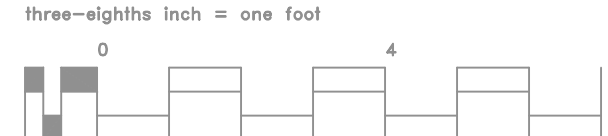
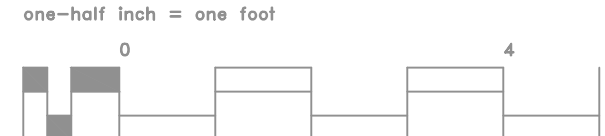
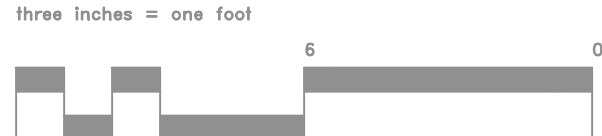

## Approximate limits of Asphalt construction

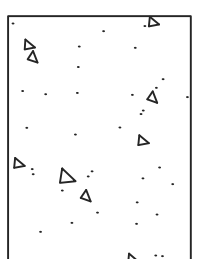

Approximate location of curbing repair

$$3/64'' = 1'-0''$$

FENCE LINE

## GENERAL NOTES:

GENERAL CONTRACTOR AND/OR ALL SUBCONTRACTORS SHALL FIELD VERIFY ALL DIMENSIONS SHOWN ON THESE PLANS AND SHALL BE RESPONSIBLE FOR VARIATIONS BETWEEN PLAN DIMENSIONS AND ACTUAL FIELD DIMENSIONS. WHERE VARIATIONS ARE FOUND TO OCCUR, THE GENERAL CONTRACTOR SHALL BE RESPONSIBLE FOR CORRECTING THE SAME. THE GENERAL CONTRACTOR SHALL BE RESPONSIBLE FOR THE WORK WILL BE MADE WITHOUT THE PRIOR APPROVAL OF THE PROJECT ENGINEER.

GENERAL CONTRACTOR SHALL BE RESPONSIBLE FOR GENERAL DEMOLITION INCLUDING REMOVAL OF WALLS, PARTITIONS, DOORS & CEILING & FLOORS, ANY AND ALL CUTTING OF CONCRETE FLOORS, WALLS OR STRUCTURE SHALL BE THE GENERAL CONTRACTOR'S RESPONSIBILITY. THE SUBCONTRACTOR BY TRADE, FINESTROUING OF THESE OPENING SHALL BE DONE BY THE RESPECTIVE SUBCONTRACTOR. REMOVAL OF DEBRIS RESULTING FROM DEMOLITION, CUTTING, AND/OR DRILLING IS THE RESPONSIBILITY OF THE GENERAL CONTRACTOR. THIS WILL BE ACCOMPLISHED UPON COMPLETION OF THE INSTALLATION OF ANY AND ALL UTILITIES INSTALLED BY THE VARIOUS SUBCONTRACTORS.

[illegible]

Architectural drawings of the building, including a plan view and two circular diagrams labeled "TRUE NORTH" and "PLAN NORTH".

<p><b>Drawing Scale</b>  <math>3\sqrt{64} = 10^\circ</math></p>	<p><b>Approved:</b> Division Chief</p>
<p><b>Full Scale</b>  <math>12" = 1'-0"</math></p>	<p><b>Approved:</b> Service Director</p>

12-123	Building Number
	Site
Parking Lots	PREAVING NO.
Location V.A. MEDICAL CENTER ONE VETERANS DRIVE MINNEAPOLIS, MN 55417	<b>1256-A8</b>
Date 06/06/2013	DRAWN OF
CHECKED	
TYPED	
DATE	

12-123	Building Number	DRAWING NO.
	Site	1256-A8
		Dwg. 9 of 14

Office of  
Facilities  
Management

 Department of  
Veterans Affairs



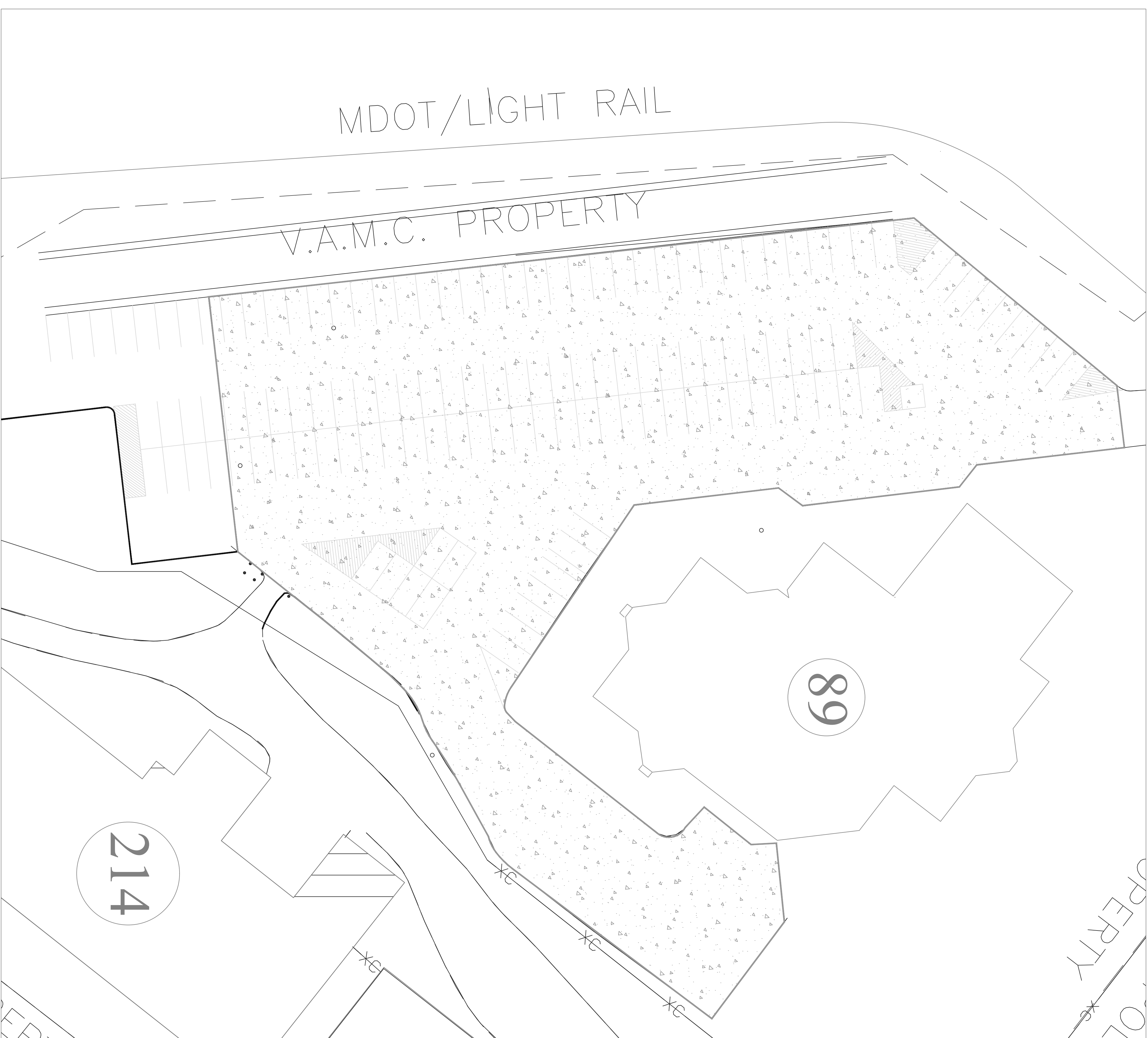
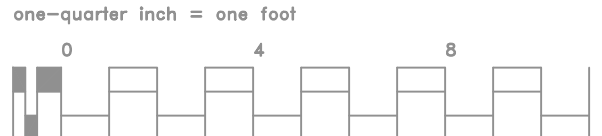
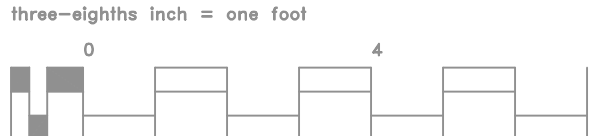
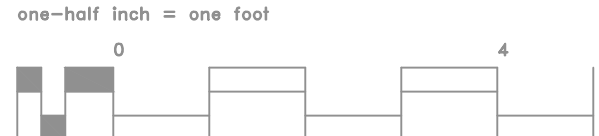
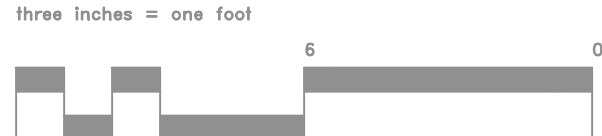

Option 2, Building 89 Parking Lot Renovation

$$3/64'' = 1'-0''$$

Option 3, Ft Snelling Overflow Parking Lot

 $1/32'' = 1'-0''$ 

1. Full Depth Pavement Rehabilitation of approximately 5000 SY Bituminous paving. To include compaction of sub base and installation of 4" Asphalt system (2" base, 2" wear)
2. Repaint lot markings per specifications
3. Remove existing signage, reinstallation prior to project completion.

## Approximate limits of Asphalt construction

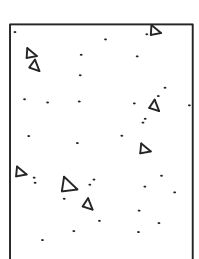
[illegible]

GENERAL  
NOTES:

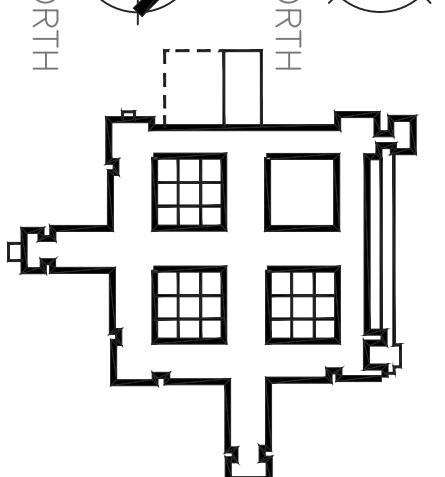
[illegible]

Drawing Title <b>Options 2 and 3 Building 89 and 222 lots</b>		Project Title <b>Upgrade Roads and Parking Lots</b>	
Drawing Scale <b>1" = 1'-0"</b>		Project No. <b>12-1-123</b>	
Approved: Division Chief		Building Number <b>516</b>	
Date: 06/08/2017		Drawing No. <b>1256-A9</b>	
Date: 10/01/16		Date: 10/01/16	



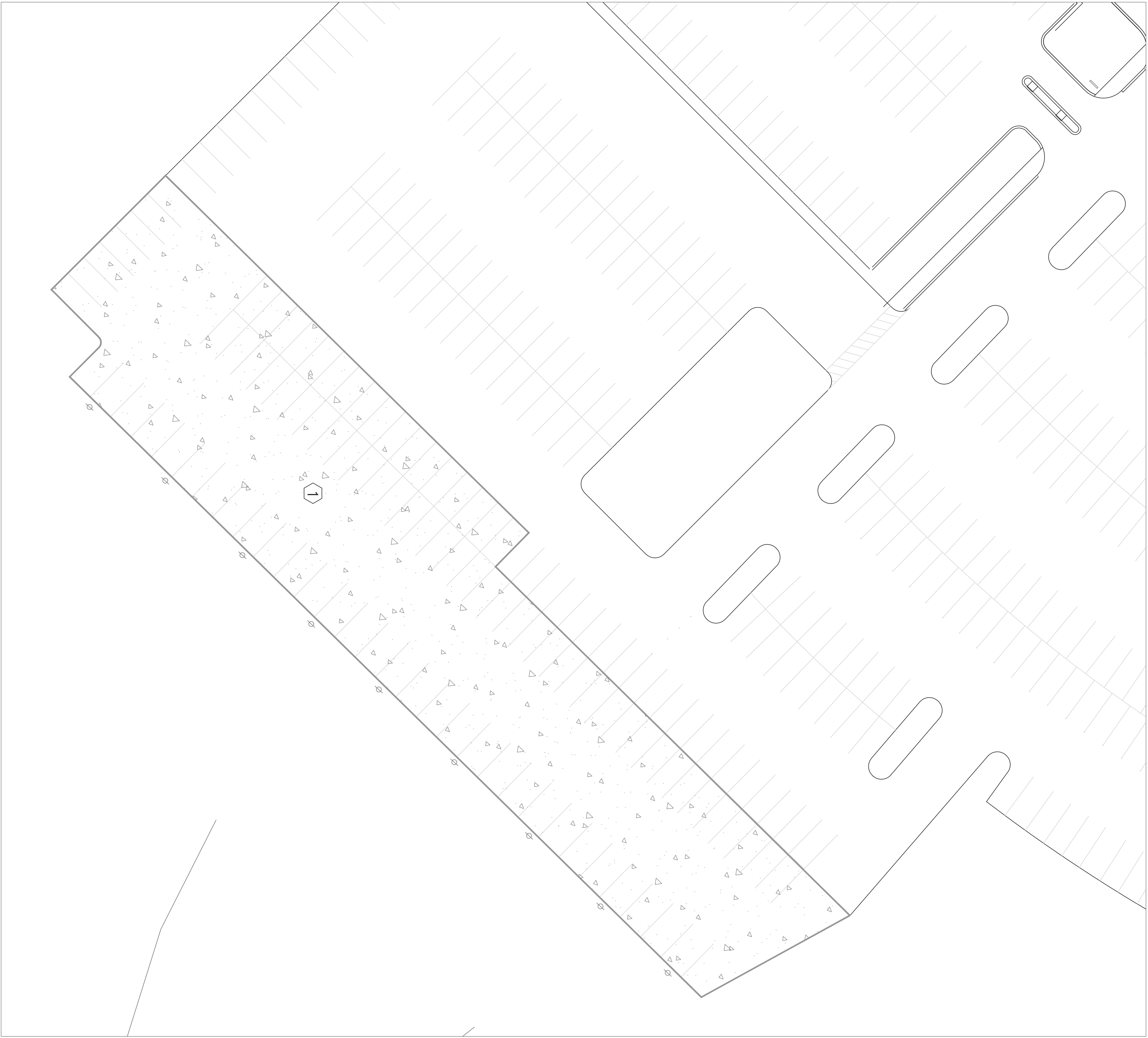

## Option 4, Lot 5 Restoration

3/64" = 1'-0"

### Notes:

1. Full Depth Pavement Rehabilitation of Bituminous paving. To include compaction of sub base and installation of 4" Asphalt system (2" base, 2" wear)
2. Repaint lot markings per specifications

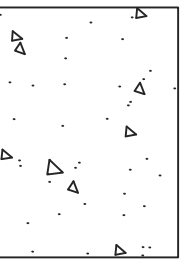

Approximate limits of Asphalt construction

Approximate location of curbing repair

REVISIONS	DATE

**GENERAL NOTES:**

GENERAL CONTRACTOR AND/OR ALL SUBCONTRACTORS SHALL FIELD VERIFY ALL DIMENSIONS SHOWN ON THESE PLANS AND SHALL BE RESPONSIBLE FOR VARIATIONS BETWEEN PLANNED DIMENSIONS AND ACTUAL FIELD DIMENSIONS. WHEN VARIATIONS ARE FOUND TO OCCUR, THE WORK WILL BE MADE WITHOUT THE PRIOR APPROVAL OF THE PROJECT ENGINEER.

GENERAL CONTRACTOR SHALL BE RESPONSIBLE FOR GENERAL DEMOLITION INCLUDING REMOVAL OF WALLS, PARTITIONS, DOORS, & CEILING & FLOORS. ANY AND ALL CUTTING OF CONCRETE FLOORS, WALLS OR STRUCTURE SHALL BE THE GENERAL CONTRACTOR'S RESPONSIBILITY. THE SUBCONTRACTOR SHALL BE RESPONSIBLE FOR THE REMOVAL OF DEBRIS RESULTING FROM DEMOLITION, CUTTING, AND/OR DRILLING IS THE RESPONSIBILITY OF THE GENERAL CONTRACTOR. THIS WILL BE ACCOMPLISHED UPON COMPLETION OF THE INSTALLATION OF ANY AND ALL UTILITIES INSTALLED BY THE VARIOUS SUBCONTRACTORS.

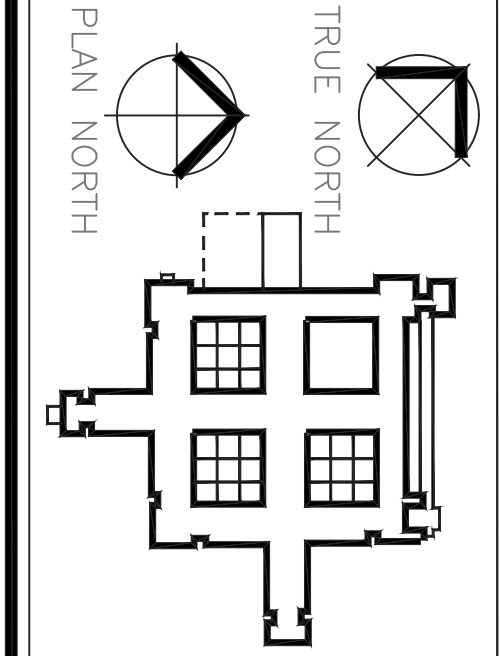

HEREBY CERTIFY THAT THIS PLAN, SPECIFICATION OR REPORT WAS PREPARED BY ME OR UNDER MY DIRECT SUPERVISION AND THAT I AM A LICENSED PROFESSIONAL ENGINEER IN THE STATE OF MINNESOTA

Drawing Title  
**Options 4 and 5  
Lot 5 and 6 Restoration**

Project Title  
**Upgrade Roads and  
Parking Lots**

Building Number  
**1256-A10**

Office of  
Facilities  
Management  
Department of  
Veterans Affairs



## Option 5, Lot 6 Restoration

1/32" = 1'-0"

### Notes:

1. Full Depth Pavement Rehabilitation of Bituminous paving. To include compaction of sub base and installation of 4" Asphalt system (2" base, 2" wear)
2. Removal and installation of indicated Curbing (Approximately 420 Lntf) and Ramps.
  - 2.1. Ramps to include 1:12 slope ratio and installation of Truncated dome plates per VA Standards.
  - 2.1. Curbing to be of a design similar to Mn/DOT type D412. Connection to existing curbing Mn/DOT Type V612 shall be by expansion joint. Transition slope to match existing curbing shall occur in no less than 36". Replace existing Storm drain inlet with "Mountable Curb Inlet"
3. Replace existing Neenah Foundry Storm Drain inlet "Curb Box" with new Full depth "Curb Box"
- 3.1. See Neenah Foundry R-3229-A for design example.
- 3.2. The intent of the government is to improve only the curb box, replacement of the entire storm drain system will be at the contractor's discretion. This MUST be specified by the contractor at the time of proposal acceptance.
4. Repaint lot markings per specifications



- Notes:
1. Full Depth Pavement Rehabilitation of Bituminous paving. To include compaction of sub base and installation of 4" Asphalt system (2" base, 2" wear)
2. Removal and Installation of Curbing. Curbing to be of a design similar to Mn/DOT Type D412. Connection to existing curbing Mn/DOT Type V612 shall be by expansion joint. Transition slope to match existing curbing shall occur in no less than 36".
3. Replace existing Neenah Foundry Storm Drain inlet "Curb Box" with new Full depth "Curb Box"
- 3.1. See Neenah Foundry R-33229-A for design example.
- 3.2. The intent of the government is to improve only the curb box, replacement of the entire storm drain system will be at the contractor's discretion. This MUST be specified by the contractor at the time of proposal acceptance.
4. Paint lot markings per Base Bid Handicap Remarkings Specifications
5. Paint lot markings to match existing per specifications

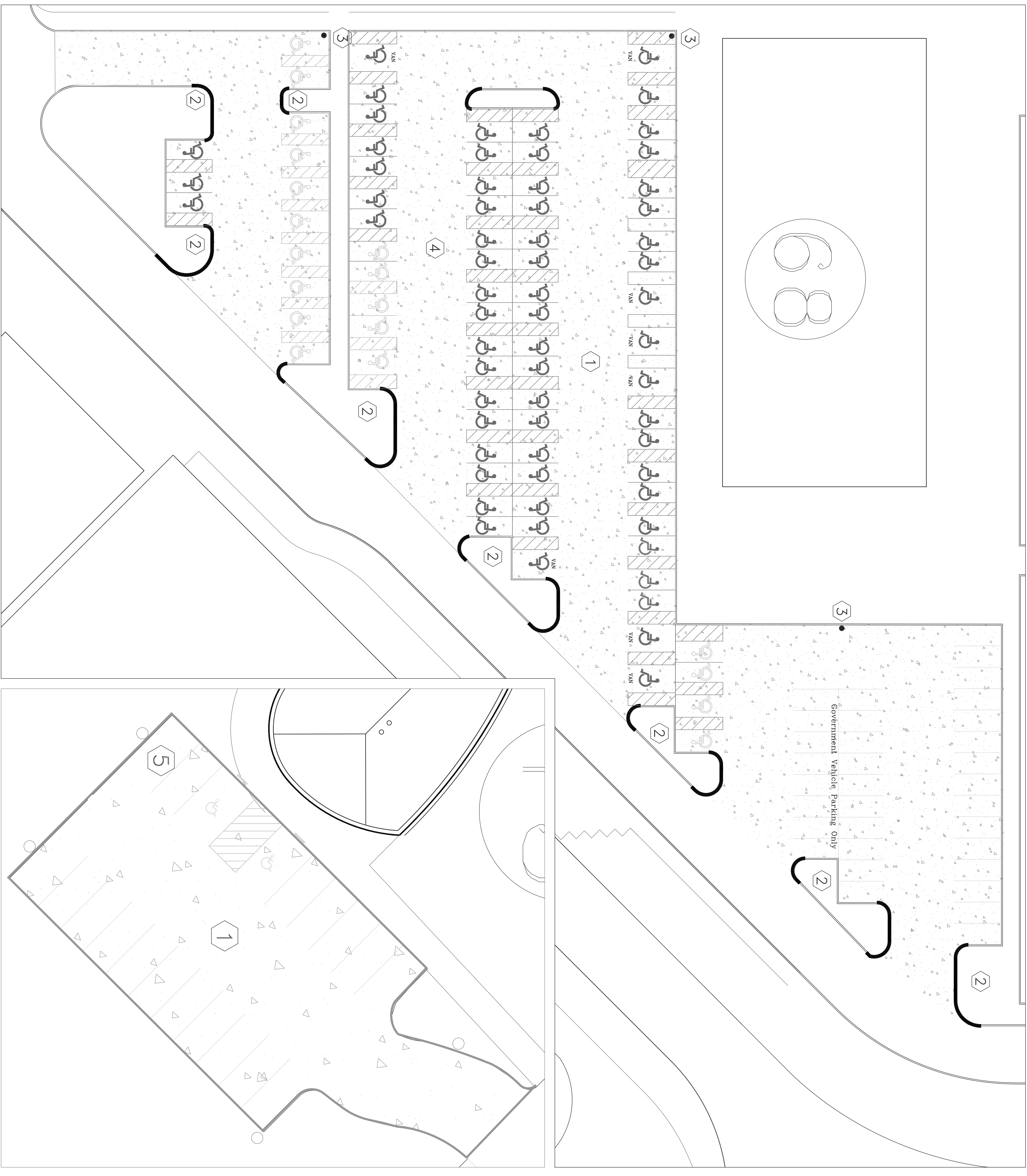

## Approximate limits of Asphalt construction

Approximate location of curbing repair

## Option 6, Lot 7 Restoration

1/16" = 1'-0" Option 7, Lot 73 Restoration

$$3/32'' = 1'-0''$$

## GENERAL NOTES:

GENERAL CONTRACTOR AND/OR ALL SUBCONTRACTORS SHALL FIELD VERIFY ALL DIMENSIONS SHOWN ON THESE PLANS AND SHALL BE RESPONSIBLE FOR CORRECTING ANY DISCREPANCIES PRIOR TO PROCEEDING WITH CONSTRUCTION. NO ADJUSTMENT TO THE CONTRACTOR SHALL NOTIFY THE PROJECT ENGINEER IN WRITING PRIOR TO ANY DIMENSIONAL CHANGES. NO ADJUSTMENT TO THE WORK WILL BE MADE WITHOUT THE PRIOR APPROVAL OF THE PROJECT ENGINEER.

GENERAL CONTRACTOR SHALL BE RESPONSIBLE FOR GENERAL DEMOLITION INCLUDING REMOVAL OF WALLS, PARTITIONS, DOORS & CEILING & FLOORS. ANY AND ALL CUTTING OF CONCRETE FLOORS, WALLS OR STRUCTURE SHALL BE THE GENERAL CONTRACTOR'S RESPONSIBILITY. REMOVAL OF BEAMS RESULTING FROM DEMOLITION, CUTTING, AND/OR DRILLING IS THE RESPONSIBILITY OF THE SUBCONTRACTOR. REMOVAL OF BEAMS RESULTING FROM DEMOLITION, CUTTING, AND/OR DRILLING SHALL BE DONE BY THE RESPECTIVE SUBCONTRACTOR. THE GENERAL CONTRACTOR SHALL BE RESPONSIBLE FOR THE INSTALLATION OF ANY AND ALL UTILITIES INSTALLED BY THE VARIOUS SUBCONTRACTORS.

I HEREBY CERTIFY THAT THIS PLAN, PREPARED BY ME OR UNDER MY DIRECT SUPERVISION AND THAT I AM A DULY REGISTERED LANDS OF THE STATE OF MINNESOTA REGISTRATION NUMBER:	Drawing Scale N/A	Plot Scale $12'' = 1'-0''$
--	----------------------	-------------------------------

Uprising title

Options 6 and 7

Lot 7 and 73 Restoration

Approved: Division Chief

Approved: Service Director

Project title	Upgrade Roads and Parking Lots, Phase 3		
Location	V.A. MEDICAL CENTER ONE VETERANS DRIVE MINNEAPOLIS, MN 55417		
Date	06/08/2012	Checked	TBD
		Drawn	MA

Project No.	12-123
Building Number	
Site	
DRAWING NO.	1256-A11
Dwg.	12 of 14

Office of  
Facilities  
Management

Department of  
Veterans Affairs



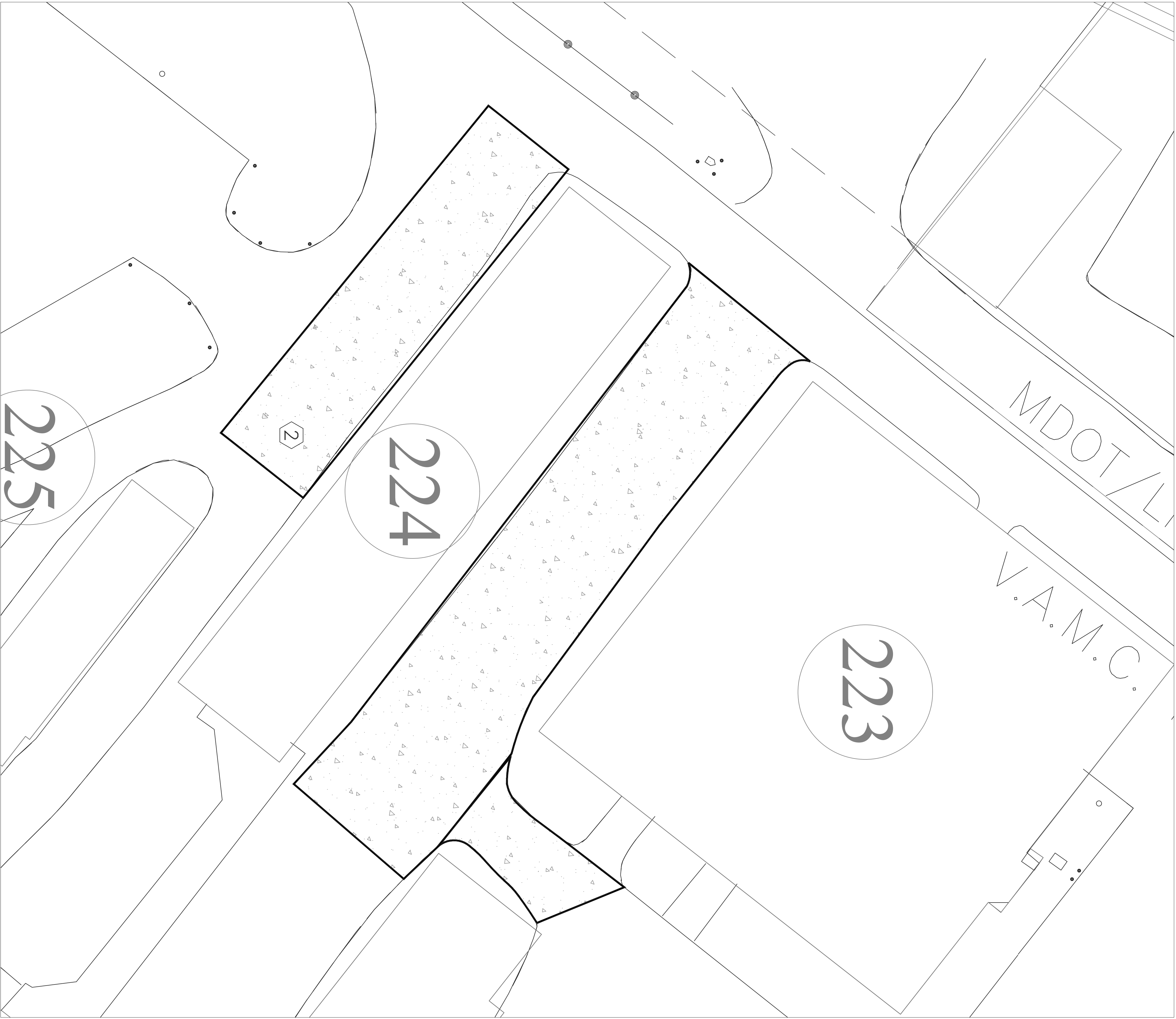

## Options 8 and 9

- Notes:
- Option 8: Building 222 loading dock access drives
  - 1.1. Mill and overlay existing Asphalt. Current system includes a concrete base
  - 1.2. Improve side access drive including base preparation, and installation of 4" asphalt system (2" base, 2" wear)
  2. Option 9 224 Ramp and Access Road Repair
  - 2.1. Improve existing Ramp access
  - 2.2. Installation of 4" asphalt system (2" base, 2" wear)

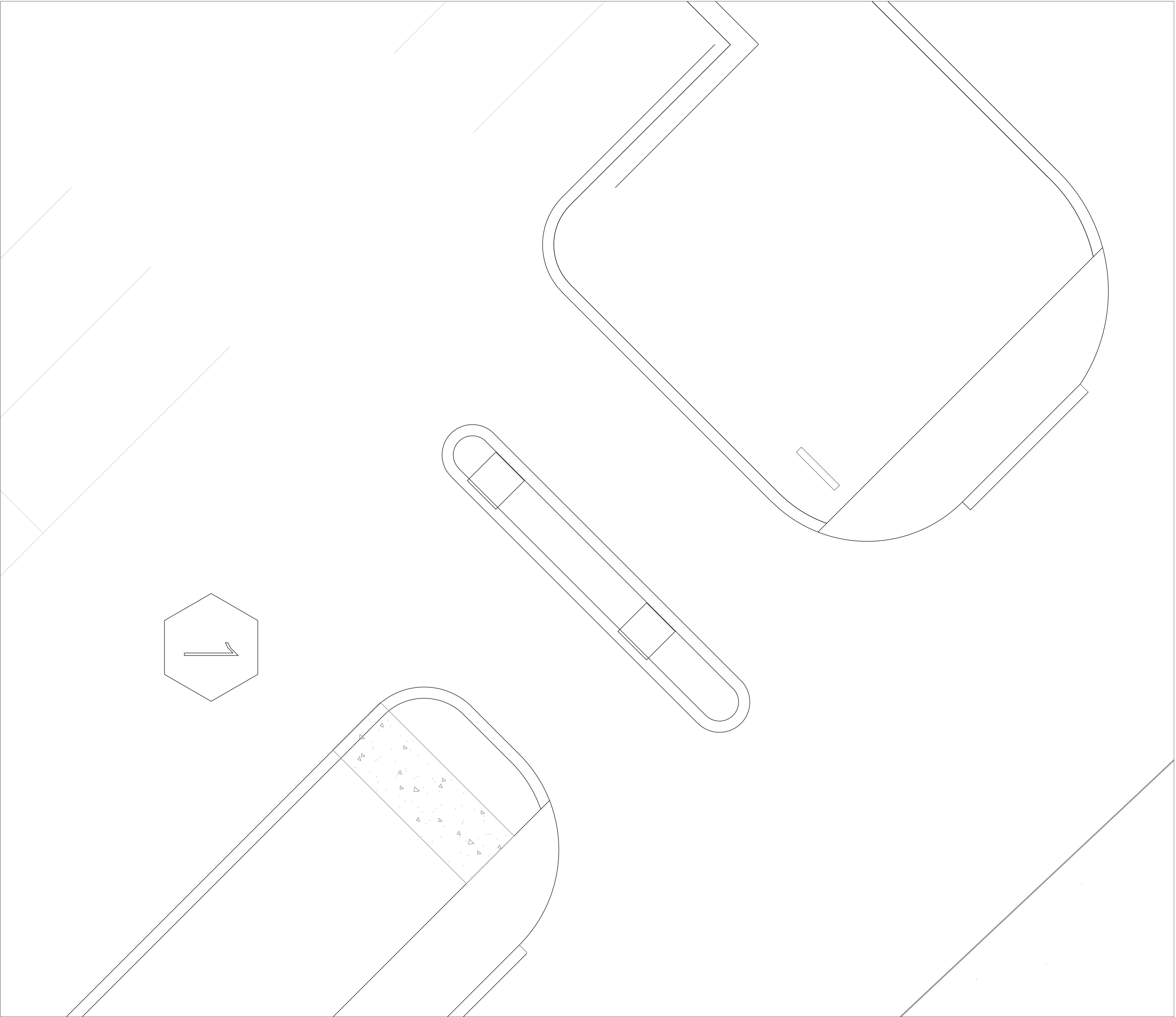

## Options 10, Lot 4 Pedestrian Ramp

- Notes
- Installation of ADA compliant Ramp. Installation of new curbing and Sidewalk.
  - 1.1. Ramps to include 1:12 slope ratio and installation of Truncated dome plates per VA Standards.
  - 1.2. Curbing to be of a design similar to Mn/DOT Type D412. Connection to existing curbing Mn/DOT Type V612 shall be by expansion joint. Transition slope to match existing curbing shall occur in no less than 36".

Approximate limits of Asphalt construction

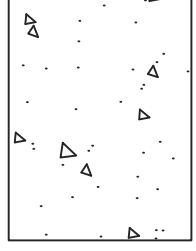

REVISIONS	DATE

**GENERAL NOTES:**

GENERAL CONTRACTOR AND/OR ALL SUBCONTRACTORS SHALL FIELD VERIFY ALL DIMENSIONS SHOWN ON THESE PLANS AND SHALL BE RESPONSIBLE FOR VARIATIONS BETWEEN PLANNED DIMENSIONS AND ACTUAL FIELD DIMENSIONS. WHERE VARIATIONS ARE FOUND TO OCCUR, THE WORK WILL BE MADE WITHOUT THE PRIOR APPROVAL OF THE PROJECT ENGINEER.

GENERAL CONTRACTOR SHALL BE RESPONSIBLE FOR GENERAL DEMOLITION INCLUDING REMOVAL OF WALLS, PARTITIONS, DOORS, & CEILING & FLOORS. ANY AND ALL CUTTING OF CONCRETE FLOORS, WALLS OR STRUCTURE SHALL BE THE GENERAL CONTRACTOR'S RESPONSIBILITY. THE SUBCONTRACTOR SHALL BE RESPONSIBLE FOR THE REMOVAL OF DEBRIS RESULTING FROM DEMOLITION, CUTTING, AND/OR DRILLING IS THE RESPONSIBILITY OF THE GENERAL CONTRACTOR. THIS WILL BE ACCOMPLISHED UPON COMPLETION OF THE INSTALLATION OF ANY AND ALL UTILITIES INSTALLED BY THE VARIOUS SUBCONTRACTORS.

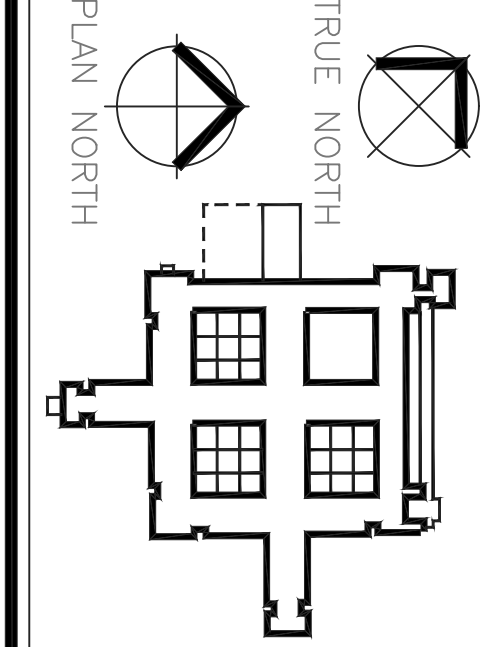

HEREBY CERTIFY THAT THIS PLAN, SPECIFICATION OR DRAWING WAS PREPARED BY ME OR UNDER MY DIRECT SUPERVISION AND THAT I AM A LICENSED PROFESSIONAL ENGINEER IN THE STATE OF MINNESOTA

Drawing Scale: 1" = 100'-0"

Plot Scale: 1/2" = 1'-0"

Drawing Title: Options 8, 9 and 10 Lot repair and ramp installation

Approved: Service Director

Project Title: Upgrade Roads and Parking Lots, Phase 3

Location: VA MEDICAL CENTER ONE VETERANS DRIVE MINNEAPOLIS, MN 55417

Date: 06/08/2012

Checked: [Signature] Drawn: [Signature]

Project No.: 12-123

Building Number: 1256-A12

Site: [Signature]

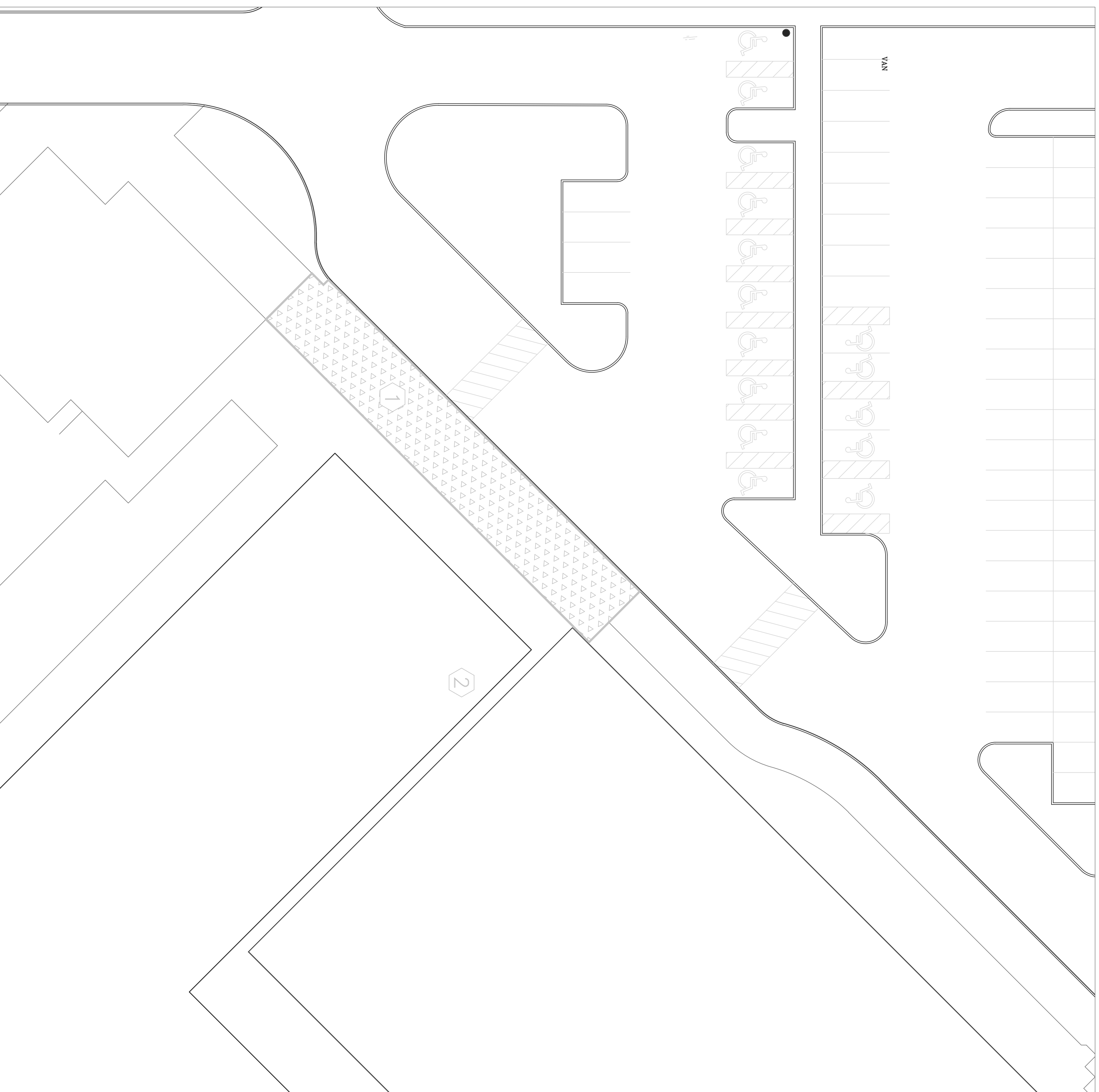
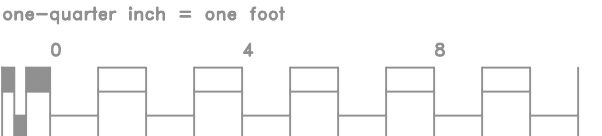
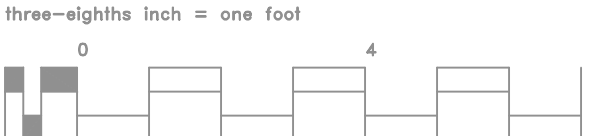
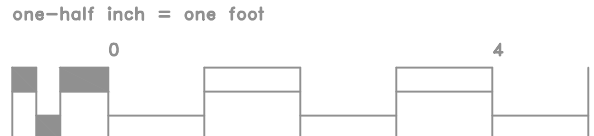
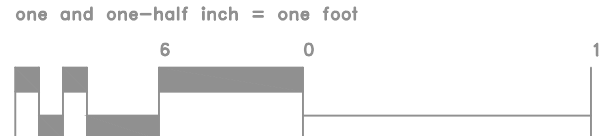
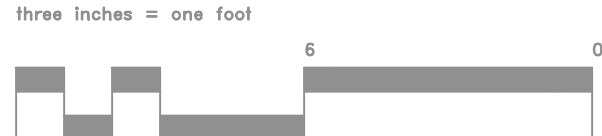

 $1/16'' = 1'-0''$ 

Employee Entrance Notes:

Notes:

Provide a broom finish. Ramps to be ADA as well as UFAS compliant at 1:12 Slope with truncated dome plates, Neenah Foundry R-4584, painted with 2 coats acrylic enamel yellow paint or approved equal. Grade and hydroseed disturbed soil.

1. Removal and Installation of Approximately 1350 Sqft concrete sidewalk
2. Repair/improve approximately 350 Sqft of damaged concrete in Trash Bay.
- 2.2. Options for a more permanent solution to prevent future damage by loading/unloading of trash container will be taken under special consideration
3. Remove existing concrete approach and surrounding excess sidewalk to Hiawatha service road. Install 6' wide ramp to match existing sidewalk width and cart/pedestrian traffic flow.
4. Remove existing ramp and sidewalk up to north south sidewalk. This location will require design services for grading to modify the sidewalk to comply with "VA Barrier Free Design Guide" standards. Sidewalk shall be installed with 6s thick x 5' wide washed sand base material. Sidewalk shall be 4s thick x 8' wide concrete. Installation of "VA Barrier Free Design Guide" compliant Ramp. Ramp to include 1:12 slope ratio and maintain full sidewalk width. Installation of Truncated dome plates per VA Standards.
5. Misc. Concrete Repairs

### Approximate limits of concrete Repairs



$$3/64'' = 1'-0''$$
[illegible][illegible]

Figure 1 consists of two diagrams. The top diagram, labeled 'TRUE NORTH', shows a circular sun path with a shaded area representing the building's footprint. The bottom diagram, labeled 'PLAN NORTH', shows the building's footprint with a dashed line indicating the true north orientation.

Drawing Scale NA	Approved: Service Director  Approved: Division Chief	Project Title Option 11, Concrete Repairs Lot repair and ramp installation	Project No. 12-123	Building Number 1256-A13
Plot Scale 12" = 1'-0"	Date 06/08/2012	Location VA MEDICAL CENTER ONE VETERAN'S DRIVE MINNEAPOLIS, MN 55417	Project No. 12-123	Building Number 1256-A13
Registration Number:	Drawing No. 1256-A13	Project No. 12-123	Building Number 1256-A13	Building Number 1256-A13

Office of  
Facilities  
Management

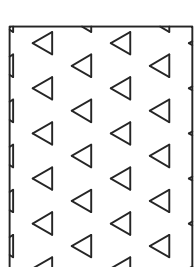
 Department of  
Veterans Affairs