

STATEMENT OF WORK
Replace 5B North Mental Health Flooring
Carl Vinson VAMC, Dublin, GA
557-18-3-5151-0068

1. GENERAL:

Contractor shall remove and dispose of existing carpeting and 4” cove base and replace with new luxury vinyl tile and 5.25” millwork wall base in approximately 2,610 square feet of waiting room, corridor, and conference room space on Building 5B North, as detailed on Attachment A1. The contractor shall provide all equipment, parts, labor, and services necessary to complete the project at Carl Vinson VAMC, 1826 Veterans Blvd, Dublin, GA.

2. DAYS AND HOURS OF OPERATION:

Friday, 5:00 p.m. to Monday 7:00 a.m. Note: After hours work is required for this project and all work shall be arranged with the approval of the COR. It is expected that the area of work be complete and ready for clinic occupancy prior to 7:00 am on Monday morning. Contractor shall break work into definable phases to complete and clean each phase during one weekend.

3. PERFORMANCE REQUIREMENT:

Removal and Disposal: Remove all existing carpeting and 4” cove base in area shown on Attachment 1 and along perimeter of this area to properly allow for installation of new luxury vinyl tile. Remove, cut, alter, replace, patch and repair existing work as necessary to install new work. Except as otherwise shown or specified, do not cut, alter or remove any structural work, and do not disturb any ducts, plumbing, steam, gas, or electric work without approval of the COR. Existing work to be altered or extended and that is found to be defective in any way, shall be reported to the COR before it is disturbed. Materials and workmanship used in restoring work, shall conform in type and quality to that of original existing construction, except as otherwise shown or specified.

Contractor shall dispose debris in compliance with applicable federal, state or local permits, rules and/or regulations.

Installation of New Flooring: Contractor shall properly prep existing floor to include scraping of any carpet adhesive that will prevent the flush and level application of luxury vinyl tile.

Flooring: Flooring shall be either Allure Teak Resilient Plank Flooring, 6"x36", Gauge 3.8mm, or Mohawk Select Step Luxury Vinyl Tile, 6" x 48", P014S Sorrell, or approved equivalent floating luxury vinyl tile 6" wide by 3.8 mm thick. Color to be approved by COR. Shall meet ASTM F1700, Class III, Printed Film Vinyl Tile, Type B.

Adhesive: Basis of design is a floating floor which comes with thin strips of adhesive pre-applied; does not require additional adhesive.

Installation: Install in all hatched areas shown on Attachment A1; Rooms CR207 Waiting Area, Corridor CR206, Corridor CR205B, Corridor CR201-5, Corridor CR202-5, Conference Room A228. Install in accordance with manufacturer's instructions for application and installation unless specified otherwise. Mix tile from at least two containers. An apparent line either of shades or pattern variance is not acceptable. If tile layout is not shown on construction documents, lay tile symmetrically about center of room or space with joints aligned. Vary edge width as necessary to maintain full size tiles in the field, no edge tile to be less than 1/2 the field tile size, except where irregular shaped rooms make it impossible. Place tile pattern in the same direction; do not alternate tiles unless specifically indicated in the construction documents to the contrary. Scribe, cut, and fit floor tiles to butt neatly and tightly to vertical surfaces and permanent fixtures including built-in furniture, cabinets, pipes, outlets, and door frames. Extend floor tiles into toe spaces, door reveals, closets, and similar openings. Extend floor tiles to center of door openings. Roll tile floor with a minimum 45 kg (100 pound) roller. COR to inspect flooring and require re-installation where quality is not met.

Installation of Edge/Transition Strips: Install transition strip where new flooring meets old carpeting. Transition strip shall be recommended for both types of flooring and approved by COR. Locate edge strips under center line of doors unless

otherwise shown on construction documents. Set resilient edge strips in adhesive. Anchor metal edge strips with anchors and screws. Where tile edge is exposed, butt edge strip to touch along tile edge. Where thin set ceramic tile abuts resilient tile, set edge strip against floor file and against the ceramic tile edge

Cleaning: Clean adhesive marks on exposed surfaces during the application of resilient materials before the adhesive sets. Exposed adhesive is not acceptable. Clean flooring as recommended in accordance with manufacturer's printed maintenance instructions and within the recommended time frame. As required by the manufacturer, apply the recommended number of coats and type of polish and/or finish in accordance with manufacturer's written instructions.

Installation of Millwork Wall Base: Install 3/8" thick by 5.25" height millwork resilient wall base, thermoplastic rubber. ASTM F1861, Type TP thermoplastic rubber, Group 1. Millwork profile to replicate the look of finely milled wood. Basis of Design is Johnsonite Millwork, Inflection Profile MW-194-G, any substitutions must be approved by COR. Provide each product from one manufacturer and from one production run. Color to approved by COR.

Preparation: Examine and verify substrate suitability for product installation. Protect existing construction and completed work from damage. Correct substrate deficiencies. Fill cracks, pits, and depressions with leveling compound. Remove protrusions; grind high spots. Apply leveling compound to achieve 3 mm (1/8 inch) in 3 m (10 feet) maximum surface variation.

Installation: Install product according to manufacturer's instructions. Install around perimeter of hatched area shown on Attachment A1. Layout resilient base with minimum number of joints, minimum length of each piece is 24". Locate joints 6" from corners and intersections of adjacent materials. Apply adhesive uniformly for full contact between resilient base and substrate. Set resilient base with hairline butted joints aligned along top edge. Preformed corners: Install preformed corners if available before installing straight pieces.

Millwork profiles – job-formed corners:

1. Outside corners: Use straight pieces of maximum lengths possible and miter corners to fit.
2. Inside corners: Butt one piece to corner then scribe next piece to fit.

Tightly adhere millwork resilient base to substrate throughout length of each piece, with base in continuous contact with horizontal and vertical substrates. Do not stretch resilient base during installation. COR will inspect wall base and require re-installation where quality is not met.

Cleaning: Remove excess adhesive before adhesive sets. Clean exposed resilient base, resilient stair treats, and surfaces. Remove contaminants and stains. Clean with mild detergent. Leave surfaces free of detergent residue. Polish exposed resilient base to gloss sheen.

4. SCHEDULED SITE VISIT:

An industry site visit will be scheduled, which will be opened to all interested vendors. This will be the only site visit offered.

5. PROPOSAL:

Proposal should include all parts and labor expected to be used.

.

6. CONTRACTING PERFORMANCE MONITORING:

The government reserves the right to monitor services in accordance with the Performance Requirements.

1. REMOVE ALL CARPETING IN HATCHED AREA, WHICH IS GUE APPLIED.
2. REMOVE ALL COVE BASE (4") AROUND PERIMETER OF HATCHED AREA.
3. INSTALL LUXURY VINYL TILE IN HATCHED AREA, APPROX AREA IS 2,610 SQ FT
4. INSTALL 6" COVE BASE AROUND PERIMETER OF HATCHED AREA, APPROX PERIMETER IS 730 FT (THIS LENGTH INCLUDES DOORWAYS).
5. All work to be completed between 5:30 pm and 7:00 am, or on weekends.
6. Area shall be available for use by staff and patients between the hours of 7:00 am and 5:30 pm, Monday through Friday.
7. Install appropriate transition strip in all areas where new flooring meets existing carpeting or VCT flooring, approx. 50 locations. Install test strip for COR approval.

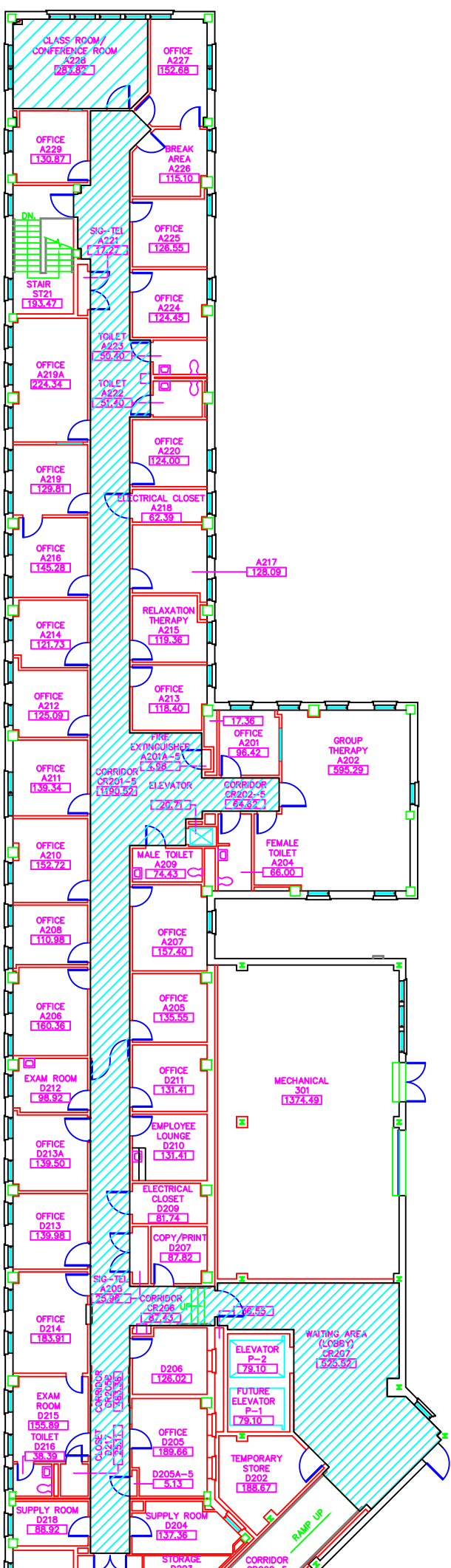

AREA OF CARPETING TO BE REPLACED WITH LVT

10 FT 10 FT 10 FT 10 FT 10 FT

SCALE

CONTRACTOR TO VERIFY AREA AND PERIMETER PRIOR TO BID

Approver: Chief of Engineering Service _____ Utility Systems Supervisor _____ Safety Manager _____ O&MS Coordinator _____	
Approved: _____ _____ _____ _____	
Project Title REPLACE 5B NORTH MENTAL HEALTH FLOORING	
Building Number 5B NORTH	
Location CARL VINSON VAMC	
Request No. 357-18-902	
Planning No. A1	
Office of Facilities	