

A

B

C

D

E

F

A

B

C

D

E

F

KEY

- A EAST ENTRANCE/08NRM||LOT 1/POLICE PARKING/EAST ENTRANCE/CANOPY||695-08-103||C90326 & C90692
- B PRIMARY CARE REMODEL/09NRM||YELLOW CLINIC||695-09-104||C90505 & C90700
- C 111 CONSTRUCT EAST ENTRANCE AUX.../11NRM||TEMP DOOR FOR TRANSTAR VANS||695-11-148||C10669
- D 111 REPLACE WAIT RAMP.../12NRM||FLOORING IN EAST LOBBY/ER & RED CLINIC WAITING/BLDG. 70 RAMP||695-12-128||C20553
- E ELEVATORS/12NRM||KITCHEN ELEVATOR RENOVATION||695-07-171ES||ES4041 & C90614
- F PHARMACY IV/05NRM||PHARMACY IV ROOM||695-05-107||C70861 & C90621
- G
- H 111 WIDEN ER EXAM.../12NRM||DOORS ER||695-12-116||C10583
- J 111 ERCT/07NRM||ERCT SCAN||695-07-370||C80687 & C90676
- K 111 CORRECT JOACH DEF.../12NRM||2012 CBAY||695-12-113||C20506
- L SCI CONNECTING CORRIDOR/MINORS||09 MINORS||695-320||Z00001
- M SPECIALTY CLINICS/00NRM||N:\DWGS\_K||695-00-110||C00525
- N AMB SURGERY CENTER/MINORS||00 MINORS||695-205||Z80005
- O AMB CARE ER-RED CLINIC/MINORS||99 MINORS||695-215||Z90001
- P ENCLOSE CANTEEN PATIO/N-DWGS||99 MINORS||695-207
- Q UPGRADE CHAPEL EXTERIOR WEST DOOR/12NRM||UPGRADE CHAPEL DOORS||695-12-115
- R EXPAND PRIMARY CARE/SPECIALTY CLINICS/MINORS/10 MONORS||KITCHEN CONSOLIDATION||695-315||Z10003
- S ENVIROMENTAL UPGRADE & ACM 1st FLOOR/05NRM||111 HALLS/FLOORS/WALLS||695-05-128
- T CCTV PHARMACY/10NRM||PHARMACY||695-10-162||C00892
- U 111 UPGRADE CHAPEL/13 NRM/ 695-13-175
- V 111 UPGRADE PUBLIC RESTROOM 1ST FLOOR/13NRM/695-12-168
- W 111 CONSTRUCT STARBUCKS & BARBER SHOP/12NRM/695-11-182
- X 111 UPGRADE CANTEEN SERVICES FLOORING/12NRM/695-12-114
- Y 111 RENOVATE FOR DERMATOLOGY/15NRM/695-15-134
- Z 111 UPGRADE ADMISSIONS PHARMACY/13NRM/695-13-119
- AA 111 RENOVATE BUILDING SOUTH ENTRANCE FOR PATIENT RECEIVING/12 NRM/695-12-101
- BB 111 70 UPGRADE AHUS AND ELECTRICAL /14NRM/695-14-146

ENTIRE FLOOR: F.A. STIMULUS(BUZZSAW)/695-09-152FCA/C90853||FIRE SYSTEM MANAGEMENT CONSOLIDATION BLDG.  
111/695-12-1272/C90851/C90855/C20695  
REPLACE FIRE ALARM SYSTEM/09NRM||695-09-150||C90854  
111 REKEY BLDG/12NRM/695-12-124

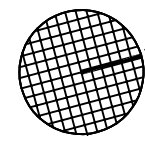
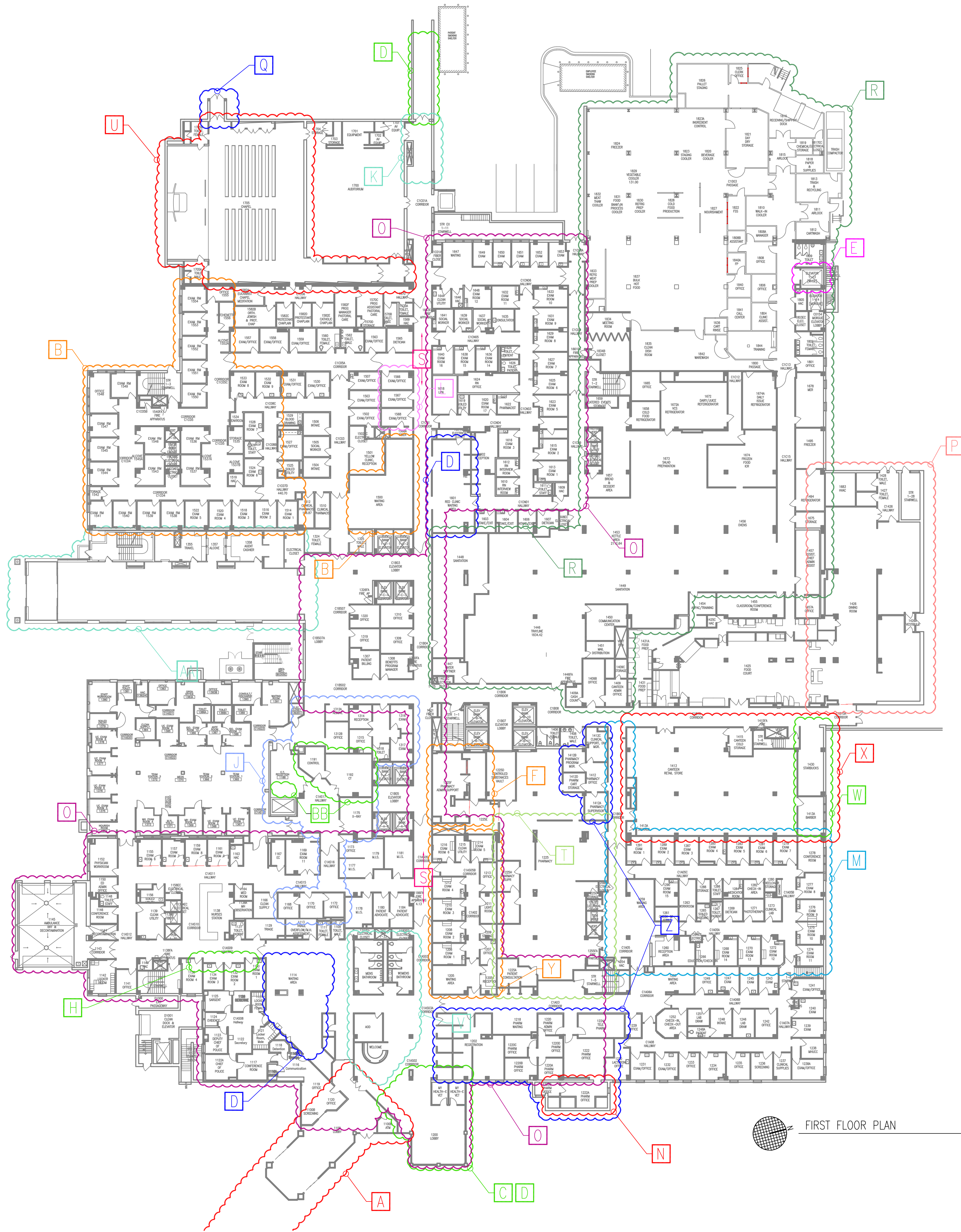

FIRST FLOOR PLAN

N.T.S.

Revisions	Date

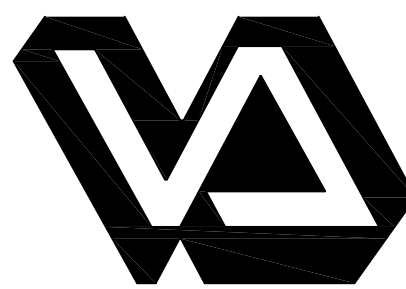

Dept. of Veterans Affairs  
Medical Center  
5000 W. National Avenue  
Milwaukee, WI



KEY PLAN: 

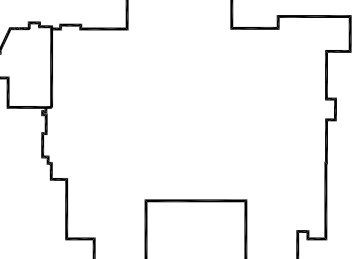

ENGINEER:

ARCHITECT:

Drawing Title  
FIRST FLOOR PLAN  
FLOOR AS-BUILT RECORD

Approved Project Director

Project Title  
-

Location  
VA Medical Center, Milwaukee, WI

Date  
6/1/18

Checked  
-

Drawn  
ASB

Project Number  
-

Building Number  
Building 111

Drawing Number  
111-01  
2 of 14

Office of  
Construction  
and Facilities  
Management

 Department of  
Veterans Affairs