

LIFE SAFETY FLOOR PLAN
GRAPHIC SCALE: SUPERIMPOSED NUMBERING SCALE
0 4 8 16'
SCALE: 1/8" = 1'-0"

1
A1.2 A1.1

**FULLY SPRINKLERED BUILDING
BID DOCUMENTS**

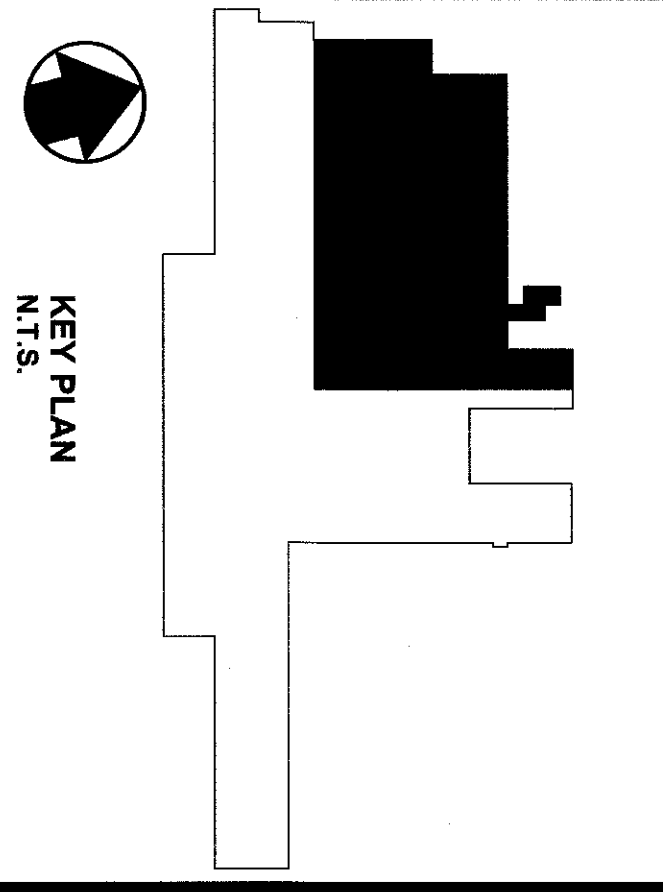

KEY PLAN
N.T.S.

RATED PARTITION LEGEND
ALL EXTERIOR WALLS SHALL BE 1-HOUR FIRE RESISTIVE CONSTRUCTION
1 HR
1 HOUR RATED PARTITION, SEE LIFE SAFETY FLOOR PLAN 1/A1.1
2 HR
2 HOUR RATED PARTITION, SEE LIFE SAFETY FLOOR PLAN 1/A1.1
EX
EXISTING 2 HOUR RATED WALL TO REMAIN, MAINTAIN 2 HOUR RATING FOR ALL EXISTING AND NEW WALL PENETRATIONS
S
SMOKE PARTITION, SEE LIFE SAFETY FLOOR PLAN 1/A1.1

FIXTURE LEGEND:
EXIT SIGN, SEE ELECTRICAL DRAWINGS
EXISTING EXIT SIGN TO REMAIN, SEE ELECTRICAL DRAWINGS
FEC
FIRE EXTINGUISHER CABINET AND FIRE EXTINGUISHER

NO.	DESCRIPTION	DATE
1	ISSUED FOR PERMIT	7/28/11
2	ISSUED FOR BIDDING	7/28/11
3	ISSUED FOR CONSTRUCTION	7/28/11
4	ISSUED FOR AS-BUILT	7/28/11
5	ISSUED FOR FINAL	7/28/11
6	ISSUED FOR ARCHIVE	7/28/11



Department of
Veterans Affairs

UPGRADE SPD AND SECURITY DOCK
PROJECT: 646-367
**VA PITTSBURGH
HEALTHCARE SYSTEM**
UNIVERSITY DRIVE C
PITTSBURGH, PENNSYLVANIA 15240

PARADIGM
ENGINEERS AND CONSTRUCTORS
PO BOX 436223
Louisville, Kentucky 40253
502-330-8511 www.paradigmusa.com



DATE
7/28/11
DRAWN BY
JG
CHECKED BY
JG
LIFE SAFETY
FLOOR PLAN
DRAWING NO.
A1.1
REV. NO.