

ENLARGED FLOOR PLAN

3

A1.0	A2.2
------	------

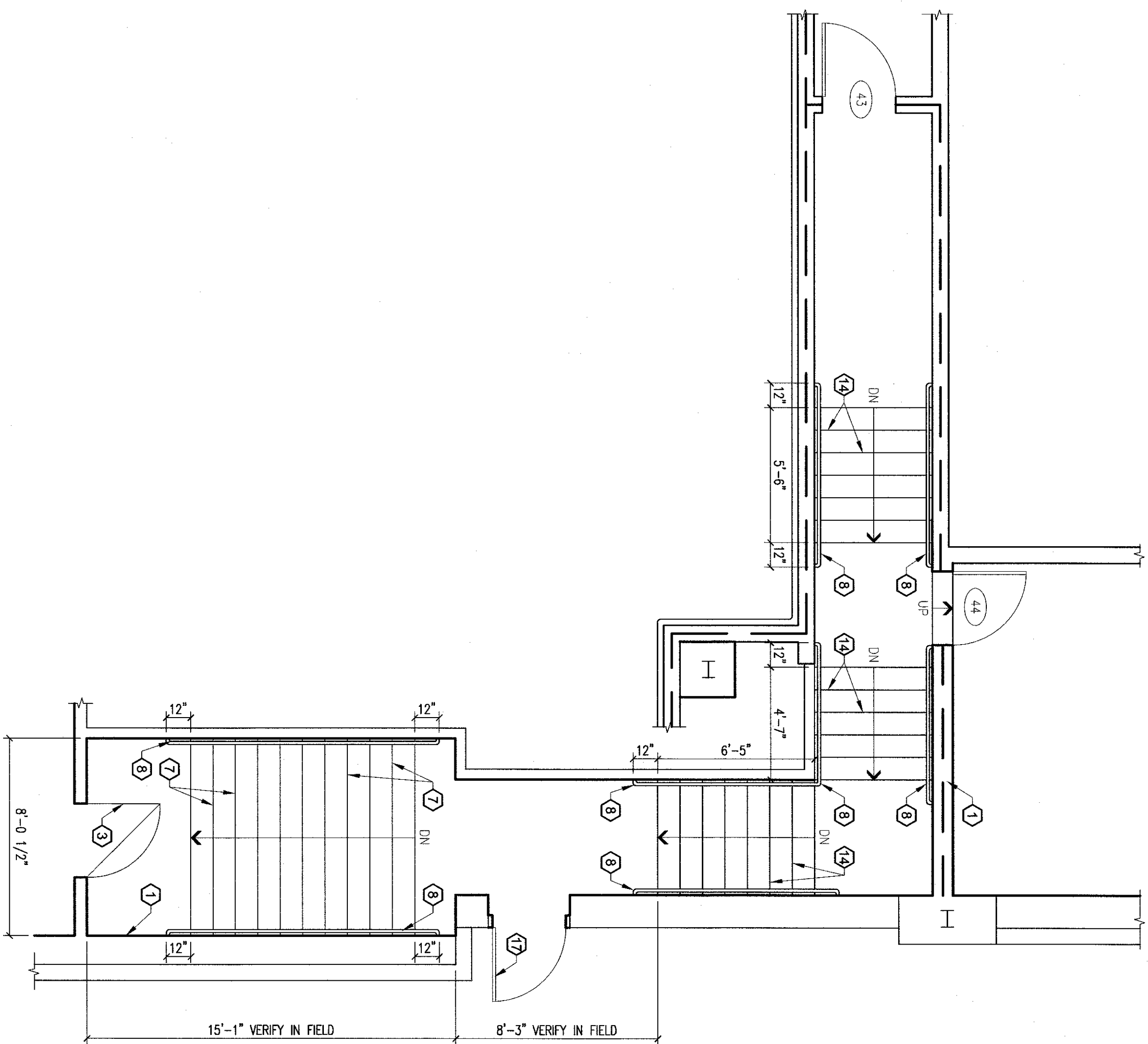

ENLARGED FLOOR PLAN

2	A1.0	A2.2
---	------	------

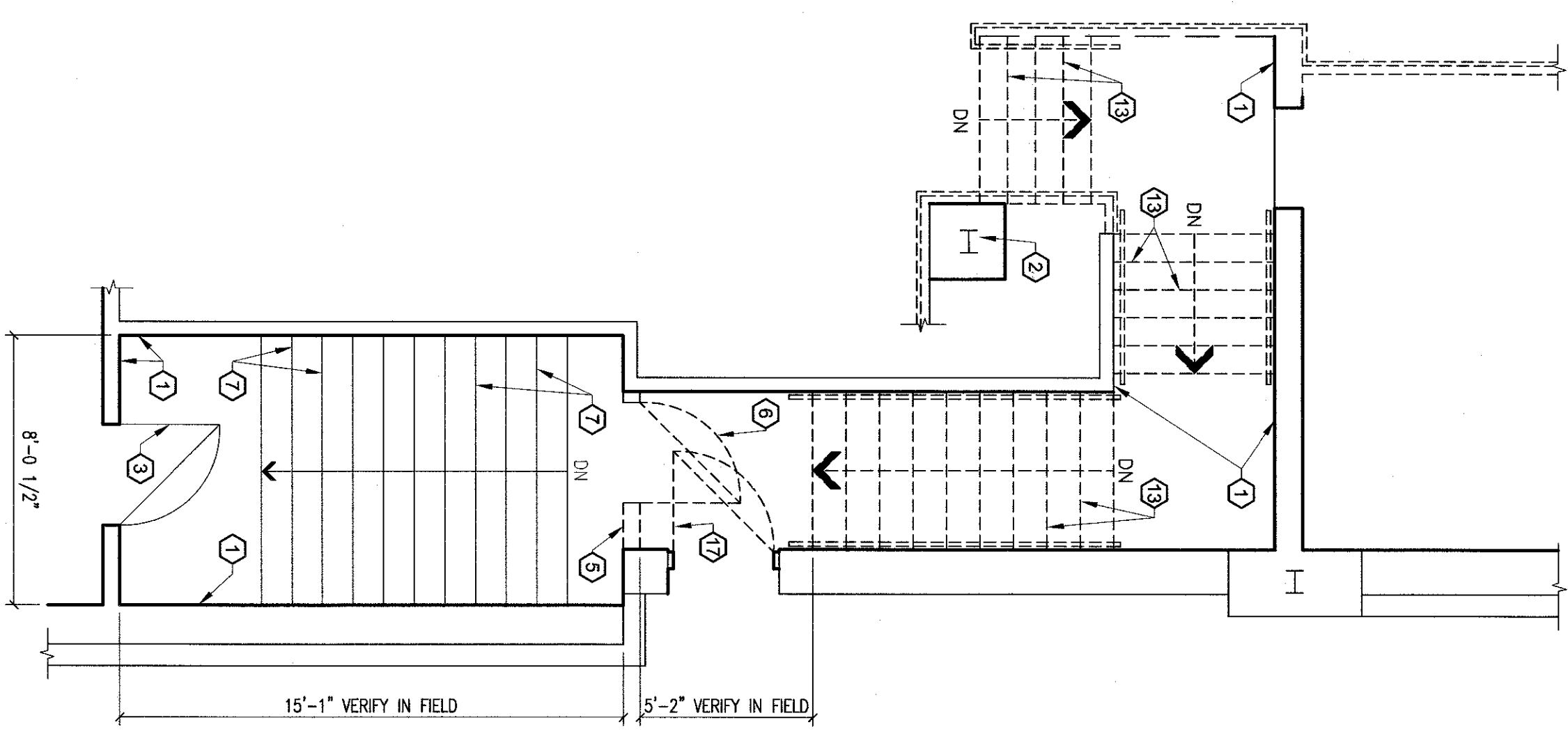

ENLARGED DEMO PLAN

AD1.0	AD2.0
-------	-------

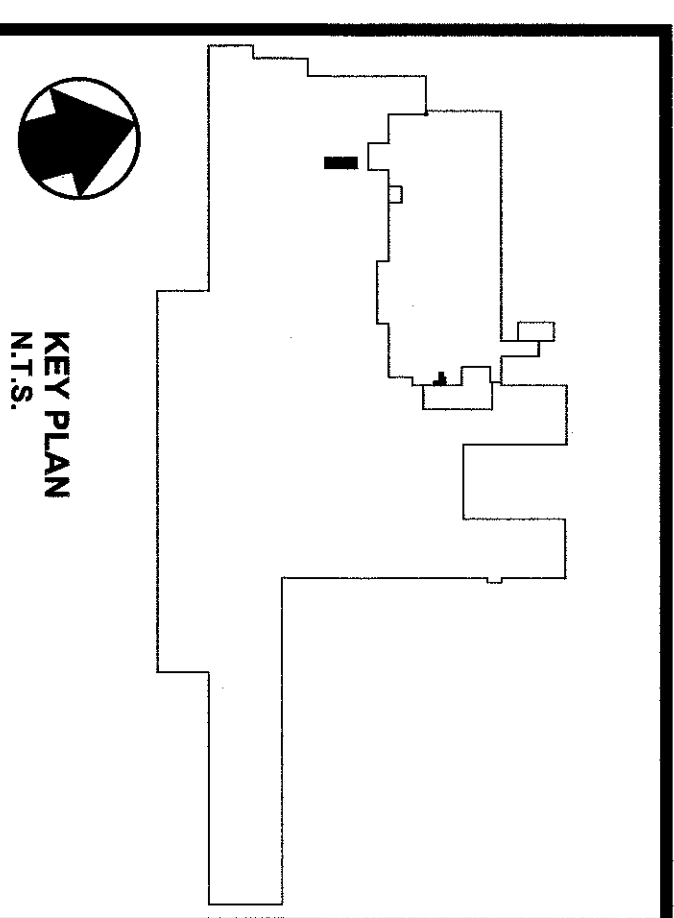

REGIONS		DATE
1		
2		
3		
4		
5		
6		
7		
8		
9		

1. EXISTING GYM WALL TO REMAIN
2. EXISTING GYM WALL TO REMAIN
3. EXISTING DOOR AND FRAME TO REMAIN, PLANT
4. REMOVE METAL DOOR AND FRAME, PAINT
5. REMOVE PORTION OF EXISTING WALL
6. REMOVE EXISTING DOOR AND FRAME
7. EXISTING CONCRETE STAIRS TO REMAIN
8. 1 1/2" DIA. W/ALUM CONCRETE AND TO SUE ELEVATION
9. REMOVE EXISTING CONCRETE AND TO SUE ELEVATION
10. PROVIDE TO STRUCTURAL AND MECHANICAL DRAWINGS FOR SIZE AND FLOOR REQUIREMENTS
11. PROVIDER REINFORCEMENT AND FLOOR FINE GRADING, PROVIDE ACTUAL FLOOR TO BE BINDER OF BALCONY OR CEILING, PROVIDE FLOOR ELEVATION JOINT COHER WITH "NO BINDER" OR NO CHANGE IN FLOOR ELEVATION, PROVIDE TWO HOUR FIRE RATED ASSEMBLY, SEE
12. FLOOR TO WALL EXPANSION JOINT DOOR AND FOUR PIRE RATED FLOOR WALL CONSTRUCTION, PROVIDE WALL EXPANSION JOINT COVERED EACH SIDE OF WALL BY DRYLOK ETC. SEE DETAIL 6/6/61
13. REMOVE EXISTING CONCRETE STAIRS
14. CONCRETE STAIRS
15. PROVIDE 1/2" W/AL STAIN STEEL FRAMING AND FIVE X ONE DOOR TO EXISTING MECHANICAL ROOM FLOOR TO ROCK ABOVE, PLANT AND OPENINGS, PROVIDE BINDER AND JOINT SEALANT
16. EXISTING WALL, FLOOR AND CEILING INSET TO REMAIN
17. EXISTING GYM DOOR AND FRAME, REMOVE AND MODIFY DOOR AND FRAME TO REVERSE DOOR SWING FOR EXISTING DOORS