

DETAIL
SCALE: 1 1/2" = 1'-0"

DETAIL
SCALE: 1 1/2" = 1'-0"

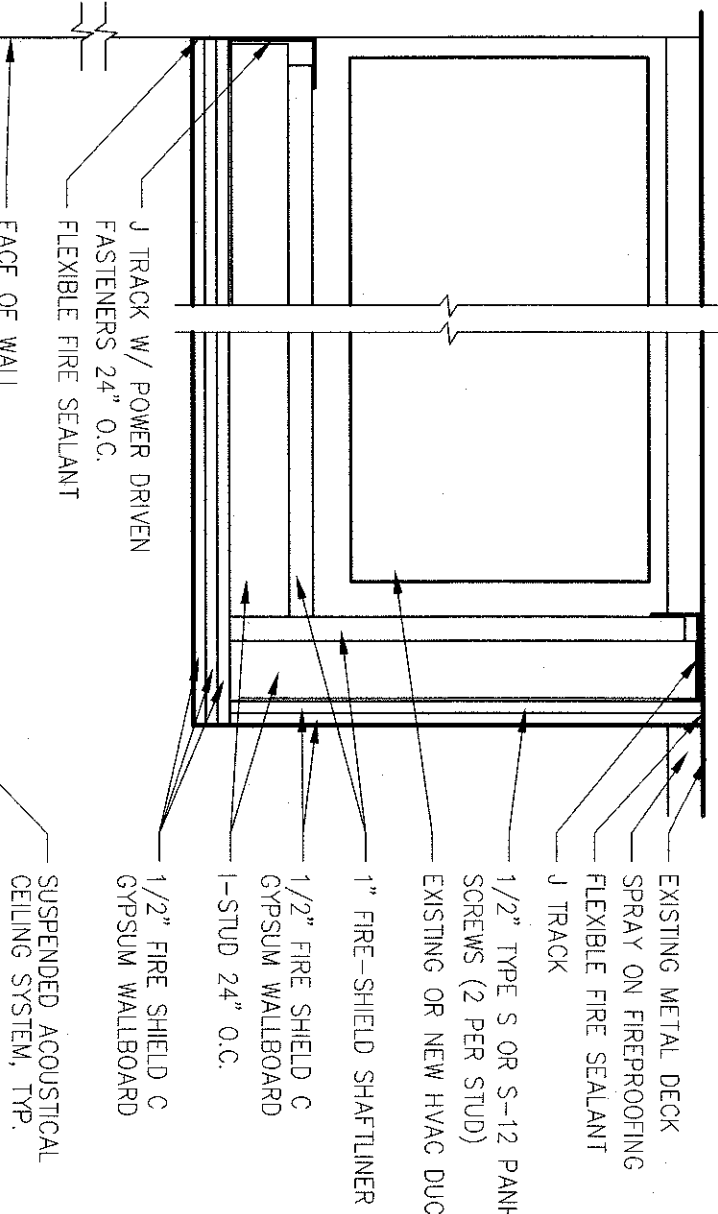

SOFFIT DETAIL
SCALE: 1 1/2" = 1'-0"

2
A3.0 A3.0

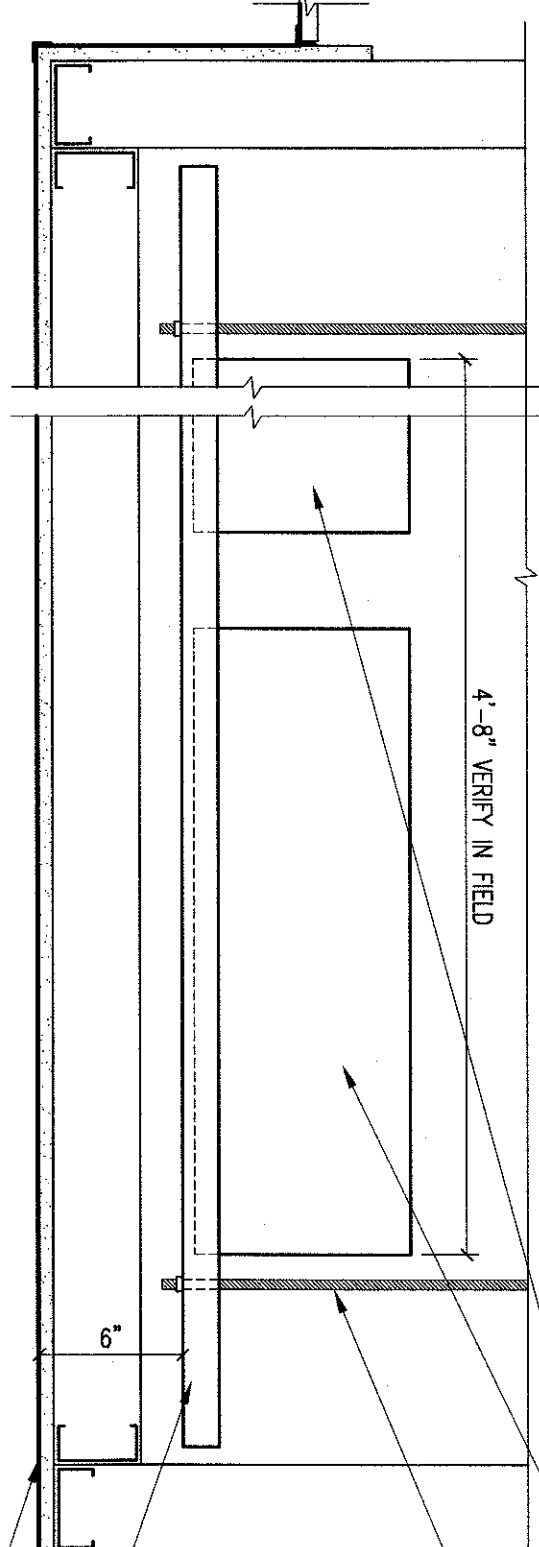

- GENERAL NOTES:**
- REFER TO ELECTRICAL DRAWINGS AND LIFE SAFETY FLOOR PLAN SHEET A11 FOR LOCATIONS OF EMERGENCY EXIT LIGHTS.
 - CEILING ADJUSTED HERE INCLUDING BUT NOT LIMITED TO: ADDITIONAL SUSPENDED CEILING ARE TO BE 9'-0" AFF UNLESS OTHERWISE NOTED.
- KEYNOTES:** (KEYNOTES REFERENCE THIS SHEET ONLY)
- OPEN TO STRUCTURE ABOVE.
 - ACQUISITION CEILING PANELS. REFER TO ROOM FINISH SCHEDULE AND SPECIFICATIONS FOR TYPE AND ROOM QTY'S BY MANUFACTURER.
 - REFER TO ROOM FINISH SCHEDULE AND SPECIFICATIONS FOR TYPE.
 - EXISTING SUSPENDED CEILING SYSTEM TO REMAIN. SEE ACF ANY EXISTING SUSPENDED CEILING SYSTEM SUSPENDED FROM EXISTING STRUCTURE ABOVE.
 - HVAC DUCTWORK CROSSING CORRIDOR TO BE PROTECTED WITH 2-HOUR FIRE RESISTIVE CONSTRUCTION SEPARATING DUCT FROM EXISTING SUSPENDED CEILING.
 - EXISTING SUSPENDED CEILING SYSTEM TO REMAIN. SEE ACF ANY EXISTING SUSPENDED CEILING SYSTEM SUSPENDED FROM EXISTING STRUCTURE ABOVE.
 - REFER TO ROOM FINISH SCHEDULE AND SPECIFICATIONS FOR TYPE.
 - REFER TO ROOM FINISH SCHEDULE AND SPECIFICATIONS FOR TYPE.
 - REFER TO ROOM FINISH SCHEDULE AND SPECIFICATIONS FOR TYPE.

- FIXTURE LEGEND:**
- ACQUISITION CEILING PANELS AND SUSPENSION SYSTEM. SEE ROOM FINISH SCHEDULE.
 - 2X4 PARALLEL LUMINAIRE. SEE ELECTRICAL DRAWINGS.
 - 2X4 PARALLEL LUMINAIRE. SEE ELECTRICAL DRAWINGS.
 - 2X4 PARALLEL LUMINAIRE. SEE ELECTRICAL DRAWINGS.
 - 2X4 PARALLEL LUMINAIRE. SEE ELECTRICAL DRAWINGS.
 - 2X4 PARALLEL LUMINAIRE. SEE ELECTRICAL DRAWINGS.
 - 2X4 PARALLEL LUMINAIRE. SEE ELECTRICAL DRAWINGS.
 - 2X4 PARALLEL LUMINAIRE. SEE ELECTRICAL DRAWINGS.
 - 2X4 PARALLEL LUMINAIRE. SEE ELECTRICAL DRAWINGS.
 - 2X4 PARALLEL LUMINAIRE. SEE ELECTRICAL DRAWINGS.
 - 2X4 PARALLEL LUMINAIRE. SEE ELECTRICAL DRAWINGS.

- EMERGENCY LIGHT (TYPICAL OF ALL TYPES). SEE ELECTRICAL DRAWINGS.
- HVAC DIFFUSER. SEE MECHANICAL DRAWINGS.
- MECHANICAL DRAWINGS.
- MECHANICAL DRAWINGS.
- MECHANICAL DRAWINGS.
- MECHANICAL DRAWINGS.
- MECHANICAL DRAWINGS.
- MECHANICAL DRAWINGS.
- MECHANICAL DRAWINGS.
- MECHANICAL DRAWINGS.

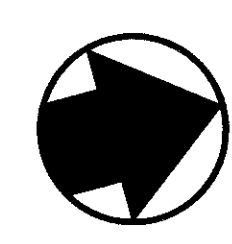

REFLECTED CEILING PLAN
SCALE: 1/8" = 1'-0"

1
A3.0 A3.0

**FULLY SPRINKLERED BUILDING
BID DOCUMENTS**

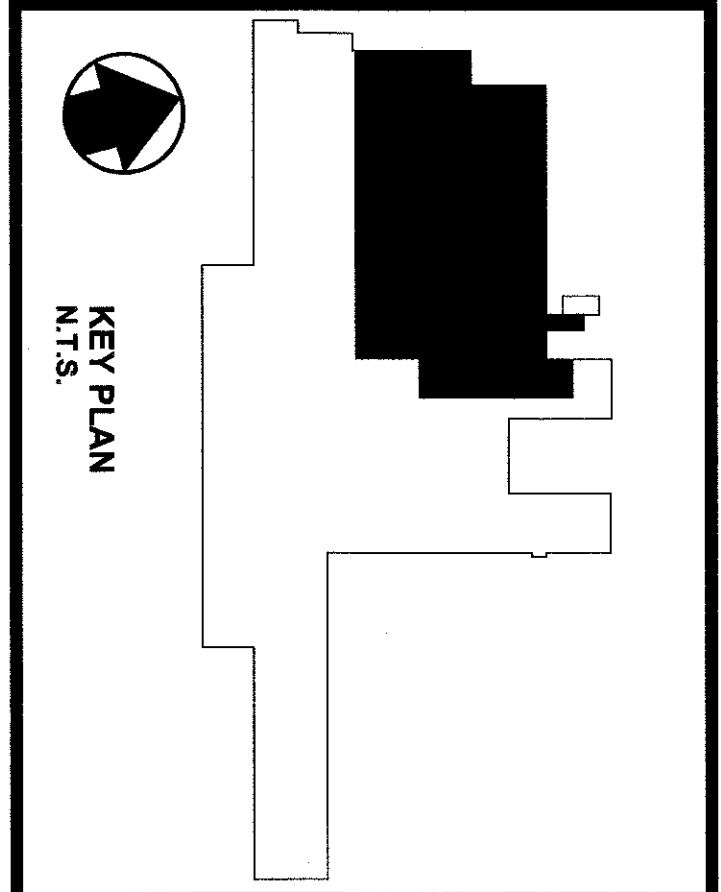

NO.	REVISIONS	DATE
1		
2		
3		
4		
5		
6		
7		
8		
9		
10		



**Department of
Veterans Affairs**

**UPGRADE SPD AND SECURITY DOCK
PROJECT: 646-367
VA PITTSBURGH
HEALTHCARE SYSTEM
UNIVERSITY DRIVE C
PITTSBURGH, PENNSYLVANIA 15240**

**PARADIGM
ENGINEERS AND CONSTRUCTORS**
PO BOX 436223
Louisville, Kentucky 40263
502-339-8511 www.paradigmusa.com

