

A

B

C

D

E

F

G

H

I

J

K

L

M

N

O

P

Q

R

S

T

U

V

W

X

Y

Z

AA

AB

AC

AD

AE

AF

AG

AH

AI

AJ

AK

AL

AM

AN

AO

AP

AQ

AR

AS

AT

AU

AV

AW

AX

AY

AZ

BA

BB

BC

BD

BE

BF

BG

BH

BI

BJ

BK

BL

BM

BN

BO

BP

BQ

BR

BS

BT

BU

BV

BW

BX

BY

BZ

CA

CB

CC

CD

CE

CF

CG

CH

CI

CJ

CK

CL

CM

CN

CO

CP

CQ

CR

CS

CT

CU

CV

CW

CX

CY

CZ

DA

DB

DC

DD

DE

DF

DG

DH

DI

DJ

DK

DL

DM

DN

DO

DP

DQ

DR

DS

DT

DU

DV

DW

DX

DY

DZ

EA

EB

EC

ED

EE

EF

EG

EH

EI

EJ

EK

EL

EM

EN

EO

EP

EQ

ER

ES

ET

EU

EV

EW

EX

FY

GZ

HA

HB

HC

HD

HE

HF

HG

HH

HI

HJ

HK

HL

HM

HN

HO

HP

HQ

HR

HS

HT

HU

HV

HW

HX

HY

GZ

IA

IB

IC

ID

IE

IF

IG

IH

II

IJ

IK

IL

IM

IN

IO

IP

IQ

IR

IS

IT

IU

IV

IW

IX

IY

JZ

KA

KB

KC

KD

KE

KF

KG

KH

KI

KJ

KK

KL

KM

KN

KO

KP

KQ

KR

KS

KT

KU

KV

KW

KX

KY

KZ

LA

LB

LC

LD

LE

LF

LG

LH

LI

LJ

LK

LL

LM

LN

LO

LP

LQ

LR

LS

LT

LU

LV

LW

LX

LY

LZ

MA

MB

MC

MD

ME

MF

MG

MH

MI

MJ

MK

ML

MM

MN

MO

MP

MQ

MR

MS

MT

MU

MV

MW

MX

MY

MZ

NA

NB

NC

ND

NE

NF

NG

NH

NI

NJ

NK

NL

NM

NO

NP

NQ

NR

NS

NT

NU

NV

NW

NX

NY

NZ

OA

OB

OC

OD

OE

OF

OG

OH

OI

OJ

OK

OL

OM

ON

OO

OP

OQ

OR

OS

OT

OU

OV

OW

OX

OY

OZ

PA

PB

PC

PD

PE

PF

PG

PH

PI

PJ

PK

PL

PM

PN

PO

PP

PQ

PR

PS

PT

PU

PV

PW

PX

PY

PZ

QA

QB

QC

QD

QE

QF

QG

QH

QI

QJ

QK

QL

QM

QN

QO

QP

QQ

QR

QS

QT

QU

QV

QW

QX

QY

QZ

RA

RB

RC

RD

RE

RF

RG

RH

RI

RJ

RK

RL

RM

RN

RO

RP

RQ

RR

RS

RT

RU

RV

RW

RX

RY

RZ

SA

SB

SC

SD

SE

SF

SG

SH

SI

SJ

SK

SL

SM

SN

SO

SP

SQ

SR

SS

ST

SU

SV



DOMESTIC AND FIRE PROTECTION WATER

UTILITY CROSSING TABLE						
POINT	NORTHING	EASTING	UPPER UTILITY	ELEVATION	LOWER UTILITY	ELEVATION
700	581133.73	4157535.38	EX 8"W	463.00	8"SS	457.31
701	581144.33	4157547.50	EX ST LITE	484.00	8"SS	457.44
702	581195.14	4157605.62	EX 10"SD	459.80	8"SS	458.05
703	581234.48	4157680.31	10"SD	460.17	8"SS	458.85
704	581343.90	4158199.33	PWR	468.81	4"F	466.31
705	581346.54	4158195.04	PWR	468.81	3"W	466.31

UTILITY CROSSING TABLE NOTES

- ELEVATIONS OF PROPOSED NON-GRAVITY UTILITIES (W, F, FDC, G, ELEC, COMM, MECH, PLUMBING, OR OTHER NON-STORM OR SANITARY UTILITIES) ARE ASSUMED APPROXIMATE TOP OF PIPE/CONDUIT ELEVATIONS (UNLESS OTHERWISE NOTED) NEEDED TO ACHIEVE MINIMUM CLEARANCE.
- ELEVATIONS OF PROPOSED SD AND SS ARE APPROXIMATE PROPOSED FLOWLINE ELEVATIONS.
- EXISTING UTILITY ELEVATIONS ARE UNKNOWN. ELEVATION SHOWN FOR EXISTING UTILITY REPRESENTS ASSUMED TOP PIPE/CONDUIT ELEVATION UNLESS OTHERWISE INDICATED.
- REFER TO CONSTRUCTION NOTES 12B, 12C AND 12D FOR MINIMUM CLEARANCES.
- REFER TO SHEET CU-101 FOR CROSSINGS BETWEEN PROPOSED SD AND EXISTING UTILITIES AND CROSSINGS BETWEEN PROPOSED SD AND ELEC, COMM, MECH, OR PLUMBING UTILITIES.
- COORDINATE WITH AFFECTED TRADES TO ENSURE MINIMUM TRENCH DEPTHS ARE SATISFIED AND BEDDING AND BACKFILL INSTALLED BY OTHER TRADES IN NOT UNDERMINED.
- BACKFILL USING FLOWABLE FILL PER SPECIFICATION SECTION 21 23 23.33 WHERE COMPACTION USING CRUSHED ROCK BACKFILL CANNOT BE ACHIEVED.

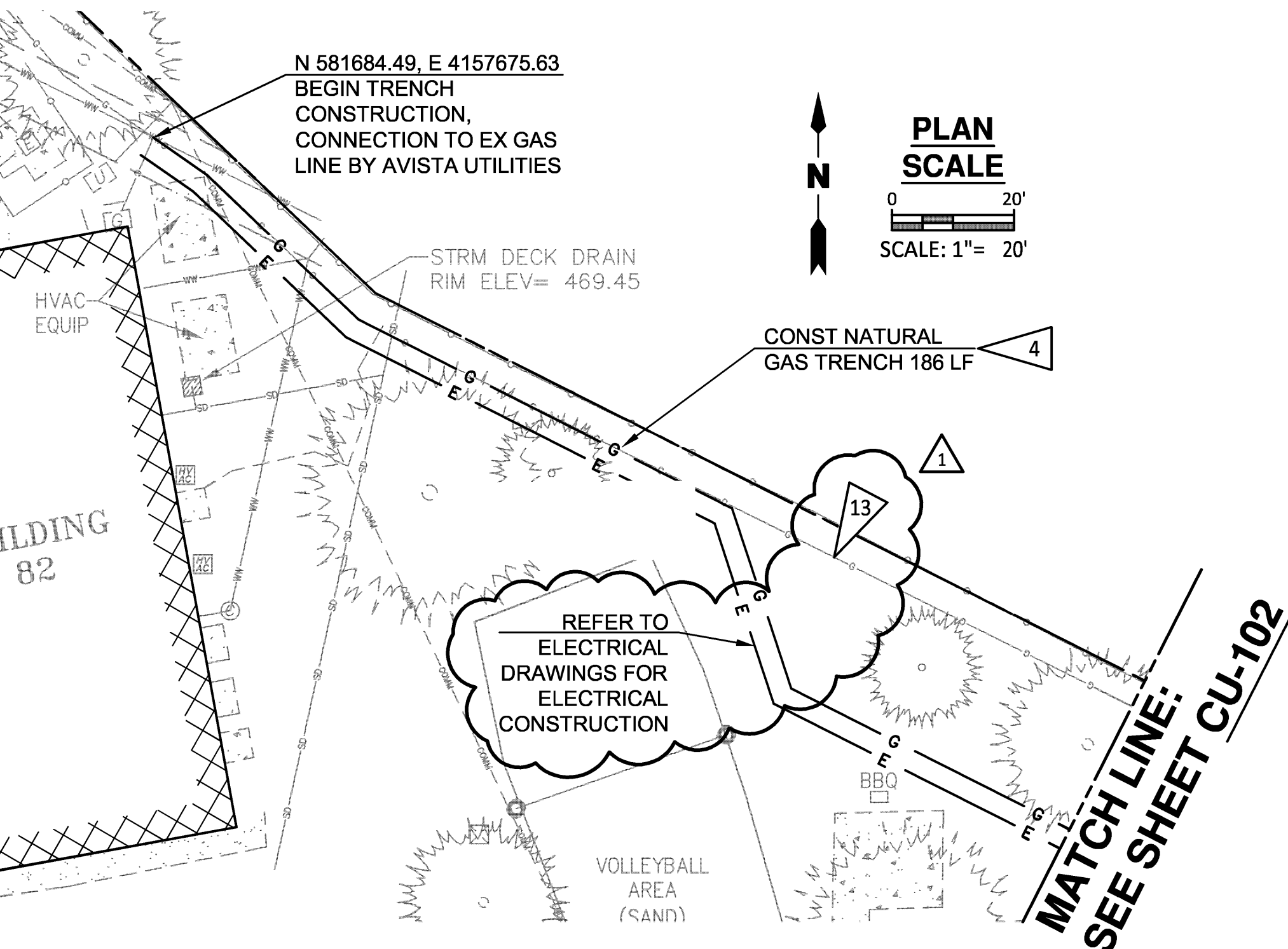

NATURAL GAS LINE EXTENSION

1 - REVISED UTILITY CROSSING TABLE AND SS FLOWLINES AND REMOVED DETAILS 4 AND 5 AND ADDED DETAILS 4A AND 4B PER ADDENDUM #1	8/10/12
Revisions:	Date

CONSULTANTS:



ARCHITECT/ENGINEERS:

Tina Ely architect
2915 Wingate Street / Eugene, OR 97408
541.521.2477 / Tina.Ely@comcast.net

Drawing Title
SANITARY SEWER, WATER,
AND NATURAL GAS
DISTRIBUTION DETAILS

Approved: Project Director

Project Title
SEISMIC REPLACEMENT BLDG 2
PHASE 1 MINOR
ACUTE PSYCHIATRIC WARD

Location
ROSEBURG, OREGON

Date
30 APR 2012

Checked
TLG

Drawn
JAH/CB

VA Project Number
653-322
Building Number
086

Sheet Number
CU-103

Office of
Construction
and Facilities
Management



SHEET NOTES

- REFER TO SHEET CS-502 FOR CIVIL AND SURVEY LEGENDS AND GENERAL NOTES.
- COORDINATES OF BFP VAULT ARE THE INTERSECTION OF THE WATER LINE AND THE EXTERIOR VAULT WALL ON THE INLET SIDE OF THE VAULT.

CONSTRUCTION NOTES

- NOT USED.
- CONST DUAL REDUCED PRESSURE DOMESTIC WATER BFP IN AN ABOVE GRADE ENCLOSURE.
- IRRIGATION CONNECTION. REFER TO LANDSCAPE ARCHITECT PLANS FOR CONTINUATION.
- NEW NATURAL GAS SERVICE. CONTRACTOR TO PROVIDE TRENCHING AND BACKFILL AND COORDINATE WITH AVISTA UTILITIES FOR CONDUIT INSTALLATION BY AVISTA UTILITIES. CONDUIT TO BE SUPPLIED BY AVISTA UTILITIES. TRENCH MUST HAVE A MINIMUM WIDTH OF 12" AND A MINIMUM DEPTH OF 36", INCLUDING A MINIMUM 6" DEPTH SAND BEDDING ON BOTTOM OF TRENCH. TRENCH BOTTOM MUST BE FREE OF ROCK AND DEBRIS. SAND SHALL BE USED TO BACKFILL IN THE PIPE ZONE TO 6" ABOVE THE TOP OF THE CONDUIT. TRENCH BACKFILL ABOVE THE PIPE ZONE SHALL BE NATIVE MATERIAL IN LANDSCAPED AREAS AND 3/4"-0" CRUSHED ROCK IN PAVEMENT AREAS. GAS SERVICE MUST MAINTAIN 12" MINIMUM HORIZONTAL AND VERTICAL SEPARATION FROM OTHER UTILITIES AND 36" HORIZONTAL SEPARATION FROM WATER LINES AND ELECTRIC LINES. CONTRACTOR MUST COMPLETE AND FAX IN GAS SERVICE APPLICATION TO AVISTA UTILITIES PRIOR TO SERVICE INSTALLATION (6 WEEKS MINIMUM). CONTRACTOR TO NOTIFY AVISTA UTILITIES AT LEAST 3 DAYS BEFORE METER INSTALLATION IS REQUIRED.
- CONNECT TO EX SS MH. REMOVE EX 4" INLET (TO BE DEMOLISHED). CORE DRILL MANHOLE WALL AND INSTALL NEW 8"SS. GROUT AND SEAL WALL PENETRATIONS WATERTIGHT.
- REMOVE AND REPLACE EX SS MH. REMOVE EX 4"SS PIPE CONNECTIONS ON LINES TO BE ABANDONED.
- BUILDING DOMESTIC WATER CONNECTION. PLUG END OF PIPE AND MARK FOR REFERENCE. COORDINATE FINAL LOCATION WITH BUILDING PLUMBER. REFER TO MECHANICAL/PLUMBING DRAWINGS FOR CONTINUATION.
- BUILDING FIRE PROTECTION CONNECTION. PLUG END OF PIPE AND MARK FOR REFERENCE. COORDINATE FINAL LOCATION WITH BUILDING PLUMBER. REFER TO MECHANICAL/PLUMBING DRAWINGS FOR CONTINUATION.
- NOT USED.
- NOT USED.
- NOT USED.
- REFER TO SPECIFICATION SECTION 21 13 13 FOR WALL MOUNTED FDC AND CONTINUATION INTO BUILDING.
- EXISTING NATURAL GAS LINE TO BE ABANDONED IN PLACE.

SANITARY SEWER CONNECTION

CONSTRUCTION NOTES

- UTILITY CROSSINGS:
 - NOT USED.
- CROSSING BETWEEN EXISTING UTILITY AND PROPOSED SANITARY SEWER: POT HOLE TO DETERMINE ELEVATION OF EXISTING UTILITY AND SUBMIT FINDINGS TO ENGINEER. NOTIFY ENGINEER IF MINIMUM ASSUMED 1' VERTICAL CLEARANCE CANNOT BE MAINTAINED.
- CROSSING BETWEEN NEW STORM AND NEW SANITARY SEWER: PROVIDE MINIMUM CLEARANCE BASED ON ELEVATIONS SHOWN.
- CROSSING BETWEEN TWO NEW UTILITIES: FOR CROSSINGS BETWEEN NEW SS AND OTHER NON-GRAVITY UTILITIES, ADJUST ELEVATION OF NON-GRAVITY UTILITY BY ADJUSTING VERTICAL ALIGNMENT OR CONSTRUCTING VERTICAL OFFSET (IF APPROVED) OF PROPOSED NON-GRAVITY UTILITY TO MAINTAIN MINIMUM 1' VERTICAL CLEARANCE. FOR CROSSINGS BETWEEN TWO NEW NON-GRAVITY UTILITIES, ADJUST ELEVATION OF ONE OR BOTH UTILITIES BY ADJUSTING VERTICAL ALIGNMENT OR CONSTRUCTING VERTICAL OFFSET (IF APPROVED) OF PROPOSED NON-GRAVITY UTILITY TO MAINTAIN MINIMUM 1' VERTICAL CLEARANCE.

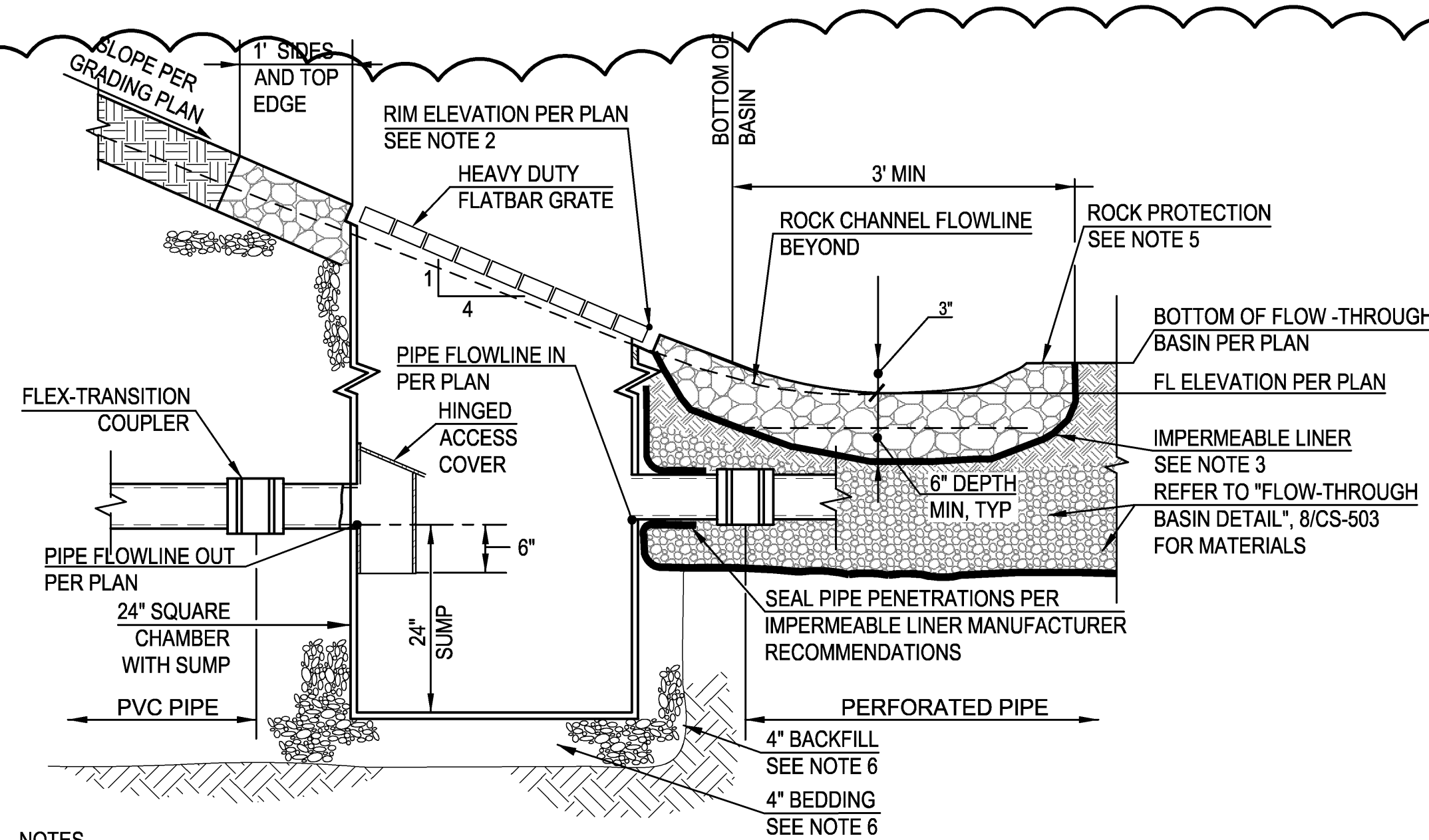

NOTES

- TRACER WIRE SHALL ENTER STRUCTURE AT PIPE INLET OR OUTLET. PROVIDE ENOUGH FREE WIRE TO EXTEND 24" ABOVE TOP OF GRATE TO FACILITATE TESTING. COIL WIRE AND SECURE WITH NON-CORROSIVE FASTENER UNDER FRAME.
- COORDINATES SHOWN ON PLAN REPRESENT MIDPOINT OF LOWER EDGE OF GRATED SECTION.
- TERMINATE IMPERMEABLE LINER AT BOTTOM OF STRUCTURE GRATE (ALL SIDES) AND 2' BELOW FINISHED SURFACE ELEVATION AT EDGE OF ROCK PROTECTION.
- EXTEND ROCK PROTECTION FROM BOTTOM EDGE OF STRUCTURE TO 3' MIN INTO BOTTOM OF FLOW-THROUGH BASIN, 1' MIN AROUND ALL SIDES AND TOP EDGE OF STRUCTURE, AND BETWEEN ROCK CHANNEL AND BOTTOM OF STRUCTURE AS SHOWN ON PLAN.
- ROCK PROTECTION MATERIAL IS 4" OPEN GRADED CRUSHED ROCK PER SPECIFICATION SECTION 33 40 00.
- BEDDING AND BACKFILL SHALL BE COMPACTED CRUSHED ROCK PER SPECIFICATION SECTION 31 20 00.

BASE BID OVERFLOW CATCH BASIN (OFCB)

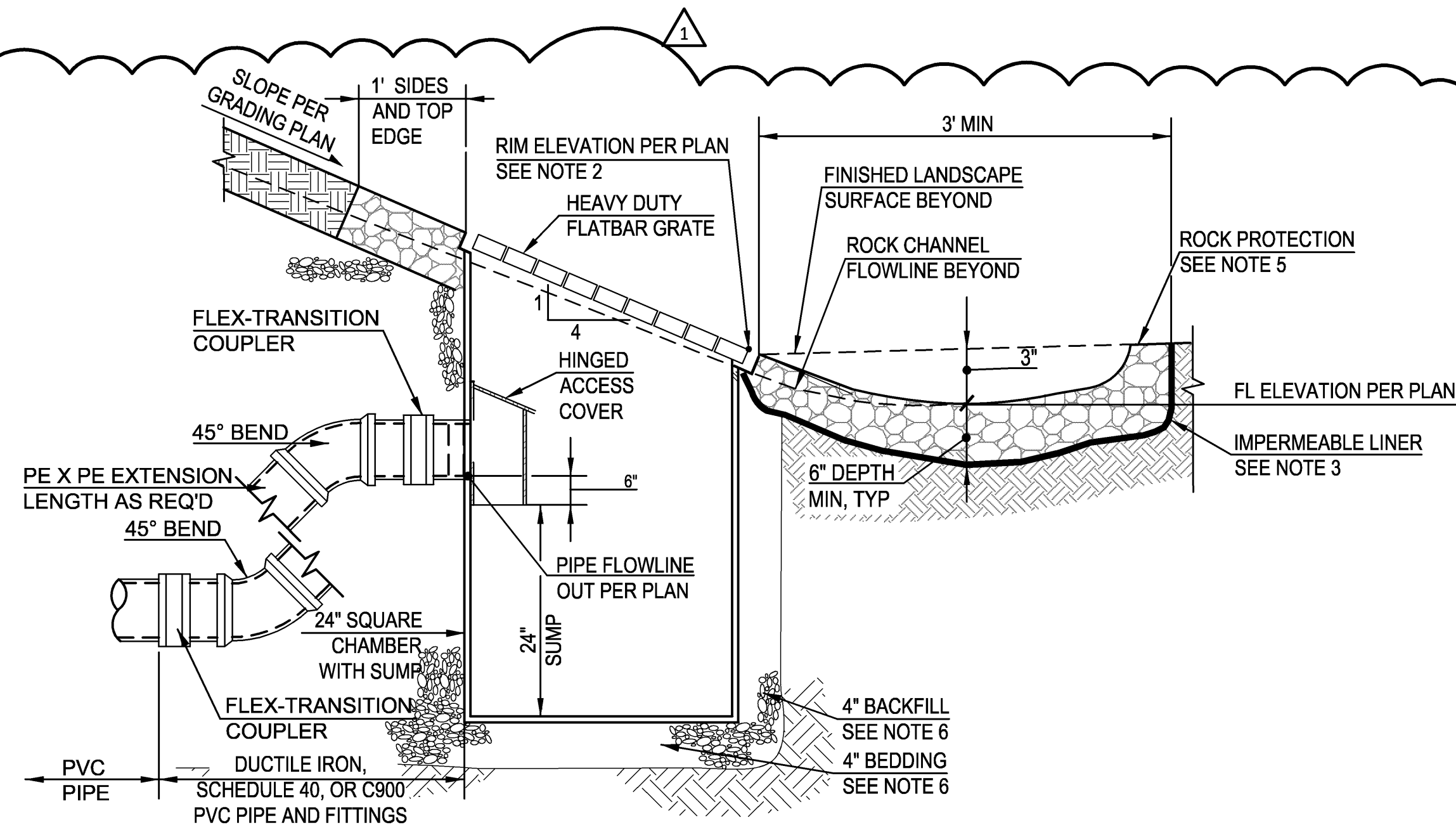

NOTES

- TRACER WIRE SHALL ENTER STRUCTURE AT PIPE INLET OR OUTLET. PROVIDE ENOUGH FREE WIRE TO EXTEND 24" ABOVE TOP OF GRATE TO FACILITATE TESTING. COIL WIRE AND SECURE WITH NON-CORROSIVE FASTENER UNDER FRAME.
- COORDINATES SHOWN ON PLAN REPRESENT MIDPOINT OF LOWER EDGE OF GRATED SECTION.
- TERMINATE IMPERMEABLE LINER AT BOTTOM OF STRUCTURE GRATE (ALL SIDES) AND 2' BELOW FINISHED SURFACE ELEVATION AT EDGE OF ROCK PROTECTION.
- EXTEND ROCK PROTECTION FROM BOTTOM EDGE OF STRUCTURE TO 3' MIN BEYOND BOTTOM EDGE OF STRUCTURE AROUND SIDES AND TOP EDGE OF STRUCTURE, AND BETWEEN ROCK CHANNEL AND BOTTOM OF STRUCTURE, AS SHOWN ON PLAN.
- ROCK PROTECTION MATERIAL IS 4" OPEN GRADED CRUSHED ROCK PER SPECIFICATION SECTION 33 40 00.
- BEDDING AND BACKFILL SHALL BE COMPACTED CRUSHED ROCK PER SPECIFICATION SECTION 31 20 00.

DEDUCTIVE ALTERNATE C-3 OVERFLOW CATCH BASIN (OFCB)

