

one eighth inch = one foot
one quarter inch = one foot
three eighths inch = one foot
one half inch = one foot
three quarters inch = one foot
one inch = one foot
one and one half inches = one foot
two inches = one foot
three inches = one foot
four inches = one foot
five inches = one foot
six inches = one foot
seven inches = one foot
eight inches = one foot
nine inches = one foot
ten inches = one foot
eleven inches = one foot
twelve inches = one foot
thirteen inches = one foot
fourteen inches = one foot
fifteen inches = one foot
sixteen inches = one foot
seventeen inches = one foot
eighteen inches = one foot
nineteen inches = one foot
twenty inches = one foot
twenty one inches = one foot
twenty two inches = one foot
twenty three inches = one foot
twenty four inches = one foot
twenty five inches = one foot
twenty six inches = one foot
twenty seven inches = one foot
twenty eight inches = one foot
twenty nine inches = one foot
thirty inches = one foot
thirty one inches = one foot
thirty two inches = one foot
thirty three inches = one foot
thirty four inches = one foot
thirty five inches = one foot
thirty six inches = one foot
thirty seven inches = one foot
thirty eight inches = one foot
thirty nine inches = one foot
forty inches = one foot
forty one inches = one foot
forty two inches = one foot
forty three inches = one foot
forty four inches = one foot
forty five inches = one foot
forty six inches = one foot
forty seven inches = one foot
forty eight inches = one foot
forty nine inches = one foot
fifty inches = one foot
fifty one inches = one foot
fifty two inches = one foot
fifty three inches = one foot
fifty four inches = one foot
fifty five inches = one foot
fifty six inches = one foot
fifty seven inches = one foot
fifty eight inches = one foot
fifty nine inches = one foot
sixty inches = one foot
sixty one inches = one foot
sixty two inches = one foot
sixty three inches = one foot
sixty four inches = one foot
sixty five inches = one foot
sixty six inches = one foot
sixty seven inches = one foot
sixty eight inches = one foot
sixty nine inches = one foot
seventy inches = one foot
seventy one inches = one foot
seventy two inches = one foot
seventy three inches = one foot
seventy four inches = one foot
seventy five inches = one foot
seventy six inches = one foot
seventy seven inches = one foot
seventy eight inches = one foot
seventy nine inches = one foot
eighty inches = one foot
eighty one inches = one foot
eighty two inches = one foot
eighty three inches = one foot
eighty four inches = one foot
eighty five inches = one foot
eighty six inches = one foot
eighty seven inches = one foot
eighty eight inches = one foot
eighty nine inches = one foot
ninety inches = one foot
ninety one inches = one foot
ninety two inches = one foot
ninety three inches = one foot
ninety four inches = one foot
ninety five inches = one foot
ninety six inches = one foot
ninety seven inches = one foot
ninety eight inches = one foot
ninety nine inches = one foot
one hundred inches = one foot

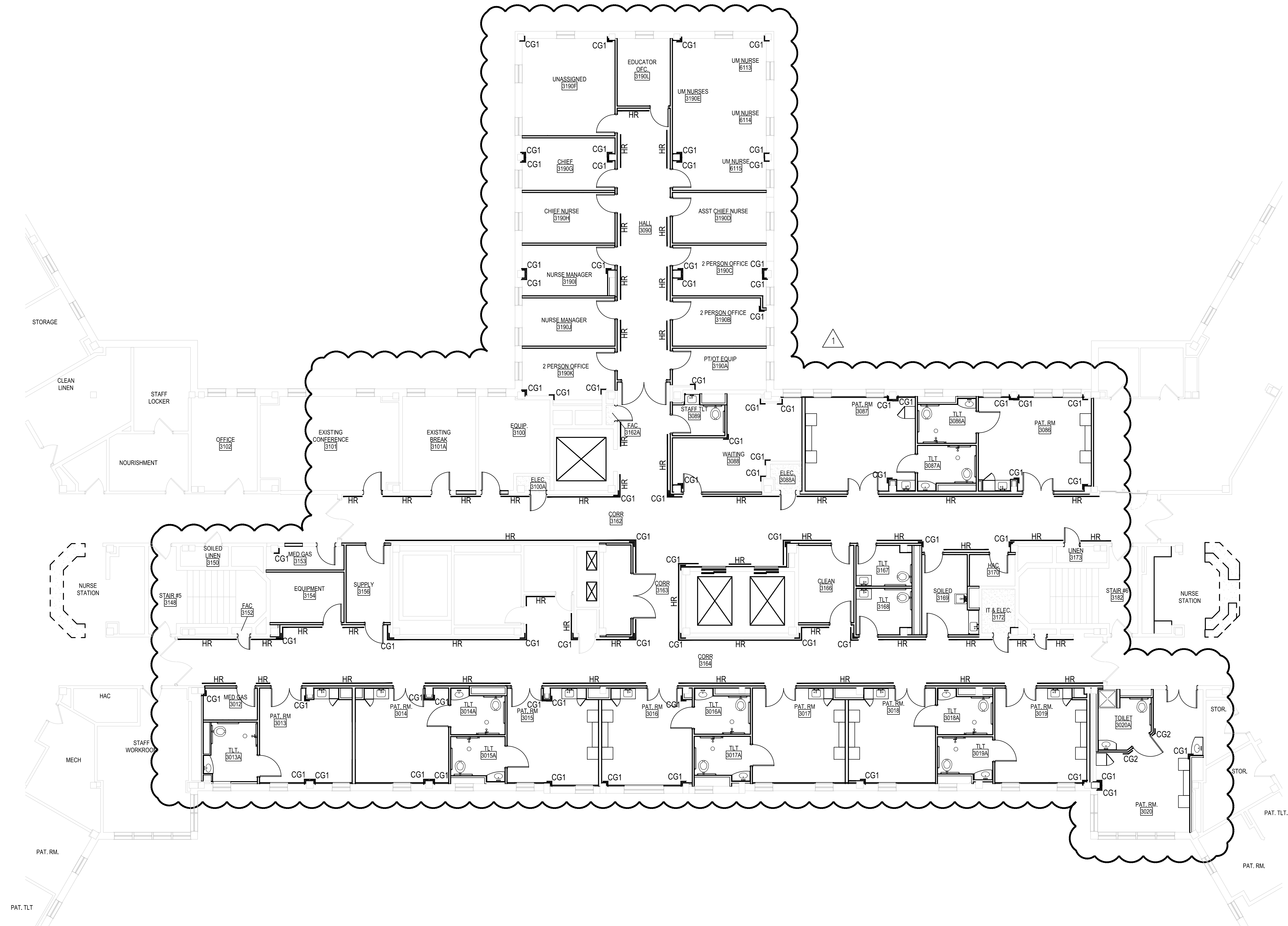

WALL PROTECTION PLAN LEGEND

- HR HANDRAIL LOCATIONS
- CG# CORNER GUARD LOCATIONS

GENERAL NOTES

- REFERENCE FINISH SCHEDULE ON IN601.
- ALL OUTSIDE CORNERS TO RECEIVE CORNER GUARDS. REFER TO FINISH SCHEDULE FOR COLOR AND MANUFACTURER.
- PROVIDE AND INSTALL APPROXIMATELY 500 +/- LINEAR FEET OF HAND RAIL PER MANUFACTURER'S INSTRUCTIONS. REFERENCE FINISH SCHEDULE FOR MANUFACTURER AND MODEL. ACTUAL LENGTH OF HAND RAIL TO BE FIELD VERIFIED PRIOR TO ORDERING AND INSTALLATION.
- HAND RAIL LOCATIONS SHOWN ON THIS PLAN ARE FOR GRAPHICAL REFERENCE ONLY. DO NOT TAKE MEASUREMENTS FROM PLAN. ALL HAND RAIL LOCATIONS AND MEASUREMENTS ARE TO BE FIELD VERIFIED AFTER CONSTRUCTION OF NEW WALLS AND INSTALLATION OF NEW DOOR FRAMES.
- TERMINATION POINTS OF HAND RAILS TO BE DETERMINED BY INSTALLER. DO NOT INSTALL HAND RAIL IN AREAS BEHIND DOOR SWING.
- DO NOT INSTALL HAND RAILS ON WALLS 24" OR LESS IN LENGTH UNLESS PART OF A CONTINUANCE OF A LONGER SECTION OF HAND RAIL THAT EXTENDS AROUND CORNER.
- INSTALL CORNER GUARDS PER MANUFACTURER'S INSTRUCTIONS. REFERENCE FINISH SCHEDULE FOR MANUFACTURER AND MODEL.
- ANGLED WALLS TO RECEIVE CORNER GUARD (CG2) AT TOILET ROOM 3020A TO BE VERIFIED IN FIELD PRIOR TO ORDERING AND INSTALLATION.

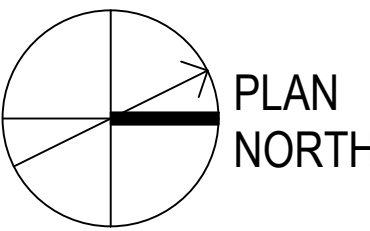

FINAL CONSTRUCTION DRAWINGS - FULLY SPRINKLERED

CONSULTANTS: FreemanWhite 8845 RED OAK BLVD. CHARLOTTE, NC 28217-5593 PHONE: 704.523.2230 FAX: 704.523.2235 www.freemanwhite.com LeGrand Engineering, Inc. 215 PARK AVE SE AKEN, SC 29801 PHONE: 803.502.0657 FAX: 803.540.4648 www.legrandengineering.com LAURENCE, RICKNER & SORRELL, INC. 8701 RED OAK BLVD, SUITE 300 CHARLOTTE, NC 28217-5593 PHONE: 704.522.0495 FAX: 704.522.0499 www.lrspc.net		SEAL 6361 6/19/2018	ARCHITECT/ENGINEERS: Atriax GROUP Atriax, pllc 102 3rd Avenue, NE PO Box 1629, Hickory, NC 28603 T: 828.315.9962 F: 828.315.9964 www.atriaxgroup.com NC Engineering License No.: P-0214 NC Architectural License No.: 51254	Drawing Title INTERIOR WALL PROTECTION PLAN Approved Project Director -	Project Title RENOVATE BUILDING 2 FOR MEDICAL SURGICAL MODERNIZATION Location W.G. HEFNER VAMC SALISBURY, NC Date MAY 1, 2018 Checked EHH Drawn MM	Project Number 659-17-101 Building Number 2 Drawing Number IN103 Dwg. 3 of 6	Office of Construction and Facilities Management Department of Veterans Affairs
----------------------------------------------------------------------------------------------------------------------------------------------------------------------------------------------------------------------------------------------------------------------------------------------------------------------------------------------------------------------------------------------------------------------------------------------------------------------------------------------------------	--	---------------------------------------------	--------------------------------------------------------------------------------------------------------------------------------------------------------------------------------------------------------------------------------------------------------------------------	----------------------------------------------------------------------------------------------------	-------------------------------------------------------------------------------------------------------------------------------------------------------------------------------------------------------------------------------------------	-----------------------------------------------------------------------------------------------------------------------------	------------------------------------------------------------------------------------------------------