

1. Plans call for communication work to be performed between building 6 and 34. Please provide full scope of work for that activity. Is this a fiber or CAT6 line?

Concerning the requirement to relocate IT closets, the design surveys anticipated a physical swing of existing CAT cabling and optic cabling from areas to the left of corridor 103 without replacing or extending existing cables.

All cables in the new construction area were anticipated to be new CAT6e.

All cable, hub, server and other data/voice devices were anticipated to be relocated with power connection and signal connection.

2. Please provide more information IRT the Sound Attenuation system requirements. What is the exact product. The size and thickness required. What kind of paint and how many coats.

Design anticipated vertical acoustical tile (5/8"x2'x4'). Minimum two (2) coats to prevent bleed through.

3. Can the Government provide a specification for the High Density Sound Blankets. Note I on Page

Fiberglass, STC 47

Smoke Developed 10

Flame spread 10

3 1/2" minimum

4. Can the Government provide a pricing schedule for the this project. It looks as if there are alternates for the flooring on page 12.

Note "A" is requiring a cost for all rooms indicated with square footage note (does not include rooms with "NIC").

Note "B" is requiring a deductive alternate with only a cost for room 103.

5. Can the Government provide a detail in regards to the Evaporation Supply Grill that needs to be capped and filled? Note C on page 2.

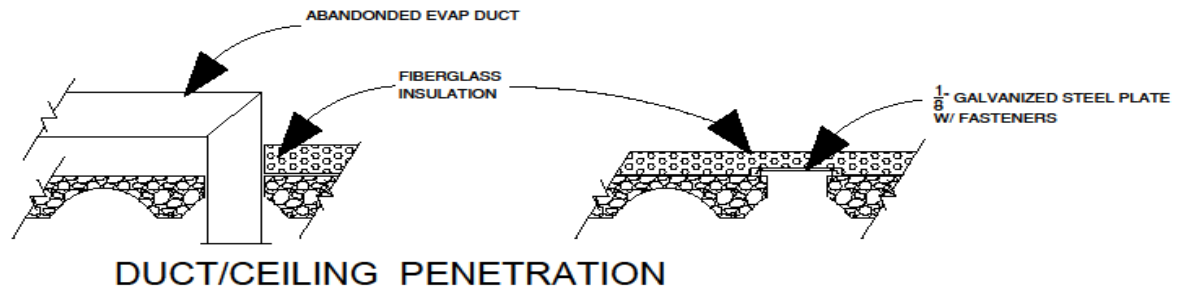

NTS

JHB 5-19-18

6. Can the government provide a LF of the Cove Base Roppe 6" continuous fawn 140? Note C page 12.

See sheet 2 of 12

7. Can the government please clarify the Sharewall notes (A & B) as it pertains to the Alternate and or base?

Note "A": BASE-All walls/vertical surfaces/columns, to be sheathed with magnetic/dry erasable panels.

Note "B": DEDUCTIVE-Only the north "N", the south "S" and east "E" walls to be sheathed with magnetic/dry erasable panels.

- 8.- Can the government provide Square footage of the room 110? There are 2 rooms labeled 110.

Restroom, "110"-adjacent to corridor room 106; correct room number is 106A.

NO WORK (FLOORING) IS SCHEDULED FOR ROOMS RESTROOM 110, RESTROOM 106A
HOUSEKEEPING CLOSET 111A OR IT CLOSET.

9. - Can the government provide a product spec for the Resilient sheet floor needed at the room 110?

"NIC" IS DEFINED AS "NOT IN CONTRACT". No resilient flooring in this area.

10. -Can the Government provide the spec for acoustical panel on the wall.

The design's intention is to utilize the same acoustical panels of the suspended ceiling system only vertical and painted. Utilize a low VOC adhesive for attachment to wall surfaces.

11 - Is the wall acoustical panels for the entire room above the white boards installation?

YES

12 -What is the Rail support system for on sheet 3 of 12?

Future operating system for electronic media screens.

13 - -On the demo sheet it shows to remove two windows. The floor plan doesn't show replacing windows. Are we to infill opening with framing and drywall with stucco on the exterior?

Windows shall be filled. Remove existing wood sill. Provide rigid fiberglass board between existing window frame and new metal studs. Fiberglass board shall be Knauf ECOSE black or approved equal. Sheath with 5/8" type X gypsum board.

14 On sheet 2, note V it calls for the removal of an anchor, upon plan review there is no reference to said anchor or note V, please advise.

DRAWING 2 OF 12, ROOM 103, INDICATES AN EMPTY NOTE CIRCLE ADJACENT TO A SOLID BLACK BOX. THESE NOTATION REPRESENT A FABRICATED STEEL SUPPORT FRAME ATTACHED TO THE CONCRETE PAN STRUCTURE ABOVE WITH INSERT ANCHORS. THIS FRAME IS VISIBLE THROUGH THE ACOUSTICAL CEILING TILE AS A POINT OF ANCHORAGE FOR HANGING ITEMS.

THE DESIGN INTENDS FOR THE FRAME TO BE REMOVED FROM THE BOLTS ANCHORS.

15 On sheet 2 note L it calls for the removal of existing window but on sheet 3 there is no reference as to the infill at that location. Please advise and to how the government wants that opening infilled and both interior/exterior desired finishes.

PREVIOUS ANSWER

16 On sheet 3, it shows a new wall framed that runs adjacent to the existing wall separating rooms 102 and 103. Please provide detail as to new wall thickness and overall assembly desired.

3 1/2" METAL STUD WALL WITH SOUND BATTING. 5/8" TYPE X GYPBOARD WITH FINISH AND PAINT.

17 On sheet 3, note I it calls for high density sound blankets. Please provide additional details as to installation and location.

PERVIOUS ANSWER

18 On sheet 3 east wall elevation it shows the location of “painted acoustic tiles”. In my experience and research, when one paints and acoustical tile and seals the manufactured pores in said tiles, any sound attenuation qualities that may have existed will no longer exist. Please advise if indeed this is the goal of the government or would the government want to proceed with a different method.

PAINTED SURFACE ON ACOUSTICAL PANELS IS THE INTENT OF THE DESIGN.

19 Sheet 3, note D, solid surface window sill. Please advise as to what type of solid surface that the government would prefer in these locations.

**ACRYLIC, EPOXY OR POLYESTER RESIN COMPOSITE, WHITE IN COLOR.
CORIAN OR APPROVED EQUAL.**

20 Sheet 3, note J magnetic dry erase board . . . , please advise as to how the government would like the contractor to address the seams, would the government want those seams just butted together or would they prefer the seams covered with a like accessory product ?

PREVIOUS ANSWER

21 Sheet 3, Elevation good detail, it refers to a “ flat panel ” with no other information. Please advise and to what it is the government is referring to here and provide additional details as to its location and installation.

“FLAT PANEL” REFERS TO ELECTRONIC MEDIA SCREEN. NOT IN CONTRACT-DESIGN INTENT IS TO BE ABLE TO ATTACH TO RAIL SYSTEM AT LATER TIME.

22 Sheet 10, note E, provide 24 strand multimode fiber optic from 106A-6 to Bldg. 34 via service hole 5. From past experience the existing conduits to provide said fiber will not accommodate any additional strands much less an additional 24 strand. Please advise how you would want this additional fiber run and the routing the government would want the contractor to take.

PREVIOUS ANSWER-ALL FIBER OPTIC WORK BETWEEN B6 AND B34 DELETED

23. Regarding the (2) Electric Operated Projector Screens (Da-Lite Designer Contour or approved equal) as noted on sheet 3, note F. Research into said Projector screens revealed that they come in numerous sizes and finishes , please provide desired sizing and finishes of said screens.

DELETE ALL WORK RELATED TO ELECTRIC OPERATED PROJECTOR SCREENS

24. Is the acoustical ceiling specification 09 51 00 applicable to the wall acoustical panels? If not, provide specification or clarify intent. **YES**

25. Is the acoustical panel detail around the entire interior of the room or just the east elevation shown? **COMPLETE PERIMETER**

26. Please provide a specification for the High Density Sound Blankets or at

minimum provide R value and any other salient factors
PREVIOUS REPLY

27. Demolition Page 2 or 12 note L states to remove 2 windows. Are these to be replaced with new windows as appears in the elevation on Architectural Page 3? If so please provide a window specification or description of desired windows or clarify if the windows should be infilled (drywall/framing/stucco etc). **WINDOW TO REMAIN. INFILL WITH INSULATION BOARD, METAL STUDS DRYWALL.**
28. Architectural Page 3 or 12 Elevation shows a “rail support”. Please clarify what this rail system is for and/or if there is a specification or preferred manufacturer. **FUTURE ATTACHMENT OF ELECTRONIC MEDIA SCREENS**
29. Architectural Page 3 of 12 Sound Tile Section shows a metal L trim is shown. Clarify what this product is. **REPLACE “L” WITH “J” TYPE METAL EDGING**
30. Is any edge trim required for the marker boards or is it whatever the manufacturer recommends?
DESIGN ANTICIPATED FLUSH FIT AT HORIZONTAL MEETING EDGES; NO TRIM TOP AND BOTTOM.
31. Electrical Sheet 6 Note B says to provide conduit/j box @ 48” for flat panel – there is no note B on the drawings – clarify scope. **PROVIDE VACANT 4”x4” J-BOX WITH ¾” CONDUIT TO CEILING SPACE EACH SIDE OF EXIT DOORWAY.**
32. Special Systems Sheet 10 Note C says 2-cat 6 cables from service point room 106A. There is no note C on the drawings – clarify scope
RELOCATE ALL FIBER OPTIC CABLE EXISTING IN ROOM 109, IT, TO ROOM 106A, IT.
33. Special Systems Sheet 10 Note E says Provide 24 strand multimode fiber optic from 106 A to building 34 via service hole 5. Please clarify fiber scope of work – it wasn’t clear at the walk through exactly what is being required.
DELETE ALL FIBER OPTIC WORK FROM BUILDING 6 TO BUILDING 34
34. Special Systems Sheet 10 Note F says Provide ACP AR203A or approved equal. There i no note F on the drawings – clarify scope
CONTRACT SHALL FURNISH ONE (1) -4- POST OPNE FRAME RACK IN ROOM 106A.
35. Special Systems Sheet 10 Note G says Provide two (2) Leviton 5R2UL-F06 or approved equal. There is no note G on the drawings - clarify scope
CONTRACT SHALL FURNISH TWO (2) FLUSH MOUNT FIBER OPTIC DISTRIBUTION AND SPLICE ENCLOSURES IN ROOM 106A.
36. Base/Alternates Page 12 shows multiple alternates, A, B, C. Would you provide a bid schedule as how the alternates are to be priced is unclear. Are Carpet B & C alternates to be deducts from the base price? Is the Sharewall alternate B to be a deduct from the

base price? Or are the alternates to be the base price with the reduced scope

BASE BID:

CARPET-ALL AREAS OF BUILDING 6 IDENTIFIED WITH SQUARE FOOTAGE.

COVE BASE-ALL AREAS OF BUILDING 6 IDENTIFIED WITH SQUARE FOOTAGE.

SHAREWALL-ALL WALLS, INCLUDING COLUMNS, IN ROOM 106.

ALTERNATE BID:

CARPET-ROOM 103

COVE BASE-ROOM 103

SHAREWALL-NORTH WALL, EAST WALL, SOUTH WALL.

37. Base/Alternates Page 12 – please clarify the alternates.

a. Clarify the Carpet C alternate for Cove Base. Is Cove base to be included in all rooms in the base bid and just 103 in the alternate?

NEW COVE BASE WITH ALL NEW CARPET INSTALLATIONS

38. If the base bid for carpeting 16 rooms is acceptable will the rooms have to be phased or will the entire building be available at one time? Also, confirm the rooms will be cleaned out and ready for carpet removal/reinstallation.

YES, PHASING TO RECARPET WILL BE REQUIRED. CONTRACTOR TO REMOVE AND REINSTALL ALL IMPACTING FURNITURE.

39. Reflected Ceiling Page 8 of 12 shows Sa and Sb next to the fixtures. Is this indicating 2 type NWSX LV DX dimming controls; if not, please clarify what the references mean.

INTENT OF DESIGN IS TO HAVE TWO (2) SWITCHING STATIONS.

EACH STATION WOULD HAVE A LOW VOLTAGE WALLPOD SWITCH (ACUITY NPODM DX WH/204 V9V OR APPROVED EQUAL) AND A LOW VOLTAGE CEILING MOUNT SENSOR (ACUITY NCM PDT 10 RJB OR APPROVED EQUAL), DUAL PASSIVE MOTION/EXTENDED RANGE 360 DEG. LENS, REAR RJ-45 PORTS.