

three inches = one foot  
one and one half inches = one foot  
one inch = one foot  
three quarters inch = one foot  
one half inch = one foot  
three eighths inch = one foot  
one quarter inch = one foot  
one eighth inch = one foot

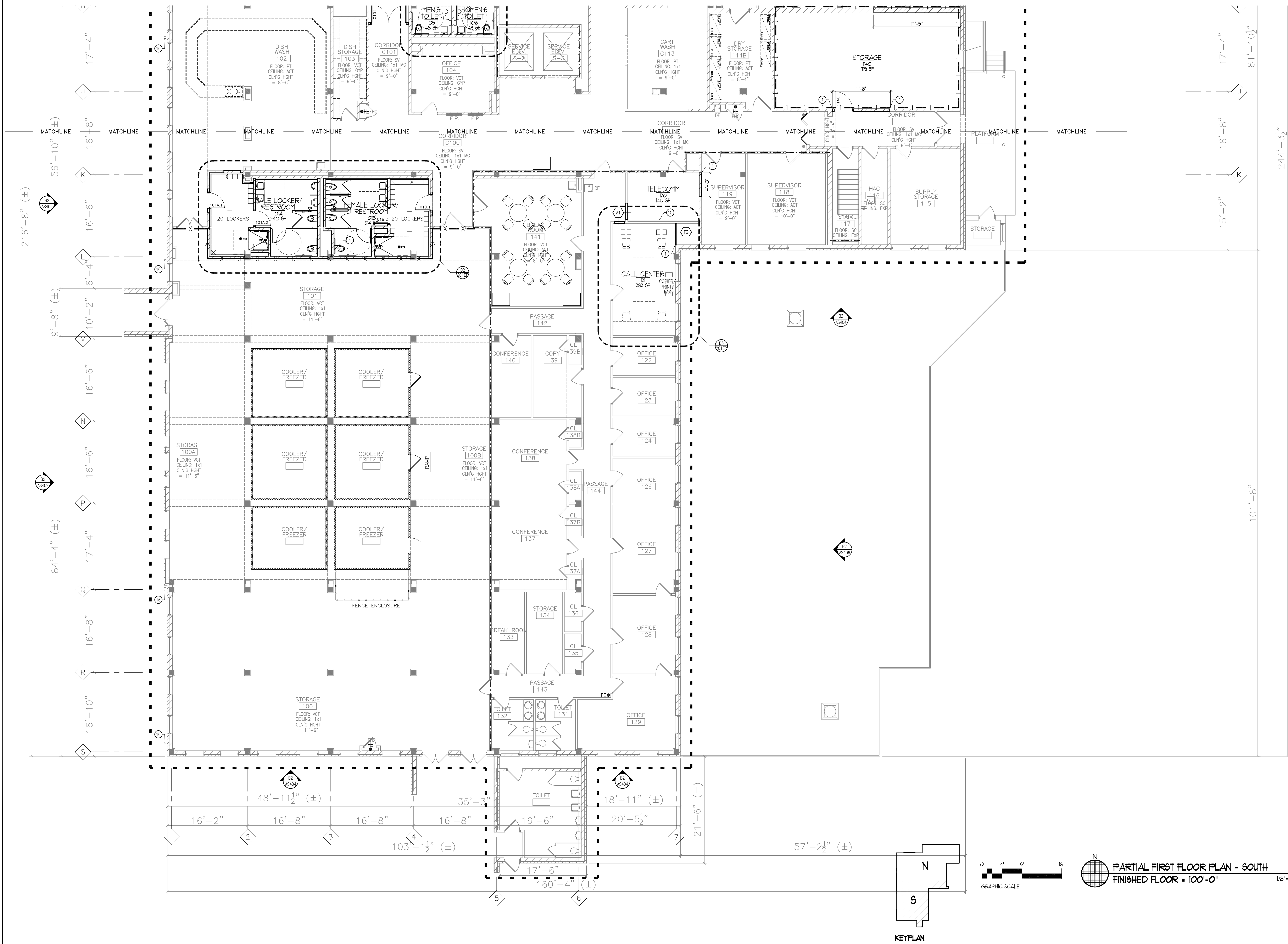

- FLOOR PLAN - SYMBOLS LEGEND**
- NEW WALL / PARTITION
  - EXISTING WALLS TO REMAIN
  - NEW DOOR AND FRAME
  - EXISTING DOOR AND FRAME TO REMAIN
  - SECTION REFERENCE
  - DETAIL REFERENCE
  - INTERIOR ELEVATION
  - BORROWED LITE, REFER TO DETAILS ON SHEET AS-830
  - KEYNOTE / WALL TYPE / PARTITION TYPE
  - PLAN NOTE
  - CONSTRUCTION LIMITS - ARCHITECTURAL
  - CORNER GUARD (REFER TO DETAIL C3/A8-300)
  - ONE HOUR FIRE RESISTIVE CONSTRUCTION
  - FIRE EXTINGUISHER

- FLOOR PLAN - GENERAL NOTES**
- DIMENSIONS ON FLOOR PLAN ARE BASED ON FACE OF FINISHED WALL TO FACE OF FINISHED WALL (NOMINAL).
  - VERIFY ALL DIMENSIONS AND CONDITIONS AT JOB SITE. PORTIONS OF EXISTING CONSTRUCTION MAY HAVE BEEN REMOVED BY FHCC.
  - MAINTAIN CONTINUOUS UTILITY SERVICE TO ALL SPACES IN THE BUILDING NOT AFFECTED BY THIS WORK. COORDINATE WITH FHCC ANY DISRUPTION IN SERVICES REQUIRED TO PERFORM WORK OR TO MODIFY EXISTING PIPING, DUCTWORK OR ANY ASSOCIATED EQUIPMENT.
  - REFER TO PROJECT MANUAL FOR ROOM FINISH SCHEDULE AND NOTES.
  - REFER TO SHEET #80 FOR DOOR SCHEDULES, DOOR TYPES, AND NOTES.

- FLOOR PLAN NOTES**
- ALIGN
  - PORTION OF WALL TO BE FULL HEIGHT.
  - PARTIAL HEIGHT WALL. REFER TO DETAIL B6/A8-300.
  - RECESSED FLOOR SLAB IN THESE AREAS.
  - UDG WALL SYSTEM. REFER TO FOOD SERVICE DRAWINGS.
  - NEW CONCRETE SLAB. REFER TO DETAIL D3/A6-00.
  - NEW DRINKING FOUNTAIN. REFER TO ELEVATION A6/A8801.
  - PATCH WALL TO MATCH EXISTING.
  - REMOVABLE SECTION OF RAILING. REFER TO DETAIL B6/B6-00.
  - PROVIDE 3 1/2" HIGH CONCRETE HOUSEKEEPING PADS UNDER EQUIPMENT.
  - NEW CHAIN LINK FENCE.
  - NEW GRASS SEED IN THIS AREA.
  - EXISTING RELOCATED FIRE EXTINGUISHER.
  - PATCH WALL TO MATCH EXISTING.
  - PROVIDE AND INSTALL 3/4" PLTACOD ON ALL WALLS OF FROM FLOOR TO 36" A.F.F. FLYWOOD TO BE PAINTED ON ALL 6 SIDES WITH (2) COATS OF FIRE RETARDANT PAINT.
  - DOWNSPOUT AND SPLASHBLOCK.
  - NEW MECHANICAL LOUVER. REFER TO DETAILS C1 AND D1/A8-600.

- GYPSUM BOARD PARTITION SCHEDULE**
- INTERIOR STEEL STUD PARTITION**
- (M) 3/4" STEEL STUDS @ 16" OC WITH 3" SOUND ATTENUATION INSULATION AND ONE LAYER 5/8" GYPSUM BOARD @ EACH FACE. PROVIDE 1 HR RATED UL #469 DESIGN WHERE 1 HR CONSTRUCTION IS INDICATED ON PLANS.
- INTERIOR FURRING PARTITION**
- (F) 2 1/4" STEEL STUDS @ 16" OC WITH ONE LAYER 5/8" GYPSUM BOARD. (REFER TO DETAIL C5/A8900)
  - (H) 3/4" STEEL STUDS @ 16" OC WITH ONE LAYER 5/8" GYPSUM BOARD.

- GYPSUM BOARD PARTITION GENERAL NOTES**
- ALL GYPSUM BOARD PARTITIONS SHALL BE (M) UNLESS OTHERWISE NOTED ON FLOOR PLAN.
- GYPSUM BOARD PARTITION DIMENSIONS ON FLOOR PLAN ARE BASED ON FACE OF FINISHED PARTITION TO FACE OF FINISHED PARTITION (NOMINAL).
- REFER TO GYPSUM BOARD SPECIFICATION FOR LOCATIONS 4 TYPE(S) OF GYPSUM BOARD MATERIAL REQUIRED.
- PROVIDE TYPE 'X' FIRE RATED GYPSUM BOARD AT ALL FIRE RATED PARTITIONS.
- SEAL ALL WALL PENETRATIONS AT PERIMETER AND FIRESTOP ALL FIRE RATED PARTITIONS.
- EXTEND ALL GYPSUM BOARD PARTITIONS FULL HEIGHT TO UNDERSIDE OF STEEL DECK ABOVE. AT METAL DECK CONSTRUCTION ABOVE PROVIDE SLIP JOINT BETWEEN TOP OF PARTITION AND UNDERSIDE OF METAL DECK / STRUCTURAL STEEL MEMBER ABOVE. REFER TO DETAIL C6/A8900.

- MASONRY PARTITION SCHEDULE**
- INTERIOR MASONRY PARTITION**
- (M6) 6" CONCRETE BLOCK.
  - (M12) 12" CONCRETE BLOCK.
- MASONRY PARTITION GENERAL NOTES**
- MASONRY PARTITIONS INDICATED WITH THE FOLLOWING HATCH PATTERN:
- ALL MASONRY PARTITIONS SHALL BE 6" CONCRETE BLOCK UNLESS OTHERWISE NOTED OR DIMENSIONED. REFER TO FLOOR PLAN FOR PARTITION THICKNESSES.
- PROVIDE UL FIRE RATED CONCRETE BLOCK AT ALL FIRE RATED PARTITIONS.
- SEAL ALL WALL PENETRATIONS AT PERIMETER AND FIRESTOP ALL RATED PARTITIONS.
- EXTEND CONCRETE BLOCK PARTITIONS FULL HEIGHT TO UNDERSIDE OF STEEL DECK ABOVE (OR PRECAST PLANK ABOVE IF APPLICABLE). REFER TO DETAIL C4/A8-300. PROVIDE HORIZONTAL MASONRY JOINT REINFORCEMENT AT 16" OC VERTICALLY. REFER TO STRUCTURAL DRAWINGS FOR VERTICAL REINFORCEMENT REQUIREMENTS.

**FINAL BID DOCUMENTS**

<b>FINAL BID DOCUMENTS</b> 90% CONSTRUCTION DOCUMENTS SUBMISSION 06-26-12 50% CONSTRUCTION DOCUMENTS SUBMISSION 05-17-12 35% DOCUMENTS SUBMISSION 04-06-12 SCHEMATIC DESIGN SUBMISSION 02-22-12 Revisions: 11-21-11 Date	 <b>Federal Health Care Center</b> U.S. Department of Veterans Affairs   U.S. Department of Defense  <b>Captain James A. Lovell</b> Federal Health Care Center 3001 Green Bay Road North Chicago, IL, 60064	 <b>CONSULTANTS:</b>  <b>ARNOLD &amp; O'SHERIDAN</b> Consulting Engineers  <b>CHEQUAMEGON BAY ENGINEERING, INC.</b>  <b>MACKESEY AND ASSOCIATES, LLC</b>	<b>PROJECT LEADER:</b>  11000 West Park Place • Milwaukee WI 53224 • Tel 414 359-3060 • Fax 414 359-3070  <b>Intelligent Designs</b>  <b>Inspired Results</b> www.p.r.a.r.c.h.com PRA Job No. 110172-01	<b>Drawing Title</b> Partial First Floor Plan - South  <b>Approved:</b> Project Director	<b>Project Title</b> AE SCIP for Building 6 FHCC  <b>Location</b> North Chicago, IL  <b>Date</b> June 26, 2012 <b>Checked By:</b> PRA <b>Drawn By:</b> RLS	<b>Project Number</b> 556-11-119 <b>Building Number</b> 6 <b>Drawing Number</b> AS-201S   <b>Department of Veterans Affairs</b>
--	--	--	---	---	---	---