

ROOF PLAN - SYMBOLS LEGEND

- DIRECTION OF STRUCTURAL SLOPE TO DRAIN
- SLOPE DIRECTION OF INSULATION TAPER SLOPE TO DRAIN. MINIMUM ALLOWABLE TAPER SLOPE SHALL BE 1/4" PER FOOT UNLESS NOTED OTHERWISE
- TAPERED INSULATION VALLEY OR RIDGE
- LOCATION OF SELF-ADHERING RUBBERIZED ASPHALT UNDERLAYMENT MEMBRANE
- TAPERED INSULATION THICKNESS
- LOCATION OF CONCRETE PAVEMENT WALKWAY
- ROOF PLAN NOTE
- EXISTING ROOF DRAIN TO REMAIN
- CONSTRUCTION LIMITS

ROOF PLAN - GENERAL NOTES

- COORDINATE AND VERIFY ALL ROOF OPENINGS AND PENETRATIONS WITH STRUCTURAL PLUMBING, HVAC, AND ELECTRICAL REQUIREMENTS.
- PROVIDE WATER TIGHT INTEGRITY AT ALL PENETRATIONS AND EQUIPMENT PER ROOFING MANUFACTURERS STANDARD DETAILS AND REQUIREMENTS FOR WARRANTY AND CURRENT NRCA STANDARDS.
- PROVIDE POSITIVE ROOF DRAINAGE INCLUDING TAPERED INSULATION LAYOUT. PROVIDE SADDLES AND CRICKETS AT ALL ROOF TOP EQUIPMENT AND PENETRATIONS TO ENSURE POSITIVE DRAINAGE.
- PROVIDE 24" WIDE CONCRETE PAVEMENT WALKWAY FROM ROOF SCUTTLE TO ALL MECHANICAL ROOFTOP UNITS AND ALL ROOF ACCESS LADDERS. PROVIDE PAVERS AROUND PERIMETER OF ROOF SCUTTLE AND HVAC ROOFTOP UNITS. PROVIDE PAVERS AT LANDINGS BELOW ROOF ACCESS LADDERS.
- FOR ALL ROOF AREAS AS PART OF THIS CONTRACT, PROVIDE NEW 3-PLY MOD BIT ROOF PER SPEC SECTION 01 52 00. NEW INSULATION TO SLOPE 1" PER FOOT PER SPEC SECTION 01 22 00 AND ALL FLASHINGS AND ACCESSORIES REQUIRED FOR A COMPLETE ROOF INSTALLATION.
- EXTEND CURBS ON ALL MECHANICAL PLUMBING AND OTHER EQUIPMENT AS REQUIRED TO MAINTAIN 12" CLEAR FROM UNDERSIDE OF EQUIPMENT (OR TOP OF CURB/FLASHING) TO TOP OF FINISHED ROOF TYP.
- ADD ALLOWANCE FOR DEMO AND PATCHING EXISTING ROOF AFTER VENTS OR OTHER EQUIPMENT HAS BEEN REMOVED.

ROOF PLAN NOTES

- PORTION OF ROOF NOT IN CONTRACT.
- PATCH EXISTING ROOF OPENING TO MATCH EXISTING.
- NEW BUILT UP ROOF SYSTEM TO BE INSTALLED.
- NEW ROOF DRAIN. SEE DETAIL B3/A600.
- NEW SCUPPER.
- NEW RELIEF SCUPPER.
- NEW DOWNSPOUT AND SPLASHBLOCK.
- NEW ROOF DRAIN. SEE DETAIL B4/A600.
- NEW GUTTER.
- INFILL EXISTING ROOF OPENING. REFER TO MECHANICAL DRAWINGS FOR DETAIL.
- EXISTING ROOF OPENING TO BE ENLARGED.
- NEW MECHANICAL ROOF TOP UNIT.
- NEW EXHAUST FAN.
- NEW INTAKE HOOD.

CONSTRUCTION KEYNOTE LEGEND

- (R1) BUILT-UP ROOFING (BUR) SYSTEM: SURFACING ON BUILT-UP ROOFING ON INSULATION ON THERMAL BARRIER.
- (R2) ASPHALT SHINGLE ROOFING SYSTEM: SHINGLES ON UNDERLAYMENT. SEE ROOF PLAN FOR LOCATION(S) OF ICE & WATER BARRIER.

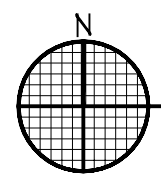
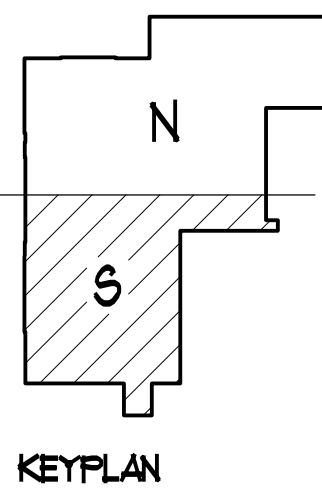

PARTIAL ROOF PLAN - SOUTH

1/8" = 1'-0"

<p>FINAL BID DOCUMENTS</p> <p>90% CONSTRUCTION DOCUMENTS SUBMISSION 05-17-12</p> <p>50% CONSTRUCTION DOCUMENTS SUBMISSION 04-06-12</p> <p>35% DOCUMENTS SUBMISSION 02-22-12</p> <p>SCHEMATIC DESIGN SUBMISSION 11-21-11</p> <p>Revisions: Date</p>	<p>Federal Health Care Center</p> <p>U.S. Department of Veterans Affairs U.S. Department of Defense</p> <p>Captain James A. Lovell</p> <p>Federal Health Care Center</p> <p>3001 Green Bay Road</p> <p>North Chicago, IL, 60064</p>	<p>CAPTAIN JAMES A. LOVELL</p> <p>FEDERAL HEALTH CARE CENTER</p> <p>2010</p>	<p>CONSULTANTS:</p> <p>ARNOLD & O'SHERIDAN</p> <p>Consulting Engineers</p> <p>CHEQUAMEGON BAY ENGINEERING, INC.</p> <p>MACKESEY AND ASSOCIATES, LLC</p>	<p>PROJECT LEADER:</p> <p>Plunkett Raysich Architects</p> <p>11000 West Park Place • Milwaukee WI 53224 • Tel 414 359-3060 • Fax 414 359-3070</p> <p>Intelligent Designs</p> <p>Inspired Results</p> <p>www.p r a r c h . c o m</p> <p>PRA Job No. 110172-01</p>	<p>Drawing Title</p> <p>Partial Roof Plan - South</p> <p>Approved: Project Director</p>	<p>Project Title</p> <p>AE SCIP for Building 6 FHCC</p> <p>Location</p> <p>North Chicago, IL</p> <p>Date</p> <p>June 26, 2012</p> <p>Checked By:</p> <p>PRA</p> <p>Drawn By:</p> <p>RLS</p>	<p>Project Number</p> <p>556-11-119</p> <p>Building Number</p> <p>6</p> <p>Drawing Number</p> <p>AS-203S</p>	<p>Office of Facilities Management</p> <p>Department of Veterans Affairs</p>
--	--	--	--	---	--	---	---	--