

Red Circle shows
location of
washer

EQUIPMENT SCHEDULE - FIRST FLOOR										
Equipment Number	Equipment Description	Equipment Manufacturer	Qty.	Provided by		REQUIREMENTS				Notes
				Installed by		Electrical	Plumbing	Data		
24002E	EYE INSTRUMENT ULTRASONIC	MEDISAFE	1	VA	VA	Yes	No	No		
24003F	AUTO CART WASH	STERIS	1	VA	CC	Yes	Yes	Yes		
24010E	CARTS - MISC SUPPLY		3	VA	VA	No	No	No		
24011E	CARTS - BED PADS HANGING		1	VA	VA	No	No	No		
24012E	CART WITH PHONE		1	VA	VA	No	No	No		
24013E	CARTS - SMALL		2	VA	VA	No	No	No		
24014E	CLAMP INSTRUMENT RACK		2	VA	VA	No	No	No		
24015E	INSTRUMENT TOOL BOXES		2	VA	VA	No	No	No		
24016E	THRU-WALL VENTED CABINET	HARLOFF	1	VA	CC	Yes	No	No		
24017E	CART WITH CORROS		1	VA	VA	No	No	No		
24018E	LASER PRINTER	HP	1	VA	VA	Yes	No	Yes		
24019E	CHARGER UNIT	COVIDIEN	1	VA	VA	No	No	No		
24020E	BECK ON WHEELS	CASPA SOLUTIONS	5	Yes	Yes	Yes	No	No		
24021E	RACKS WITH INSTRUMENTS		2	VA	VA	No	No	No		
24022E	RACK WITH CASE LIDS		1	VA	VA	No	No	No		
24024E	CARTS - BED PADS HANGING		1	VA	VA	No	No	No		
24025E	CHEMICAL STERILIZER	ASP	1	VA	CC	Yes	No	No		
24026E	CART CARRIERS	STERIS	4	VA	VA	No	No	No		
24027E	AUTO READERS	3M	4	Yes	VA	No	No	No		
24032E	STERILIZER	STERIS	2	VA	VA	No	No	No		
24028F	STERILIZER	STERIS	1	1	VA	VA	No	No		
24029E	WASHER DISINFECTOR - THRU WALL	STERIS	2	VA	CC	No	No	No		
24029F	WASHER DISINFECTOR - THRU WALL	STERIS	1	VA	CC	No	No	No		
24030F	LOW V PRO MAX STERILIZER	STERIS	1	VA	CC	No	No	No		
24032E	CANWAVE		2	VA	CC	Yes	No	No		
24033E	DOSING SYSTEM		2	VA	VA	Yes	No	Yes	TWO ARE FUTURE EQUIPMENT	
24033F	DOSING SYSTEM		2	VA	VA	Yes	No	Yes	TWO ARE FUTURE EQUIPMENT	
24034E	METAL TABLE - LARGE		1	VA	VA	No	No	No		
24035E	MONITOR - WALL MOUNTED		2	VA	VA	No	No	Yes	TWO ARE FUTURE EQUIPMENT	
24035F	MONITOR - WALL MOUNTED		2	VA	VA	Yes	No	Yes	TWO ARE FUTURE EQUIPMENT	
24036E	MONITOR - WALL MOUNTED		1	VA	VA	Yes	No	Yes	TWO ARE FUTURE EQUIPMENT	
24037E	RACK FOR CASES		1	VA	VA	No	No	No		
24038E	TABLE ON WHEELS - SMALL		1	VA	VA	No	No	No		
24039E	RACK WITH TOWELS AND CHEMICALS		1	VA	VA	No	No	No		
24040E	CARTS FOR WASHER - SMALL		2	VA	VA	No	No	No		
24041E	METAL WORK TABLE		1	VA	VA	No	No	No		
24046E	STERILE DRYER	OLYMPIC	1	VA	VA	Yes	1	No	No	
24046F	SCOPE DRYING		1	VA	VA	No	No	No		
24047E	THERMAL PRINTER		2	VA	VA	Yes	Yes	Yes		
24048N	MEDIATOR	UNKNOWN	1	VA	CC	Yes	Yes	No		
24049E	RACK		1	VA	CC	No	No	No		
24049F	CASE CARTS		20	VA	VA	No	No	No		
24061N	SINKS		2	VA	CC	Yes	No	No	11'-0" x 2'-6"	
24062N	SINKS		1	CC	CC	Yes	No	No	7'-6" x 2'-1"	
24063N	SINKS		1	Yes	CC	No	No	No	9'-1" x 2'-1"	
DESK1	CHIEF DESK		1	VA	VA	No	No	No		
DESK2	CHIEF DESK - RETURN		1	VA	VA	No	No	No		
DESK3	EDUCATOR DESK		1	VA	VA	No	No	No		
DESK6	EDUCATOR DESK		1	VA	VA	No	No	No		
FILE1	CHIEF FILE		1	VA	VA	No	No	No		
FILE3	EDUCATOR FILE		1	VA	VA	No	No	No		

1ST FLOOR

0' 4' 8' 16'

1/8" = 1'-0"

CONSULTANTS:

Project Title	STERILE PROCESSING SERVICE (SPS) SURGICAL SUITE EXPANSION, B34
---------------	---

Location	Robert J. Dole VA Medical Center 5500 E Kellogg, Wichita, KS
----------	--

Date	Checked	Drawn
10/31/2016	SS	CK

Project Number	589-754
----------------	---------

Drawing Number
A1000

Al-202

Office of
Construction
and Facilities
Management



GENERAL NOTES

1. PLANS ARE SCHEMATIC IN NATURE. LAYOUT IS BASED ON BEST AVAILABLE INFORMATION. CONTRACTOR SHALL FIELD VERIFY EXISTING CONDITIONS AND DIMENSIONS.
2. ALL CUTTING, PATCHING AND DEMOLITION WORK SHALL BE CLOSELY COORDINATED WITH THE EXISTING CONDITIONS AND THE REQUIRED NEW WORK. G.C. SHALL PATCH AND FINISH PENETRATIONS OF EXISTING SURFACES TO MATCH ADJACENT SURFACES.
3. FIELD VERIFY BEST ROUTING FOR NEW PIPING AND DUCTWORK. COORDINATE WITH EXISTING EQUIPMENT, PIPING AND DUCTWORK. NEW PIPING SHALL RISE AND DROP JOG OR OFFSET AS REQUIRED TO AVOID CONFLICTS. DUCTWORK SHALL TAKE PRECEDENCE OVER ALL PIPING, EXCEPT WHERE GRADE MUST BE MAINTAINED FOR DRAINAGE. ANY EXPENSES RISING FROM LACK OF COORDINATION SHALL BE MADE AT THE CONTRACTOR'S EXPENSE.
4. REFER TO ARCHITECTURAL SPECIFICATIONS AND PLANS FOR PHASING OF DEMOLITION AND NEW WORK. ADJACENT AREAS ARE 100% OCCUPIED AND CONTRACTOR SHALL WORK CLOSELY WITH OWNER TO SCHEDULE DEMOLITION AND CONSTRUCTION TO BE AS LEAST DISRUPTIVE AS POSSIBLE.
5. ALL WORK SHALL BE DONE AT NIGHT AND/OR WEEKENDS, OR AS DIRECTED BY THE GC.
6. PIPE LENGTH FROM RECIRCULATED HOT WATER MAIN TO LAVATORY HOT WATER STOP SHALL BE NO MORE THAN 18'-0".
7. PIPE LENGTH FROM COLD WATER MAIN TO WATER CLOSET FLUSH VALVE SHALL BE NO MORE THAN 18'-0".
8. COORDINATE COORDINATION OF DRAWINGS SHALL BE REQUIRED BY PARAGRAPH "SUBMITTAL" IN SPECIFICATION SECTION 220511. CONTRACTOR SHALL NOT START ON ANY SYSTEM UNTIL THE COORDINATION DRAWINGS HAVE BEEN APPROVED BY VA.

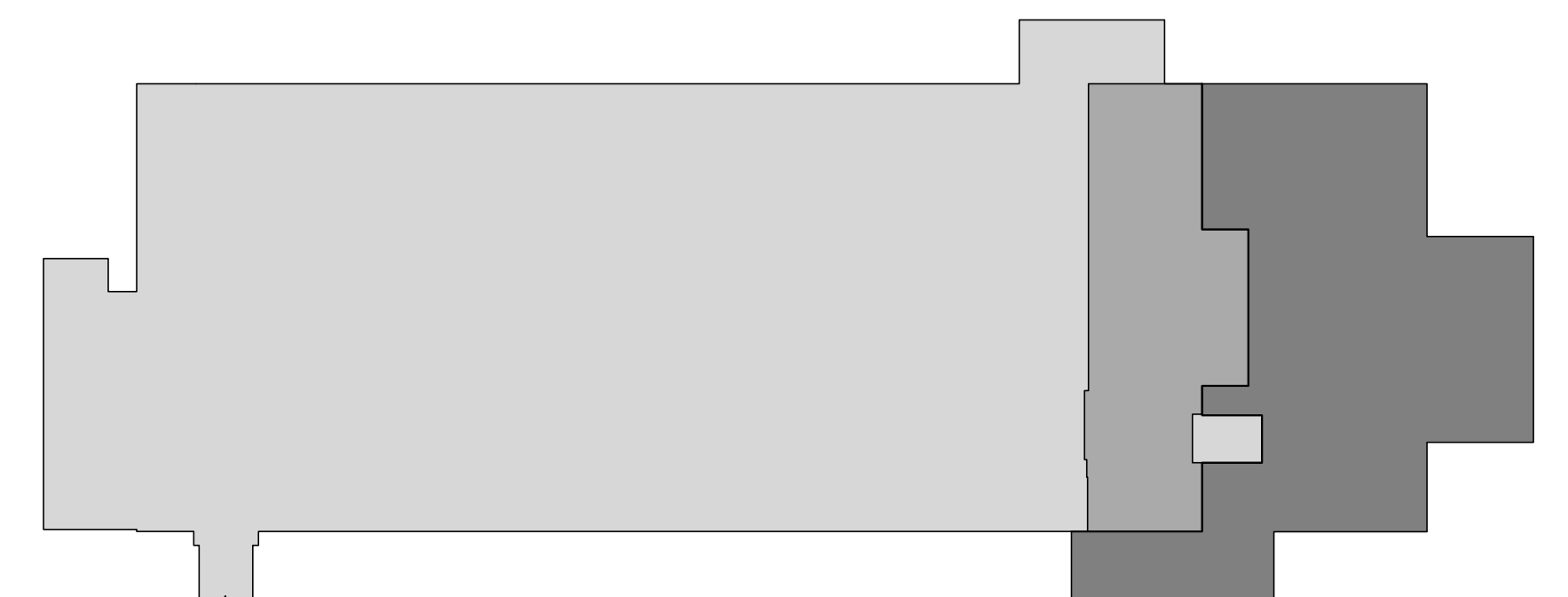
[illegible]

HFG | HEALTH
FACILITIES
GROUP
architecture



BID SET

Drawn
JML

Date of

 Department of
Veterans Affairs

