

three inches = one foot
one and one half inches = one foot
one inch = one foot
three quarters inch = one foot
one half inch = one foot
three eighths inch = one foot
one quarter inch = one foot
one eighth inch = one foot

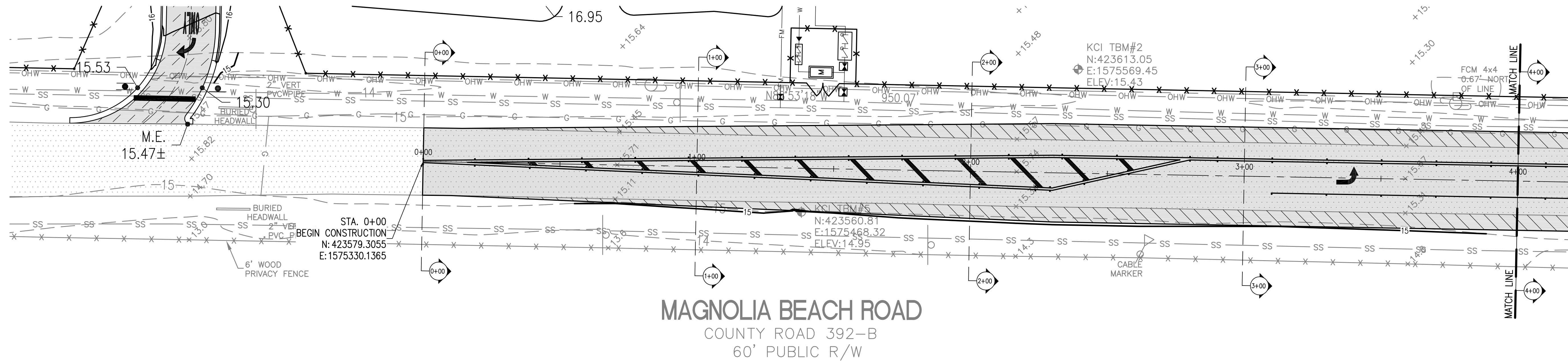

NOTES:
SEE SHEET CG111 FOR MAGNOLIA BEACH ROAD SECTIONS.

- LEGEND:**
- EXISTING SPOT ELEVATION
 - PROPOSED SPOT ELEV., (S) SIDEWALK (P) PAVEMENT
 - EXISTING CONTOUR
 - PROPOSED CONTOUR
 - STORM
 - NEW CLEAN-OUT
 - NEW FDOT TYPE "E" INLET (B2/CG501)
 - NEW FDOT TYPE "3" CURB INLET (E4/CG501)
 - NEW FDOT TYPE "4" CURB INLET (E4/CG501)
 - STORMWATER FLOW DIRECTION

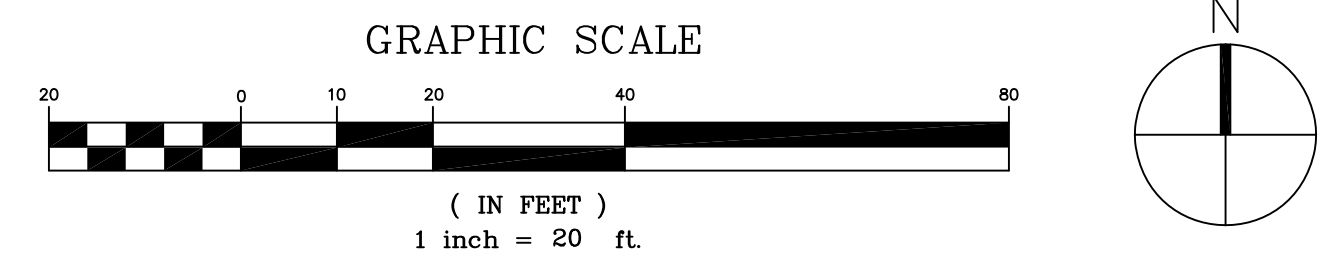
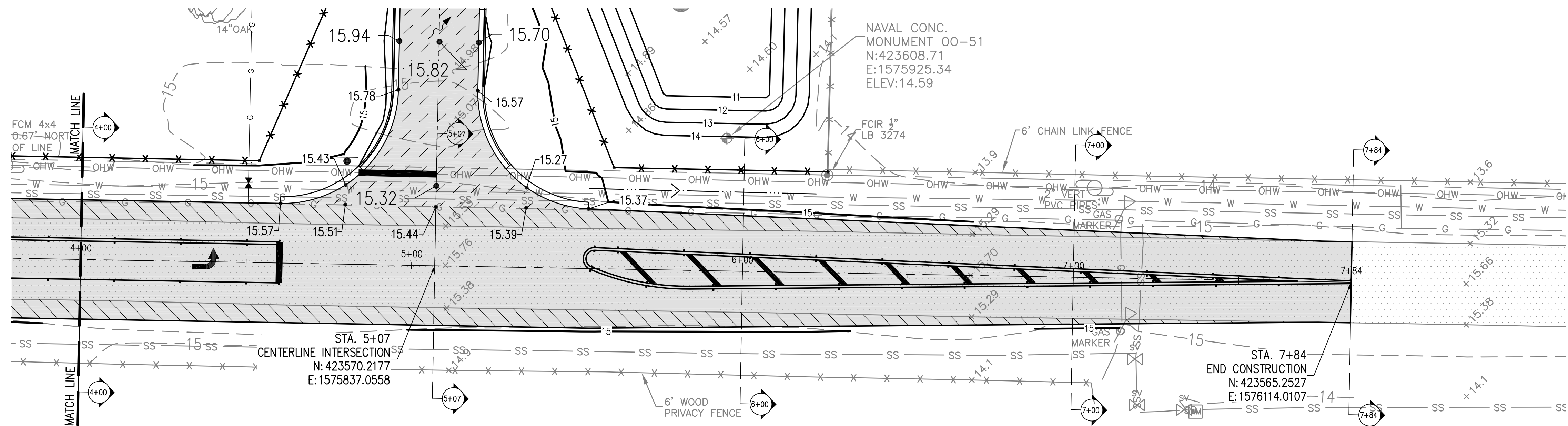

CONSULTANTS:		ARCHITECT/ENGINEERS:		Drawing Title MAGNOLIA BEACH ROAD GRADING PLAN		Project Title PANAMA CITY JOINT OUTPATIENT CLINIC VA GULF COAST HEALTH CARE		Project Number 520-326		Office of Construction and Facilities Management
CIVIL: KENNETH HORNE & ASSOCIATES 7201 NORTH 9TH AVENUE, STE. 6 PENSACOLA, FLORIDA 32504 PH: (850) 471-9008 FX: (850) 471-0093		COMMENTS: SCHMIDT CONSULTING GROUP, INC. 40 S. PALAFOX PLACE, STE. 300 PENSACOLA, FLORIDA 32502 PH: (850) 438-0050 FX: (850) 432-8651		SURVEYORS: KCI TECHNOLOGIES, INC. 10401 HIGHLAND MANOR DRIVE, SUITE 120 TAMPA, FLORIDA 33610 PH: (813) 740-2300		Approved Project Director		Building Number -		
LANDSCAPE ARCHITECT: CSA GROUP, INC. 6300 PICCADILLY SQUARE DRIVE MOBILE, ALABAMA 36609 PH: (251) 344-4233 FX: (251) 344-4052		ARCHITECTURE: BULLOCK TOE ASSOCIATES, INC. 809 EAST CERVANTES STREET PENSACOLA, FL 32501 PH: (850) 438-0444 FX: (850) 432-8208		BES DESIGN/BUILD 766 Middle St, Fairhope, AL 36532 Phone: 251.990.5778 Fax: 251.990.3716		Location PANAMA CITY, FLORIDA		Drawing Number CG110 Dwg. 19 of 21		
Revisions:		Date		State of Florida Professional Engineer Seal KHA FL. #8268		Date MARCH 2012		Checked KCH	Drawn LRR	