

A

B

C

D

E

F

D:_MAC2012\100409 AM 3/26/2012 10:04:09 AM
one eighth inch = one foot
one quarter inch = one foot
one half inch = one foot
one inch = one foot
three quarters inch = one foot
three eighths inch = one foot
one eighth inch = one foot
one quarter inch = one foot
one half inch = one foot
one inch = one foot
three quarters inch = one foot
three eighths inch = one foot
one eighth inch = one foot

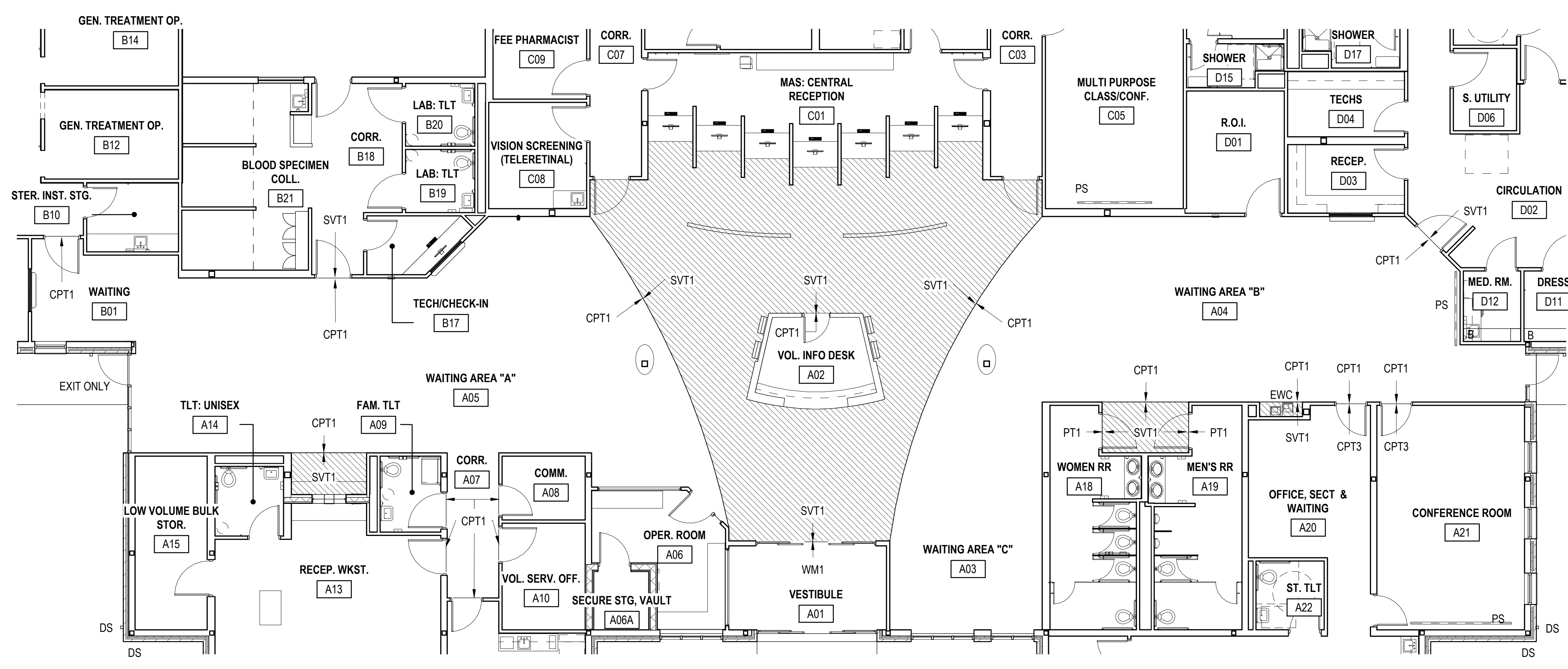

1 ENLARGED PLAN - LOBBY FLOOR FINISH PLAN
1/8" = 1'-0"

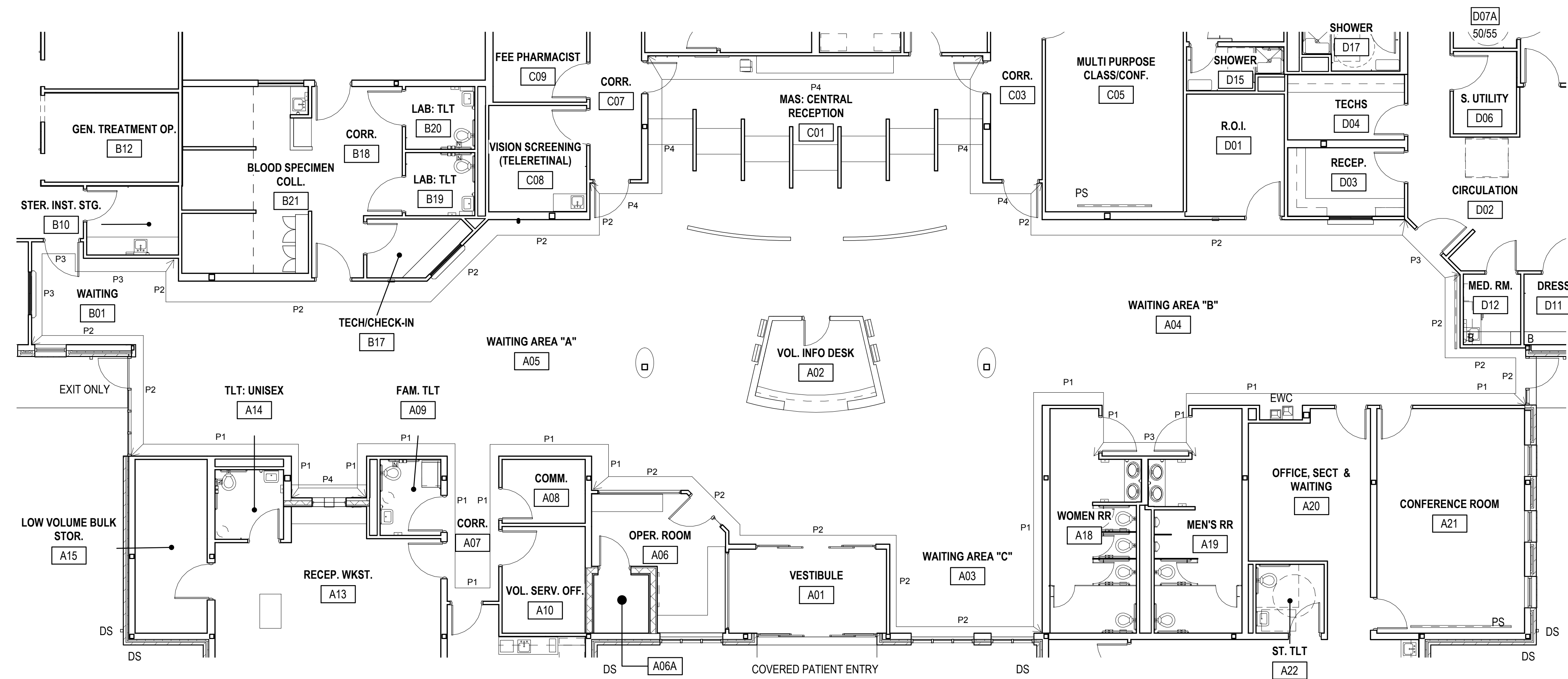

2 ENLARGED PLAN - LOBBY FINISH LOCATION PLAN
1/8" = 1'-0"

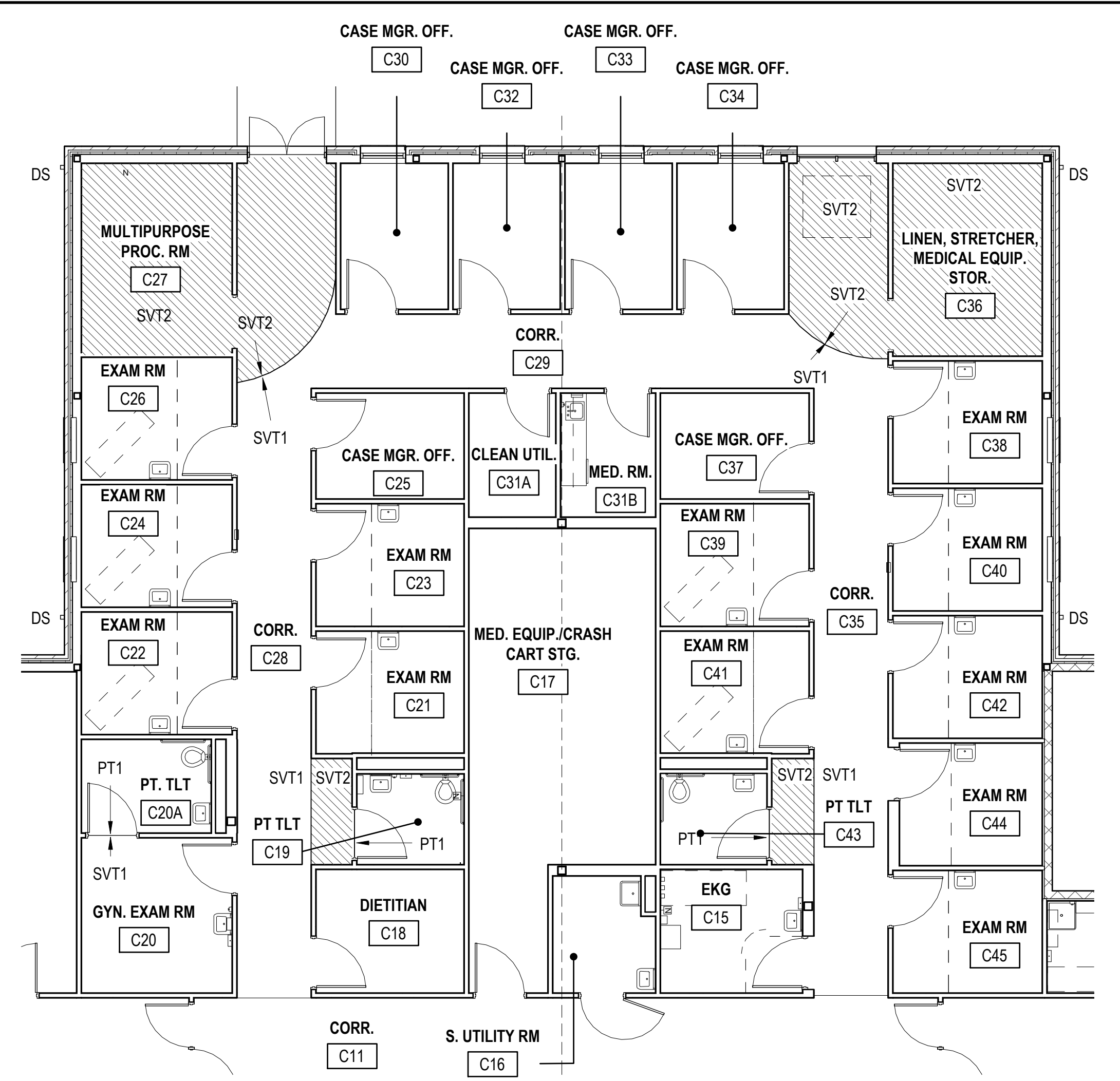

3 ENLARGED PLAN - AMBULATORY WING PLAN
1/8" = 1'-0"

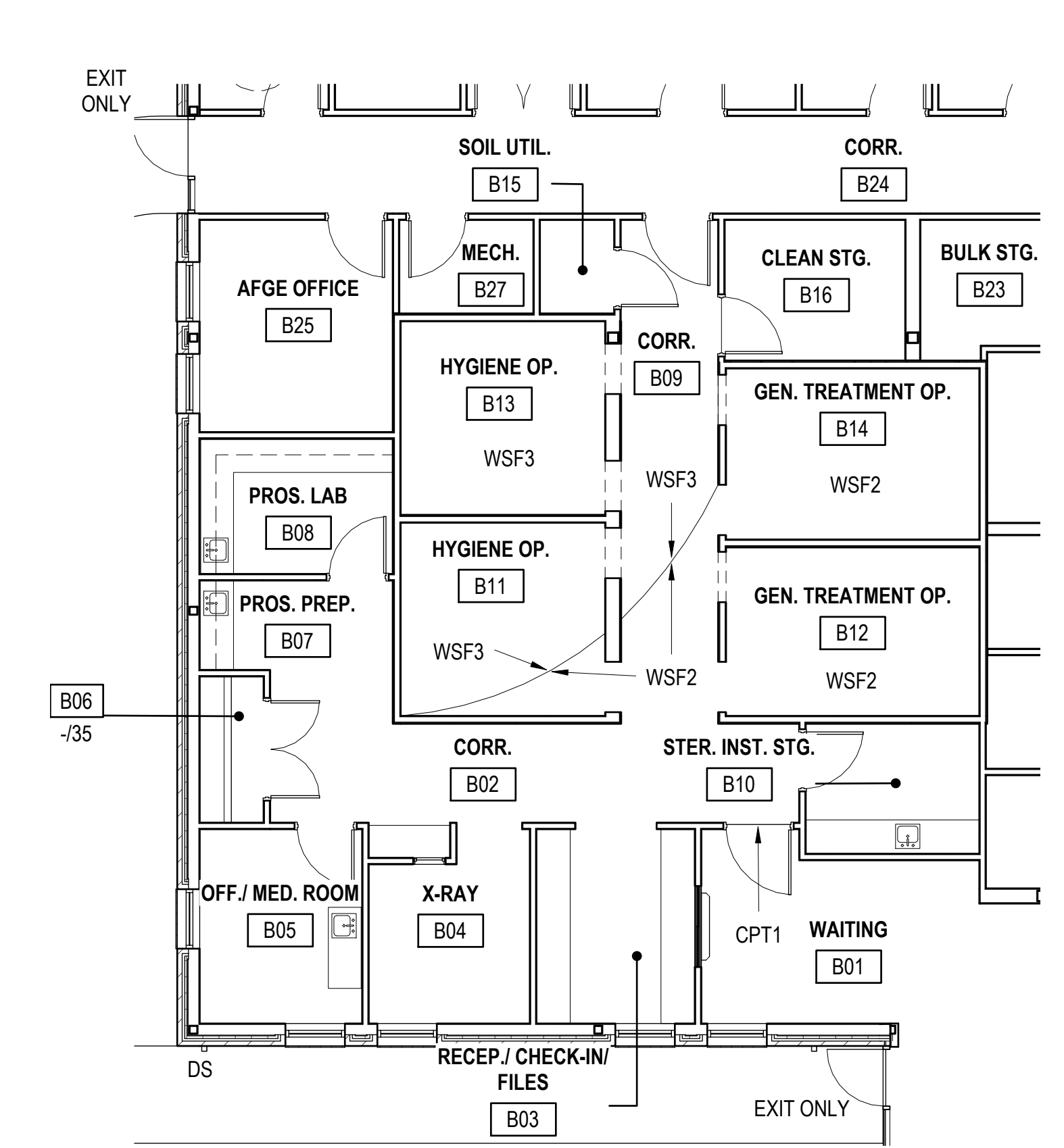

4 ENLARGED PLAN - DENTAL FLOOR FINISH PLAN
1/8" = 1'-0"

0 4' 8' 16'
SCALE: 1/8" = 1'-0"

CONSULTANTS:

CIVIL:
KENNETH HORNE & ASSOCIATES
7201 NORTH 9TH AVENUE, STE. 6
PENSACOLA, FLORIDA 32504
PH: (850) 471-9005
FX: (850) 471-0053

COMM/DES:
SCHMIDT CONSULTING GROUP, INC.
139 EAST GOVERNMENT STREET
PENSACOLA, FLORIDA 32202
PH: (850) 438-0050
FX: (850) 432-8611

LANDSCAPE ARCHITECT:
CSA GROUP, INC.
6300 PICCADILLY SQUARE DRIVE
MOBILE, ALABAMA 36689
PH: (251) 344-4023
FX: (251) 344-4052

ARCHITECTURE:
BULLOCK TICE ASSOCIATES, INC.
909 EAST CERVANTES STREET
PENSACOLA, FL. 32501
PH: (850) 434-5444
FX: (850) 432-8208

ARCHITECT/ENGINEERS:

BES DESIGN/BUILD, LLC
766 Middle St, Fairhope, AL 36532
Phone: 251.990.5778 Fax: 251.990.3716

Drawing Title FINISH PLANS	Project Title PANAMA CITY JOINT OUTPATIENT CLINIC VA GULF COAST HEALTH CARE	Project Number 520-326	Office of Construction and Facilities Management Department of Veterans Affairs
Approved: Project Director	Location PANAMA CITY, FLORIDA	Building Number -	
Date MARCH 2012	Checked BM	Drawn TWMF	
Dwg. 2 of 6		IS121	