

three inches = one foot

one and one half inches = one foot

one inch = one foot

three quarters inch = one foot

one half inch = one foot

three eighths inch = one foot

one quarter inch = one foot

one eighth inch = one foot

PANEL MPA
480/277VAC, 800A MCB
100% RATED
3-PHASE, 4-WIRE
NEMA 1, SURFACE

PANEL RPA
480/3
125A

PANEL RPB
480/3
70A

PANEL HPA
480/3
250A

X-RAY
480/3
SHUNT
200A

LIFT STATION
480/3
30A

DOCK LIFT
480/3
20A

CHILLER
480/3
125A

PANEL HPE
480/3
250A

GENERATOR
275KW, 0.8PF
480/277VAC
3PH/4W

GENERATOR CONTROL

REMOTE ANNUNCIATOR
PANEL
(LOBBY)

3-#1 AWG THHN &
1-#8 GND, 1-1/2"

3-#250KCMIL AWG THWN,
1-#250KCMIL AWG NEU &
1-#2 GND, 4"

3-#300KCMIL AWG THWN &
1-#4 GND, 4"

3-#250KCMIL AWG THWN,
1-#250KCMIL AWG NEU &
1-#2 GND, 4"

3-#8 AWG &
1-#8 GND, 1-1/4"

3-#10 AWG &
1-#10 GND, 3/4"

3-#1 AWG THHN &
1-#8 GND, 1-1/2"

3-#250KCMIL AWG THWN,
1-#250KCMIL AWG NEU &
1-#2 GND, 4"

3-#4/0 AWG THHN,
1-#4/0 AWG NEU &
1-#2 GND, 2-1/2"

6-#12 AWG THWN
CONTROL CONDUCTORS
1"PVC CONDUIT

XFMR TA
75KVA
480 PRI
208/120 SEC

XFMR TB
45KVA
480 PRI
208/120 SEC

3-#3/0 AWG THHN,
1-#3/0 AWG NEU &
1-#6 GND, 2"

3-#250KCMIL AWG THWN,
1-#250KCMIL AWG NEU &
1-#2 GND, 4"

PANEL RPA
208/3
200A

PANEL RPB
208/3
125A

PANEL RPA
208/120VAC, 200A
3-PHASE, 4-WIRE
NEMA 1, SURFACE

PANEL RPB
208/120VAC, 125A
3-PHASE, 4-WIRE
NEMA 1, SURFACE

PANEL HPA
480, 250A MLO
3-PHASE, 3-WIRE
NEMA 4X, SURFACE

COOLING TOWER
480/3
70A

P-1
480/3
20A

P-2
480/3
20A

P-3
480/3
20A

WSPR SKID
480/3
150A

SPARE
480/3
20A

SPARE
480/3
20A

3-#4 AWG THHN &
1-#8 GND, 1-1/2"

3-#12 AWG &
1-#12 GND, 3/4"

3-#12 AWG &
1-#12 GND, 3/4"

3-#12 AWG &
1-#12 GND, 3/4"

3-#1/0 AWG THWN &
1-#6 GND, 2-1/2"

PANEL HPE
480/277VAC, 250A MLO
100% RATED
3-PHASE, 4-WIRE
NEMA 1, SURFACE

PANEL RPE
20A
3P

PANEL RPC
50A
3P

PANEL LPE
60A
3P

AHU #1
30A
3P

AHU #2
30A
3P

ERV #1
20A
3P

ERV #2
20A
3P

CP-1
CIRC. PUMP
20A
3P

SPARE
20A
3P

SPARE
20A
3P

3-#4 AWG THHN &
1-#8 GND, 1-1/2"

3-#6 AWG THHN &
1-#8 GND, 1"

3-#6 AWG THHN,
1-#6 AWG NEU &
1-#8 GND, 1"

3-#10 AWG &
1-#10 GND, 3/4"

3-#10 AWG &
1-#10 GND, 3/4"

3-#12 AWG &
1-#12 GND, 3/4"

3-#12 AWG &
1-#12 GND, 3/4"

3-#12 AWG &
1-#12 GND, 3/4"

XFMR TE
45KVA
480 PRI
208/120 SEC

XFMR TC
30KVA
480 PRI
208/120 SEC

3-#1 AWG THHN,
1-#1 AWG NEU &
1-#8 GND, 1-1/2"

3-#3 AWG THHN,
1-#3 AWG NEU &
1-#8 GND, 1-1/2"

3-#10 AWG &
1-#10 GND, 3/4"

3-#10 AWG &
1-#10 GND, 3/4"

3-#12 AWG &
1-#12 GND, 3/4"

3-#12 AWG &
1-#12 GND, 3/4"

3-#12 AWG &
1-#12 GND, 3/4"

125A
3P

100A
3P

PANEL RPE
208/120VAC, 125A
3-PHASE, 4-WIRE
NEMA 1, SURFACE

PANEL RPC
208/120VAC, 100A
3-PHASE, 4-WIRE
NEMA 1, SURFACE

PANEL LPE
480/277VAC, 60A MLO
3-PHASE, 4-WIRE
NEMA 1, SURFACE

AHU #1

AHU #2

ERV #1

ERV #2

CP #1

CONSULTANTS:

CIVIL
KENNETH HORNE & ASSOCIATES
7201 NORTH 6TH AVENUE, STE. 6
PENSACOLA, FLORIDA 32504
PH: (850) 471-9005
FX: (850) 471-0068

COMM/DS-
SCHMIDT CONSULTING GROUP, INC.
40 S. PALMFOX PLACE, STE. 300
PENSACOLA, FLORIDA 32502
PH: (850) 438-0080
FX: (850) 432-8831

SURVEYORS
KGI TECHNOLOGIES, INC.
10401 HIGHLAND MANOR DRIVE, SUITE 100
TAMPA, FLORIDA 33610
PH: (813) 740-2500

LANDSCAPE ARCHITECT:
CSA GROUP, INC.
6800 PROGRESS SQUARE DRIVE
MOBILE, ALABAMA 36608
PH: (251) 344-4023
FX: (251) 344-4052

ARCHITECTURE:
BULLOCK TICE ASSOCIATES, INC.
609 EAST CERVANTES STREET
PENSACOLA, FL 32501
PH: (850) 454-9444
FX: (850) 432-9208

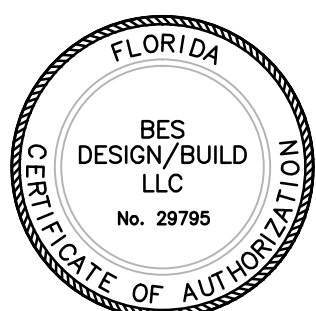

ARCHITECT/ENGINEERS:

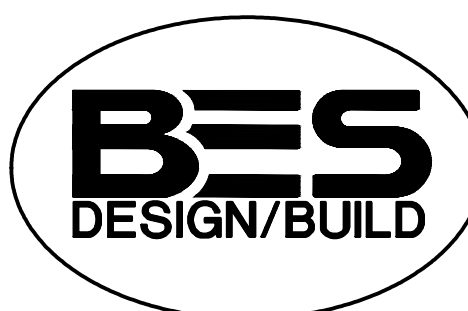

BES DESIGN/BUILD, LLC
766 Middle St. Fairhope, AL 36532
Phone: 251.990.5778 Fax: 251.990.3716

Drawing Title

ELECTRICAL ONE LINE DIAGRAM

Approved: Project Director

Project Title

PANAMA CITY
JOINT OUTPATIENT CLINIC
VA GULF COAST HEALTH CARE

Location

PANAMA CITY, FLORIDA

Date

MARCH 2012

Checked

-

Drawn

GWS

Project Number

520-326

Building Number

-

Drawing Number

EP601
Dwg 12 of 17

Office of
Construction
and Facilities
Management



Department of
Veterans Affairs

FINAL SUBMISSION