

SITE PLAN KEY NOTES

- 1 LIGHT-POLE MOUNTED PAN-TILT-ZOOM DOME CAMERA. SECURITY CONTRACTOR TO PROVIDE CAMERA AND CAMERA MOUNT AT TOP OF POLE. PROVIDE 28VAC CAMERA POWER SUPPLY AT POLE. COORDINATE WITH LIGHT POLE MANUFACTURER AND ELECTRICAL CONTRACTOR TO PROVIDE FACTORY-INSTALLED MOUNTS FOR CAMERA HOUSING AND CABLING. CAMERA AND CAMERA MOUNT SHALL COME PROVIDED WITH FACTORY WHITE POWDERCOAT FINISH. SEE SINGLE LINE FOR CABLING REQUIREMENTS.
- 2 1" UNDERGROUND PVC CONDUIT FROM POLE BASE FOR CAMERA CABLING, ROUTE TO NEAREST HANDHOLE. **POWER FOR CAMERAS SHALL BE RUN IN SEPARATE CONDUITS TO ESS ROOM.**
- 2A 1" UNDERGROUND PVC CONDUIT FROM POLE BASE FOR CAMERA CABLING, ROUTE THRU HANDHOLE SECURITY ENCLOSURE IN ESS. **POWER FOR CAMERAS SHALL BE RUN IN SEPARATE CONDUITS TO ESS ROOM.**
- 4 UNDERGROUND PVC CONDUIT (QTY AND SIZES AS INDICATED), SCHEDULE 40, RUN UNDERGROUND DIRECT BURIED. TYPICAL MINIMUM BURIAL DEPTH 48" BELOW FINISHED GRADE. PROVIDE CONTINUOUS WARNING TAPE OVER ALL BURIED CONDUIT AT 18" BELOW FINISH GRADE. INSTALL 3/8" MARKED PULL TAPE ALONG WITH REQUIRED CABLES.
- 5 SECURITY HANDHOLE. SEE DETAILS ON SHEET TN501. LABEL HANDHOLE "SECURITY". LOCATED ADJACENT TO TELECOMMUNICATIONS HANDHOLE.

UNITED STATES NAVY
PARCEL #31229-000-000
O.R. BOOK 47 PG 141

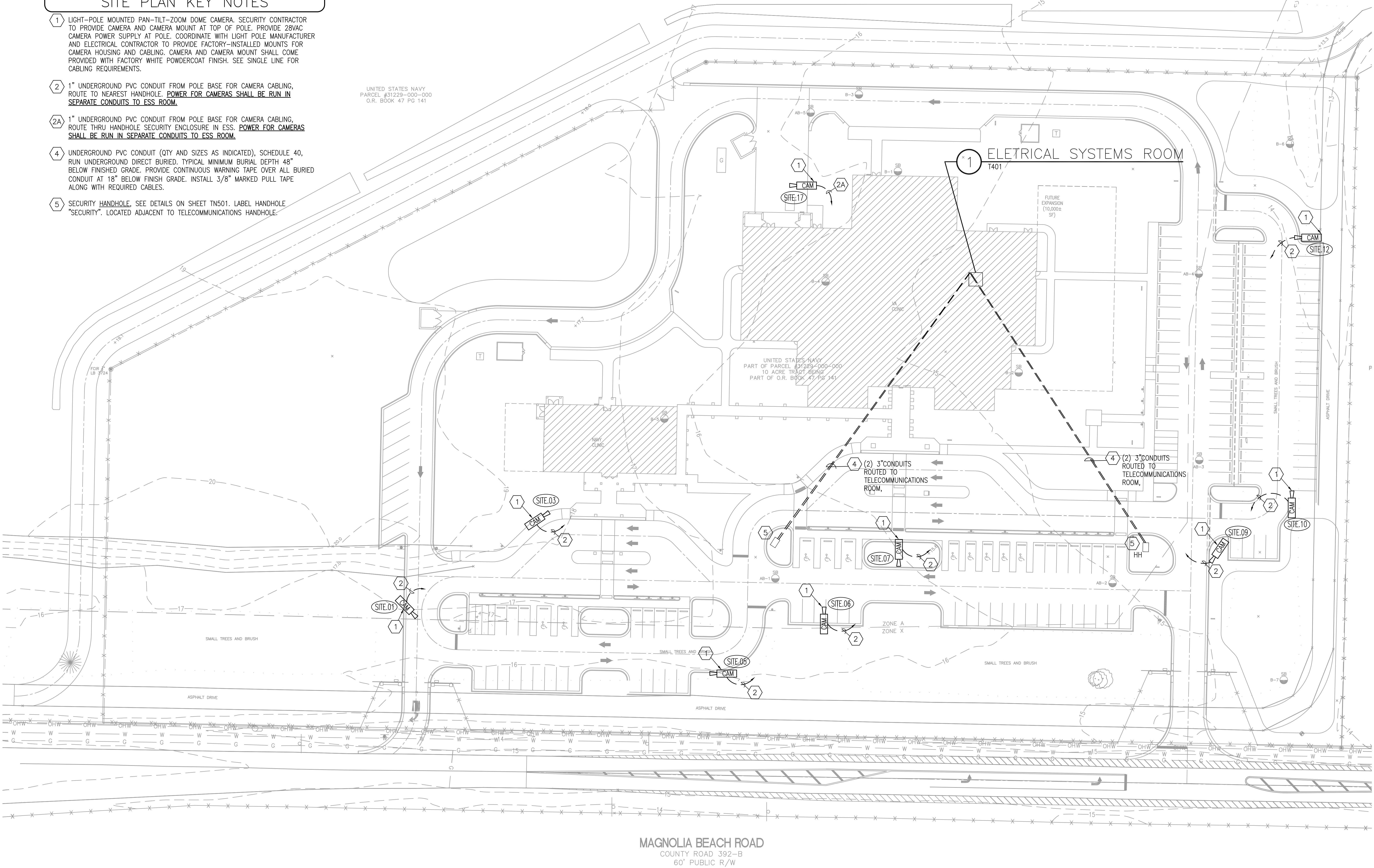

MAGNOLIA BEACH ROAD
COUNTY ROAD 392-B
60' PUBLIC R/W

1 SECURITY SITE PLAN
30' 0' 30' 60'
SCALE: 1"=30'-0"

CONSULTANTS:

CIVIL:
KENNETH HORNE & ASSOCIATES
7201 NORTH 9TH AVENUE
PENSACOLA, FLORIDA 32504
PH: (850) 471-9005
FX: (850) 471-0093

COMM/DS:
SCHMIDT CONSULTING GROUP, INC.
40 S. PALADINO PLACE, STE. 300
PENSACOLA, FLORIDA 32502
PH: (850) 438-6050
FX: (850) 432-9631

SURVEYORS:
KGI TECHNOLOGIES, INC.
10401 HIGHLAND MANOR DRIVE, SUITE 120
TAMPA, FLORIDA 33610
PH: (813) 740-2300

ARCHITECTURE:
BULLOCK TICE ASSOCIATES, INC.
909 EAST CERVANTES STREET
PENSACOLA, FL 32201
PH: (850) 434-5444
FX: (850) 432-5208

ARCHITECT/ENGINEERS:



BES DESIGN/BUILD, LLC
766 Middle St, Fairhope, AL 36532
Phone: 251.990.5778 Fax:
251.990.3716

Drawing Title

SECURITY SITE PLAN

Approved Project Director

Project Title

PANAMA CITY
JOINT OUTPATIENT CLINIC
VA GULF COAST HEALTH CARE

Location

PANAMA CITY, FLORIDA

Date

MARCH 2012

Checked

TAN

Drawn

CEC

Project Number

520-326

Building Number

-

Drawing Number

TY101

Dwg 2 of 7

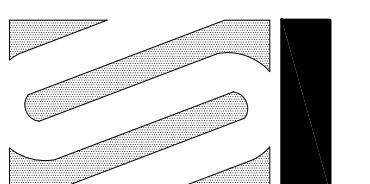

SCHMIDT
CONSULTING GROUP, INC.

FLORIDA LICENSE NUMBER 05371
40 S. PALADINO PL. Ste. 300 - Pensacola, FL 32502
P: (850) 438-6050 F: (850) 432-9631
10000 HIGHLAND MANOR P.E.
FLORIDA LICENSE NUMBER 04882
SCG project 2011-146

Office of
Construction
and Facilities
Management

Department of
Veterans Affairs