

**VA** U.S. Department  
of Veterans  
Affairs



**LEO A DALY**

VA CBOC Ann Arbor

U.S. Department of  
Veterans Affairs

PROJECT NO. 36C10F18N3258  
07/03/2018  
FINAL SUBMISSION

SHEET INDEX	
GENERAL	
GI-001	COVER SHEET
A-101	OVERALL FLOOR PLAN - ABOA SUMMARY
A-102	OVERALL PLAN
A-103	ENLARGED FLOOR PLAN - AREA A
A-104	ENLARGED FLOOR PLAN - AREA B
A-105	ENLARGED FLOOR PLAN - AREA C
A-106	ENLARGED FLOOR PLAN - AREA D

PLANNING  
ARCHITECTURE  
ENGINEERING  
INTERIORS

EST. 1915  
ABU DHABI  
ATLANTA  
AUSTIN  
CHICAGO  
COLLEGE STATION  
CORPUS CHRISTI  
DALLAS  
FLINT  
FORT WORTH  
HOUSTON  
LAN - MONTGOMERY COUNTY  
LANSING  
LAREDO  
LAS VEGAS  
LOS ANGELES  
MIAMI  
MIDWEST  
MILPITAS  
MINNEAPOLIS  
NORMAN  
OMAHA  
ORANGE  
SACRAMENTO  
SAN ANTONIO  
SAN MARCOS  
TAMPA  
WACO  
WASHINGTON, DC  
WEST PALM BEACH

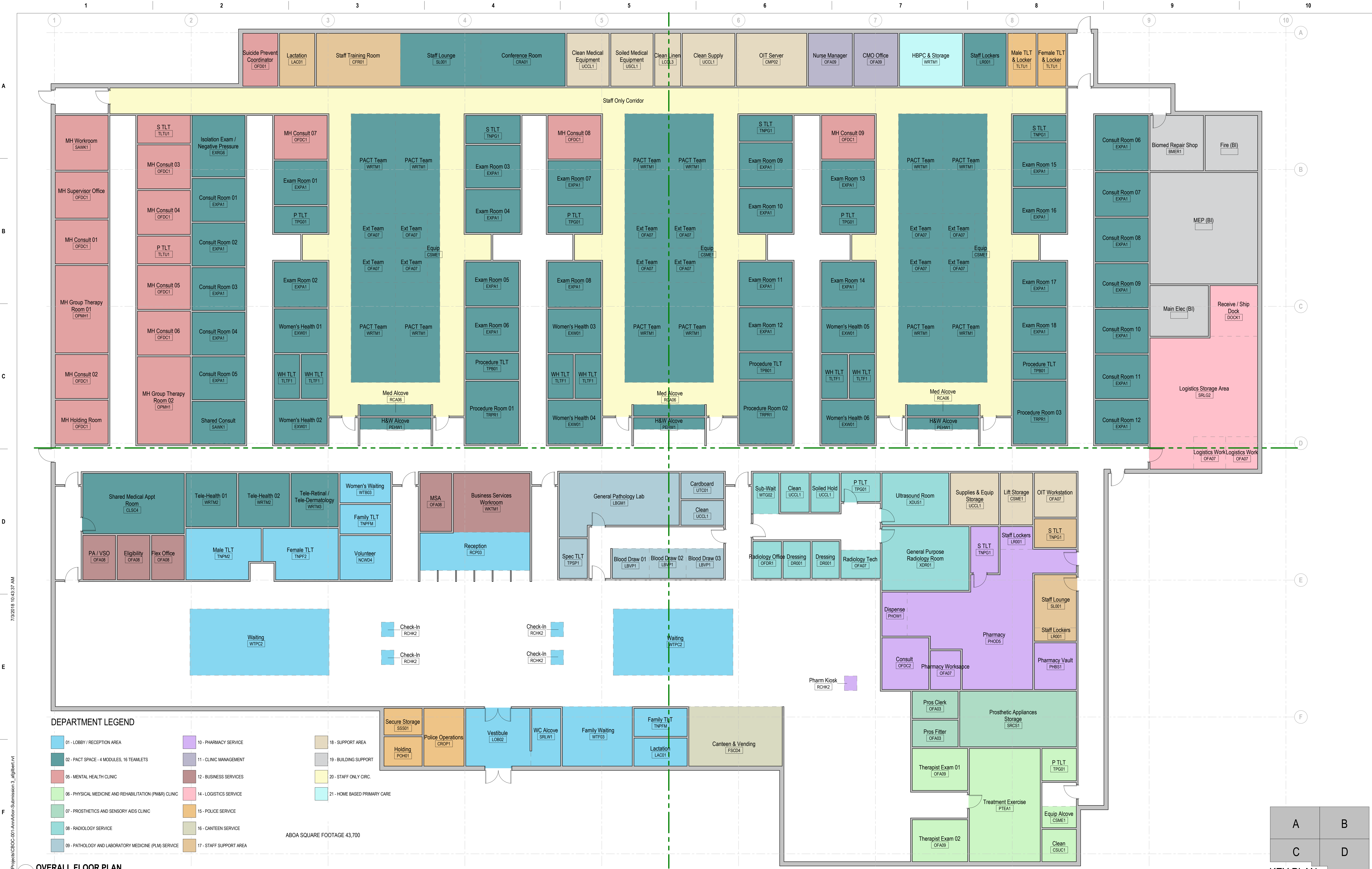

<b>CONSULTANT</b> LEO A DALY 730 2nd Ave. South #1100 Minneapolis, MN 55402 (612) 338-8741 <b>LEO A DALY</b>		<b>ARCHITECT/ENGINEER OF RECORD</b> F F E Inc Engineering and Technical Services 420 Springfield Pike Wyoming, OH 45215 513-522-0956 <b>F F E Inc</b> Engineering and Technical Services		<b>STAMP</b>	<b>Engineering and Facilities Management Services</b> <b>VA</b> U.S. Department of Veterans Affairs	<b>Drawing Title</b> OVERALL PLAN <b>Approved:</b>	<b>Phase</b> FINAL SUBMISSION TBD SPRINKLERED	<b>Project Title</b> ANN ARBOR, MI CBOC <b>Location</b> ANN ARBOR, MI <b>Issue Date</b> 07/03/2018 <b>Checked</b> DJA <b>Drawn</b> AFG	<b>Project Number</b> 36C10F18N3258 <b>Building Number</b> C.B.O.C <b>Drawing Number</b> A-102
---	--	---	--	--------------	--	--	---	---	---

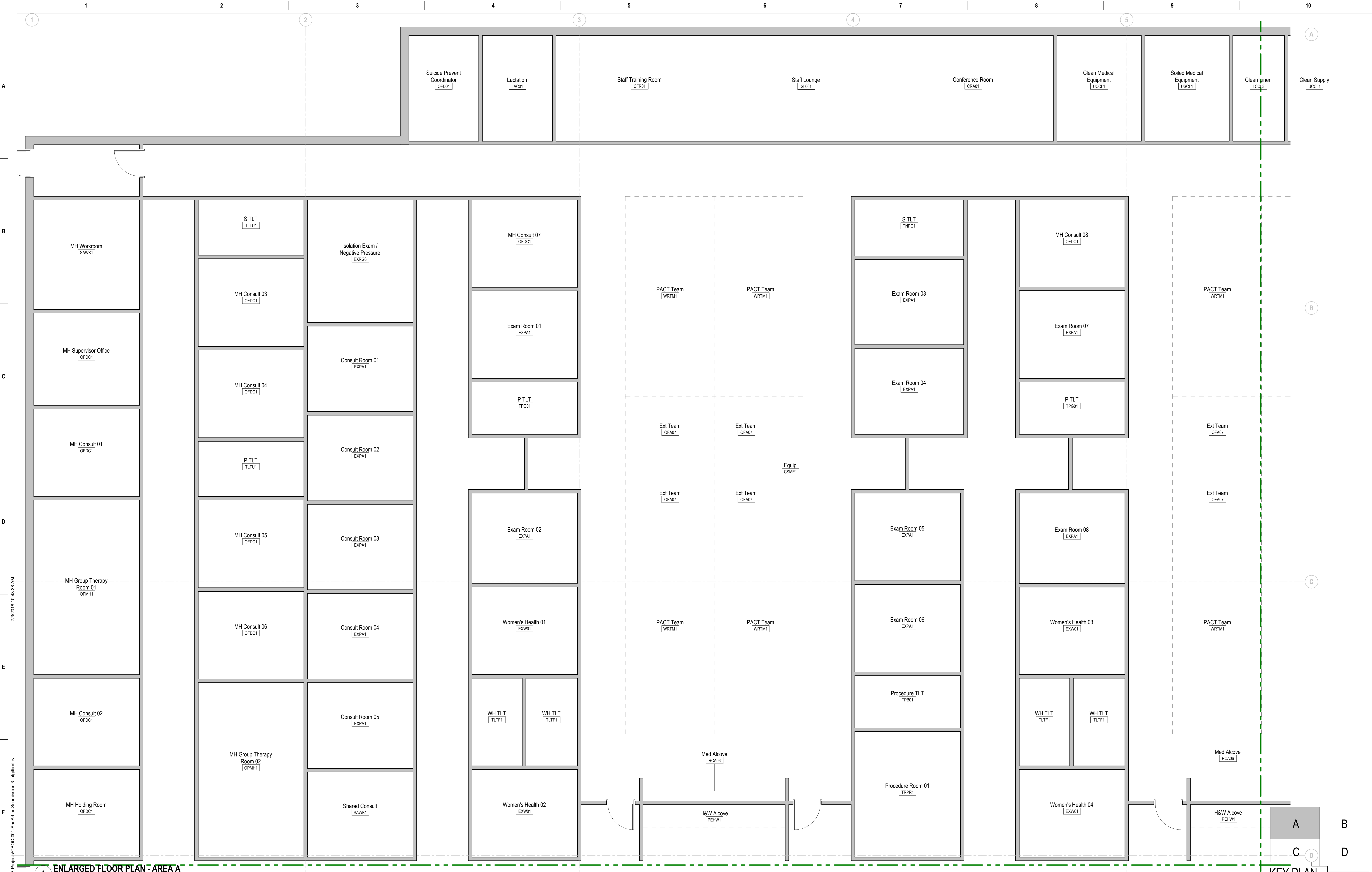

1 ENLARGED FLOOR PLAN - AREA A  
SCALE: 1/4" = 1'-0"

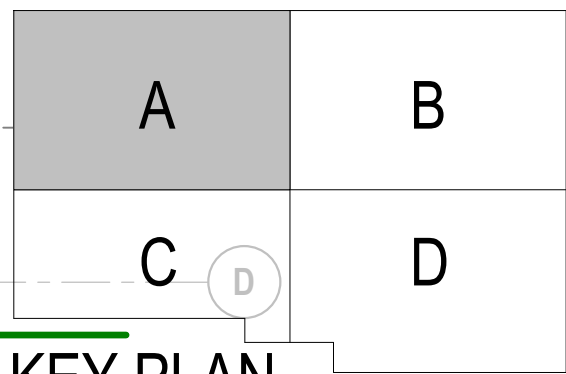

<div>Revisions:</div> <div>Date:</div>		<div>CONSULTANT</div> <div>LEO A DALY 730 2nd Ave. South #1100 Minneapolis, MN 55402 (612) 338-8741</div> <div>LEO A DALY</div>	<div>ARCHITECT/ENGINEER OF RECORD</div> <div>FFE Inc Engineering and Technical Services 420 Springfield Pike Wyoming, OH 45215 513-522-0956</div> <div>FFE Inc Engineering and Technical Services</div>	<div>STAMP</div>	<div>Engineering and Facilities Management Services</div> <div>VA U.S. Department of Veterans Affairs</div>	<div>Drawing Title</div> <div>ENLARGED FLOOR PLAN - AREA A</div> <div>Approved:</div>	<div>Phase</div> <div>FINAL SUBMISSION</div> <div>TBD SPRINKLERED</div>	<div>Project Title</div> <div>ANN ARBOR, MI CBOC</div> <div>Location</div> <div>ANN ARBOR, MI</div> <div>Issue Date</div> <div>07/03/2018</div> <div>Checked</div> <div>DJA</div> <div>Drawn</div> <div>AFG</div>	<div>Project Number</div> <div>36C10F18N3258</div> <div>Building Number</div> <div>C.B.O.C</div> <div>Drawing Number</div> <div>A-103</div>
--	--	---	---	------------------	---	---	---	---	---





1 ENLARGED FLOOR PLAN - AREA B

SCALE: 1/4" = 1'-0"

KEY PLAN

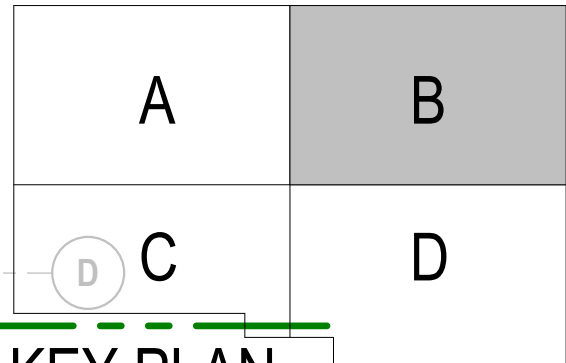

C:\Users\jgiblen\Documents\AutoCAD\Rev 2018 Projects\CBDC-101 Ann Arbor Submission 3\_14\sheet1.rvt 7/26/2018 10:43:39 AM

Revisions:	Date:

CONSULTANT

LEO A DALY  
730 2nd Ave. South #1100  
Minneapolis, MN 55402  
(612) 338-8741

LEO A DALY

ARCHITECT/ENGINEER OF RECORD

FFE Inc  
Engineering and Technical Services  
420 Springfield Pike  
Wyoming, OH 45215  
513-522-0956

FFE Inc  
Engineering and Technical Services

STAMP

Engineering  
and Facilities  
Management  
Services

VA U.S. Department  
of Veterans  
Affairs

Drawing Title

ENLARGED FLOOR PLAN - AREA B

Approved:

Phase

FINAL SUBMISSION

TBD SPRINKLERED

Project Title

ANN ARBOR, MI CBOC

Location

ANN ARBOR, MI

Issue Date

07/03/2018

Checked

DJA

Drawn

AFG

Project Number

36C10F18N3258

Building Number

C.B.O.C

Drawing Number

A-104

## KEY PLAN

