

— MILL ASPHALT

COMPACTED  
SUB-GRADE MIN 12"  
R-VALUE >50. 95%  
MIN COMPACTION

CONTRACTOR CANNOT OBTAIN THE DESIRE  
COMPACTION TO DUE TO EXISTING  
CONDITIONS THEN CLSM CAN BE USED AS A  
BACKFILL WITH NO ADDITIONAL COST TO THE  
GOVERNMENT.

## ASPHALT MILLING/PAVING DETAIL

## ADJUSTMENT OF MANHOLE TO GRADE

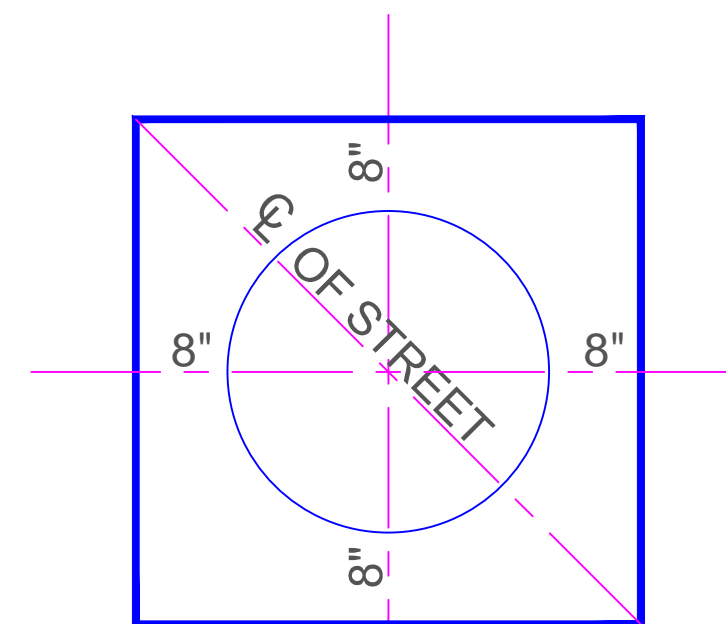

### PLAN VIEW OF MANHOLE

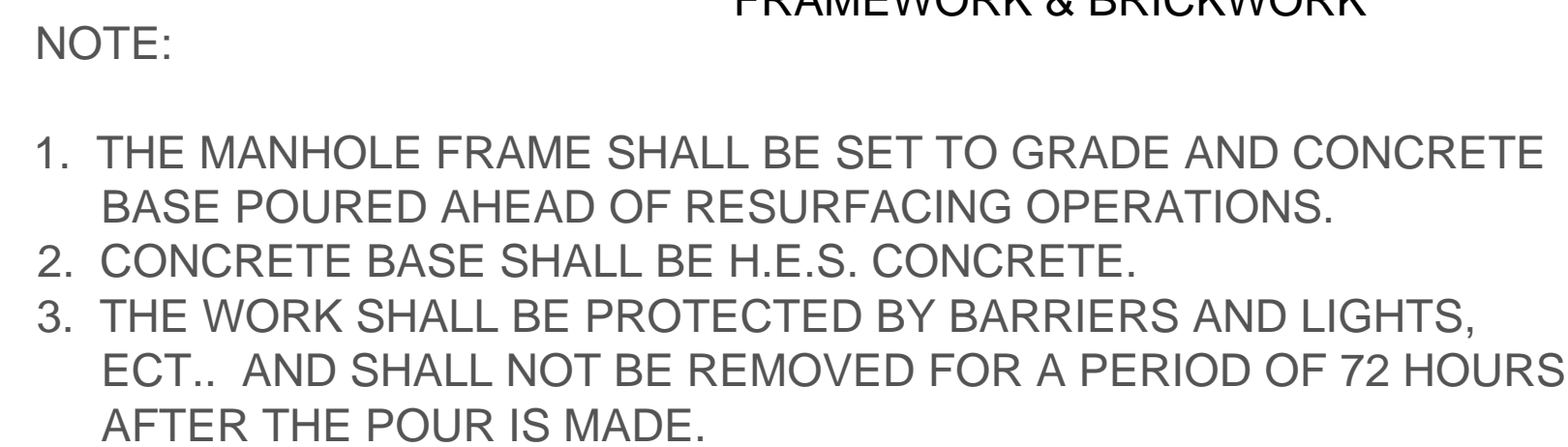

### ADJUSTMENT OF VALVE BOX TO GRADE

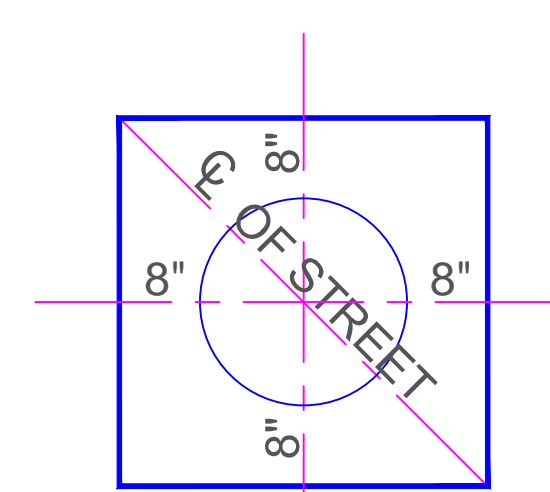

### PLAN VIEW OF VALVE BOX

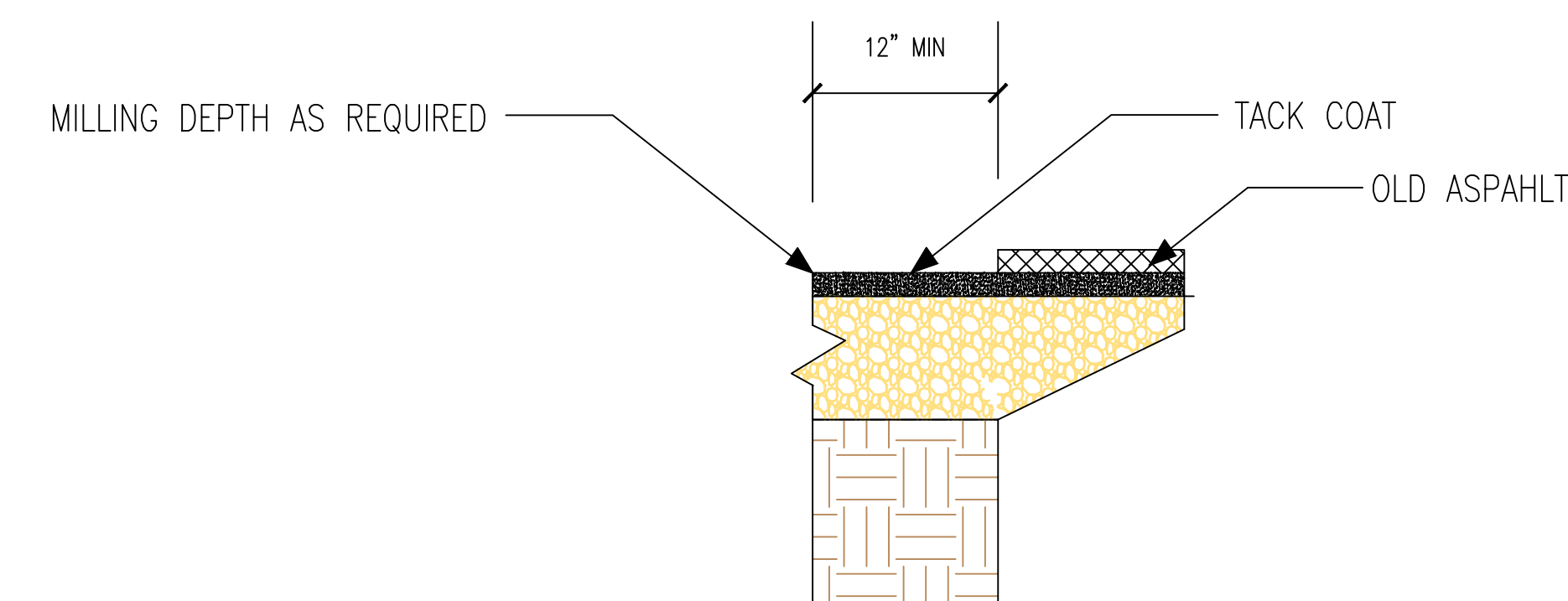
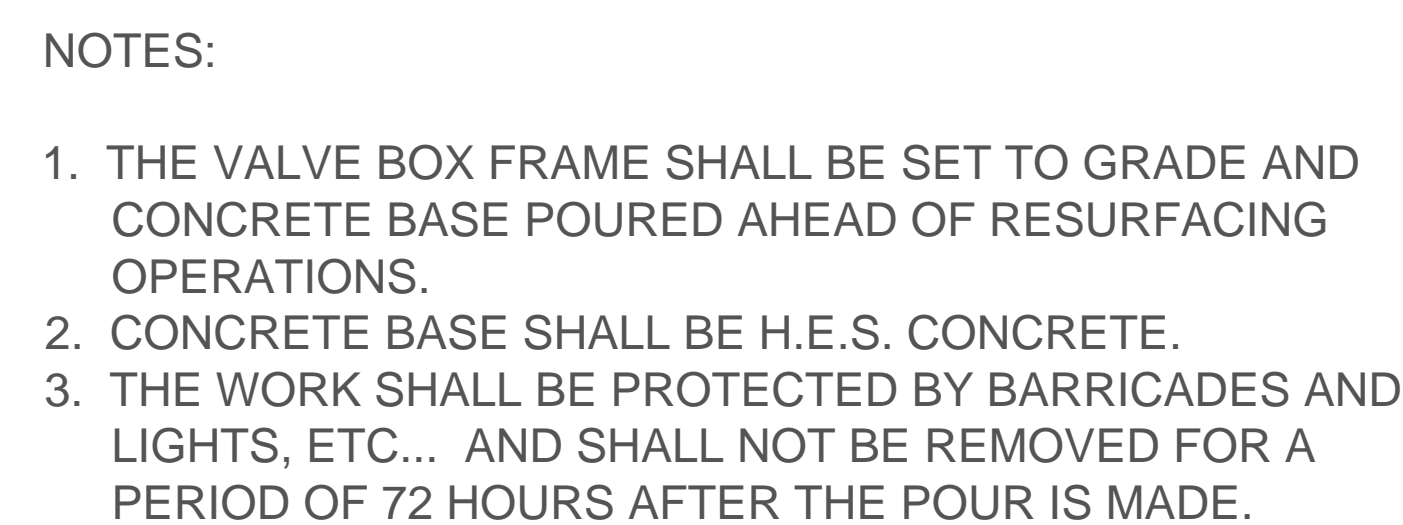

OLD/NEW ASPHALT CONNECTION DETAIL

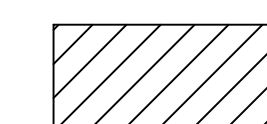

AREA FOR NEW PAVEMENT-

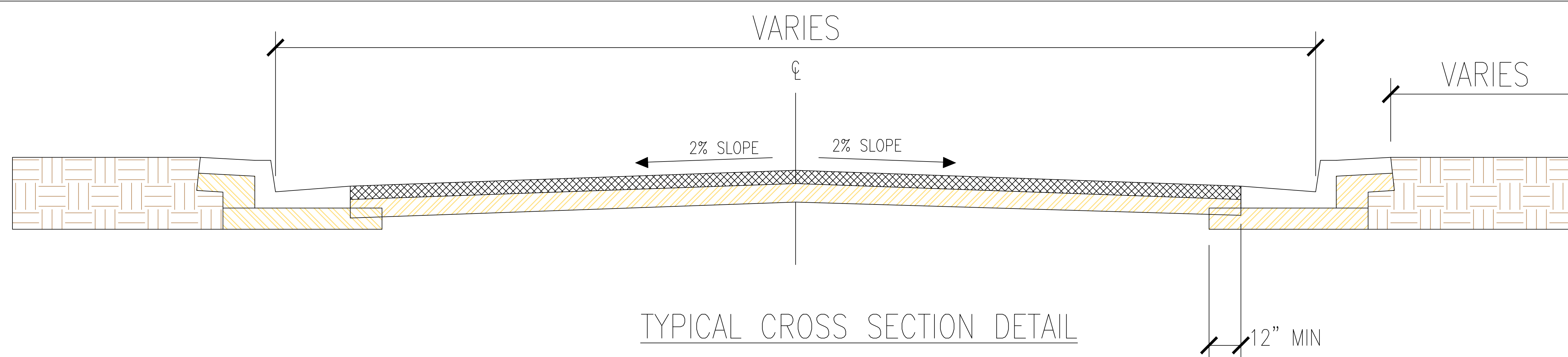
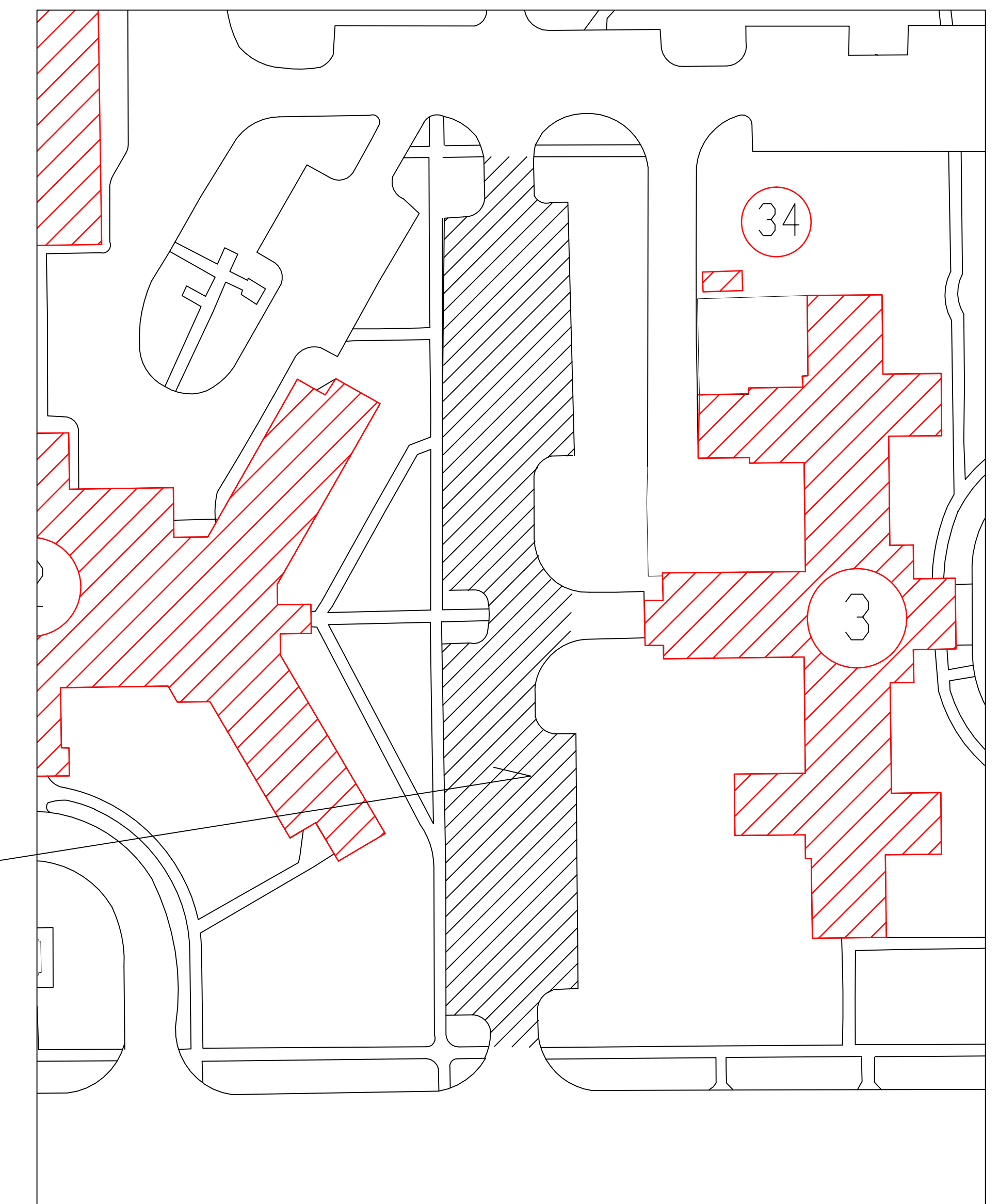

TYPICAL CROSS SECTION DETAIL

ALL EXISTING ASPHALT TO BE CUT WITH A SAW.  
ALL CUTS SHALL BE STRAIGHT AND AS PER DETAILS OR RECOMMENDATION OF COR.  
ANY ASPHALT CUT NOT USING A SAW SUCH AS THE USE OF HEAVY EQUIPMENT SHALL  
BE REJECTED AND ADDITIONAL CUT SHALL BE MADE TO ENSURE THAT A SOLID  
CONNECTION IS MADE BETWEEN NEW AND OLD ASPHALT AT NO COST TO THE  
GOVERNMENT.  
ALL ELEVATIONS TO BE VERIFY BY LAND SURVEYOR SUCH AS M.H., VALVE COVERS,  
CROWN OF ROAD, AND STORM DRAINAGE TO ENSURE PAVING AS PER DETAILS.  
CONTRACTOR TO SUBMIT A WORK PLAN SHOWING ORDER OF OPERATION FOR ENSURING  
WORK AS PER DETAILS AND COORDINATION WITH VAMC SALISBURY AS TO MIN.  
DISRUPTION OF HOSPITAL OPERATIONS.  
A FINAL AS-BUILT OF ALL PAVED AREAS SHALL BE SUBMITTED TO GOVERNMENT.

[illegible]

RECOMMEND APPROVAL			
REQUESTER	Date		
CHIEF OF SERVICE	Date	CHIEF OF STAFF	Date
ASSOC. DIR. PATIENT CARE SVC.	Date	ASSOC. DIR. for OPERATIONS	Date
APPROVAL BY: MEDICAL CENTER DIRECTOR			Date

	Drawing Title
e	ASPHALT PAVING & REPAIRS DETAILS
e	Approved: Safety Manager/M&O Supervisor
e	Approved: Chief of Facilities Management Sv

	Project Title		
	REPLACE DOMESTIC WATER PIPING-NORTH LOOP		
	Building Number CAMPUS	Checked	Drawn BLF
r.	Location W.C.(Bill) Hefner Medical Center 1601 Brenner Ave. Salisbury NC 28144		

Date	29 JUNE 2012
Project No.	659-12-253
DRAWING NO.	C-102
DWG. 7 OF 8	



Veterans Affairs