

RCP SYMBOL LEGEND	
	ACOUSTICAL TILE CEILING (24X24)
	ACOUSTICAL TILE CEILING (24X48)
	GYPSUM CEILING - PAINTED
	RECESSED OR SURFACE MOUNTED FLUORESCENT LIGHT FIXTURE
	RECESSED OR SURFACE MOUNTED FLUORESCENT LIGHT FIXTURE
	RECESSED OR SURFACE MOUNTED ROUND DOWNLIGHT LUMINAIRE
	RECESSED OR SURFACE MOUNTED SQUARE DOWNLIGHT LUMINAIRE
	STRIP ON TURRET FLUORESCENT LUMINAIRE, SURFACE MOUNTED
	STRIP ON TURRET FLUORESCENT LUMINAIRE, PENDANT MOUNTED
	LINEAR FLUORESCENT LUMINAIRE, PENDANT MOUNTED
	LINEAR FLUORESCENT LUMINAIRE, WALL MOUNTED
	CHANDIELER, PENDANT MOUNTED
	CHANDIELER, PENDANT MOUNTED
	SMOKE DETECTOR
	HEAT DETECTOR
	BREAKER
	EXIT LIGHT
	HVAC SUPPLY DIFFUSER
	HVAC RETURN DIFFUSER
	HVAC EXHAUST DIFFUSER
	RADIANT HEAT PANEL

GENERAL NOTES

- CONTRACTOR TO COORDINATE WITH ROOF INSTALLATION WARRANTY REQUIREMENTS FOR ANY MODIFICATIONS TO ROOFING TO ENSURE NO VIOLATIONS OCCUR OF THE WARRANTY. CONTRACTOR TO OBTAIN A CERTIFIED ROOFING INSPECTOR BEFORE THE REQUIREMENTS OF THE INSTALLED ROOF. ALL WARRANTY VIOLATIONS WILL BE REQUIRED TO BE CORRECTED PRIOR TO THE END OF ROOFING WORK. PROVIDE ALL PIPING PENETRATIONS OF FIRE, SMOKE AND FULL HEIGHT WALLS SHALL BE CALLED OUT TO THE ADJACENT STRUCTURE BY MEANS OF ALL APPROVED FIRE PROOF CALLING MATERIAL. SEE MECHANICAL AND PLUMBING DRAWINGS FOR ADDITIONAL INFORMATION.
- CONTRACTOR SHALL COORDINATE ALL PIPING, PLUMBING, AND CONDUIT RIGGING WITH STRUCTURAL, MECHANICAL, AND ELECTRICAL SYSTEMS AND SHALL PROVIDE NECESSARY OFFSETS TO AVOID CONFLICTS AND TO MAINTAIN REQUIRED EQUIPMENT ACCESS AND BECOMING AVAILABLE.
- EXISTING CONDITIONS ARE BASED ON EXISTING PLANS AND FIELD VERIFICATION WHERE FEASIBLE. ACTUAL CONDITIONS MAY DIFFER FROM THOSE INDICATED. CONTRACTOR TO FIELD VERIFY IN ADVANCE THE LOCATION AND CONDITION OF THOSE EXISTING SYSTEMS SHOWN TO BE MODIFIED OR REMOVED. CONTRACTOR TO NOTIFY ARCHITECT SHOULD CONDITIONS BE FOUND TO DIFFER SIGNIFICANTLY FROM CONSTRUCTION DOCUMENTS.
- CONTRACTOR TO COORDINATE ALL NEW EQUIPMENT LOCATION WITH ALL TRADES PRIOR TO INSTALLATION.
- CONTRACTOR TO PROVIDE GALVANIC PROTECTION AS REQUIRED AT CONNECTIONS BETWEEN ALL DISSIMILAR METALS.
- ANY FLOOR, WALL, OR CEILING CUTTING OR FILLING THAT IS REQUIRED TO COMPLETE THIS PROJECT, THE CONTRACTOR SHALL PATCH AND PAINT AND RETURN TO MATCH EXISTING CONDITION AND FINISHES.
- CONTRACTOR TO PROVIDE BULDOZING ON ALL NEW EXPOSED EXTERIOR PIPE, PENETRATIONS AND SEAL COMPLETELY.
- ANY LANDSCAPE, HARDSCAPE, FUTURE, SIGNAGE AND SYSTEMS OR PEDESTRIAN CONTROL DEVICES WITHIN THE TEMPORARY ACCESSIBLE PATHWAY SHALL BE PROTECTED IN PLACE OR TEMPORARILY RELOCATED AS NECESSARY FOR CONTINUED UNINTERRUPTED OPERATION, ACCESS, MAINTENANCE AND/OR VISIBILITY.

DEMOLITION KEYNOTES

- REMOVE EXISTING OFFICER'S REGISTERS. RETAIN EXISTING OUTLOOK FOR NETWORK.
- REMOVE EXISTING LUMINAIRE.
- REMOVE EXISTING LUMINAIRE.
- REMOVE EXISTING LUMINAIRE.
- REMOVE EXISTING LUMINAIRE.

KEYNOTES

- NEW LUMINAIRE BY CLEANER.
- NEW 2' X 4' FPM FILT UNIT BY CLEANER. LOCATION TO BE DETERMINED BY CLEANER.
- NEW SOLAR SYSTEM BY CLEANER.
- EXISTING EXHAUST HOOD DUCT TO BE REPLACED FOR NEW BIOSAFETY CABINET. SEE A-701 FOR HOOD SPECIFICATIONS.
- NEW PARTITIONS BY CLEANER.
- NEW LOW WALL EXHAUST BY CLEANER. INTEGRATED INTO PREFABRICATED CLEAN ROOM SYSTEM. CONNECTION TO NEW EXHAUST SYSTEM WITH VENTUR VALVE FLOW CONTROL. SEE MECHANICAL SHEETS.

Revisions:	Date:

CONSULTANT

ARCHITECT/ENGINEER OF RECORD

A/E
Triple C - The A/E Group
4401 Atlantic Avenue, Suite 200
Long Beach, CA 90807
(562) 452-7175
Mal Perkins
A MULTI-DISCIPLINE COMPANY

STAMP



Office of
Construction and
Facilities
Management
VA U.S. Department
of Veterans Affairs

Drawing Title
ARCHITECTURAL REFLECTED
CEILING PLANS - NINTH FLOOR
(ROOM E904)

Phase
100% CONSTRUCTION
DOCUMENTS
FULLY SPRINKLERED

Project Title
Clean Room Site Prep AE Design
Location
5901 E 7TH ST, LONG BEACH, CA 90822
Issue Date
06/28/2018
Checked
M. PERKINS
Drawn
K. LUKE
Project Number
800-18-200
Building Number
B126
Drawing Number
AC101



EXISTING ROOF EXHAUST FAN TO BE REPLACED

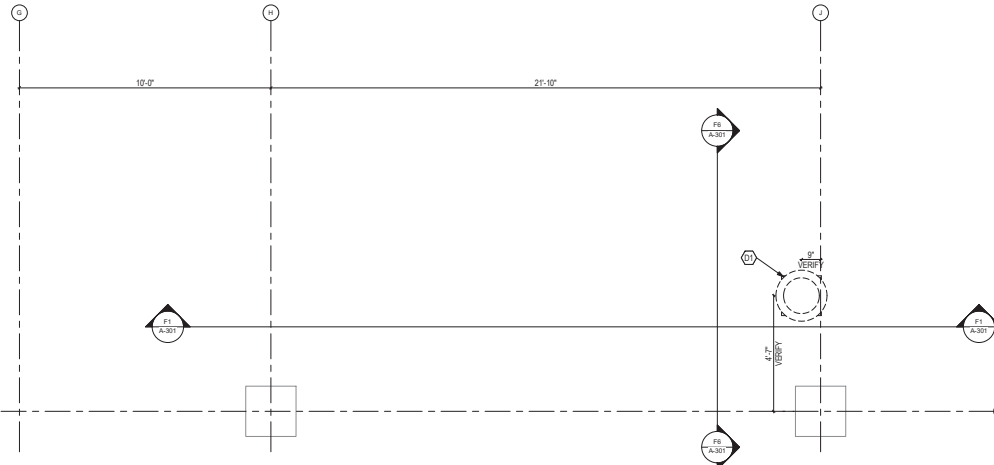

1 ARCHITECTURAL ROOF PLAN - DEMOLITION
1/2" = 1'-0"

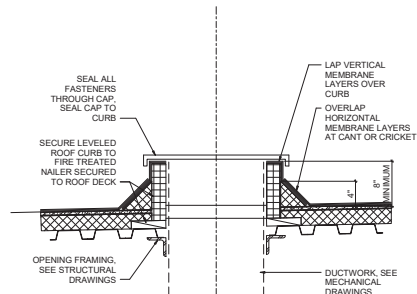

3 ROOF CURB DETAIL
1 1/2" = 1'-0"

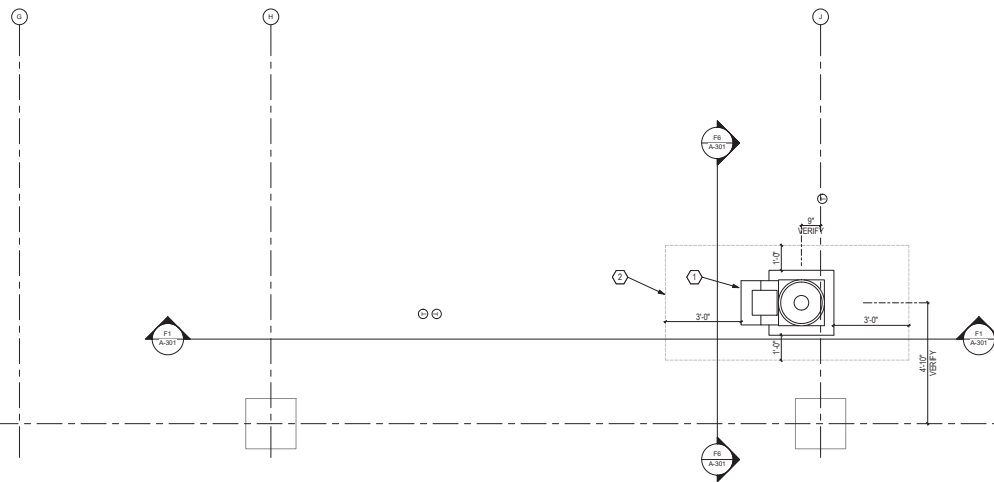

2 ARCHITECTURAL ROOF PLAN - NEW
1/2" = 1'-0"

GENERAL NOTES

- CONTRACTOR TO COORDINATE WITH ROOF INSTALLATION WARRANTY REQUIREMENTS FOR ANY MODIFICATIONS TO ROOFING TO ENSURE NO VIOLATIONS OCCUR OF THE WARRANTY. CONTRACTOR TO EMPLOY A CERTIFIED ROOFING INSPECTOR MEETING THE REQUIREMENTS OF THE INSTALLED ROOF. ALL WARRANTY VIOLATIONS WILL BE REQUIRED TO BE CORRECTED PRIOR TO CLOSE OUT ROOF AND/OR ROOFING IMPACTED BY WORK INCLUDE E.G.
- CONTRACTOR TO VALIDATE AND VERIFY ALL FIRE RATED AND/OR SMOKE RATED WALLS AND ASSEMBLIES INDICATED ON PLANS IN WORK AREA. PROVIDE ALL PILING PENETRATIONS OF FIRE SMOKE AND FULL HEIGHT WALLS SHALL BE CALLED OUT TO THE ADJACENT STRUCTURE BY MEANS OF ALL APPROVED FIRE PROOF CALLING MATERIAL. SEE MECHANICAL AND PLUMBING DRAWINGS FOR ADDITIONAL INFORMATION.
- CONTRACTOR SHALL COORDINATE ALL PIPING, PLUMBING, AND CONDUIT PIPING WITH STRUCTURAL, MECHANICAL, AND ELECTRICAL SYSTEMS AND SHALL PROVIDE NECESSARY OFFSETS TO AVOID CONFLICTS AND TO MAINTAIN REQUIRED EQUIPMENT ACCESS AND SERVICEABILITY.
- EXISTING CONDITIONS ARE BASED ON EXISTING PLANS AND FIELD VERIFICATION WHERE FEASIBLE. ACTUAL CONDITIONS MAY DIFFER FROM THOSE INDICATED. CONTRACTOR TO FIELD VERIFY IN ADVANCE THE LOCATION AND CONDITION OF THOSE EXISTING SYSTEMS SHOWN TO BE MOVED OR REMOVED. CONTRACTOR TO NOTIFY ARCHITECT SHOULD CONDITIONS BE FOUND TO DIFFER SIGNIFICANTLY FROM CONSTRUCTION DOCUMENTS.
- CONTRACTOR TO COORDINATE ALL NEW EQUIPMENT LOCATION WITH ALL TRADES PRIOR TO INSTALLATION.
- CONTRACTOR TO PROVIDE GALVANIC PROTECTION AS REQUIRED AT CONNECTIONS BETWEEN ALL DISSIMILAR METALS.
- ANY FLOOR, WALL, OR CEILING CUTTING OR FILLING THAT IS REQUIRED TO COMPLETE THIS PROJECT, THE CONTRACTOR SHALL PATCH AND PAINT AND RETURN TO MATCH EXISTING CONDITIONS TO FINISH.
- CONTRACTOR TO PROVIDE BOOTLATCHING ON ALL NEW EXPOSED EXTERIOR PIPE PENETRATIONS AND SEAL COMPLETELY.
- CONTRACTOR TO PROVIDE TEMPORARY FLOORING WHILE MOODING SUB-FLOORING. ANY LANDSCAPE, HARDSCAPE, FUTURE, SIGNAGE, AND SYSTEMS OR PEDESTRIAN CONTROL DEVICES WITHIN THE TEMPORARY ACCESSIBLE PATHWAY SHALL BE PROTECTED IN PLACE OR TEMPORARILY RELOCATED AS NECESSARY FOR CONTINUED UNINTERRUPTED OPERATION, ACCESS, MAINTENANCE AND/OR VISIBILITY.

DEMOLITION KEYNOTES

- EXISTING ROOF TOP EXHAUST FAN TO BE REMOVED AND REPLACED. EXISTING CURB TO BE REMOVED AND EXISTING OPENING TO BE REDUCED TO FIT NEW REC-1. SEE M.B. FOR DIMENSIONS.

KEYNOTES

- NEW ROOF TOP EXHAUST FAN. SEE MECHANICAL SHEETS FOR DETAILS. SEE ARCHITECTURAL ROOF CURB DETAIL, THIS SHEET.
- EXHAUST FAN MINIMUM SERVICE CLEARANCE.

03/20/2018 4:58:34 PM

7/1/2018

06/28/2018 03:55:37 C:\Users\Nelson\OneDrive\AE Design\0628-03-05_Clean Room_Site Prep AE Design.dwg User: Nelson, Eric, 7/1/2018

VA FORM 08 - 6231

Revisions:	Date:

CONSULTANT

ARCHITECT/ENGINEER OF RECORD

AE:
Triple C - The A/E Group
4401 Atlantic Avenue, Suite 200
Long Beach, CA 90807
(562) 452-7175
Mal Perkins



STAMP

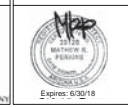

Office of Construction and Facilities Management



Drawing Title

ARCHITECTURAL ROOF PLANS

Approved:

Phase

100% CONSTRUCTION DOCUMENTS

FULLY SPRINKLERED

Project Title

Clean Room Site Prep AE Design

Location
5901 E 7TH ST, LONG BEACH, CA 90822

Issue Date
06/28/2018

Checked

Drawn

Project Number

800-18-200

Building Number
B126

Drawing Number
A-111



- [illegible]

KEYNOTES

- | | |
|---|--|
| 1 | NEW CHEMO HOOD: STEIRLGAARD4M |
| 2 | NEW EXHAUST HOOD: WITH INLINE MEDIUM PRESSURE VENTURI VALVE WITH SHUT-OFF. TO BE PROVIDED FOR NEW USP HOD CONNECTED TO ROOM EXHAUST. SEE MECHANICAL SHEETS FOR ADDITIONAL INFORMATION. |
| 3 | NEW EXHAUST FAN/FLUE EJECTOR: COMPLETELY SUPPORTED BY ROOF CURB. RATED FOR 125 WING. SEE MECHANICAL SHEETS FOR EQUIPMENT AND INSTALLATION INFORMATION. |
| 4 | NEW MEDIUM PRESSURE VENTURI VALVE WITH INTEGRATED REHEAT. SEE MECHANICAL SHEETS FOR ADDITIONAL INFORMATION. |
| 5 | NEW ROOF CURB TO SUPPORT EXHAUST FAN/EJECTOR. |
| 6 | HANDS FREE STAINLESS STEEL SINK WITH SOAP DISPENSER. MPOR, EAGLE, MODEL: HSA-10-FA-P. EYE WASH |
| 7 | SWING DOOR WITH AUTOMATIC OPERATOR BY CLEANAIR |
| 8 | NEW PARTITIONS BY CLEANAIR. COORDINATE REQUIREMENTS |
| 9 | EXISTING FINE PARTICULATE FILTERED TO ACCOMMODATE NEW ROOF CURB. SEE MECHANICAL SHEETS FOR DIMENSIONS |

F1 BUILDING LONGITUDINAL SECTION (ROOM E904)
1/8" = 1'-0"

F6 BUILDING TRANSVERSE SECTION (ROOM E904)
1/2" = 1'-0"

CONSULTANT

ARCHITECT/ENGINEER OF RECORD

A/E:
Triple C - The A/E Group
4401 Atlantic Avenue, Suite 200
Long Beach, CA 90807
(562) 452-7175
Mat Perkins



STAMP



Office of
Construction
and Facilities
Management

 U.S. Department
of Veterans Affairs

Drawing Title
ARCHITECTURAL SECTIONS -
BUILDING

Approved:

Phase	100% CONSTRUCTION DOCUMENTS
-------	-----------------------------

FULLY SPRINKLERED

Project Title	Clean Room Site Prep AE Design
---------------	--------------------------------

Clean Room Site Prep AE Design

Location	5901 E 7TH ST. LONG BEACH, CA 90822
----------	-------------------------------------

Issue Date

Checked

Project Number	600-18-200
----------------	------------

Building Number
B126

	Drawing Number

A-301

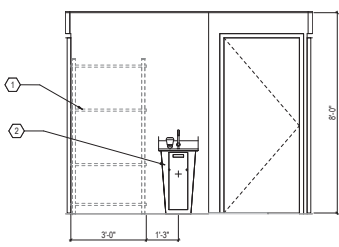

B1 ANTE ROOM - NORTH ELEVATION
1/2" = 1'-0"

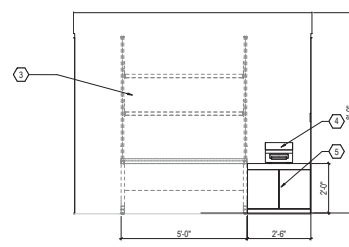

B3 ANTE ROOM - SOUTH ELEVATION
1/2" = 1'-0"

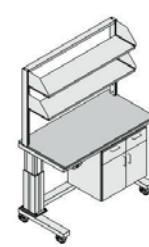

Order cantilevered shelving units, suspended wall and base cabinets separately

EXAMPLES OF HEIGHT ADJUSTABLE UNIT AND OPTIONS THAT CAN BE ADDED.
OWNER TO VERIFY FINAL CONFIGURATION, COLOR/ FINISHES AND PART NUMBERS WITH MANUFACTURER

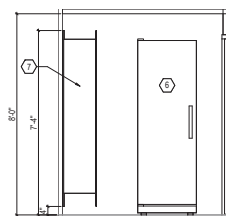

D1 HAZARDOUS STORAGE - NORTH ELEVATION
1/2" = 1'-0"

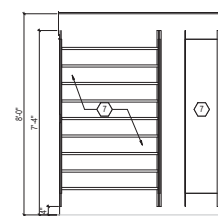

D3 HAZARDOUS STORAGE - SOUTH ELEVATION
1/2" = 1'-0"

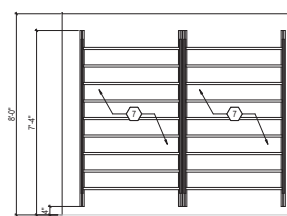

D5 HAZARDOUS STORAGE - WEST ELEVATION
1/2" = 1'-0"

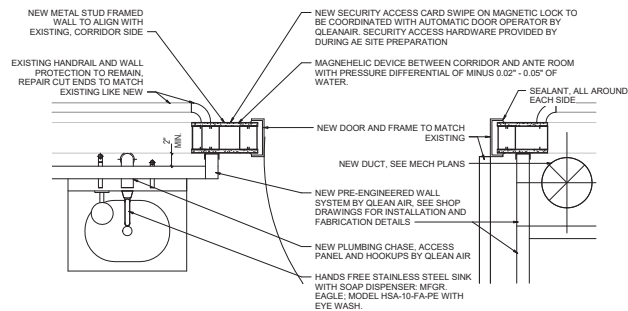

F5 PLAN DETAIL AT NEW DOOR FRAME
1 1/2" = 1'-0"

GENERAL NOTES

- CONTRACTOR TO COORDINATE WITH ROOF INSTALLATION WARRANTY REQUIREMENTS FOR ANY MODIFICATIONS TO ROOFING TO ENSURE NO VIOLATIONS OCCUR OF THE WARRANTY. CONTRACTOR TO EMPLOY A CERTIFIED ROOFING INSPECTOR MEETING THE REQUIREMENTS OF THE INSTALLED ROOF. ALL WARRANTY VIOLATIONS WILL BE REQUIRED TO BE CORRECTED PRIOR TO CLOSE OUT ROOF AND/OR ROOFING IMPACTED BY WORK INCLUDE E.G.:
- CONTRACTOR TO VALIDATE AND VERIFY ALL FIRE RATED ANCHOR SMOKE RATED WALLS AND ASSEMBLIES INSTALLED ON-PIES IN WORK AREA. PROVIDE ALL PIPING PENETRATIONS OF FIRE SMOKE AND FULL HEIGHT WALLS SHALL BE CALLED AIRTIGHT TO THE ADJACENT STRUCTURE BY MEANS OF ALL APPROVED FIRE PROOF SEALING MATERIAL. SEE MECHANICAL AND PLUMBING DRAWINGS FOR ADDITIONAL INFORMATION.
- CONTRACTOR SHALL COORDINATE ALL PIPING, PLUMBING, AND CONDUIT PIPING WITH STRUCTURAL, MECHANICAL, AND ELECTRICAL SYSTEMS AND SHALL PROVIDE NECESSARY OFFSETS TO AVOID CONFLICTS AND TO MAINTAIN REQUIRED EQUIPMENT ACCESS AND SERVICEABILITY.
- EXISTING CONDITIONS ARE BASED ON EXISTING PLANS AND FIELD VERIFICATION WHERE FORMER ACTUAL CONDITIONS MAY DIFFER FROM THOSE INDICATED. CONTRACTOR TO FIELD VERIFY IN ADVANCE THE LOCATION AND CONDITION OF THOSE EXISTING SYSTEMS SHOWN TO BE MODIFIED OR REMOVED. CONTRACTOR TO NOTIFY ARCHITECT SHOULD CONDITIONS BE FOUND TO DIFFER SIGNIFICANTLY FROM CONSTRUCTION DOCUMENTS.
- CONTRACTOR TO COORDINATE ALL NEW EQUIPMENT LOCATION WITH ALL TRADES PRIOR TO INSTALLATION.
- CONTRACTOR TO PROVIDE GALVANIC PROTECTION AS REQUIRED AT CONNECTIONS BETWEEN ALL DISSIMILAR METALS.
- ANY FLOOR, WALL, OR CEILING CUTTING OR FILLING THAT IS REQUIRED TO COMPLETE THIS PROJECT, THE CONTRACTOR SHALL PATCH AND PAINT AND RETURN TO MATCH EXISTING CONDITIONS AND FINISHES.
- CONTRACTOR TO PROVIDE EROSION CONTROL ON ALL NEW EXPOSED EXTERIOR PIPE PENETRATIONS AND SEAL COMPLETELY.
- CONTRACTOR TO PROVIDE EROSION CONTROL ON ALL NEW EXPOSED EXTERIOR PIPE PENETRATIONS AND SEAL COMPLETELY.
- ANY LANDSCAPE, HARDSCAPE, FUTURE, SIGNAGE AND SYSTEMS OR PEDESTRIAN CONTROL DEVICES WITHIN THE TEMPORARY ACCESSIBLE PATHWAY SHALL BE PROTECTED IN PLACE OR TEMPORARILY RELOCATED AS NECESSARY FOR CONTINUED UNINTERRUPTED OPERATION, ACCESS, MAINTENANCE AND/OR VISIBILITY.

KEYNOTES

1	NEW LABORATORY STAINLESS STEEL SHELVES ON CASTORS
2	HANDS FREE STAINLESS STEEL SINK WITH SOAP DISPENSER, MFG: EAGLE, MODEL HSA-10-FA-PE WITH EYE WASH
3	NEW ADJUSTABLE HEAVY STAINLESS STEEL DESK AND SHELVING UNIT MODIFICATION
4	NEW PRESCRIPTION LABEL PRINTER
5	PROVIDE METAL CABINET FOR PRINTER STORAGE
6	NEW LABORATORY REFRIGERATOR
7	NEW LABORATORY STAINLESS STEEL SHELVING

Revisions:	Date:

CONSULTANT

ARCHITECT/ENGINEER OF RECORD

A/E:
Triple C - The A/E Group
4401 Atlantic Avenue, Suite 200
Long Beach, CA 90807
(562) 432-7175
Mal Perkins



STAMP



Office of Construction and Facilities Management

VA U.S. Department of Veterans Affairs

Drawing Title

ARCHITECTURAL INTERIOR ELEVATIONS

Approved:

Phase

100% CONSTRUCTION DOCUMENTS

FULLY SPRINKLERED

Project Title

Clean Room Site Prep AE Design

Location
5901 E 7TH ST, LONG BEACH, CA 90822

Issue Date
06/28/2018

Checked
M. PERKINS

Project Number

800-18-200

Building Number
B126

Drawing Number
A-401

Drawn
N. BLANCHARD

