

VA U.S. Department of Veterans Affairs



LEO A DALY

VA CBOC Rochester

U.S. Department of Veterans Affairs

PROJECT NO. 36C10F18N3252
07/03/2018
FINAL SUBMISSION

SHEET INDEX	
GENERAL	
G1001	COVER SHEET
A-101	OVERALL PLAN - ABOX SUMMARY
A-102	OVERALL PLAN
A-103	ENLARGED PLAN - AREA A
A-104	ENLARGED PLAN - AREA B
A-105	ENLARGED PLAN - AREA C
A-106	ENLARGED PLAN - AREA D

PLANNING
ARCHITECTURE
ENGINEERING
INTERIORS

EST. 1915

ABU DHABI
ATLANTA
AUSTIN
CHICAGO
COLLEGE STATION
CORPUS CHRISTI
DALLAS
FLINT
FORT WORTH
HOUSTON
LAN - MONTGOMERY COUNTY
LANSING
LAREDO
LAS VEGAS
LOS ANGELES
MIAMI
MIDWEST
MILPITAS
MINNEAPOLIS
NORMAN
OMAHA
ORANGE
SACRAMENTO
SAN ANTONIO
SAN MARCOS
TAMPA
WACO
WASHINGTON, DC
WEST PALM BEACH



1 OVERALL PLAN SCALE: 1/8" = 1'-0"		CONSULTANT LEO A DALY 730 2nd Ave. South #1100 Minneapolis, MN 55402 (612) 338-8741 LEO A DALY		ARCHITECT/ENGINEER OF RECORD F F E Inc Engineering and Technical Services 420 Springfield Pike Wyoming, OH 45215 513-522-0956 FFE Inc Engineering and Technical Services		STAMP Engineering and Facilities Management Services VA U.S. Department of Veterans Affairs		Drawing Title OVERALL PLAN Approved:		Phase FINAL SUBMISSION TBD SPRINKLERED		Project Title ROCHESTER, NY CBOC Location ROCHESTER, NY Issue Date 07/03/2018 Checked KDC Drawn AFG		Project Number 36C10F18N3252 Building Number C.B.O.C Drawing Number A-102	
--	--	---	--	---	--	--	--	---	--	---	--	---	--	---	--

HBPC Team Work Area

Homeless Team Room
VIRTM1

TLT & Shower
TLTS2

Homeless Storage
SRS01

Homeless Patient
Interview

Homeless Patient Interview

Pharmacy Consult
OFDC2

D

SCALE: 1/4" = 1'-0"

Drawing Number

A-103



1 ENLARGED FLOOR PLAN - AREA B
SCALE: 1/4" = 1'-0"

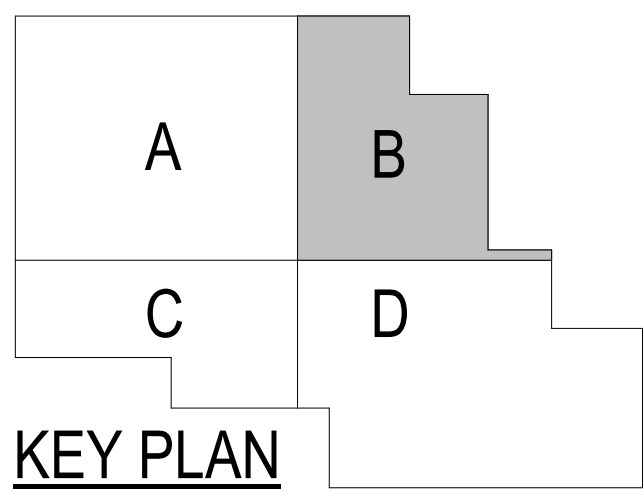

C:\Users\jgiblen\Documents\A\Index\Rev 2018 Project\CBDC-005-Rochester-Submission_3_aligent.vrt
7/9/2018 10:42:28 AM
F

Revisions:	Date:

CONSULTANT

LEO A DALY
730 2nd Ave. South #1100
Minneapolis, MN 55402
(612) 338-8741

LEO A DALY

ARCHITECT/ENGINEER OF RECORD

FF E Inc
Engineering and Technical Services
420 Springfield Pike
Wyoming, OH 45215
513-522-0956

FF E Inc
Engineering and Technical Services

STAMP

Engineering
and Facilities
Management
Services

VA U.S. Department
of Veterans
Affairs

Drawing Title

ENLARGED PLAN - AREA B

Approved:

Phase

FINAL SUBMISSION

TBD SPRINKLERED

Project Title

ROCHESTER, NY CBOC

Location

ROCHESTER, NY

Issue Date

07/03/2018

Checked

KDC

Drawn

AFG

Project Number

36C10F18N3252

Building Number

C.B.O.C

Drawing Number

A-104

A-105

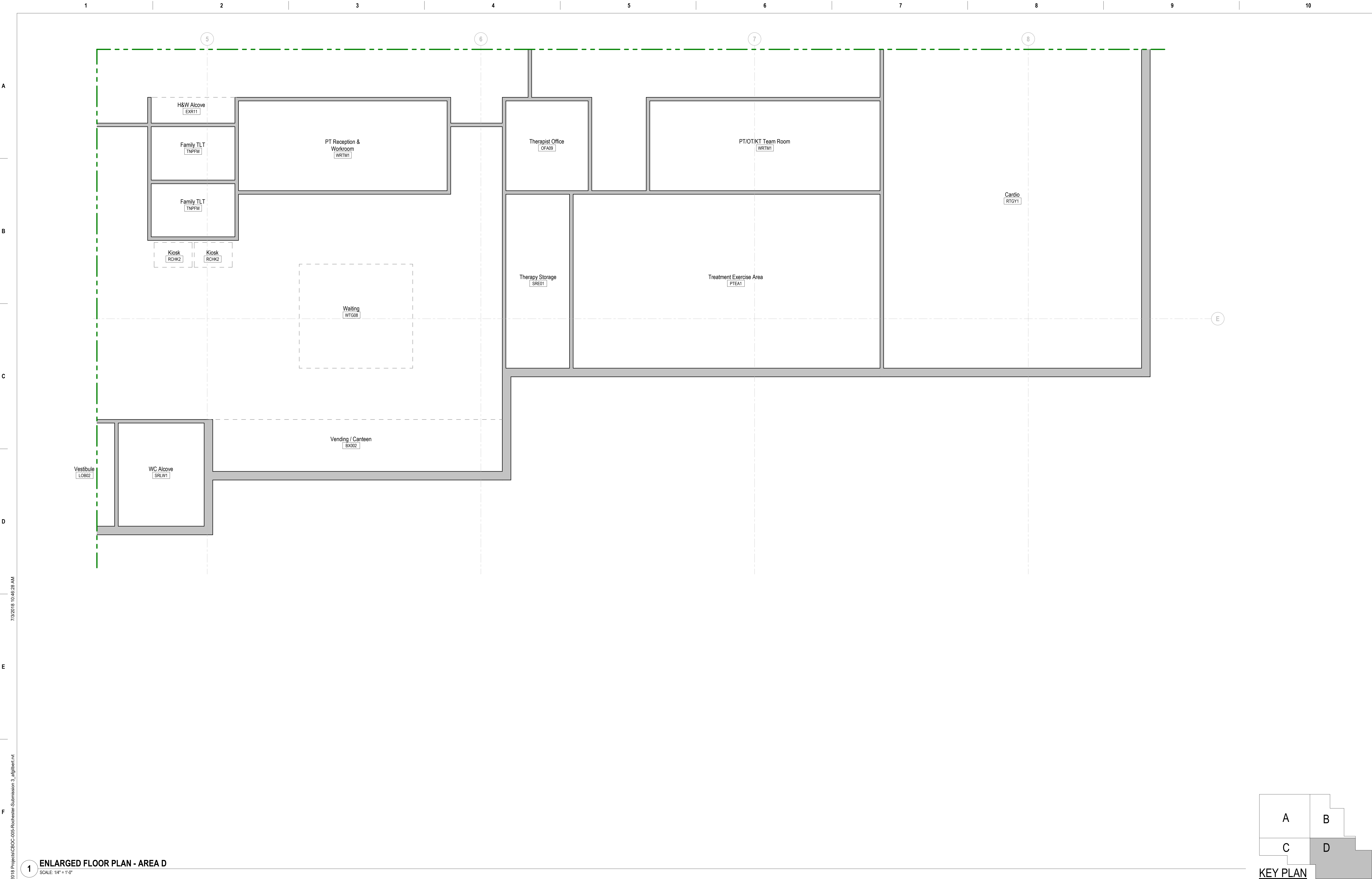

1 ENLARGED FLOOR PLAN - AREA D
SCALE: 1/4" = 1'-0"

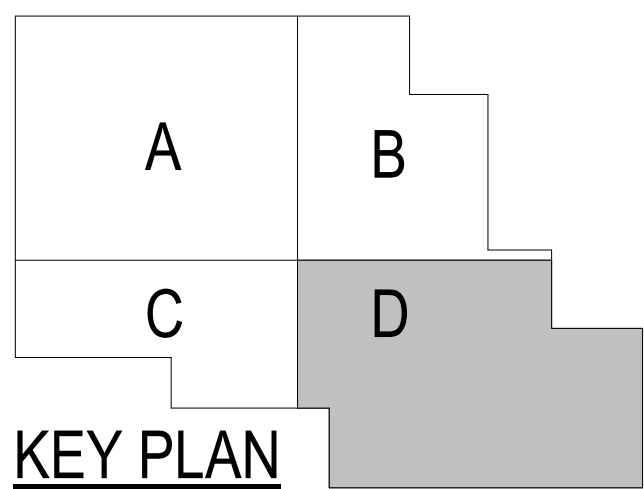

<div>Revisions:</div> <div>Date:</div>		<div>CONSULTANT</div> <div>LEO A DALY</div> <div>LEO A DALY 730 2nd Ave. South #1100 Minneapolis, MN 55402 (612) 338-8741</div>	<div>ARCHITECT/ENGINEER OF RECORD</div> <div>FF E Inc</div> <div>Engineering and Technical Services 420 Springfield Pike Wyoming, OH 45215 513-522-0956</div> <div>FF E Inc Engineering and Technical Services</div>	<div>STAMP</div>	<div>Engineering and Facilities Management Services</div> <div>VA U.S. Department of Veterans Affairs</div>	<div>Drawing Title</div> <div>ENLARGED PLAN - AREA D</div> <div>Approved:</div>	<div>Phase</div> <div>FINAL SUBMISSION</div> <div>TBD SPRINKLERED</div>	<div>Project Title</div> <div>ROCHESTER, NY CBOC</div> <div>Location</div> <div>ROCHESTER, NY</div> <div>Issue Date</div> <div>07/03/2018</div> <div>Checked</div> <div>KDC</div> <div>Drawn</div> <div>AFG</div>	<div>Project Number</div> <div>36C10F18N3252</div> <div>Building Number</div> <div>C.B.O.C</div> <div>Drawing Number</div> <div>A-106</div>
--	--	---	--	------------------	---	---	---	---	---

C:\Users\jgibber\Documents\A\Index\Rev 2018 Project\CBDC-005-Rochester-Submission_3_aligent.vrt 7/3/2018 10:42:28 AM