

B6 FOOD COURT DEMO
1/4" = 1'-0"

LEGEND

- = EXISTING WALLS TO BE REMOVED
- //// = NEW FULL HEIGHT WALL
- XXXXXX = NEW 60" HIGH WALL
- ===== = EXISTING WALL TO REMAIN

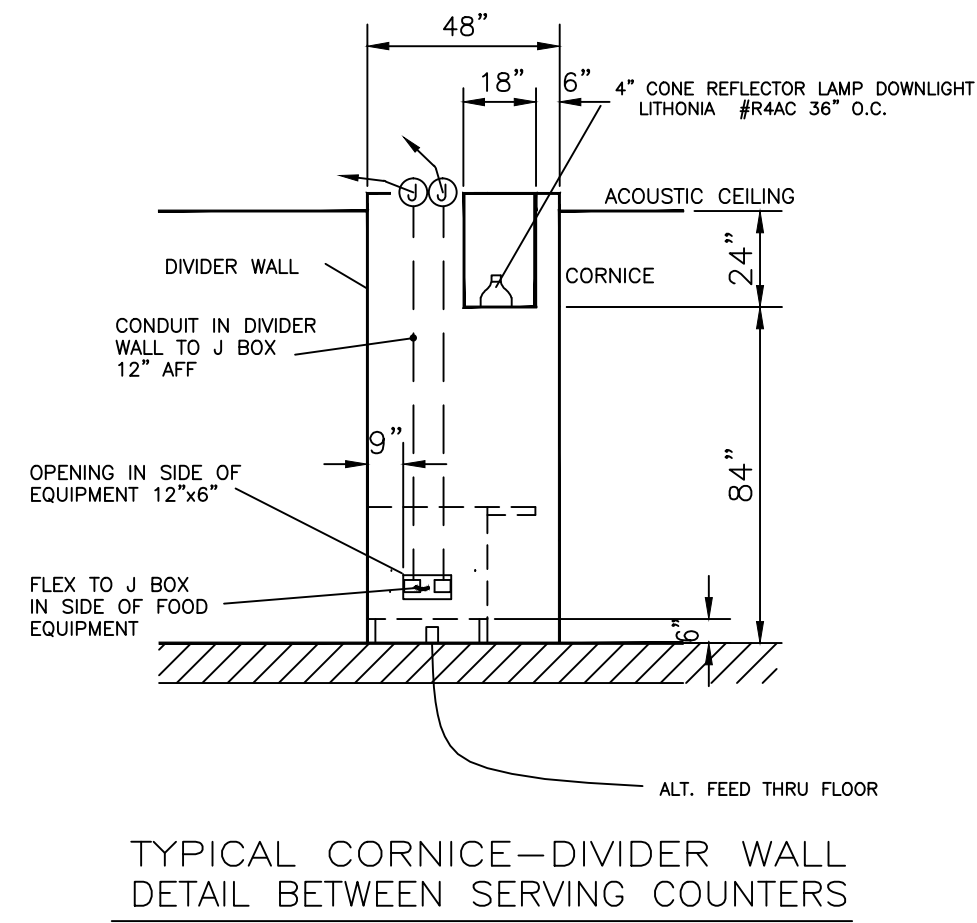

GENERAL NOTES FOR THE CONSTRUCTION OF THE FOOD COURT

ALL CONSTRUCTION IS THE RESPONSIBILITY OF THE CONTRACTOR INCLUDING THE REMOVAL, WALL DEMOLITION, DISCONNECTION AND INSTALLING UTILITIES, CONSTRUCTING NEW WALLS, PAINTING, LIGHTING, AND ACT.

- A. REMOVE ALL EXISTING VCS EQUIPMENT FROM AREA AND TRANSPORT TO
- B. REMOVE ALL DIVIDING WALLS LOCATED BETWEEN REMOVED EQUIPMENT. THIS INCLUDED THE CORNICE WITH LIGHT FIXTURES. CAP ALL UTILITIES AFTER DISCONNECTING FROM EQUIPMENT. DISPOSE OFF VA PROPERTY.
- C. REMOVE ALL FURNITURE AND DISPOSE OFF STATION.
- D. REMOVE EXISTING CEILING TILE AND GRID AND DISPOSE OFF STATION.
- E. REMOVE ALL FLOORING MATERIAL FROM FLOOR AND DISPOSE OFF STATION.
- F. REMOVE EXISTING ELECTRICAL SWITCH LEGS, OUTLETS AS REQUIRED FOR INSTALLATION OF NEW NEW DOORS AND STORE WINDOWS. REMOVE FIRE ALARM STROBE AND STORE FOR RELOCATION.
- G. SAWCUT EXISTING WALL FOR NEW STORE FRONT WINDOWS
- H. DISCONNECT AND REMOVE EXISTING DISHWASHER AND ALL ELECTRICAL, STEAM, CONDENSATE LINES AND CAP BELOW FLOOR. DISCONNECT EXISTING EXHAUST DUCTWORK AND CAP ABOVE CEILING AND REPLACE CEILING TILES TO MATCH.
- I. REMOVE EXISTING CLEAN TABLE AND TURN OVER TO VA
- J. REMOVE EXISTING GARBAGE DISPOSAL AND TURN OVER TO THE VA.
- K. REMOVE EXISTING SECURITY CAMERAS AND STORE FOR REINSTALLATION.

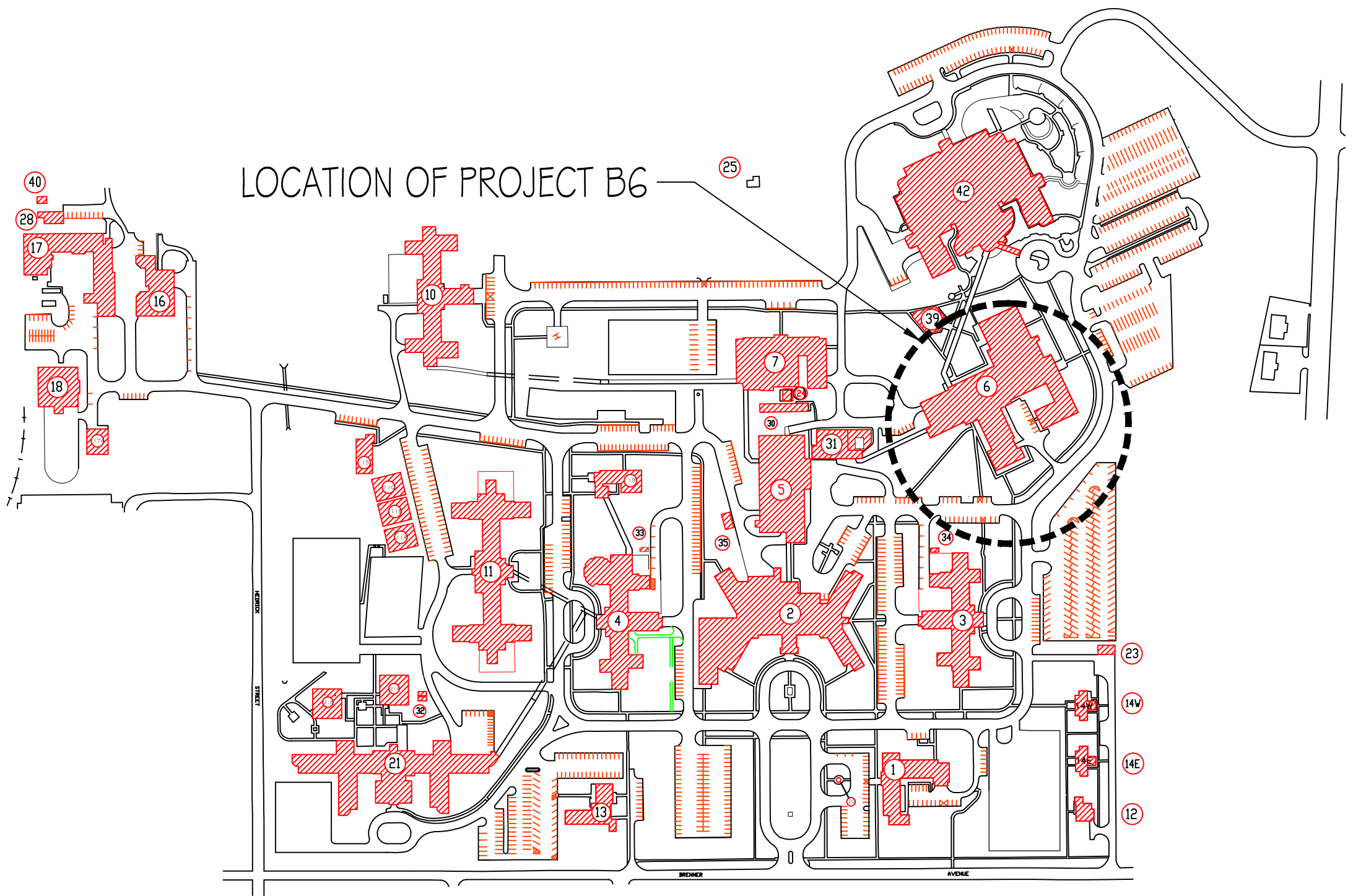

SALISBURY VAMC SITE PLAN

Revision		Date		RECOMMEND APPROVAL				Drawing Title		Project Title		Date			Department of Veterans Affairs		
				REQUESTER	Date	CHIEF OF SERVICE	Date	CHIEF OF STAFF	Date	DEMO PLANS, NOTES		BUILDING 6 FOOD COURT RENOVATION				7-25-2012	
				ASSOC. DIR. PATIENT CARE SVC.	Date	ASSOC. DIR. for OPERATIONS	Date	Approved: Safety Manager/M&O Supervisor		Building Number	Checked	Drawn	Project No.		DRAWING NO.		
								Approved:Chief of Facilities Management Svr.		6		GLM	659-12-242				1
				APPROVAL BY:		Date		Location		W.G.(Bill) Hefner Medical Center 1601 Brenner Ave. Salisbury NC 28144							
				MEDICAL CENTER DIRECTOR													

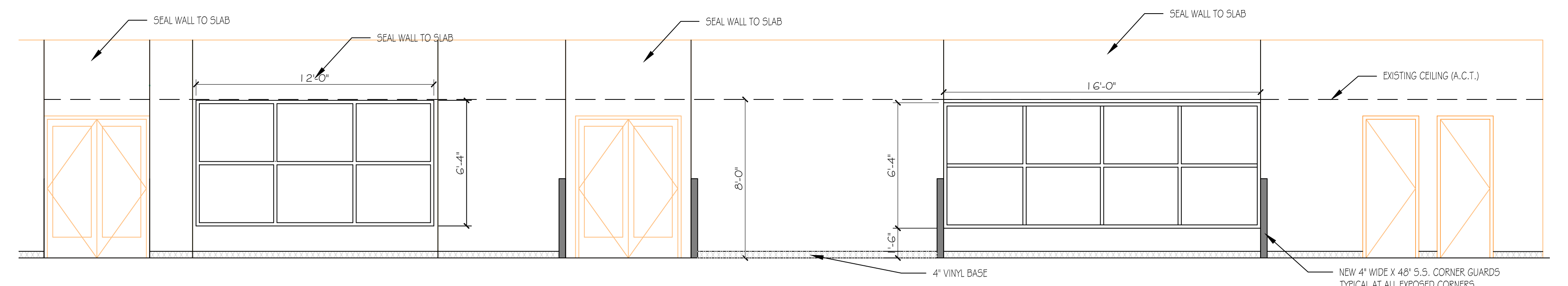

1. CONSTRUCT NEW METAL STUD AND $\frac{5}{8}$ " G.W.B WALL FROM FLOOR TO 4" ABOVE CEILING GRID.
2. CONSTRUCT NEW METAL STUD AND $\frac{5}{8}$ " G.W.B WALL FROM FLOOR TO SLAB ABOVE. SEAL ALL PENETRATIONS THAT COME THROUGH THIS SECTION OF WALLS.
3. PATCH AND REPAIR FLOOR SLAB BACK AND INSTALL NEW VINYL FLOORING TO MATCH EXISTING IN CORRIDOR.
4. PROVIDE AND INSTALL NEW 6'-0" WIDE DOUBLE DOOR WITH MOTION DETECTORS. ONE DOOR IS TO SWING IN AND THE OTHER TO SWING OUT.
5. CONSTRUCT NEW METAL STUD AND $\frac{5}{8}$ " G.W.B. WALL FROM FLOOR TO SLAB ABOVE. SEAL ALL OPENING AND PENETRATIONS IN NEW WALL. INSTALL NEW METAL FRAME STORE FRONT WINDOWS.
6. CONSTRUCT NEW METAL STUD AND $\frac{5}{8}$ " G.W.B WALL 60" HIGH AS INDICATED BY DRAWING.
7. INSTALL 4" X 48" S.S. CORNER GUARDS ON ALL EXPOSED CORNERS IN CORRIDOR AND ON NEW 60" HIGH WALL.
8. INSTALL NEW 4" RUBBER BASE ON ALL WALLS IN CORRIDORS TO MATCH EXISTING BASE IN AREA,
9. CONSTRUCT THESE WALLS FOR A SMOKE TIGHT SEAL TO SLAB ABOVE.
10. CONSTRUCT NEW CORNICE WITH NEW FLUORESCENT PENDANT LIGHTS CENTERED 24" O.C. SEE DETAIL ON SHEET 5.
11. PROVIDE AND INSTALL NEW 27 $\frac{1}{2}$ " x 74 $\frac{5}{8}$ " 430 S.S. 3 BOWL SINK THAT IS N.S.F CERTIFIED. EACH BOWL TO BE 20" x 16" X 10 $\frac{1}{2}$ " DEEP. SINK TO BE COMPLETE WITH ONE KROWNE METAL 17-108w ROYAL SERIES PRE-RINSE WALL MOUNTED, SPRING ACTION FLEXIBLE GOOSENECK 35" HIGH WITH 15" OVERHANG, INTERNAL CHECK VALVE, $\frac{1}{2}$ " NPT FEMALE INLETS THAT IS N.S.F., ONE KROWNE METAL 21-140L LOW LEAD ADD ON FAUCET WITH 14" SPOUT, N.S.F./ANSI STANDARD 61-G. INSTALL ALL REQUIRE PLUMBING, INCLUDING DRAINS, HOT AND COLD SUPPLY LINES WITH INSULATION ON PIPING. NEW SINK BE ABLE TO MATCH EXISTING HEIGHT OF EXISTING SCRAP TABLE TO WHERE THERE WILL BE A SMOOTH TRANSITION BETWEEN THE TWO TABLES.
12. PROVIDE AND INSTALL A NEW 430 S.S. CLEAN TABLE THAT IS N.S.F CERTIFIED AND CAN MATCH LENGTH OF EXISTING AND WILL FIT INTO THE REMAINING SPACE AFTER THE INSTALLATION OF NEW 3 BOWL SINK.
13. PROVIDE AND INSTALL NEW 5" WIDE WOOD CHAIR RAIL. COLOR OF PAINT TO BE CHOSEN LATER AFTER AWARD.



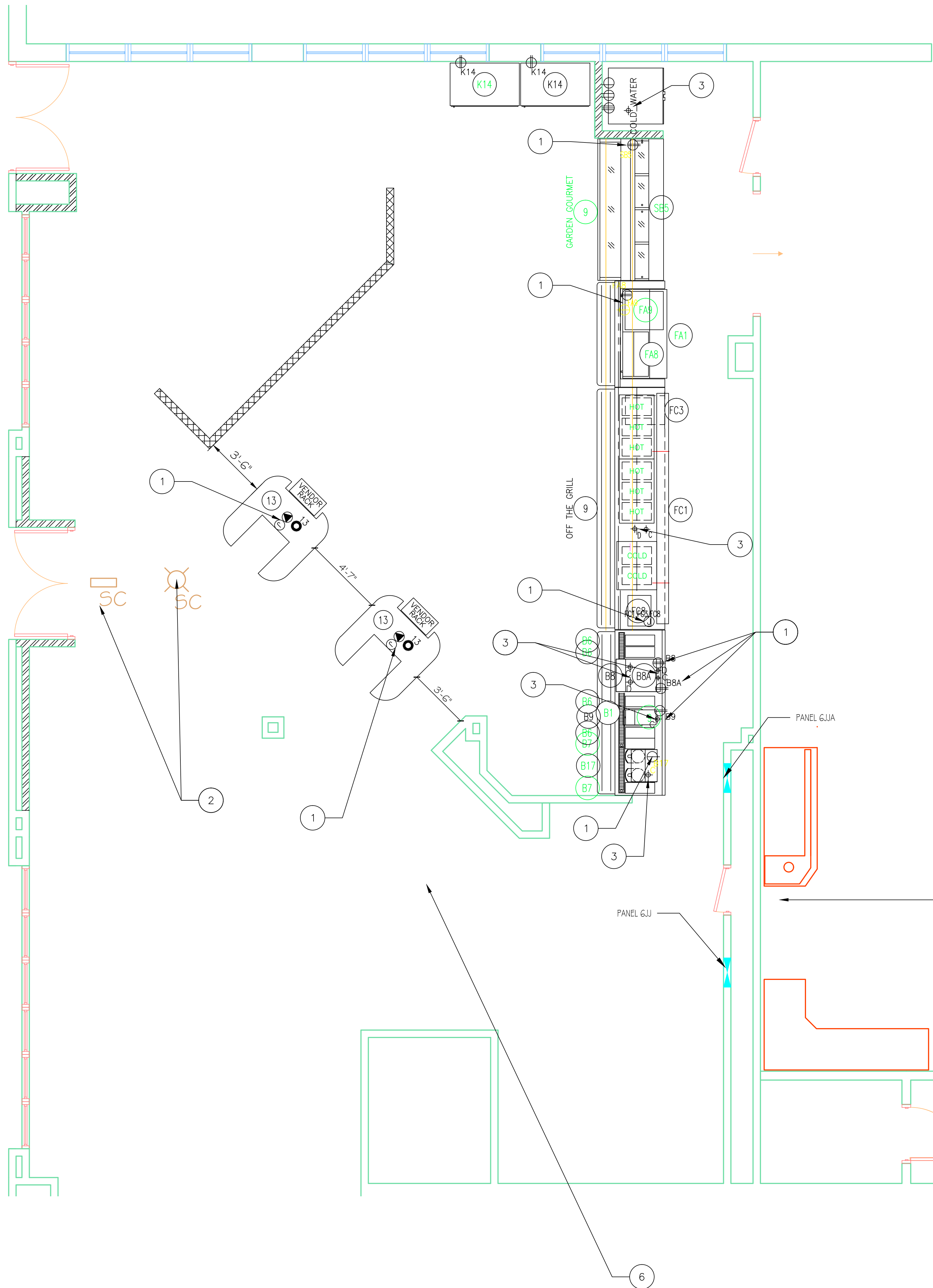

FOOD SERVICE EQUIPMENT SCHEDULE													
EQUIPMENT SPECIFICATIONS				PREFERRED ENERGY SOURCE				PLUMBING			ALTERNATE ENERGY SOURCE		
NO.	ITEM	MODEL	SIZE L/W/H	ELECTRICAL SUPPLY	PREFERRED ENERGY SOURCE	WATER	WASTE	ELEC	STEAM	GAS	ALTERNATE ENERGY SOURCE	VENTILATION	REMARKS
6	CONDIMENT STAND	FABRICATED	60/37/45	KC									
6	CONDIMENT PUMP	SERVER SE-301 07050	18/14/11	KC									
9	MENU BOARD (3)	HOWARD	48/3/24	KC									
13	REGISTER STAND (2)	FABRICATED	56/60/49	KC	STUB UP	120/1	15A	DEDICATED	CLEAN	LINE	REQD.		
17	TRAY DISPENSER (2)	DUKE TTD-1216	25/24/52	KC									
B1	BEVERAGE COUNTER	FABRICATED	112/46/34	KC	12" AFF	120/1	6.2A				1"		
B6	COLD CUP DISPENSER (4)	DISPENSE-RITE WR-CT-4	7/20/24	KK									
B7	HOT CUP DISPENSER (2)	DISPENSE-RITE WR-CT-5	7/20/19	KK									
B8	BEVERAGE/ICE DISPENSER	PROVIDED BY COKE	22/30/32	KC	12" AFF	120/1	2.5A				1/2"		
B8A	ICE MACHINE	HOSHIZAKI MODEL - TBD	22/27/30	KC	12" AFF	120/1	20A				1/2"	3/4"	
B9	ICED TEA BREWER	BUNN TSD W/ TDO-4	9/18/34	KC	12" AFF	120/1	15A				1/4"		
B17	COFFEE BREWER	FETCO CBS-2052a	22/22/37	KC	12" AFF	120/2DBV	1-Phase 23A				3/8"	(3-Wires + Ground)	
FA1	COUNTER FRONT W/ TRAY SLIDE	FABRICATED W/ S.S. TOP CAP/GLASS	72/5/34	KC									
FA8	REFRIG FOOD PREP. TABLE	TRUE TSU-60-8	80/30/36	KC	12" AFF	115/1	7.8A	NEMA 5-15P					
FA9	TORNADO OVEN	TURBO-CHEF NC	26/26/19	KC	40" AFF	208/1	30A						
FC1	OFF THE GRILL COUNTER	FABRICATED W/6 HOT/2 COLD	164/46/34	KC	12" AFF	208/1	43A				3/8"	3/4"	INCLUDE POWER FOR FC1, FC3 & FC8
FC3	1-DRAWER WARMER (BUILT-IN)	HATCO HDW-1BN	20/28/10	KC	BUILT IN								
FC8	HOLDING BIN	DUKE FWM3-42	21/16/22	KC	BUILT IN								
K14	2 SECTION DISPLAY REFRIGERATOR (2)	TRUE GRM-41	47/30/79	KC	48" AFF	115/1	9.2A						
SB5	SALAD/DELI CASE	FEDERAL SQ-BCD	96/45/48	KC	12" AFF	120/1	16A	(HARDWIRED)					

CC = MEDICAL CENTER CONTRACTOR SUPPLY AND INSTALL
KC = CANTEEN SUPPLY AND MEDICAL CENTER CONTRACTOR INSTALL
KK = CANTEEN SUPPLY AND CANTEEN INSTALL

UTILITY REQUIREMENTS	
	120V OUTLET WITH EQUIPMENT NUMBER
	208V OUTLET WITH EQUIPMENT NUMBER
	SPARE OUTLET 120V
	J-BX WITH EQUIPMENT NUMBER
	STUB UP WITH EQUIPMENT NUMBER
	TELEPHONE JACK
	COLD WATER INLET
	HOT WATER INLET
	DRAIN REQUIRED
	GAS REQUIRED
	STEAM REQUIRED

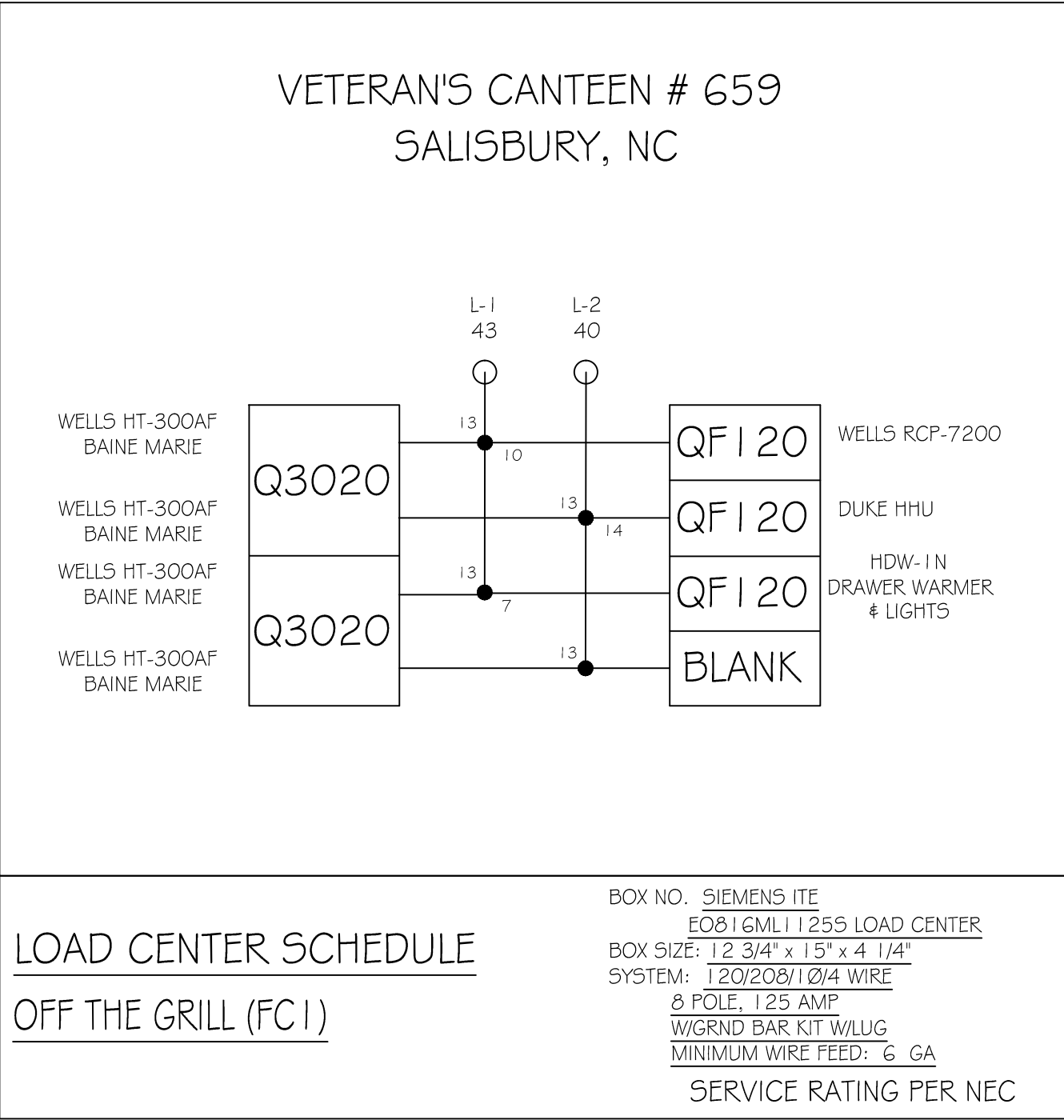

UTILITIES GENERAL NOTES:

- INSTALL NEW ELECTRICAL AS EQUIPMENT SCHEDULE REQUIREMENTS.
- REINSTALL EXISTING SECURITY CAMERAS AS REQUIRED
- INSTALL NEW PLUMBING LINES (SUPPLY AND WASTE LINES) AS REQUIRED BY EQUIPMENT SCHEDULE.
- REMOVE ALL ASSOCIATED PLUMBING LINES TO THE DISHMACHING AND CAP. THIS INCLUDES STEAM, CONDENSATE, WATER SUPPLY LINES.
- INSTALL A VA PROVIDED GARBAGE DISPOSAL TO THE EXISTING SCRAP TROUGH. TIE INTO EXISTING SYSTEM POWER SOURCE
- EXTEND EXISTING SPRINKLER HEAD TO THE NEW CEILING ELEVATION.

Revision		Date	RECOMMEND APPROVAL		Drawing Title	Project Title	Date		Department of Veterans Affairs
Requester		Date	Chief of Service		UTILITIES PLANS AND NOTES	BUILDING 6 FOOD COURT RENOVATION	7-25-2012		
Chief of Service		Date	Chief of Staff		Approved: Safety Manager/M&O Supervisor	Building Number	6		
Assoc. Dir. Patient Care Svc.		Date	Assoc. Dir. for Operations		Approved: Chief of Facilities Management Svr.	Checked	GLM		
Approval By:		Date	Medical Center Director		Location	W.G.(Bill) Hefner Medical Center 1601 Brenner Ave. Salisbury NC 28144	Drawn	3	
								DWG. 3 OF 5	

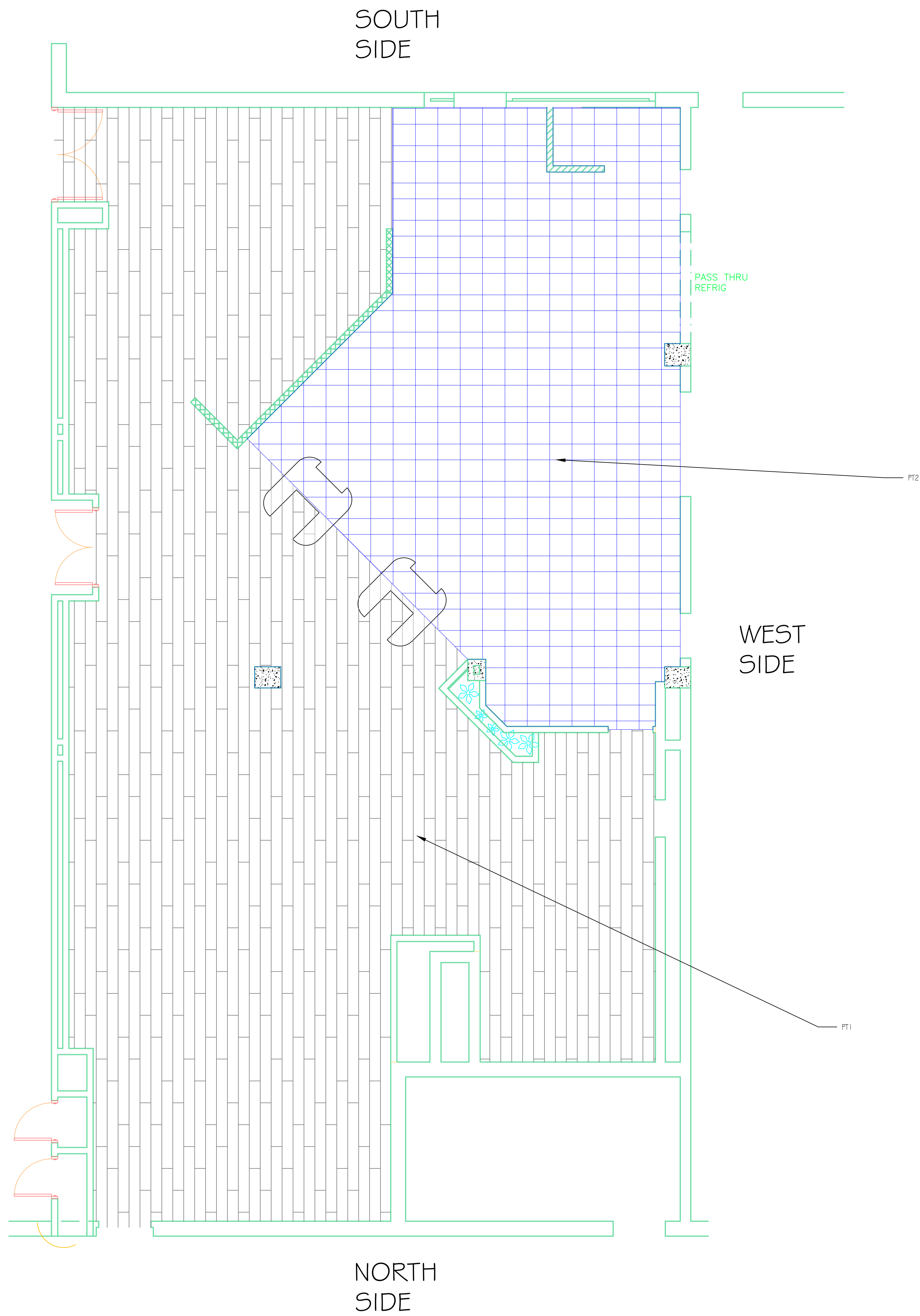

TILE LOCATION PLAN

1/4" = 1'-0"

FINISH SCHEDULE										
ROOM NUMBER	FUNCTION	FLOOR	BASE	WALLS				DOOR FRAME	CEILING	REMARKS
				NORTH	EAST	SOUTH	WEST			
1074	DINING AREA	SV	R	P1/P2/WP	P2	P1	P2/P1	P3		SEE DRAWING FOR FINISH DETAIL
1074	VISITOR SERVING AREA	PT1	PT1	P1	P1	P1	P1	P3		SEE DRAWING FOR FINISH DETAIL
1074	BEHIND SERVING LINE	PT2	PT2	P2	P2	P2	PT1 DIAGONAL 12X12	P3		SEE DRAWING FOR FINISH DETAIL

MATERIALS LEGEND				
ITEM	CODE	MANUFACTURE	STYLE	FINISH
PAINT	P1	SHERWIN WILLIAMS	DOWNING EARTH SW2820	LOW LUSTER
PAINT	P2	DELUX ICI	TRADITIONAL TAN L1823	LOW LUSTER
TRIM PAINT	P3	SHERWIN WILLIAMS	POISED TAUPE SW6039	LATEX ENAMEL
WALL PAPER	WP	CARNEGIE XOREL	ARTISAN EMBROIDER 6787 W134	PAPER BACKED XOREL
PORCELAIN TILE	PT1	MOSAIC TILE (EDIMAX)	SLATY 12X18 & 12X12	OCHRE
PORCELAIN TILE	PT2	CROSSVILLE	CROSS TRED 8X8	GRAPHITE A850
SHEET VINYL	SV	TEKNOFLOR	FORESTSCAPES/FIRESIDE COLLECTION	MEDIUM WALNUT 31097
RUBBER BASE	R	JOHNSONITE 4" COVE	RUBBER COVE	TOAST 283

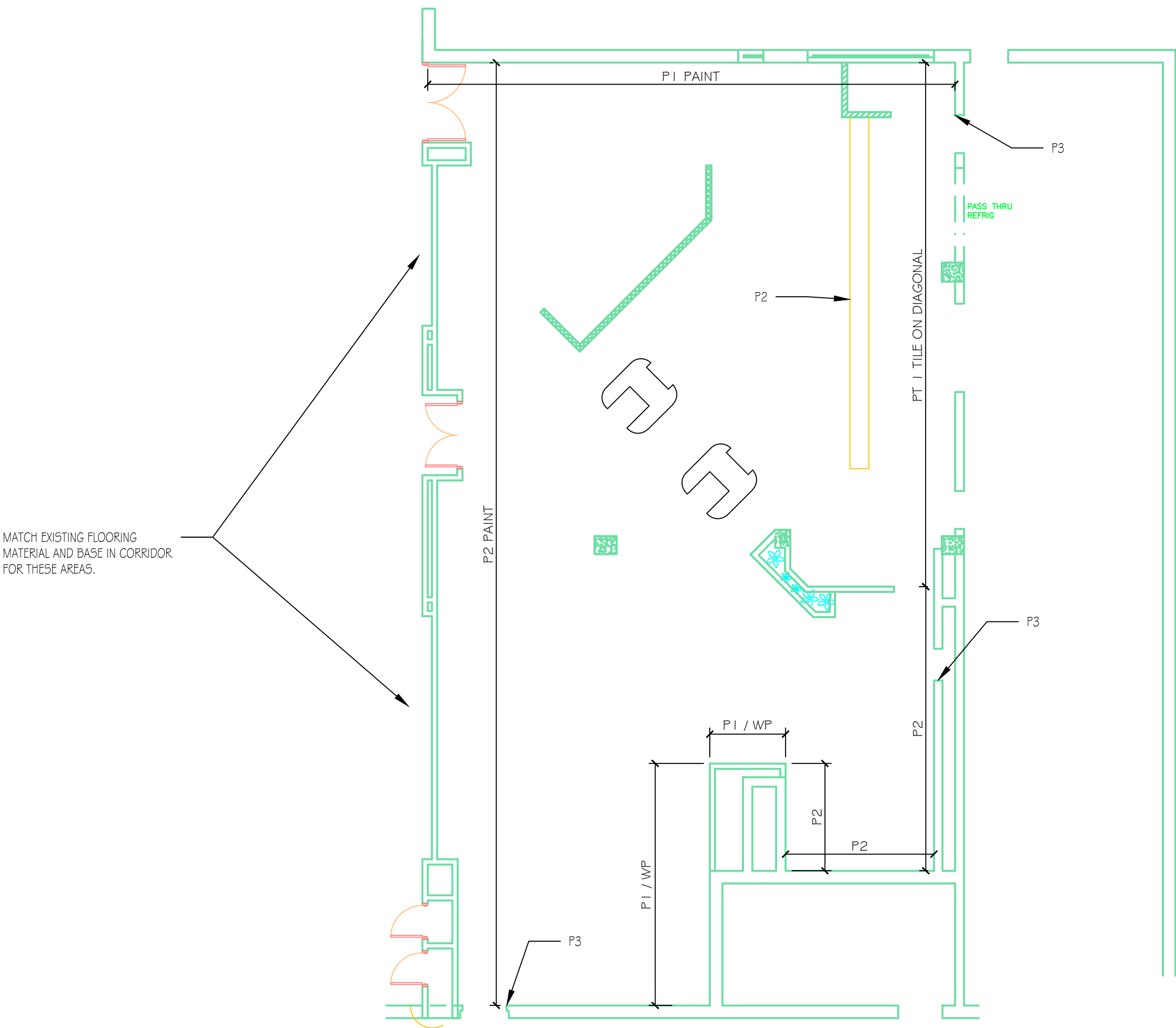

FINISH LOCATION PLAN

1/8" = 1'-0"

Revision		Date	RECOMMEND APPROVAL				Drawing Title		Project Title		Date		Department of Veterans Affairs	
Requester		Date	Chief of Service		Date	Chief of Staff		Date	TILE LAYOUT AND MATERIALS		BUILDING 6 FOOD COURT RENOVATION			
Assoc. Dir. Patient Care Svc.		Date	Assoc. Dir. for Operations		Date	Approved: Safety Manager/M&O Supervisor		Date	Building Number		Checked	Drawn		
Approval By:		Date	MEDICAL CENTER DIRECTOR		Date	Approved: Chief of Facilities Management Svr.		Date	6		GLM	GLM		
							Location		W.G.(Bill) Hefner Medical Center 1601 Brenner Ave. Salisbury NC 28144		Project No. 659-12-242			
											DRAWING NO. 4			
											DWG. 4 OF 5			

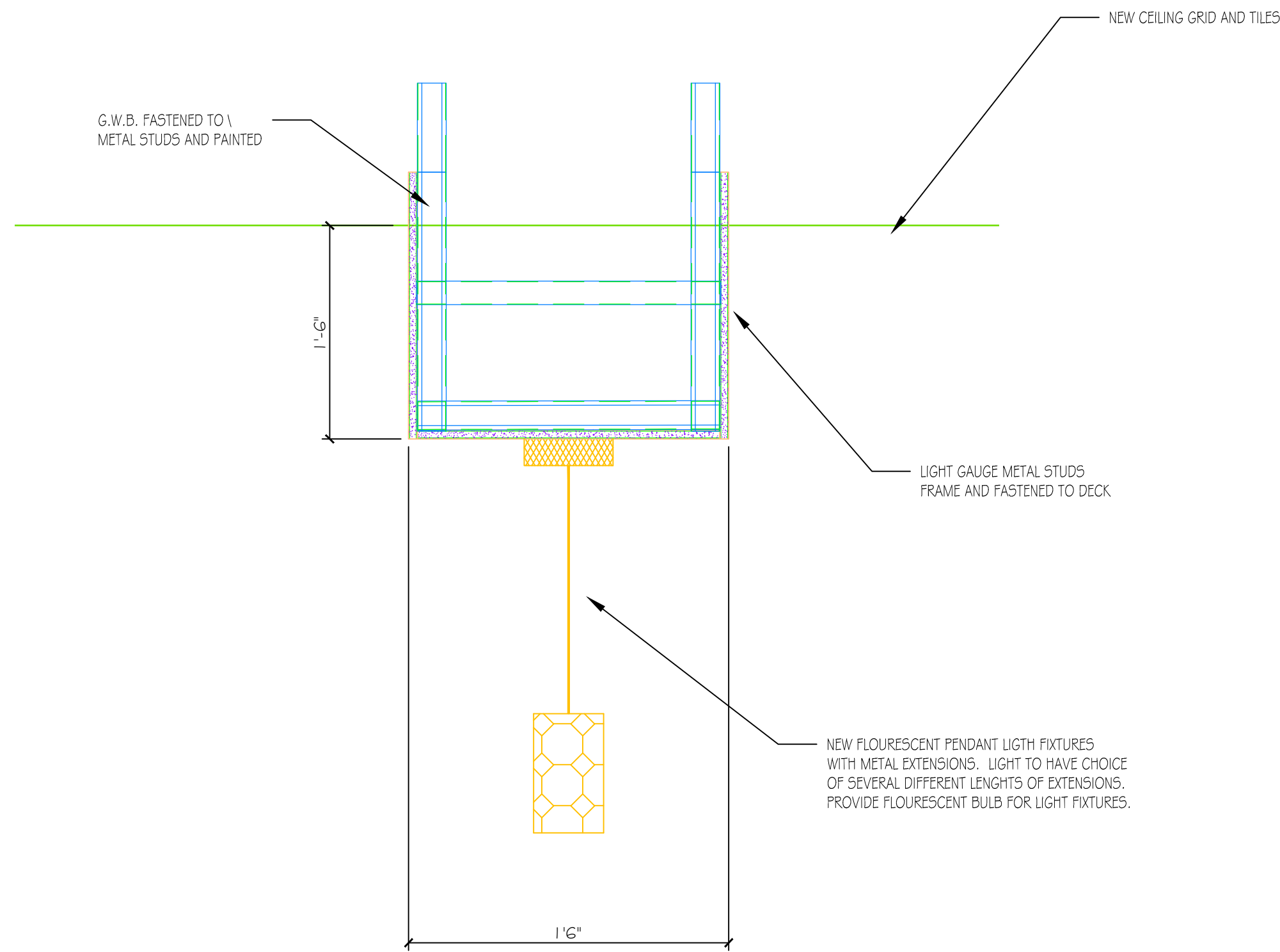
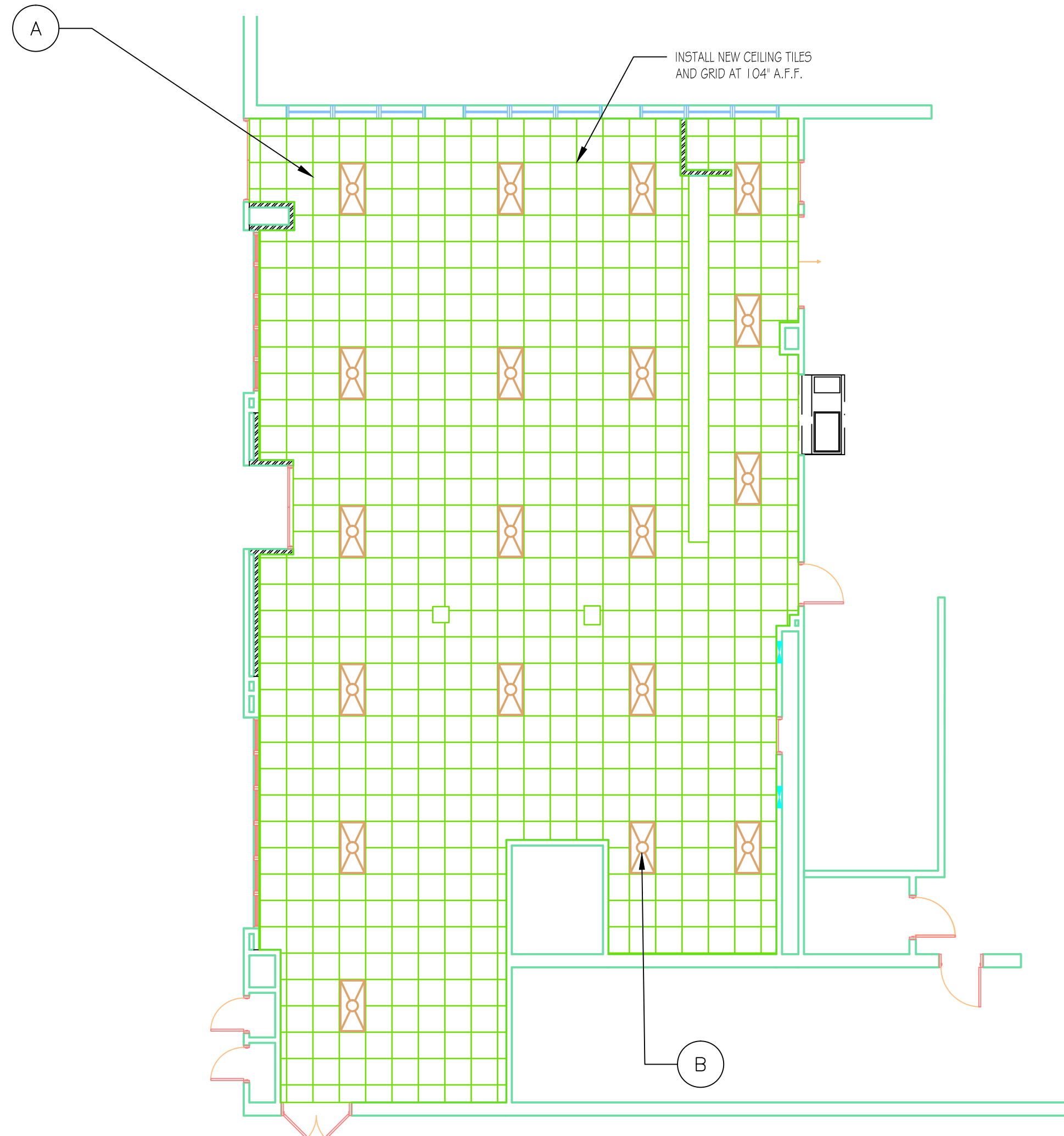

- NOTES ON CEILING AND LIGHTS:
- A. PROVIDE AND INSTALL NEW ARMSTRONG CIRRUS ANGLED TEGULAR CEILING TILE AND GRID SYSTEM, INSTALL AT 1'04" ABOVE THE FINISHED FLOOR.
 - B. PROVIDE AND INSTALL NEW 2'X4' ORACLE (CAT # 240T-232-E-MVOLT) WITH A-19 MAL CONICAL PRISMATIC LENS.
 - C. PROVIDE AND INSTALL NEW PENDANT LIGHT FIXTURES EQUAL TO PRIMA TITAN VII-532I MONOPOINT WITH A METAL SHAFT FROM BASE TO FIXTURE. LIGHT FIXTURE MUST USE A FLUORESCENT BULB (18-23 WATTS) AND MUST ALSO INCLUDE SEVERAL DIFFERENT LENGTHS OF METAL SHAFT SUCH AS TWO EACH OF 6" AND 12" OR 15" SO AS TO COME UP AT LONGER LENGTH
 - D. PROVIDE AND INSTALL NEW WALL SCONCE BY PEACHTREE OR EQUAL (MODEL PS-FCYL-PL). MOUNT AT A HEIGHT OF 72" O.C A.F.F.
 - E. PROVIDE AND INSTALL NEW DOWNLIGHT BY MAXILUME (MODEL BHVR6PL-1X32-E-MVOLT-6107-CL, OPEN REFLECTOR/WALL WASH OPTIC)
 - F. ASSEMBLE VA PROVIDE FURNITURE AND LOCATE IN RENOVATED AREA.

DINING EQUIPMENT SCHEDULE

NO.	ITEM	SUPPLIER/INSTALLER	SIZE	QUANTITY	# OF SEATS
D6	27"x24" TABLE W/2 CHAIRS	C/M	27"x24"	27	54
D7	47"x30" TABLE W/4 CHAIRS	C/M	48"x30"	2	8
D8	36"x36" TABLE W/4 CHAIRS	C/M	36"x36"	3	12
D11	36"x36" TABLE W/3 CHAIRS, HANDICAP	C/M	36"x36"	5	20
D21	TRASH RECEPTACLE (SINGLE)	C/M	24"x24"	8	
TOTAL NUMBER OF SEATS					94

C/M = CANTEN SUPPLY/MEDICAL CENTER INSTALLATION
ALL FREESTANDING TABLES ARE 30" AFF, MEETING HANDICAP REGULATIONS.
THOSE MARKED HANDICAP ARE 32" AFF TO SUPPORT TODAY'S LARGER WHEELCHAIRS.

** PURCHASE 10% BARIATRIC CHAIRS

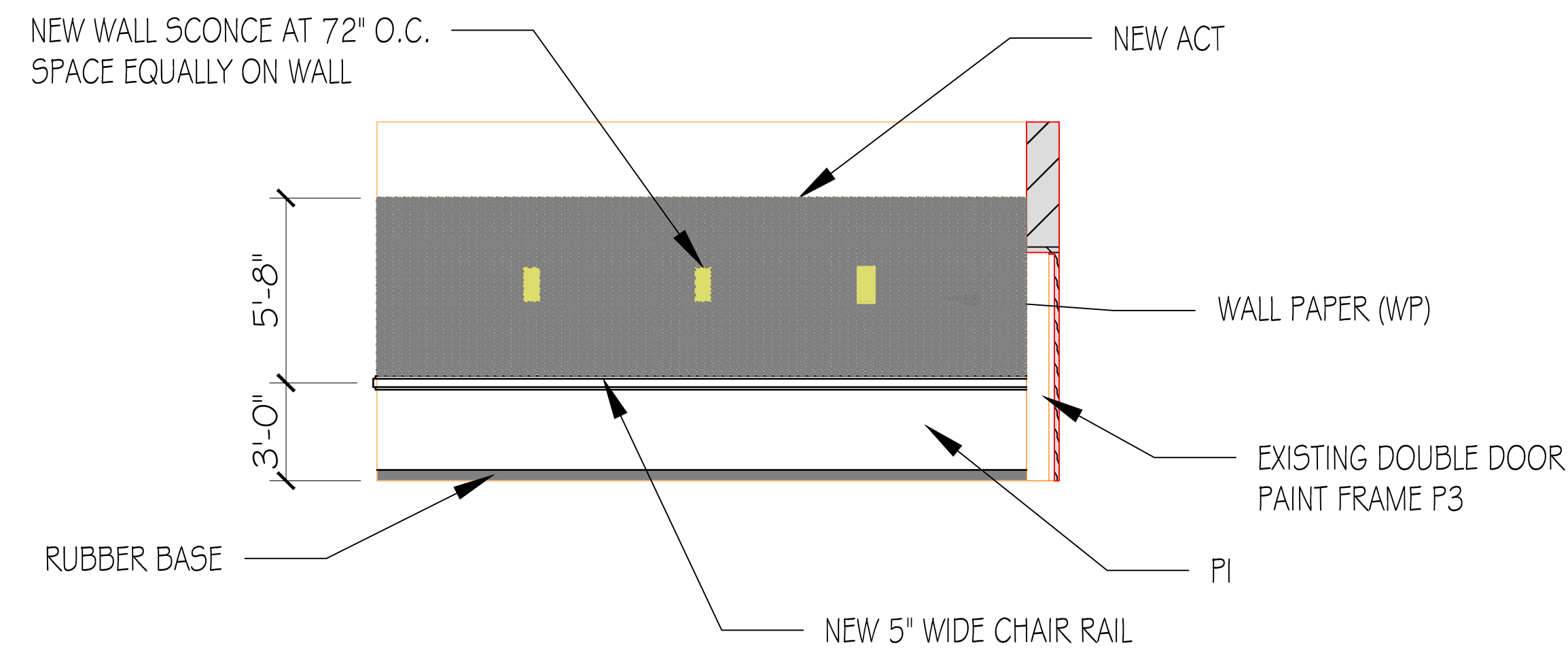
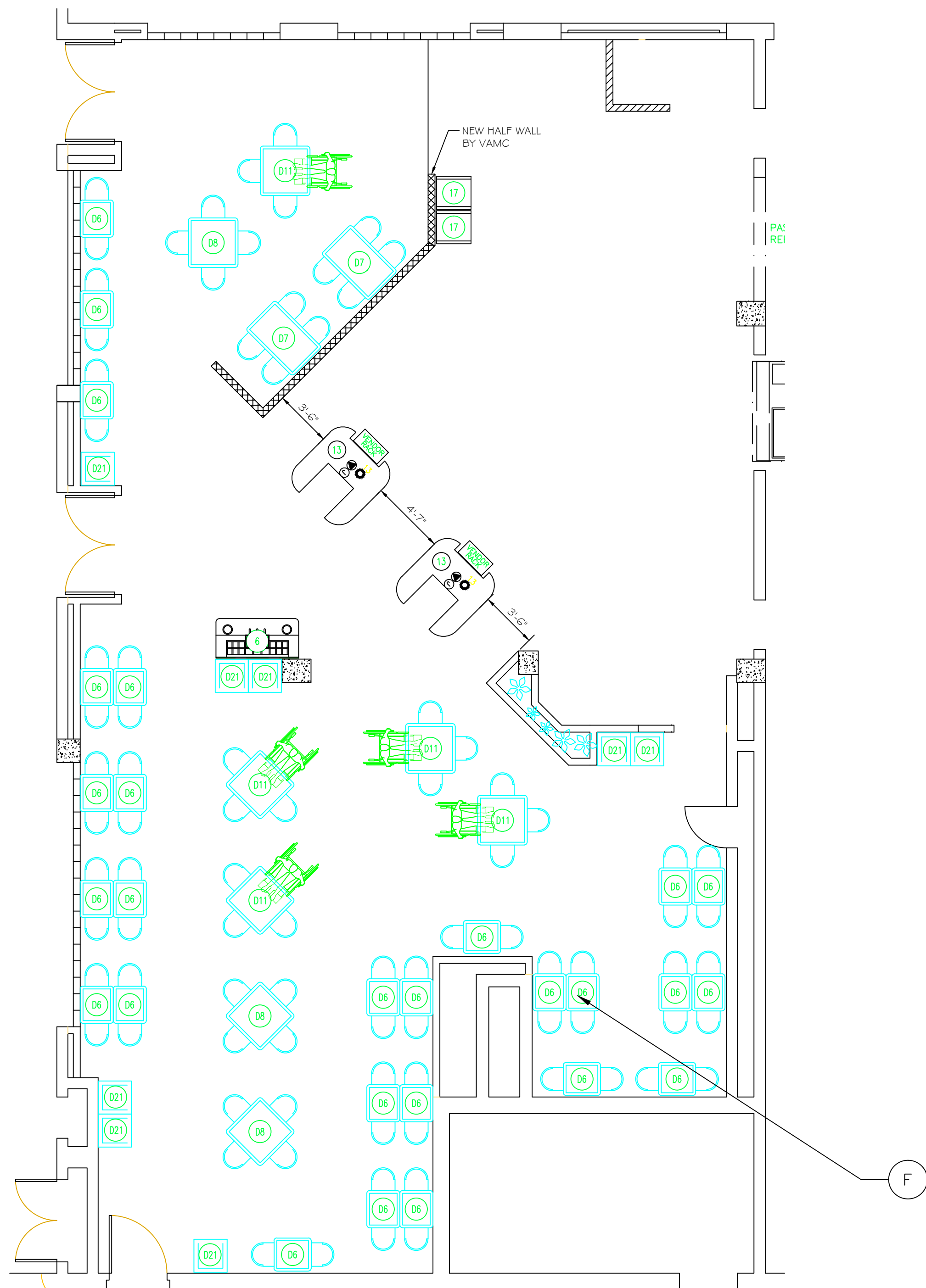

1 WALL ELEVATION
1/4" = 1'-0"

Revision	Date

RECOMMEND	APPROVAL
REQUESTER	Date
CHIEF OF SERVICE	Date
ASSOC. DIR. PATIENT CARE SVC.	Date
APPROVAL BY:	Date
MEDICAL CENTER DIRECTOR	

RECOMMEND	APPROVAL
REQUESTER	Date
CHIEF OF SERVICE	Date
ASSOC. DIR. PATIENT CARE SVC.	Date
APPROVAL BY:	Date
MEDICAL CENTER DIRECTOR	

Drawing Title	CEILING PLANS, LIGHT LAYOUT AND DETAIL
Approved: Safety Manager/M&O Supervisor	
Approved:Chief of Facilities Management Svr.	

Project Title	BUILDING 6 FOOD COURT RENOVATION
Building Number	6
Checked	GLM
Drawn	GLM
Location	W.G.(Bill) Hefner Medical Center 1601 Brenner Ave. Salisbury NC 28144

Date	7-25-2012
Project No.	659-12-242
DRAWING NO.	5
DWG. 5 OF 5	

