

- REFLECTED CEILING PLAN LEGEND**
- FULL HEIGHT METAL STUD @ 16" O.C. U.N.O. WITH SOUND BATT. INSULATION AND FINISHES FULL HEIGHT FROM FINISH FLOOR TO DECK ABOVE. REFER TO DETAIL 6, 7 & 8/AS906.
 - PARTIAL HEIGHT METAL STUD @ 16" O.C. U.N.O. WITH SOUND BATT. INSULATION AND FINISHES FROM FINISH FLOOR TO 2" ABOVE FINISH CEILING. REFER TO DETAIL 5/AS906.
 - (E) METAL STUD WALL WITH SOUND BATT. INSULATION. WALL AND FINISHES FULL HEIGHT FROM FINISH FLOOR TO DECK ABOVE. REPLACE FINISHES WHERE NOTED.
 - (E) METAL STUD WALL WITH THERMAL INSULATION. WALL AND FINISHES FULL HEIGHT FROM FINISH FLOOR TO DECK ABOVE. REPLACE FINISHES WHERE NOTED.
 - (E) FULL HEIGHT STRUCTURAL CONCRETE WALL.
 - (E) METAL STUD WALL WITH SOUND BATT. INSULATION. WALL AND FINISHES PARTIAL HEIGHT. REPLACE FINISHES WHERE NOTED.
 - 1 HR FIRE BARRIER. WALL AND FINISHES FULL HEIGHT FROM FLOOR TO DECK ABOVE.
 - (E) 2 HR FIRE BARRIER. WALL AND FINISHES FULL HEIGHT FROM FLOOR TO DECK ABOVE.
 - CEMENT PLASTER. REFER TO SHEET AS911.
 - SUSPENDED GYPSUM WALLBOARD CEILING. REFER TO SHEET AS911.
 - SUSPENDED T-BAR ACOUSTICAL CEILING WITH 2'-0" x 2'-0" INFILL PANELS. REFER TO SHEET AS911.
 - CONCRETE FLOOR ABOVE. REFER TO STRUCTURAL DRAWINGS.
 - LIGHT FIXTURES. REFER TO ELECTRICAL DRAWINGS FOR FIXTURE TYPES.
 - HVAC DIFFUSERS. REFER TO MECHANICAL DRAWINGS FOR DIFFUSER TYPES.
 - LINEAR DIFFUSER. TITUS FLOWBAR OR EQUAL. REFER TO MECHANICAL.
 - FIRE SPRINKLER HEAD LOCATION AT AUDITORIUM. REFER TO FIRE PROTECTION DRAWINGS FOR TYPE. REFER TO FIRE PROTECTION DRAWINGS FOR SPRINKLER HEAD LOCATIONS THROUGHOUT REMAINDER OF BUILDING.
 - CEILING ACCESS PANEL. ALSO INDICATES DIRECTION OF DOOR SWING. SEE DETAIL 6/AS911.
 - EXIT SIGN. SOLID LINES INDICATES THE LOCATIONS OF ILLUMINATION WITH EXIT DIRECTIONAL ARROW. REFER TO ELECTRICAL DRAWINGS FOR FIXTURE TYPES.
 - (E) SUSPENDED GYP. WALL BOARD CEILING TO REMAIN. PAINT.

- REFLECTED CEILING PLAN - REMODEL KEYNOTES**
- EXISTING SKYLIGHT AND SLOPING CEMENT PLASTER SOFFIT TO REMAIN. TYPICAL OF 7., PAINT CEMENT PLASTER.
 - (E) SUNSCREEN TO REMAIN, U.N.O. REMOVE DEBRIS AND CLEAN VIA POWER WASH.
 - DECORATIVE PANEL CEILING. (OMIT DECORATIVE PANEL CEILING AT DEDUCTIVE ALTERNATE 4)
 - (E) CEILING HVAC DIFFUSERS, LIGHTING & ELECTRICAL DEVICES TO REMAIN, TYP.
 - CEMENT PLASTER SOFFIT PAINT
 - (E) CEMENT PLASTER TRELLIS, PAINT
 - (E) GYPSUM BOARD CEILING, PAINT.
 - PROJECTOR MOUNT. SEE ELECTRICAL DRAWINGS.

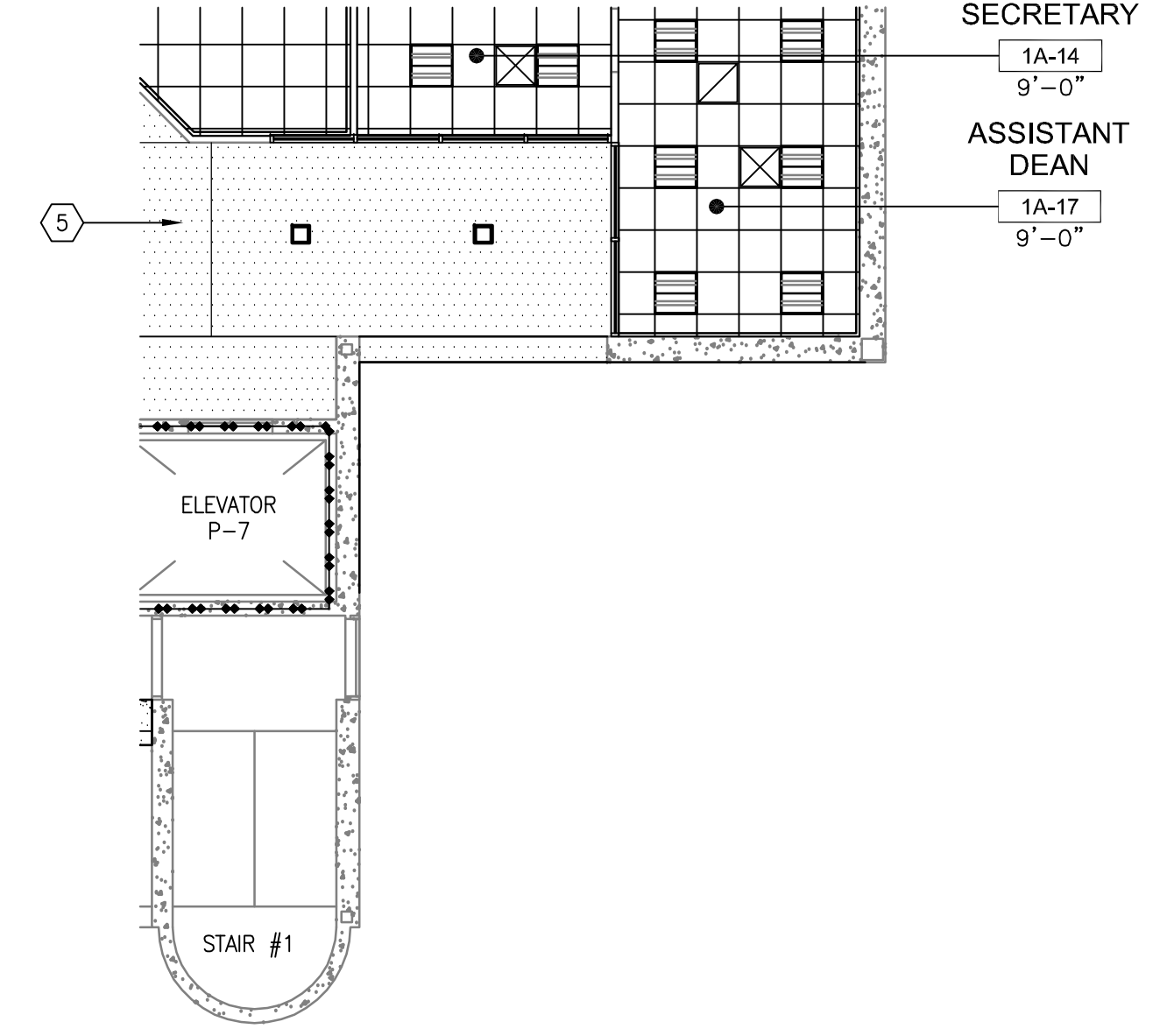

REMODELED PARTIAL FIRST FLOOR REFLECTED CEILING PLAN
DEDUCTIVE ALTERNATE 1
1/8" = 1'-0"

CONSULTANTS:		ARCHITECT/ENGINEERS:		Drawing Title		Project Title		Project Number		Office of Construction and Facilities Management Department of Veterans Affairs	
		HMC Architects		FIRST FLOOR REFLECTED CEILING PLAN		BUILDING 24 SEISMIC CORRECTION AND ADDITION		570-215			
		1827 E. Fir Avenue, Studio 103 / Fresno, CA 93720 T 559 322 2444 / www.hmcarchitects.com		Approved Project Director		Location VAMC FRESNO, CA		Building Number 24			
						Date October 14, 2011		Drawing Number AS301			
Revisions								Checked BB		Drawn CLO	
Date										Dwg. 56 of 180	