

A
three inches = one foot
1
B
one and one half inches = one foot
2
C
one inch = one foot
3
D
three quarters inch = one foot
4
E
one half inch = one foot
5
F
three eighths inch = one foot
6
one quarter inch = one foot
7
one eighth inch = one foot
8
one sixteenth inch = one foot
9

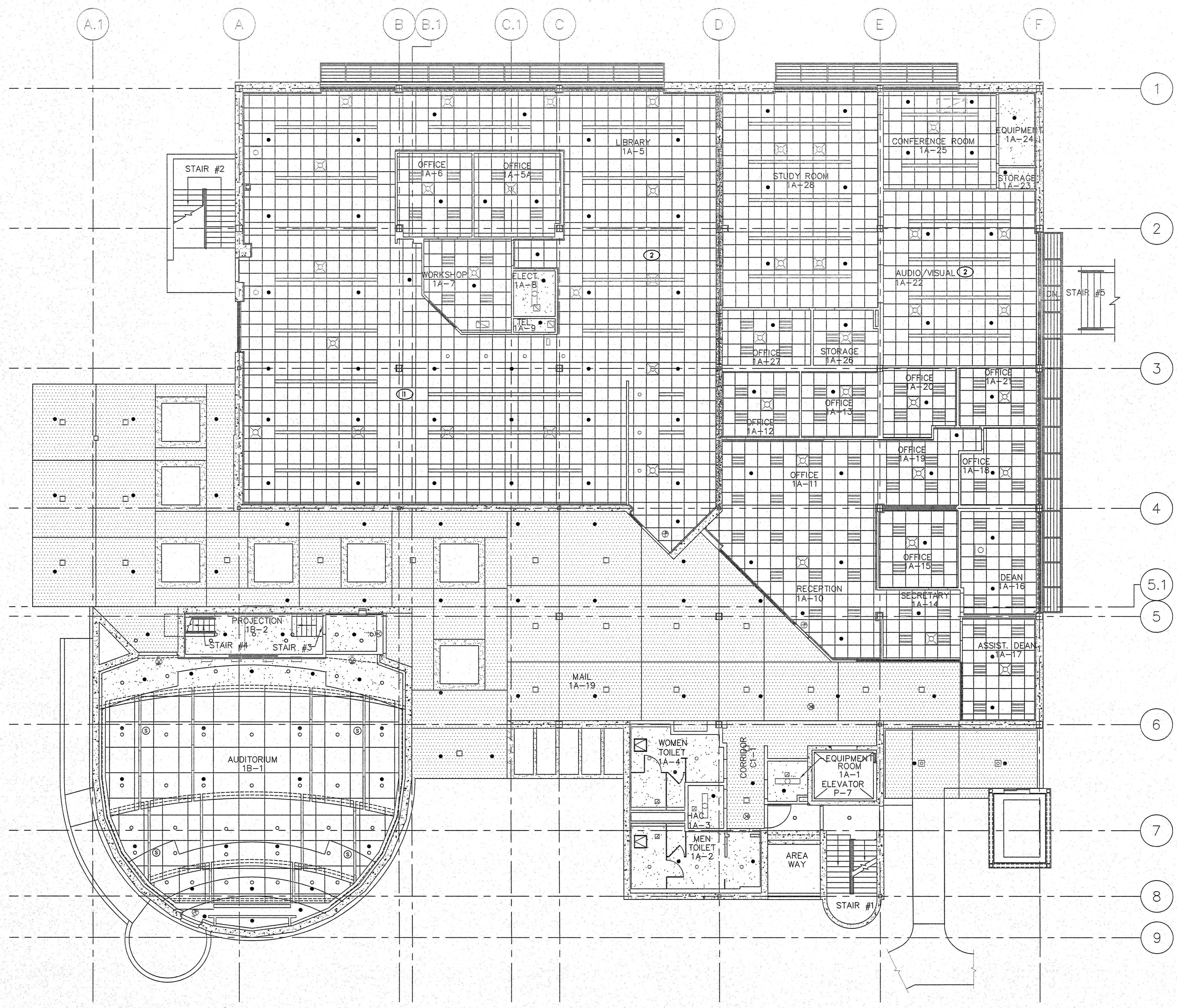

- KEY NOTES
- 1

MAINTAIN 18" CLEARANCE FROM SPRINKLER DEFLECTOR TO TOP OF STORAGE.
- 2

ALL PENDENT SPRINKLERS TO BE IN CENTERLINE OF CEILING TILE OR LIGHTING PATTERN, UNO.

- GENERAL NOTES
- 1

ITEMS SHOWN ON THIS PLAN DESCRIBE GENERAL LAYOUT REQUIREMENTS, AND ARE NOT INTENDED TO SHOW A COMPLETE LAYOUT OF REQUIRED FIRE PROTECTION SYSTEM PIPING AND COMPONENTS. REFER TO ARCHITECTURAL, MECHANICAL, AND PLUMBING SHEETS, FIRE PROTECTION SPECIFICATIONS, AS WELL AS OTHER PORTIONS OF THE CONTRACT DOCUMENTS FOR ADDITIONAL COORDINATION REQUIREMENTS.
- 2

THE LAYOUT REQUIREMENTS DESCRIBED IN THESE PLANS SHALL BE ADHERED TO AS CLOSELY AS POSSIBLE BUT SHALL NOT SUPERSEDE CODE CONSTRAINTS AND/OR REQUIREMENTS OF AUTHORITIES HAVING JURISDICTION (A/HJ). WHERE CODE OR A/HJ REQUIREMENTS SUPERSEDE ITEMS SHOWN ON THIS PLAN, CONTRACTOR SHALL INCLUDE ALL ASSOCIATED PROVISIONS IN THE BID, AND SHALL MAKE THEM AT NO ADDITIONAL COST TO OWNER. PROPOSED DEVIATIONS FROM THIS PLAN SHALL BE SUBJECT TO ENGINEER OF RECORD REVIEW AND APPROVAL PRIOR TO IMPLEMENTATION.
- 3

ALL AREAS OF THE BUILDING NOT COVERED BY NOTES HEREIN SHALL BE FULLY SPRINKLERED IN ACCORDANCE WITH SPECIFICATIONS, NFPA 13, 2010 ED., CITY OF FRESNO FIRE DEPARTMENT REQUIREMENTS, DEPARTMENT OF VETERANS AFFAIRS FIRE PROTECTION DESIGN STANDARDS AND CODE REQUIREMENTS.
- 4

WHERE PLAN INDICATES EXPOSED FIRE SPRINKLER PIPING DIRECTION OF LAYOUT, ASSOCIATED CONNECTED FIRE SPRINKLER PIPING RUNNING IN PERPENDICULAR DIRECTIONS SHALL BE INSTALLED ONLY IN CONCEALED LOCATIONS UNLESS INDICATED OTHERWISE.
- 5

INSTALLING CONTRACTOR TO FIELD VERIFY ALL EXISTING CONDITIONS AND IS RESPONSIBLE FOR PREPARING A DESIGN TO ACCOMMODATE ALL EXISTING CONDITIONS.
- 6

EXPOSED FIRE SPRINKLER SYSTEM PIPING SHALL BE RUN STRAIGHT AND TIGHT TO UNDERSIDE OF STRUCTURAL MEMBERS, AND SHALL NOT OFFSET VERTICALLY TO DROP BELOW BEAMS.

SYMBOLS AND DESCRIPTIONS

SYM	TYPE	FINISH	TEMP	K FACTOR	THRD	SN *	MFG	MODEL	EXCUT/CHN
●	SGP	WHITE	155	5.6	1/2"	VK300	VIKING	MICROFAST	SEMI REC

1 FIRST FLOOR FIRE SPRINKLER REFLECTED CEILING PLAN
1/8"=1'-0"

Revisions

Date

CONSULTANTS:

LP Consulting Engineers, Inc.
695 W. Ashlan Ave, Suite 101 Clovis, CA 93612
p 559-348-2130 - f 559-348-2131
www.lpeengineers.com
Job #: 10-1096

HMC Architects
1827 E. Fir Avenue, Studio 103 / Fresno, CA 93720
T 559 322 2444 / www.hmcarchitects.com

Drawing Title

FIRST FLOOR FIRE SPRINKLER
REFLECTED CEILING PLAN

Approved Project Director

Project Title

BUILDING 24
SEISMIC CORRECTION
AND ADDITION

Location

VAMC FRESNO, CA

Date

JANUARY 31, 2012

Checked

SA

Drawn

ES

Project Number

570-215

Building Number

24

Drawing Number

FP201

Dwg. 125 of 180

Office of Construction and Facilities Management

Department of Veterans Affairs