

- SITE PLAN GENERAL NOTES**
- SEE CIVIL ENGINEERING DRAWINGS FOR CONCRETE PAD, SITE UTILITIES & EXISTING SITE INFORMATION.
  - SEE MEP DRAWINGS FOR FIRE PROTECTION, ELECTRICAL, MECHANICAL & PLUMBING OF TEMPORARY RAMP FOR MOBILE PROCESSING UNIT & UTILITY SERVICE ENTRANCE.
  - ALL DAMAGE TO EXISTING PAVEMENT TO REMAIN WHICH RESULTS FROM THE CONTRACTORS OPERATIONS SHALL BE REPLACED WITH LIKE MATERIALS AT THE CONTRACTORS EXPENSE.
  - THE CONTRACTOR SHALL VERIFY ALL DIMENSIONS AND ELEVATIONS IN THE FIELD PRIOR TO THE START OF CONSTRUCTION. THE CONTRACTOR SHALL BE RESPONSIBLE FOR ALL FIELD DIMENSIONS AND ELEVATIONS DURING THE ENTIRE CONSTRUCTION SCHEDULE. IF ANY DISCREPANCIES ARE FOUND IN THESE PLANS FROM ACTUAL FIELD DIMENSIONS, THE CONTRACTOR SHALL CONTACT THE ENGINEER/ARCHITECT IMMEDIATELY.
  - REFER TO THE ARCHITECTURAL DRAWINGS FOR EXACT BUILDING DIMENSIONS AND LOCATIONS OF UTILITY SERVICES ENTRANCE, BUILDING DRAINS, ROOF DRAINS, DOORS AND EXIT FEATURES.

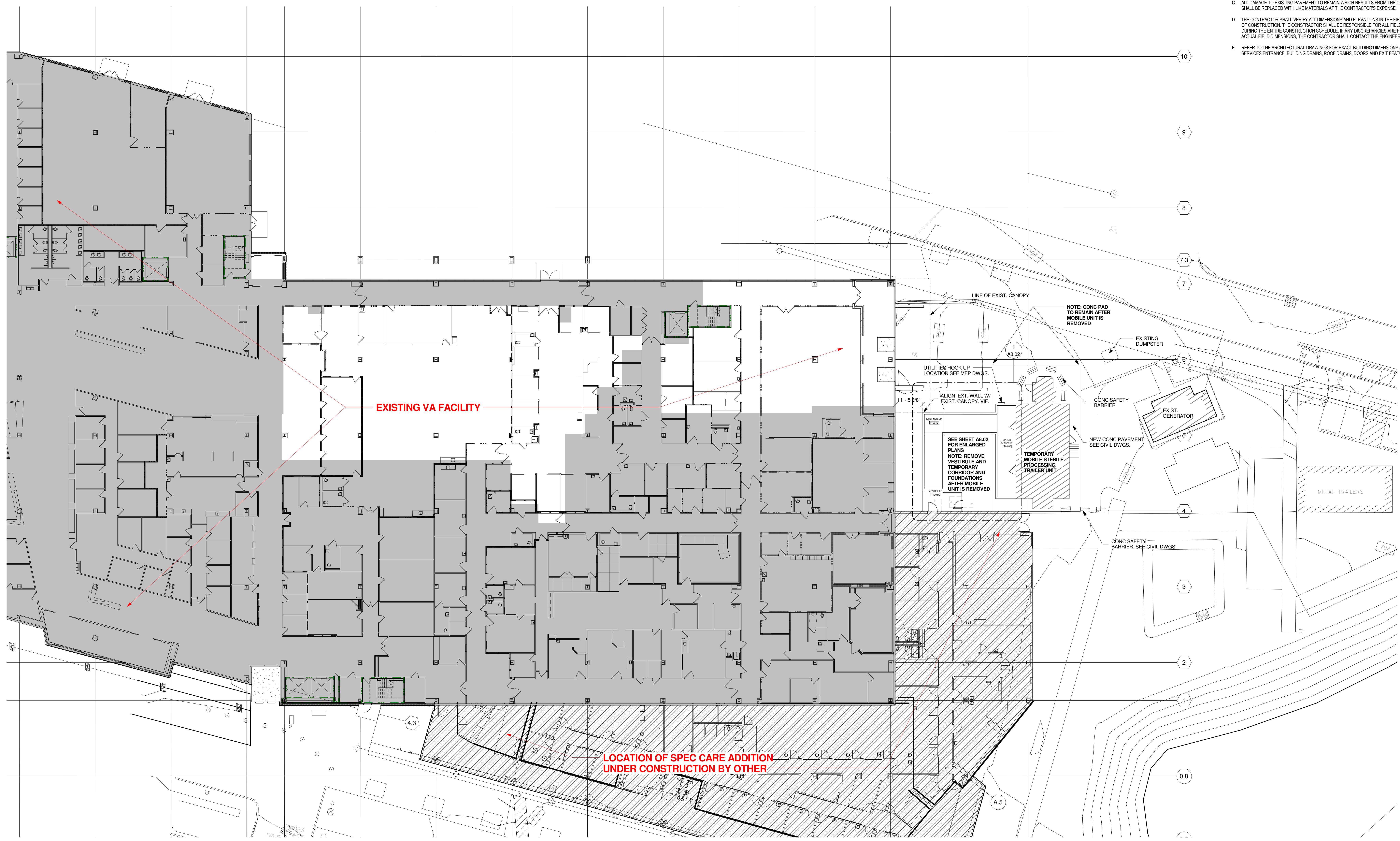

site plan - temporary mobile sterile processing

1  
A8.01 1/8" = 1'-0"

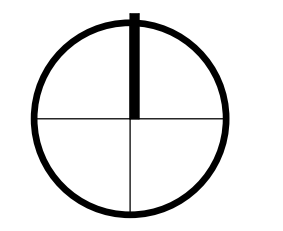

BID DOCUMENTS - 100% SET REVISED	2016 11-18
BID DOCUMENTS - 100% SET	2016 05-11
CONSTRUCTION DOCUMENTS - 85% REVIEW SET	2016 03-30
DESIGN DEVELOPMENT TWO - 75% REVIEW SET	2016 02-03
DESIGN DEVELOPMENT ONE - 50% REVIEW SET	2015 11-25
SCHEMATIC DESIGN REVISIONS - 25% REVIEW SET	2015 10-21
SCHEMATIC DESIGN - 25% REVIEW SET	2015 10-07
Revisions:	Date

**CONSULTANTS:**

**Dynamix Engineering Ltd.**  
Facility Engineering Consultants  
800 Grandview Avenue, 3rd Floor Columbus, OH 43215  
Phone: 614.766.1218 Fax: 614.766.1216  
Email: dynamix@engineering.com

**Jezerinac Geers**  
Structural Engineering

**EMH&T**  
Engineers, Surveyors, Planners, Scientists

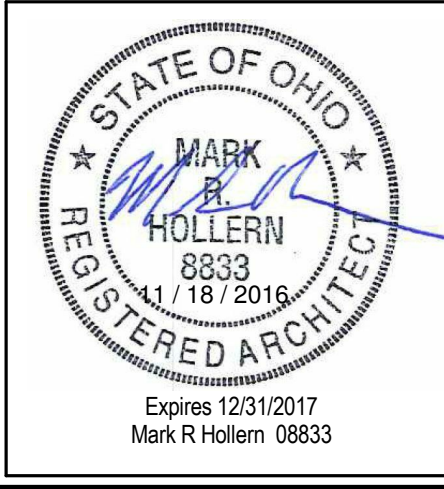

**ARCHITECT/ENGINEERS:**

**ma**

775 Yard Street, Suite 325  
Columbus, Ohio 43212  
p 614.766.0407  
f 614.766.0237  
www.ma-architects.com

<b>BID DOCUMENTS - BID</b>	
Drawing Title <b>Architectural Site Plan</b>	Project Title <b>EXPAND LAB AND SPS DEPARTMENTS</b>
Approved: <b>FARID MEHR, PE CHIEF, ENGINEERING SERVICE</b>	Location <b>CHALMERS P. WYLIE VA AMBULATORY CARE CENTER</b>
Date 2016-11-18	Checked By: RK
Building Number 1A	Drawing Number <b>A8.01</b>
Drawn By: AT	Project Number 757-16-101
	Building Number 1A
	Drawing Number A8.01

