

HYDRAULIC INFO.  
THIS BUILDING IS PROTECTED BY A  
HYDRAULICALLY DESIGNED  
AUTOMATIC FIRE SPRINKLER SYSTEM.  
LOCATION - ATTC  
NO. OF A.S. - 27  
BASIS OF DESIGN:  
1. DENSITY - .10  
2. AREA OF APPLICATION - 1950  
SYSTEM DEMAND:  
1. GPM DISCHARGE - 580 G  
2. RESIDUAL PRESSURE @ BASE  
OF RISER - 6.5/7.4

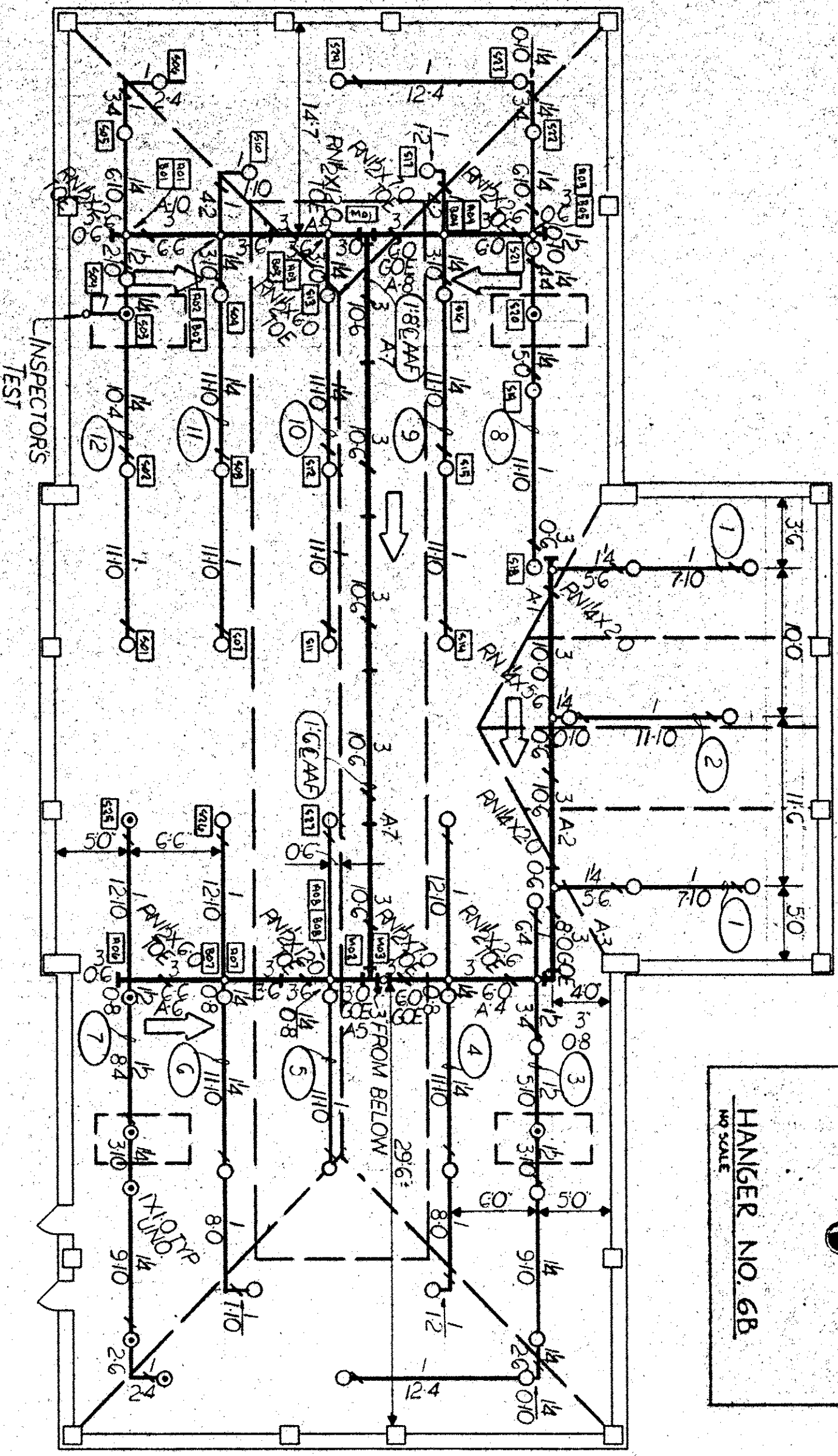

HYDRAULIC INFO.  
THIS BUILDING IS PROTECTED BY A  
HYDRAULICALLY DESIGNED  
AUTOMATIC FIRE SPRINKLER SYSTEM.  
LOCATION - Bedrooms  
NO. OF A.S. - 21  
BASIS OF DESIGN:  
1. DENSITY - .10  
2. AREA OF APPLICATION - 1500  
SYSTEM DEMAND:  
1. GPM DISCHARGE - 556 G  
2. RESIDUAL PRESSURE @ BASE  
OF RISER - 6.5/7.4

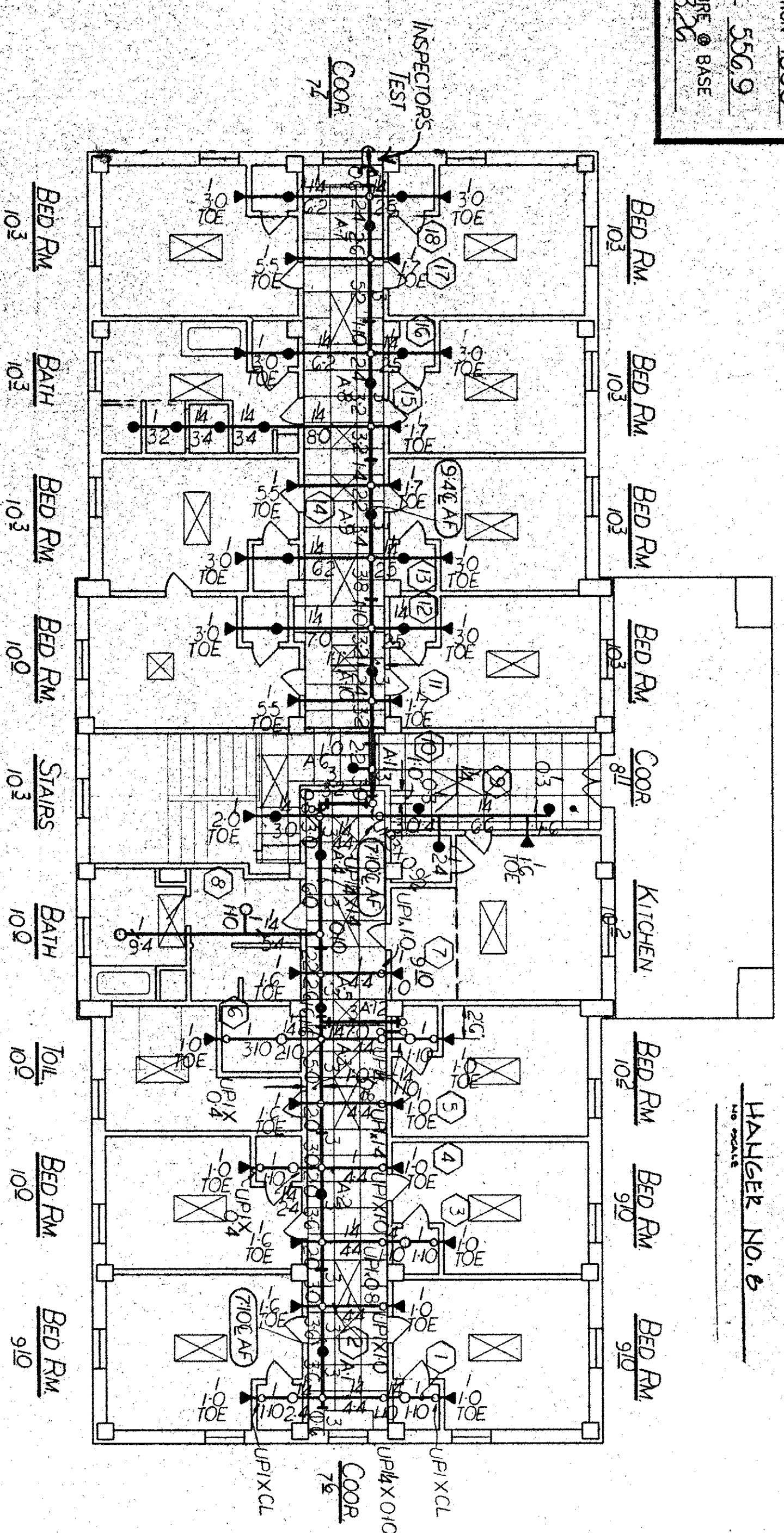

BUILDING 17  
SECOND FLOOR PLAN  
SCALE: 1/8"=1'-0"

DWG. # 2235 AS-BUILT PIPING DWGS.  
AS-BUILTS

INSTALLED BY:		Magic City Sprinkler, Inc.		100 GARDEN STREET, N.E.	
FIRE PROTECTION SYSTEMS		Magic City Sprinkler, Inc.		ROANOKE, VIRGINIA 24012	
SPRINKLERS		REVISIONS		Phone (703) 345-8810	
SYMBOL	DATE	BY	DATE	SHEET NO.	
1/2" 160°F	6/4	7/6	1/1	8-22-96 RM	
1/2" 160°F	6/4	7/6	1/1	Bldg 17 FLOOR PLAN	
1/2" 160°F	6/4	7/6	1/1	DRAWN BY: JAC	
1/2" 160°F	6/4	7/6	1/1	CHECKED BY: JAC	
1/2" 160°F	6/4	7/6	1/1	DATE: 8/2/96	
1/2" 160°F	6/4	7/6	1/1	SHEET NO. 2 of 2	
1/2" 160°F	6/4	7/6	1/1	CONTRACT WITH: NOTED	