

LEGEND

- ← NEW BURIAL SECTION HEADSTONE DIRECTION
- 42 PPC NEW BURIAL SECTION I.D.
- ← EXISTING BURIAL SECTION HEADSTONE DIRECTION
- EX. 13 PPC EXISTING BURIAL SECTION I.D.
- NOTE: SEE SHEETS LS103-LS504 FOR SIGNAGE SPECIFIC INFORMATION

CONTROL POINT SCHEDULE			
Point #	Northing	Easting	Raw Description
P 1	1911818.0903	6597993.6400	CONTROL POINT
P 2	1911818.0866	6598089.5904	CONTROL POINT
P 3	1911850.0207	6598047.5904	CONTROL POINT
P 4	1911850.0207	6598447.5904	CONTROL POINT
P 5	1911661.0207	6598447.5904	CONTROL POINT

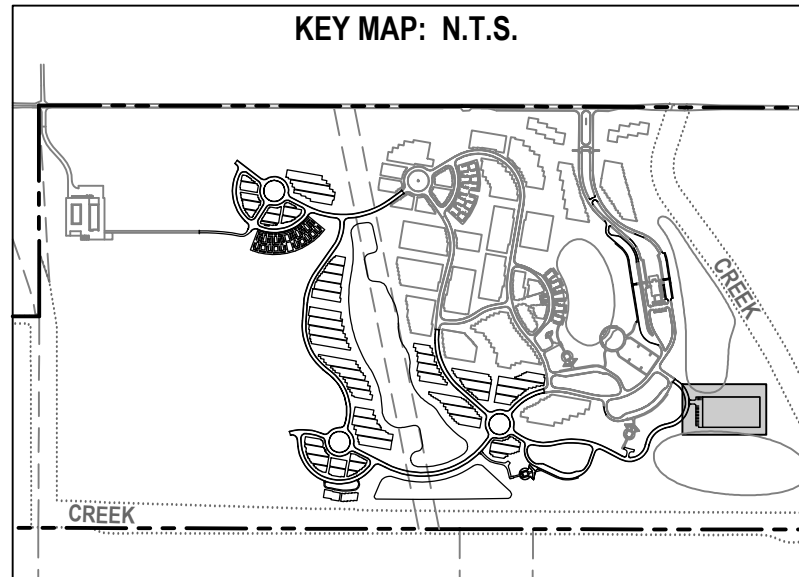
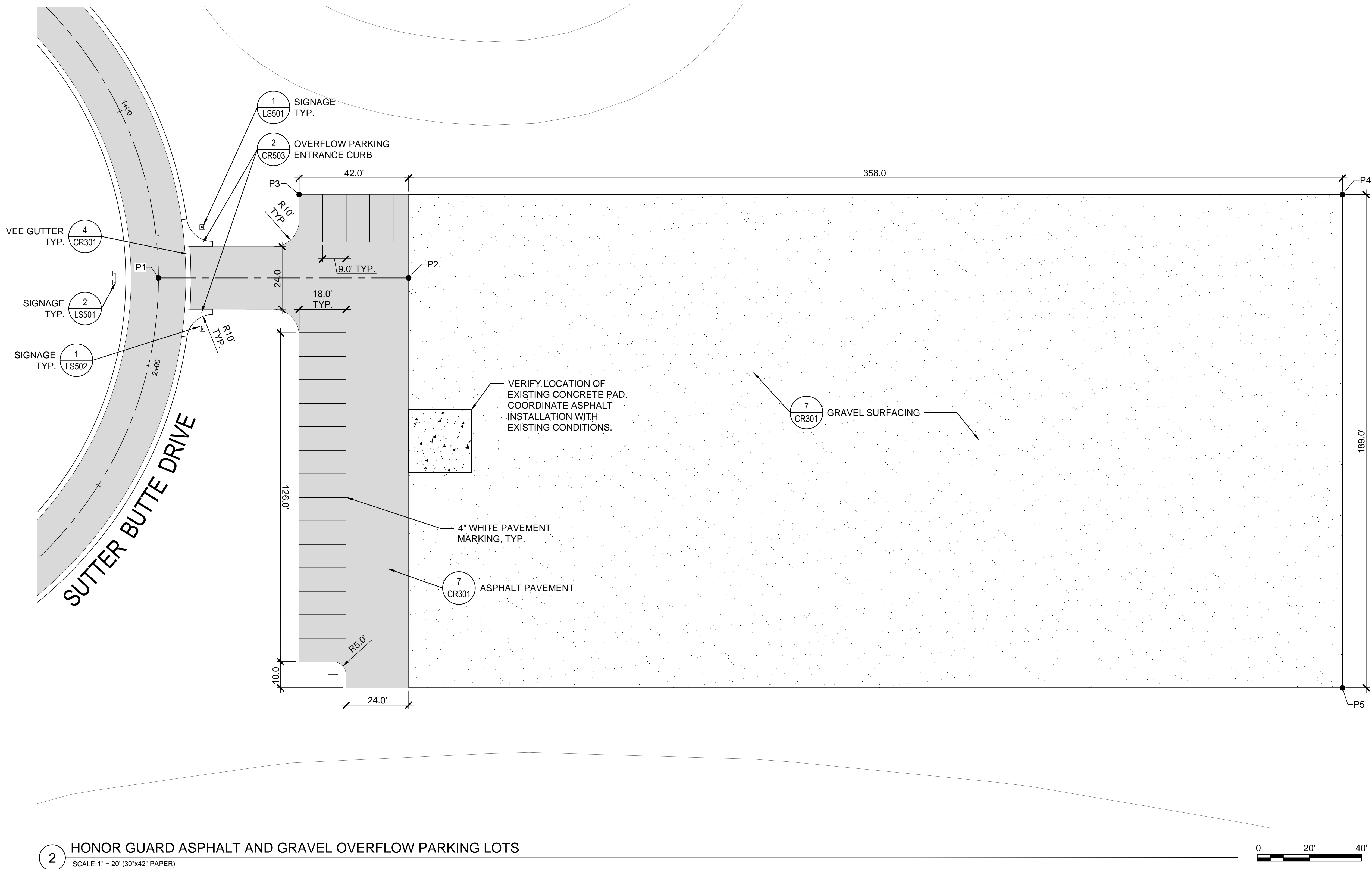

CONSULTANTS

Structural Engineering, Electrical Engineering:
HDR Engineering, Inc.
2365 Iron Point Rd. #500
Folsom, CA 95650
(916)-817-4924
Duane Hodgins

Irrigation:
Aqua Engineering, Inc.
373 Horseshoe Rd., Bldg. 2-202
Fort Collins, CO 80525
(970)-372-6104
Robert Beccard

Cost Estimating:
CPMI, Inc.
3265 Northwood Cir., Ste. 170
Eagan, MN 55121
(952)-854-3663
Bryan Bertrand

Geotechnical Engineering:
Terracon Consultants, Inc.
50 Goldenland Ct., Ste. 100
Sacramento, CA 95834
(916)-928-4690
Robert Holmer

ARCHITECT/ENGINEER OF RECORD

Project Management, Architecture, Landscape Architecture, Cemetery Planning, Civil Engineering, Land Survey:
Anderson Engineering of MN, LLC
15005 1st Ave. N., Ste. 100
Plymouth, MN 55441
(763)-412-4000
Michael Brandvold, Project Manager

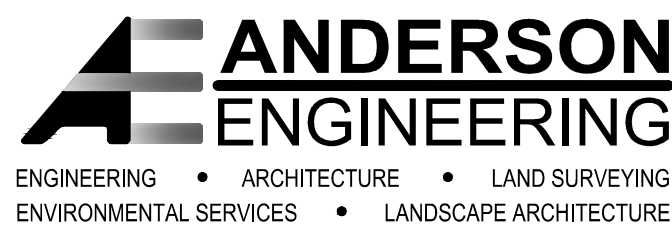

STAMP

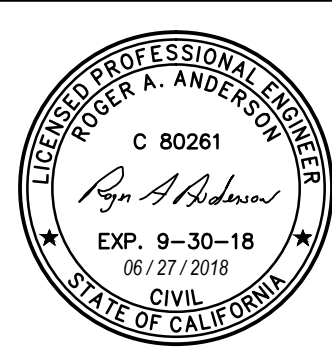

Office of Construction and Facilities Management



Drawing Title

SITE PLAN - HONOR GUARD & OVER FLOW PARKING

Approved: Project Director

Phase

BID DOCUMENTS

Project Title

Sacramento Valley National Cemetery Phase 2 Development

Location

5810 Midway Rd, Dixon, CA 95620

Issue Date

JUNE 27, 2018

Checked

JDL

Drawn

DJS

Project Number

921CM2007

Building Number

Drawing Number

C-105 REV

50 OF 262