

DEPARTMENT LEGEND

- 01-LOBBY / RECEPTION AREA
- 02-PATIENT ALIGNED CARE TEAM (PACT) CLINIC
- 03-SPECIALTY CARE SPACE - PATIENT AREA
- 04-SPECIALTY CARE SPACE-PATIENT SUPPORT
- 05-SPECIALTY CARE SPACE-PROVIDER AREA
- 08-MENTAL HEALTH CLINIC
- 09-PHYSICAL MEDICINE AND REHABILITATION (PM&R) CLINIC
- 10-PROSTHETICS AND SENSORY AIDS CLINIC
- 11-RADIOLOGY SERVICE
- 12-PATHOLOGY AND LABORATORY MEDICINE (PLM) SERVICE
- 13-PHARMACY SERVICE
- 14-CLINIC MANAGEMENT
- 15-BUSINESS SERVICES
- 16-ENGINEERING SERVICES
- 17-LOGISTICS SERVICE
- 18-POLICE SERVICE
- 19-CANTEEN SERVICE
- 20-STAFF SUPPORT AREA
- 21-SUPPORT AREA
- 22-TELE-MEDICINE
- 23-DENTAL

1 OVERALL FLOOR PLAN
3/22/2018

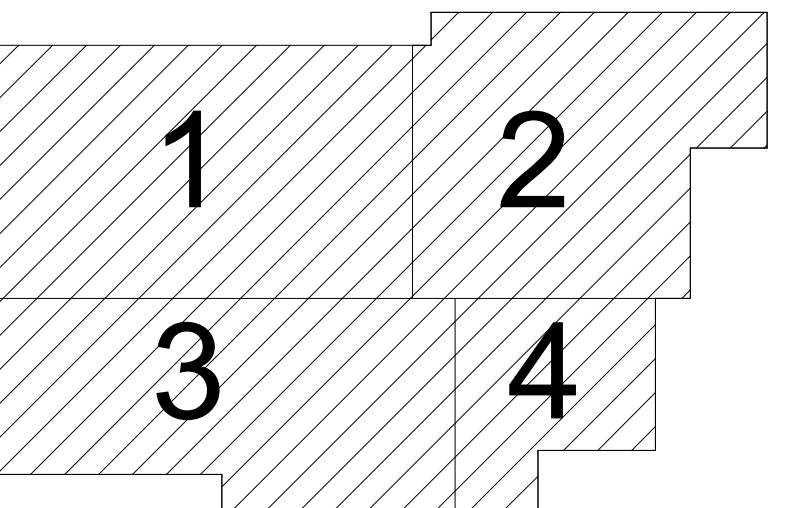
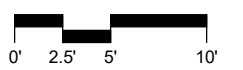

Oculus Inc.

ARCHITECTURE | STRATEGIC PLANNING |
INTERIORS | MOVE MANAGEMENT

1 South Memorial Drive
Suite 1500
Saint Louis, MO 63102

(p) 314.367.6100
(f) 314.367.1489
www.oculusinc.com



SANTA ROSA CBOC
OVERALL FLOOR PLAN
A101

VA101F-17-D-2905 36C10F18N3262
Santa Rosa, CA

SCHEMATIC DESIGN
NOT FOR
CONSTRUCTION

08/03/18

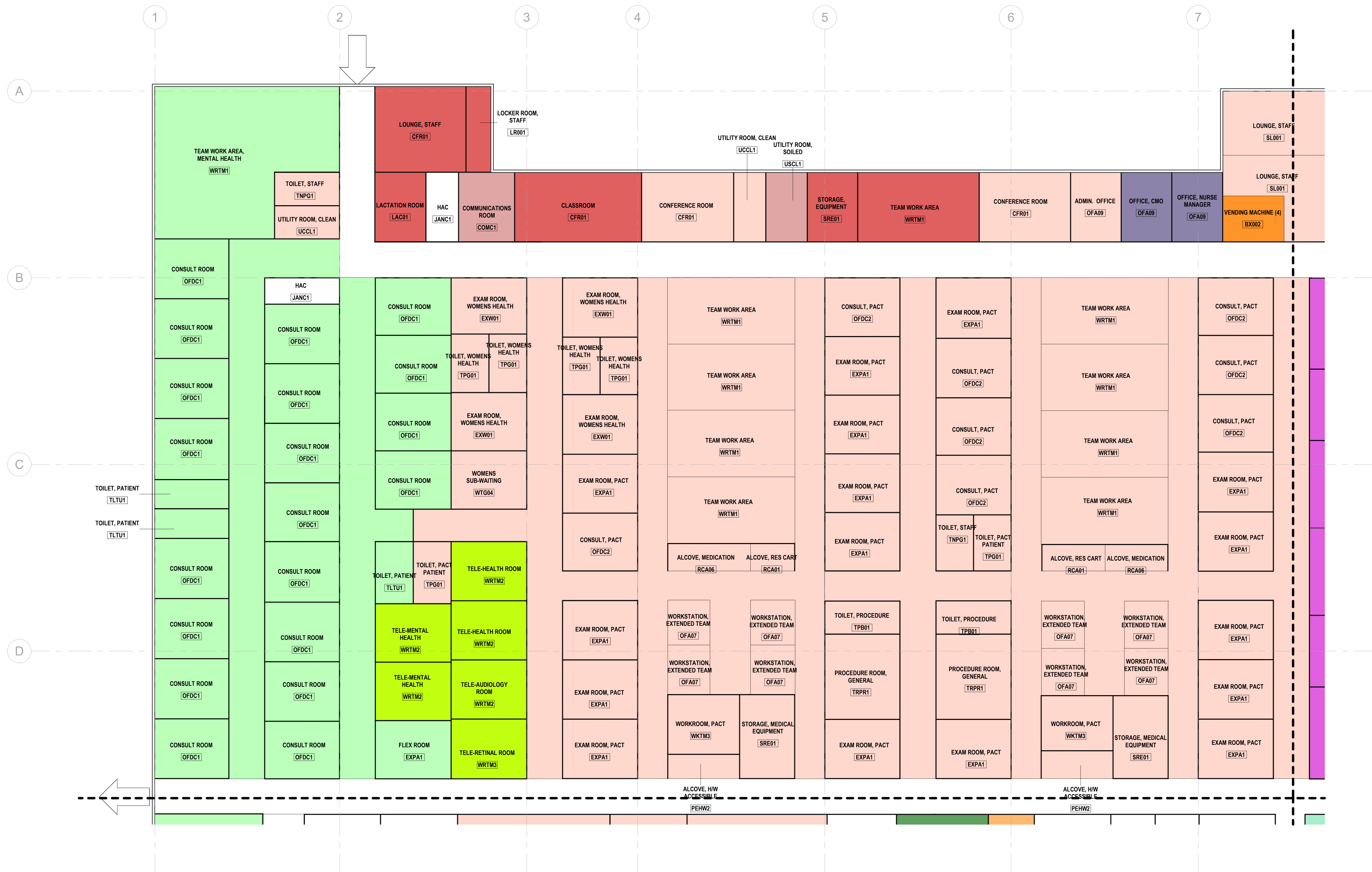

DEPARTMENT LEGEND

- 01-LOBBY / RECEPTION AREA
- 02-PATIENT ALIGNED CARE TEAM (PACT) CLINIC
- 03-SPECIALTY CARE SPACE - PATIENT AREA
- 08-MENTAL HEALTH CLINIC
- 11-RADIOLOGY SERVICE
- 14-CLINIC MANAGEMENT
- 15-BUSINESS SERVICES
- 19 CANTEEN SERVICE
- 20-STAFF SUPPORT AREA
- 21-SUPPORT AREA
- 22-TELE-MEDICINE

1 ENLARGED PLAN - AREA 1

1/8" = 1'-0"

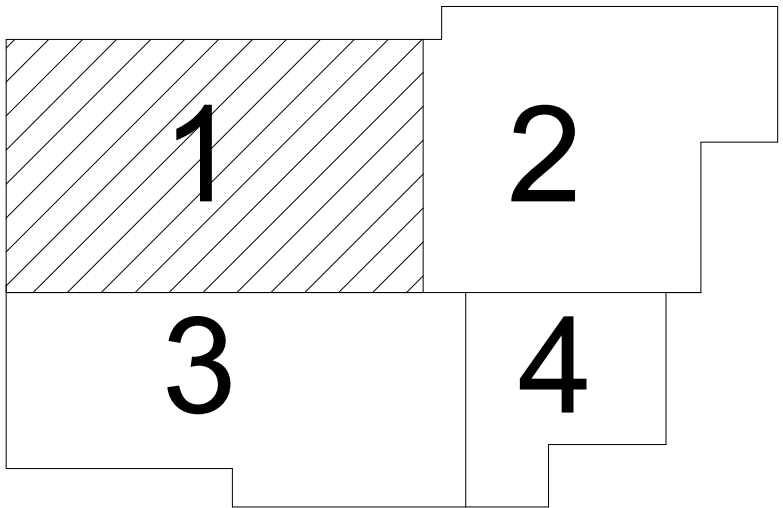

Oculus Inc.

ARCHITECTURE | STRATEGIC PLANNING |
INTERIORS | MOVE MANAGEMENT

1 South Memorial Drive Suite 1500 Saint Louis, MO 63102
(p) 314.367.6100
(f) 314.367.1489
www.oculusinc.com



SANTA ROSA CBOC
ENLARGED PLANS - 1
A201.1

VA101F-17-D-2905 36C10F18N3262
Santa Rosa, CA

SCHEMATIC DESIGN
NOT FOR
CONSTRUCTION

08/03/18

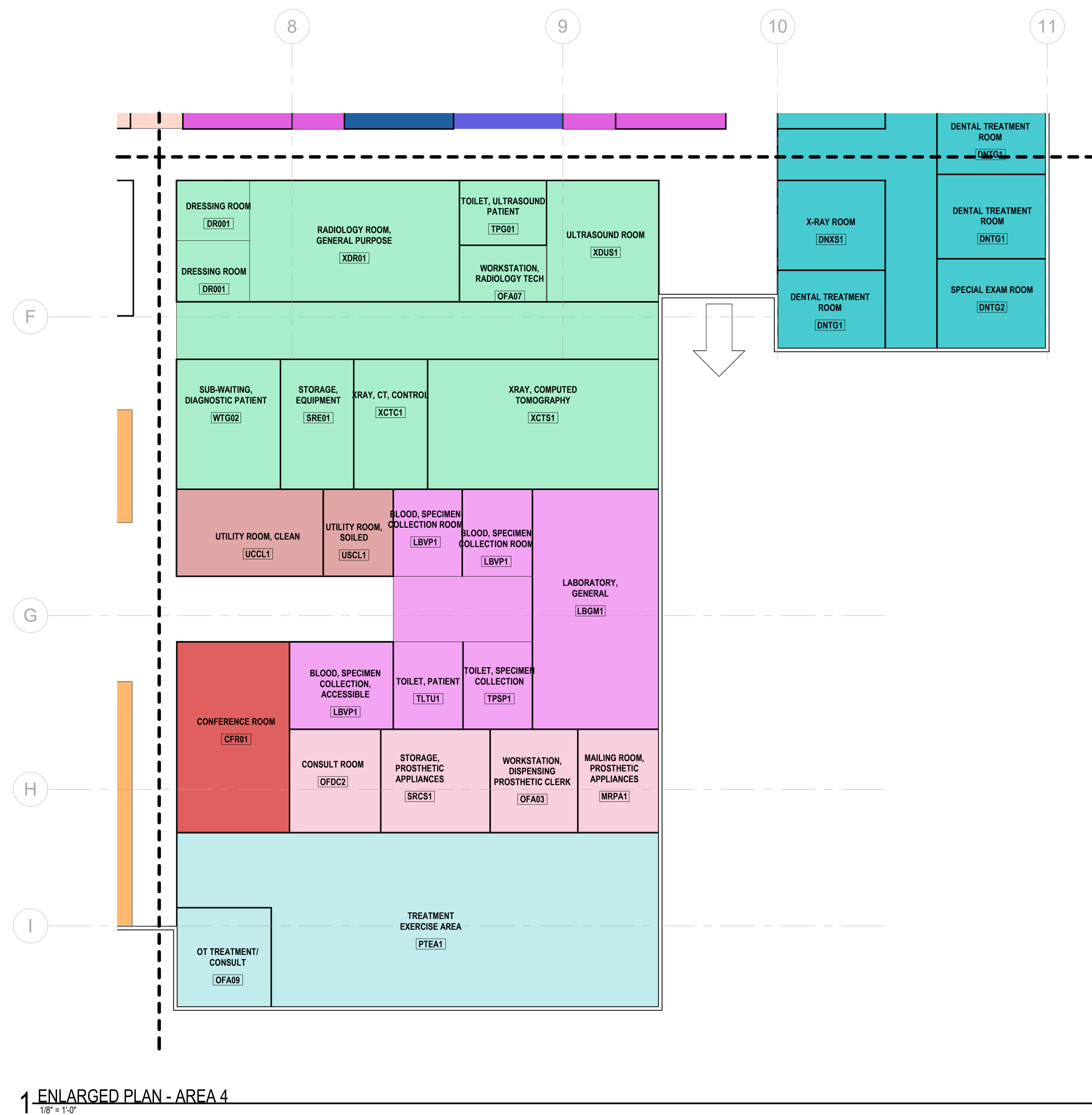

DEPARTMENT LEGEND

- 01-LOBBY / RECEPTION AREA
- 02-PATIENT ALIGNED CARE TEAM (PACT) CLINIC
- 03-SPECIALTY CARE SPACE - PATIENT AREA
- 04-SPECIALTY CARE SPACE-PATIENT SUPPORT
- 05-SPECIALTY CARE SPACE-PROVIDER AREA
- 09-PHYSICAL MEDICINE AND REHABILITATION (PM&R) CLINIC
- 10-PROSTHETICS AND SENSORY AIDS CLINIC
- 11-RADIOLOGY SERVICE
- 12-PATHOLOGY AND LABORATORY MEDICINE (PLM) SERVICE
- 20-STAFF SUPPORT AREA
- 21-SUPPORT AREA
- 23-DENTAL

