

A  
three inches = one foot  
 B  
one and one-half inches = one foot  
 C  
one inch = one foot  
 D  
three quarters inch = one foot  
 E  
one-half inch = one foot  
 F  
three-eighths inch = one foot  
 one-quarter inch = one foot  
 one-eighth inch = one foot

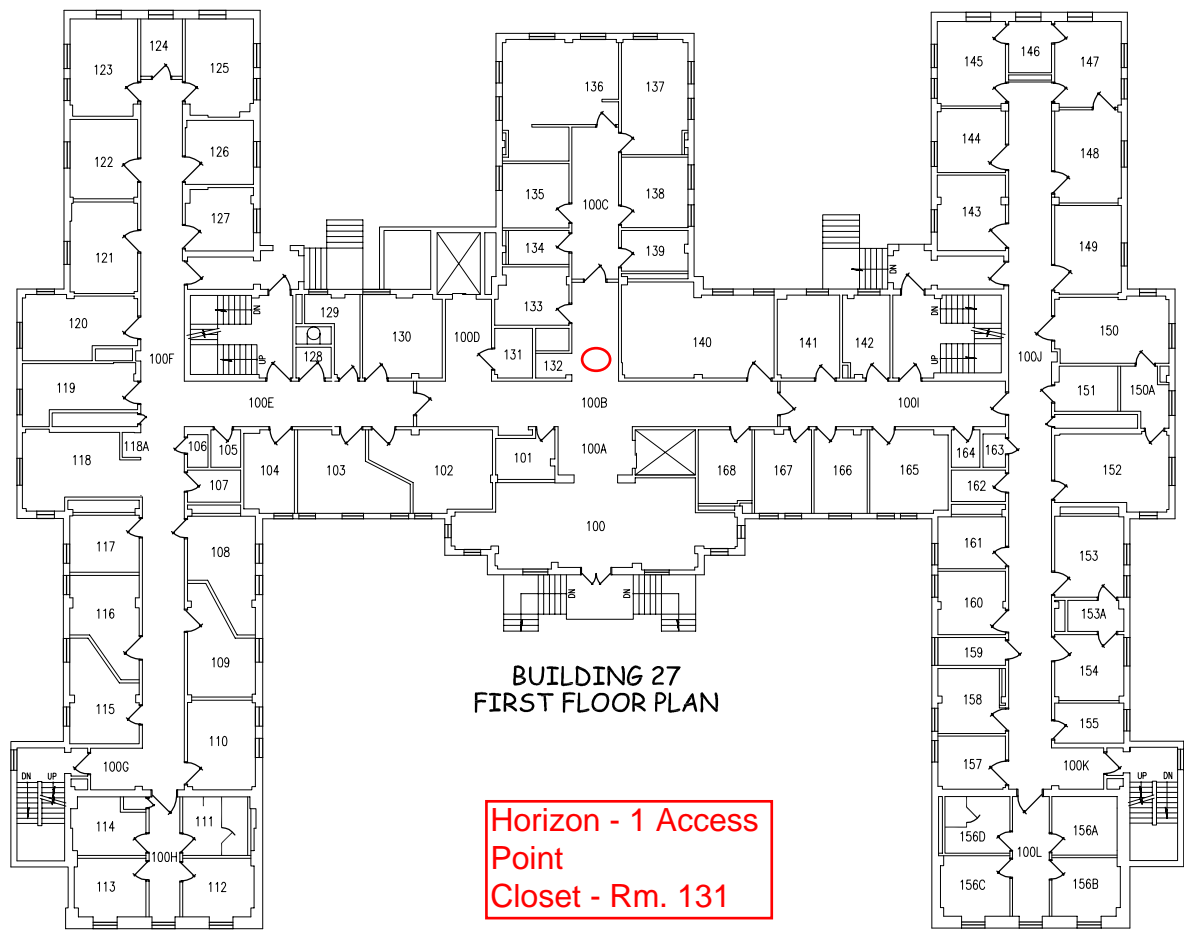

**BUILDING 27  
FIRST FLOOR PLAN**

**Horizon - 1 Access  
Point  
Closet - Rm. 131**

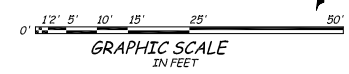

Updated Revisions		n-05 Date						Drawing Title <b>First Floor Plan</b>		Project Title		Date				
								Approved: Chief, Engineering Service		Building Number <b>27</b>		Checked Drawn			Project No.	
								Approved: Director, Medical Center		Location Chillicothe, Ohio		Drawing No. <b>S-027-1</b>			Dep. Of	