

[illegible]

CONSULTANTS:

402.282.8250 • FAX 402.280.8250
PASTORAL CARE
LUTHERAN CHURCH
1501 N. 10TH ST.
LINCOLN, NEBRASKA 68504
JOHN MILLNER ASSOCIATES
BUILDING COST CONSULTANTS
402.328.2200 • FAX 402.328.2200
1000 24TH ST., SUITE 200
LINCOLN, NEBRASKA 68502
ROBERT L. EMMOUR & ASSOCIATES
VERTICAL TRANSPORTATION CONSULTANTS
200 NICHOLS AVE. SUITE 200
LINCOLN, NEBRASKA 68502
FREDERICK AND DAVIS
402.462.7172 • FAX 402.462.0771
1615 PEAVER DR.
LINCOLN, NEBRASKA 68502



ARCHITECT/ENGINEERS:

ARCHITECT/ENGINEERS:

ARCHITECTURE
PLANNING
ENGINEERING
POLY DESIGN GROUP

2215 Conowingo Rd., Suite 101
Bel Air, Maryland 21015-1436

www.poly-design.com

410.803.2141
fax 410.836.6611

SCALE: 1/4" = 1'-0"

ENLARGED FLOOR PLANS I -
UPPER LEVEL

LIVING CENTER REPLACEMENT COMMUNITY		Date 06/08/18	
Location PERRY POINT VA MEDICAL CENTER		Checked	CAJ
		Drawn JIK/CE/ BP	W/P/ DW/ DK

 Department of Veterans Affairs	Office of Construction and Facilities Management	AS426	Drawing Number 170	Plot Number 12-173

FINAL CONSTRUCTION DOCUMENTS
FULLY SPRINKLERED

KEY PLAN

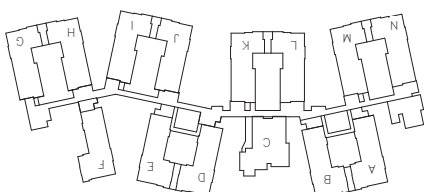

KEYNOTE LEGEND	
DIVISION	DESCRIPTION
04 72 00.06	CAST STONE WALL CAP
05 50 00.01	ALUMINUM GRATING
05 50 00.02	ALUMINUM GRATING TREADS
05 52 00.02	1 1/2" OD ALUMINUM GUARD RAIL WITH 1" BALUSTERS
05 52 00.03	12" ALUMINUM CHANNEL
05 52 00.07	S.S. EXPANSION BOLTS WITH S.S. WASHERS
05 52 00.08	8" ALUMINUM CHANNEL
05 52 00.09	ALUMINUM ANGLE
05 52 00.12	4" X 4" ALUMINUM TUBE

LIFE SAFETY LEGEND

2 HR FIRE RATED WALL & SMOKE BARRIER	
1 HR FIRE RATED WALL & SMOKE BARRIER	
SMOKE BARRIER	

MECHANICAL BUILDING STAIR - PLAN

3 EXTERIOR PLATFORM SECTION 1/2" = 1'-0" (S426)

4. LEATH FORM CROSS SECTION

5 ALUMINUM STAIR DETAIL 3/4" = 1'-0"

MECHANICAL JOINTING CHAIN

1
ENLARGED PARTIAL PLAN F-2 AS428 1/4" = 1'-0"