

three eighths inch = one foot  
one and one half inches = one foot  
one inch = one foot  
three quarters inch = one foot  
one half inch = one foot  
one quarter inch = one foot  
one eighth inch = one foot

☆ ALTERNATE NOTES

1. OMIT ELEVATOR P-31. INFILL DOORS ON BOTH LEVELS W/ SHAFTWALL. SEE WALL TYPE S4.2 ON G1004.
2. OMIT SUNDOLIER DAYLIGHT HARVESTER. OPENING IN CONCRETE FLOORS, SHAFTWALL AND CEILING FIXTURE TO REMAIN IN CONTRACT.
3. REPLACE 60 MIL KEE ROOFING MEMBRANE WITH 35 MIL KEE ROOFING MEMBRANE.
4. OMIT ROOF GARDEN SYSTEM, LANDSCAPING AT ROOF GARDEN AND GUARDRAIL SURROUNDING ROOF GARDEN. OMIT TRELLIS ON EXISTING MRI WALL. REMOVE PAVERS AT ROOF GARDEN. ROOFING MEMBRANE, INSULATION AND LIQUID WATERPROOFING BELOW ROOF GARDEN TO REMAIN IN CONTRACT.
5. OMIT SITE WALLS, ALUMINUM GATES, TRANSLUCENT PANELS AND LANDSCAPING NEAR LOUNGES/HOLDING BAYS. REPLACE SITE WALLS WITH RETAINING WALL SHOWN. SEE SHEETS AE513 AND AE514.
6. OMIT VEHICULAR ENTRANCE CANOPY. REPLACE WITH PEDESTRIAN ENTRANCE CANOPY. SEE SHEET AE512. REPLACE VESTIBULE STOREFRONT WITH STOREFRONT INDICATED. OMIT SUPPORTING CAST-IN-PLACE COLUMNS AND METAL STRUCTURE AND REPLACE WITH STRUCTURE FOR PEDESTRIAN ENTRANCE CANOPY. SEE SHEET S-601.
7. OMIT AREA INDICATED. AREA TO BE UNFINISHED SPACE. INCLUDE GYPSUM BOARD AND VAPOR BARRIER ON EXTERIOR WALLS.
8. OMIT AREA INDICATED. AREA TO BE UNFINISHED SPACE. INCLUDE GYPSUM BOARD AND VAPOR BARRIER ON EXTERIOR WALLS.
9. OMIT AREA INDICATED AND ELEVATOR P-30. INFILL DOORS ON BOTH LEVELS W/ SHAFTWALL. AREA TO BE UNFINISHED SPACE. INCLUDE GYPSUM BOARD AND VAPOR BARRIER ON EXTERIOR WALLS.
10. OMIT AREA INDICATED. AREA TO BE UNFINISHED SPACE. INCLUDE GYPSUM BOARD AND VAPOR BARRIER ON EXTERIOR WALLS.

FIRE ALARM LEGEND

SYMBOL	DESCRIPTION
	FIRE ALARM SPEAKER/STROBE LIGHT-WALL MOUNTED SUCH THAT THE ENTIRE LENS IS NOT LESS THAN 80" AND NOT GREATER THAN 90" AFF. #cd - CANDELA SETTING, # W - SPEAKER SETTING
	FIRE ALARM STROBE LIGHT-WALL MOUNTED SUCH THAT THE ENTIRE LENS IS NOT LESS THAN 80" AND NOT GREATER THAN 90" AFF. #cd - CANDELA SETTING
	FIRE ALARM STROBE LIGHT-CEILING MOUNTED SUCH THAT THE ENTIRE LENS IS NOT GREATER THAN 10'-0" AFF. #cd - CANDELA SETTING
	FIRE ALARM SPEAKER/STROBE LIGHT-CEILING MOUNTED SUCH THAT THE ENTIRE LENS IS NOT GREATER THAN 10'-0" AFF. #cd - CANDELA SETTING, # W - SPEAKER SETTING
	FIRE ALARM CONTROL PANEL
	FIRE ALARM EXTENDER PANEL
	FIRE ALARM ANNUNCIATOR
	SMOKE DETECTOR
	HEAT DETECTOR
	SMOKE DUCT DETECTOR
	FLOW SWITCH
	TAMPER SWITCH
	SMOKE DAMPER
	FIRE ALARM VOICE SPEAKER
	DOOR HOLD OPEN
	POST INDICATOR VALVE
	FIRE ALARM BELL
	FIRE ALARM REMOTE SWITCH

GENERAL NOTES:

- A. ALL FIRE ALARM DEVICES AND EQUIPMENT SHALL BE INSTALLED IN ACCORDANCE WITH THE PROJECT SPECIFICATIONS, THE MANUFACTURER'S RECOMMENDED PROCEDURES, ALL APPLICABLE LOCAL AND STATE CODES, AMERICAN DISABILITIES ACT AND WITH THE LATEST EDITION OF THE NATIONAL ELECTRICAL CODE, BICSI STANDARDS, AND VA STANDARDS.
- B. CONTRACTOR SHALL COORDINATE THE LOCATION OF CEILING MOUNTED FIRE ALARM DEVICES WITH LOCATION OF CEILING MOUNTED LIGHTING AND HVAC DIFFUSERS.
- C. CONTRACTOR SHALL COORDINATE ALL WALL MOUNTED DEVICES WITH ARCHITECTURAL DRAWINGS.
- D. ALL FIRE ALARM CABLEING SHALL BE IN FACTORY PAINTED RED EMT CONDUIT.
- E. A CORRIDOR, ROOM, OR ADJACENT SPACE WITH TWO OR MORE VISIBLE FIRE ALARM NOTIFICATION DEVICES WITHIN THE FIELD OF VIEW SHALL FLASH IN SYNCHRONIZATION.
- F. CONTRACTOR SHALL COORDINATE ALL THE SPRINKLER SYSTEM POST INDICATOR VALVE, TAMPER SWITCH, AND FLOW SWITCH LOCATIONS WITH THE SPRINKLER CONTRACTOR.
- G. POST INDICATOR VALVE SHALL HAVE TAMPER AND FLOW SWITCHES CONNECTED INTO THE FIRE ALARM SYSTEM. SEE CIVIL PLANS FOR LOCATION(S).
- H. SEE E-002 FOR ELECTRICAL BID ALTERNATES.

② SHEET KEY NOTES:

1. FIRE ALARM CONTROL PANEL. SEE SHEET FA501 FOR DETAILS. SEE SHEETS EY103 AND EY104 FOR FIRE ALARM CONTROL PANEL CABLE ROUTING.
2. PROVIDE SMOKE AND HEAT DETECTORS (OR COMBINATION DEVICE) AT TOP OF ELEVATOR SHAFT.

WALL RATING LEGEND

- 0 HOUR SMOKE RESISTANT
- 1 HOUR FIRE RATED BARRIER
- 2 HOUR FIRE RATED BARRIER
- 1 HOUR SMOKE BARRIER
- 2 HOUR SMOKE BARRIER

KEY PLAN

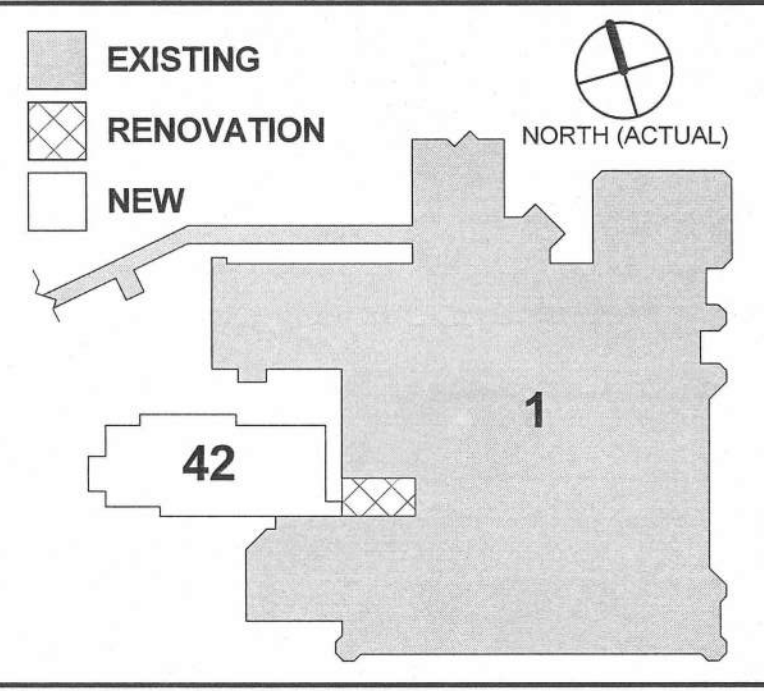

FULLY SPRINKLERED FINAL CONSTRUCTION DOCUMENTS

2 PARTIAL ROOF FIRE ALARM PLAN  
FA102 1/8" = 1'-0"

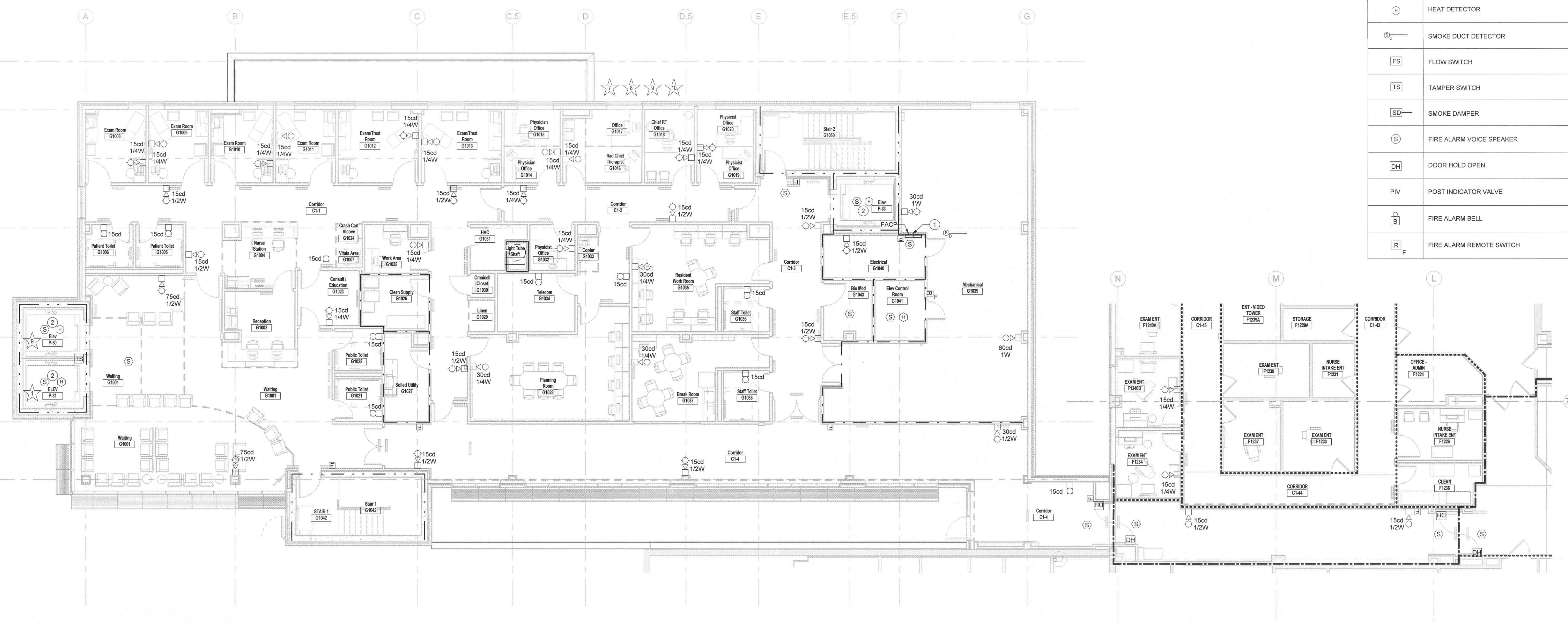

1 LEVEL 1 FIRE ALARM PLAN  
FA102 1/8" = 1'-0"

<b>CONSULTANTS:</b>  5960 Fairview Road, Suite 500 Charlotte, NC 28210 704-887-3500  111 West Main Street Durham, NC 27701 919-628-0368  P. O. Box 51967 Durham, NC 27717 919-489-0926  3516 Bush Street, Suite 200 Raleigh, NC 27609 919-871-1070		<b>PROJECT MANAGER:</b>  Raleigh, NC Indianapolis, IN Philadelphia, PA Pittsburgh, PA Virginia Beach, VA Fort Collins, CO (919) 858-7420		Project Number 13-290	Scale As indicated	Drawing Title: LEVEL 1 AND PARTIAL ROOF FIRE ALARM PLAN Approved: Project Director	Project Title VA Durham Specialty Care Building 42 Location Durham, North Carolina Date 04/28/2015 Checked JKM/RSB Drawn EAG	Project Number 558-321 Building Number 42 Drawing Number FA102 Dwg. 2 of 3	Office of Construction and Facilities Management Department of Veterans Affairs
--	--	--	--	--------------------------	-----------------------	--	---	--	--

















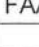





1. FIRE ALARM SYSTEM SHALL BE INTERCONNECTED WITH ACCESS CONTROL SYSTEM TO ALLOW EGRESS DURING ALARM CONDITIONS. COORDINATE BETWEEN ACCESS CONTROL SYSTEM AND FIRE ALARM SYSTEM.
2. ALL FIRE ALARM WIRING SHALL BE IN EMT CONDUIT FACTORY PAINTED RED.
3. ALL WIRING SHALL BE AS RECOMMENDED BY MANUFACTURER.
4. PROVIDE SEPARATE OUTPUT SIGNALS TO AIR HANDLER UNIT VFD FOR INDIVIDUAL UNIT SHUT-DOWN.
5. PROVIDE ZONE ADAPTER MODULES TO CONNECT NON ADDRESSABLE DEVICES SUCH AS FLOW AND TAMPER SWITCHES, DOOR-HOLD-OPEN DEVICES, AND CONTROL SIGNALS.
6. PROVIDE POWER SUPPLY AND/OR NAC (NOTIFICATION APPLIANCE CIRCUIT) PANEL, AS REQUIRED FOR ADDITIONAL DEVICES.
7. PROVIDE POWER AMPLIFIERS FOR ALL SPEAKERS.
8. NEW SYSTEM SHALL MATCH EXISTING SIMPLEX/GRINNELL 4100 ES.
9. PROVIDE ADDRESSABLE RELAY MODULES FOR ELEVATOR PRIMARY RECALL, ELEVATOR ALT. RECALL AND IN CAB NOTIFICATION.
10. PROVIDE ADDRESSABLE CONTROL MODULES FOR ELEVATOR SHUNT-UP.
11. PROVIDE ADDRESSABLE INTERFACE MODULES FOR ELEVATOR EMERGENCY SHUNT POWER SUPERVISION.

FIRE ALARM GENERAL NOTES

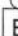
- FIRE ALARM SYSTEM AND COMPONENTS SHALL MEET THE FOLLOWING CODES:
    - A. NFPA 13 - STANDARD FOR THE INSTALLATION OF SPRINKLER SYSTEM.
    - B. NFPA 14 - STANDARD FOR THE INSTALLATION OF STANDPIPE SYSTEM.
    - C. NFPA 20 - STANDARD FOR THE INSTALLATION OF FIRE PUMP.
    - D. NFPA 70 - NATIONAL ELECTRIC CODE.
    - E. NFPA 72 - NATIONAL FIRE ALARM CODE.
    - F. NFPA 80A STANDARD FOR THE INSTALLATION OF AIR CONDITIONING.
    - G. NFPA 101 - LIFE SAFETY CODE.
    - H. VA STANDARDS.
    - I. ANSI S3.41 AUDIBLE EMERGENCY EVACUATION SIGNAL.
  2. FIRE ALARM SYSTEM SHALL COMPLY WITH FACTORY MUTUAL RESEARCH CORPORATION (FM).
  3. ALL FIRE ALARM CABLEING SHALL BE IN CONDUIT. CONDUIT SHALL BE FACTORY PAINTED RED.
  4. THE CONTRACTOR IS RESPONSIBLE FOR TESTING THE EXISTING FIRE ALARM SYSTEM IN THE AREA OF WORK AND ADJACENT AREAS FULLY, PRIOR TO THE START OF WORK. ANY DEFICIENCIES OR NON-OPERATION OF COMPONENTS OF THE FIRE ALARM SYSTEM SHALL BE BROUGHT TO THE ATTENTION OF THE OWNER AND ENGINEER AT THAT TIME. UPON COMPLETION OF WORK, THE AFFECTED AREA OF WORK AND ADJACENT AREAS SHALL AGAIN BE FULLY TESTED 100%. BE A PORTION OF THE FIRE ALARM SYSTEM WHICH IS NON-FUNCTIONAL, OR NON-COMPLIANT WITHIN THE AREA OF WORK OR ADJACENT SPACES AT THAT TIME SHALL BE REPAIRED AT NO ADDITIONAL COST TO THE OWNER.

FIRE ALARM LEGEND	
SYMBOL	DESCRIPTION
	FIRE ALARM SPEAKER/STROBE LIGHT-WALL MOUNTED SUCH THAT THE ENTIRE LENS IS NOT LESS THAN 80° AND NOT GREATER THAN 90° AFF #cd - CANDELA SETTING, # W- SPEAKER SETTING
	FIRE ALARM STROBE LIGHT-WALL MOUNTED SUCH THAT THE ENTIRE LENS IS NOT LESS THAN 80° AND NOT GREATER THAN 90° AFF. #cd - CANDELA SETTING
	FIRE ALARM STROBE LIGHT-CEILING MOUNTED SUCH THAT THE ENTIRE LENS IS NOT GREATER THAN 10-0° AFF. #cd - CANDELA SETTING
	FIRE ALARM SPEAKER/STROBE LIGHT-CEILING MOUNTED SUCH THAT THE ENTIRE LENS IS NOT GREATER THAN 10-0° AFF. #cd - CANDELA SETTING, # W- SPEAKER SETTING
	MANUAL FIRE ALARM PULL STATION TO BE LOCATED WITHIN 5-0" OF THE EXIT DOORWAY OPENING. MIN. 42" AFF, MAX. 48" AFF.
	FIRE ALARM CONTROL PANEL
	FIRE ALARM EXTENDER PANEL
	FIRE ALARM ANNUNCIATOR
	SMOKE DETECTOR
	HEAT DETECTOR
	SMOKE DUCT DETECTOR
	FLOW SWITCH
	TAMPER SWITCH
	SMOKE DAMPER
	FIRE ALARM VOICE SPEAKER
	DOOR HOLD OPEN
	POST INDICATOR VALVE
	FIRE ALARM BELL
	FIRE ALARM REMOTE SWITCH

		<b>CONSULTANTS:</b>			<b>PROJECT MANAGER:</b>		Project Number 13-290	Scale N.T.S.	Drawing Title: FIRE ALARM DETAILS	Project Title  VA Durham Specialty Care Building 42	Project Number 558-321	<b>Office of Construction and Facilities Management</b>	
		 <b>rpadesign</b> 5960 Fairview Road, Suite 500 Charlotte, NC 28210 704-887-3500		 <b>Coulter Jewell Thames</b> 111 West Main Street Durham, NC 27701 919-628-0388	 <b>GARDNER &amp; McDANIEL P.A.</b> CONSULTING ENGINEERS P. O. Box 51967 Durham, NC 27717 919-489-0926	 <b>CRENSHAW CONSULTING</b> 3516 Bush Street, Suite 200 Raleigh, NC 27609 919-871-1070			 <b>APOGEE</b> Consulting Group www.acg-pa.com Raleigh, NC Indianapolis, IN Philadelphia, PA Pittsburgh, PA Virginia Beach, VA Fort Collins, CO (919) 858-7420				
									Approved: Project Director	Location Durham, North Carolina	Drawing Number <b>FA501</b>		 <b>Department of Veterans Affairs</b>
Revisions	Date									Date 04/28/2015	Checked JKM/RSB		



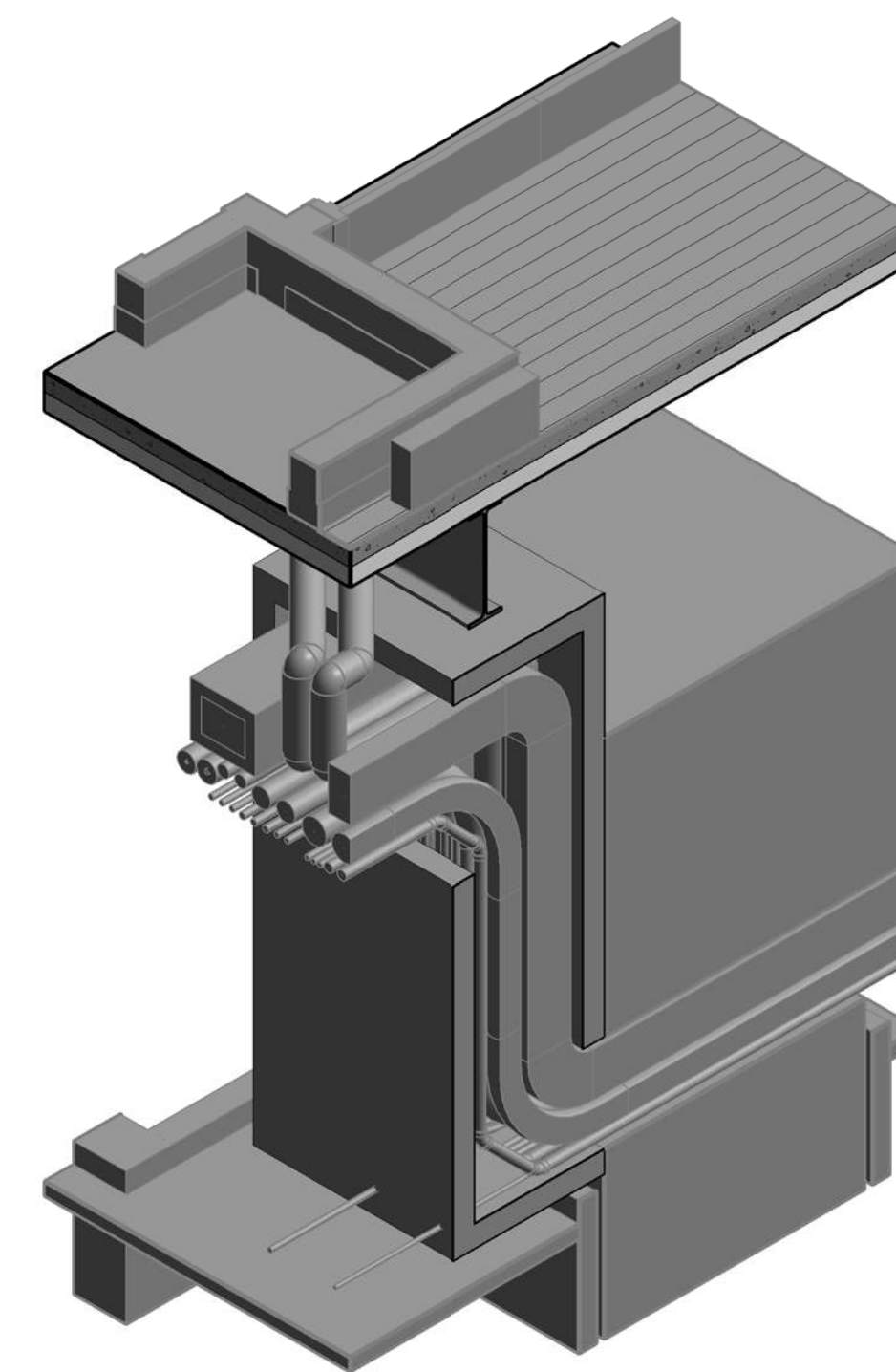

**B5 LINAC DUCT SHEILDING CUT 3D VIEW**  
R-901 SCALE:

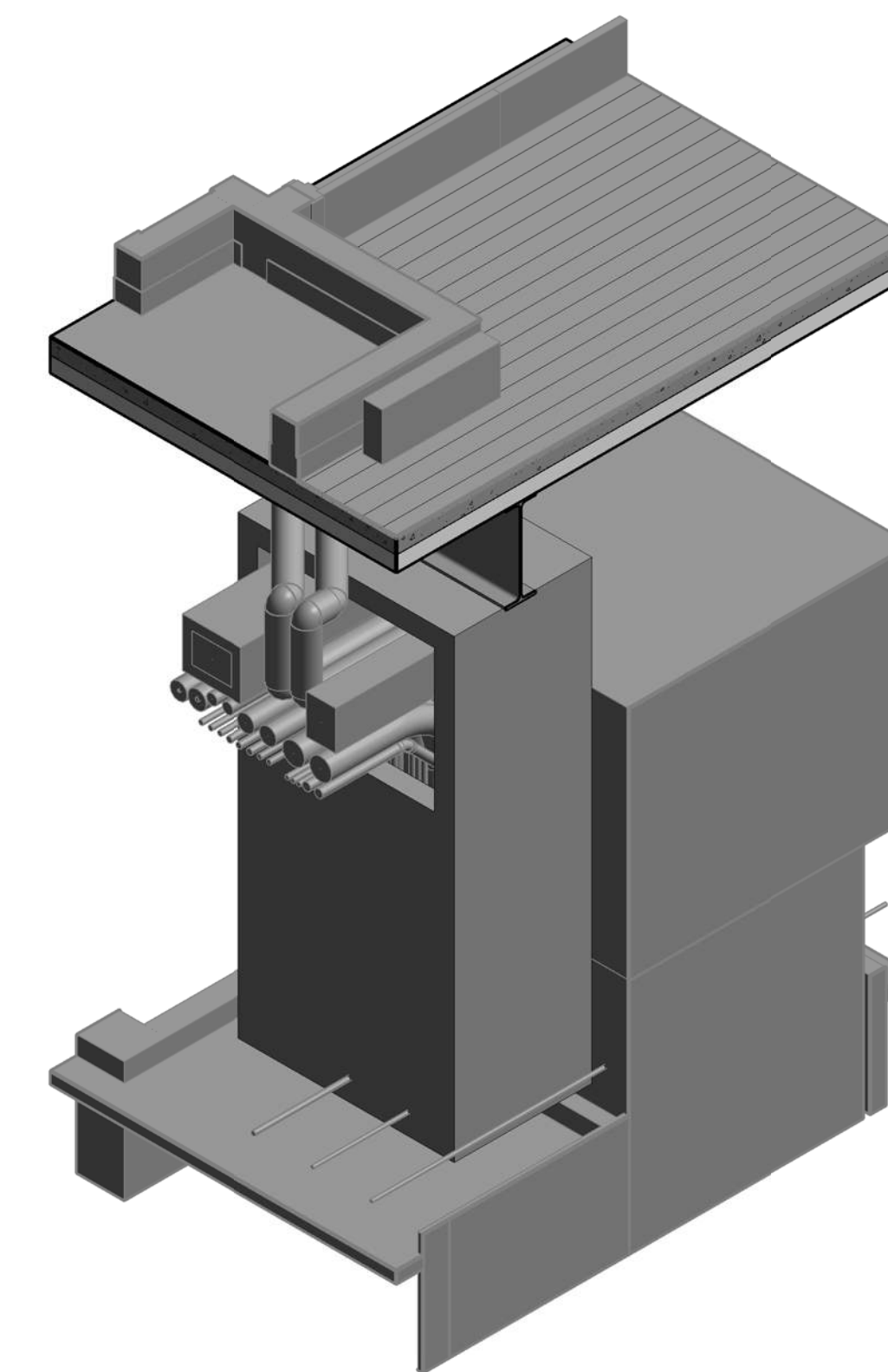

**B6** **LINAC DUCT SHIELDING 3D VIEW**  
**R-901** **SCALE:**

THIS SHEET IS FOR REFERENCE ONLY. SEE OTHER SHEETS  
FOR MORE INFORMATION.

FULLY SPRINKLERED  
FINAL CONSTRUCTION DOCUMENTS

[illegible]